

Introduction / Comments:

VP1 PERIMETER LADDER RACK FOR FULL SIZE VANS

Note:

It is advised that all fasteners used in this assembly and installation should be checked for tightness at the following intervals: @ 2-weeks and again @ 6-weeks of operation. This preventive maintenance step must be completed to ensure your Product gives you long service life.

ITEM NO.	PART NUMBER	DESCRIPTION	QTY
1	BAG19455-0	FAS ASM/INSTL VP1 FSV	1
2	19733-0	VPLR. OUTER FOOT	6
3	19737-0	VP1,R.H. SIDE ASSY.,FSVAN	1
4	19738-0	VP1,L.H. SIDE ASSY.,FSVAN	1
5	19747-0	VPLR, CROSS TUBE 57"	4
6	19749-0	LADDER STOP POST, NO FAS	2
7	25689-0	DCL "LOAD RUNNER" PULR	2
8	27630-0	LABEL, MAX WEIGHT VP1	1
9	29118-0	FOOT CLAMP-VP1-FORD&DODGE	6
10	29119-0	FOOT CLAMP-VP1-CHEVY/GMC	6

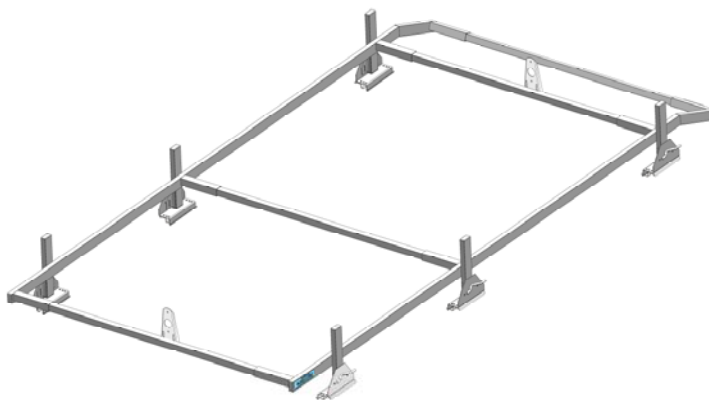

**VP1
PERIMETER LADDER RACK FSV**

- PRECAUTIONS -



CAUTION
THE USE OF AIR IMPACT TOOLS CAN
OVER-TORQUE FASTENERS AND
CAUSE FASTENER FAILURE!



CAUTION
ALL INSTALLATION HOLES SHOULD BE SEALED
WITH SILICON OR BUTYL SEALANT TO PREVENT
EXHAUST FUMES FROM ENTERING THE VEHICLE!



DANGER
INSPECT FOR FUEL TANK, FUEL LINES, BRAKE LINES, HIGH
VOLTAGE BATTERIES AND ELECTRICAL LINES PRIOR TO
DRILLING TO AVOID DAMAGING CRITICAL VEHICLE SYSTEMS
OR INJURY TO INSTALLER DURING INSTALLATION PROCESS!



CAUTION
TO AVOID DAMAGING THE VEHICLE ALWAYS USE DRILL
STOPS WHEN DRILLING ANY INSTALLATION HOLES!
ADRIAN AVAILABLE PART #'S 31121-0 (3/8" X 1/2"
DEEP), 31121-0 (1/2" x 1/2" DEEP)



- IMPORTANT WARRANTY REQUIREMENTS -

1. SUBSTITUTING ADRIAN STEEL SPECIFIED FASTENERS FOR ASSEMBLY AND/OR INSTALLATION WILL VOID YOUR PRODUCT WARRANTY.
2. ALL HOLES DRILLED INTO VEHICLE SHOULD HAVE THE RAW METAL EDGES SEALED WITH A SELF-ETCHING PRIMER TO RESIST CORROSION AND POTENTIAL FASTENER POINT FAILURE.
3. ALL FASTENERS USED IN THE INSTALLATION OF THIS PRODUCT SHOULD BE TIGHTENED TO THE TORQUE(S) SPECIFIED IN THESE INSTRUCTIONS.
4. THESE INSTRUCTIONS SHOULD BE KEPT WITH THE VEHICLE.

THE BASIC TOOLS NEEDED FOR MOST INSTALLATIONS



DRILL



DRILL BIT WITH
STOP



RATCHET, SOCKETS
AND/OR WRENCHES



SCREWDRIVERS



MEASURING TAPE

ADDITIONAL TOOLS MAY BE NEEDED FOR THIS INSTALLATION AND THEY WILL BE IDENTIFIED IN THE STEPS THAT FOLLOW.

If your vehicle contains carpet or a rubber floor mat you will need to prepare the mounting location. Position the product to be installed into the vehicle and once you are satisfied with the mounting locations, mark the mounting locations. Using a 1-3/16" diameter carpet cutter (P/N: 31183-0). Select the appropriate floor spacers as shown in the illustration. Set those aside for use later into the installation process.

Using the correct drill bit size for the selected plusnut, drill the mounting holes in the vehicle sheet metal to prepare for installing the plusnuts.

If you are thru-bolting at any of the locations simply drill a hole that is 1/16" larger than the bolt size(s) for those locations.

Once you have drilled the holes into the vehicle, the raw metal edges should be sealed using a self-etching primer to resist corrosion and potential fastener point failure.

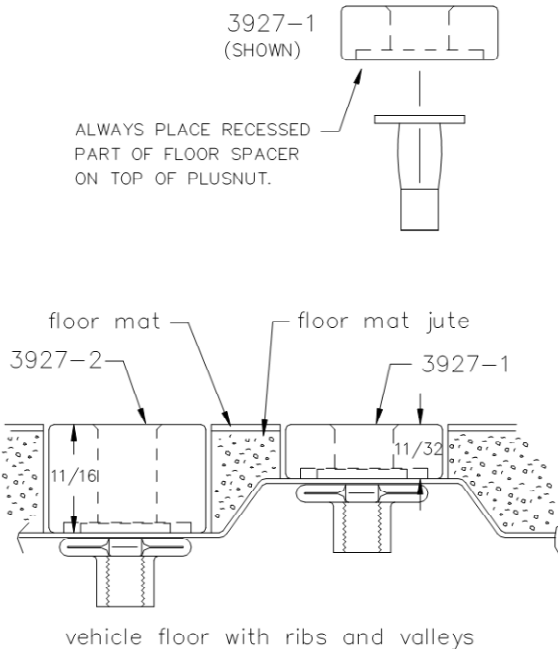

A PLUSNUT (RIVNUT) SETTING TOOL IS REQUIRED FOR PLUSNUT (RIVNUT) INSTALLATION . PLUS NUT SETTING TOOL CAN BE ORDERED THROUGH ADRIAN STEEL, OR USE AN AIR POWERED PLUSNUT SETTING GUN.

1/4-20UNC Plusnut (FAS0052) Use 3/8" dia. drill w/stop
 FAS0080 SCREW, HXHD, 1/4-20UNCx2.00", G8
 FAS0067 WASHER, FLAT, 1/4"ID
 22200-0 PLUSNUT TOOL

5/16-18UNC Plusnut (FAS0091) Use 1/2" dia. drill w/stop
 FAS0095 SCREW, HXHD, 5/16-18UNCx2.00", G8
 FAS0086 WASHER, FLAT, 5/16"ID
 22200-0 PLUSNUT TOOL

Place barrel of the plusnut body in sheet metal thru hole until flange is flush with sheet metal.
 Using a 9/16" combination wrench of plusnut tool body and a second hand wrench, ratchet, or air tool, rotate the hex bolt head CW to draw plus nut flanges up (set the plusnut).

**Installation and/or Assembly Fasteners
(BAG19455-0)**

ITEM NO.	PART NUMBER	DESCRIPTION	QTY
1	BAG0507-A	5" X 7" 3 MIL AUTOBAG	1
2	FAS0124	WASHER, FLAT USS 1/4 ZN	8
3	FAS0125	NUT, HEX NLK 1/4-20 SS	32
4	FAS0208	BOLT, CRG 1/4-20X.62 G5 NZ	12
5	FAS0213	BOLT, CRG 1/4-20X1 G5 ZN	12
6	FAS0327	U-BOLT 1/4-20X1.37X1.75SS	4
7	FAS0581	SCREW, SET 5/16-18X.37 ZN	8
8	26618-0	SILICONE, 1 OZ TUBE	1

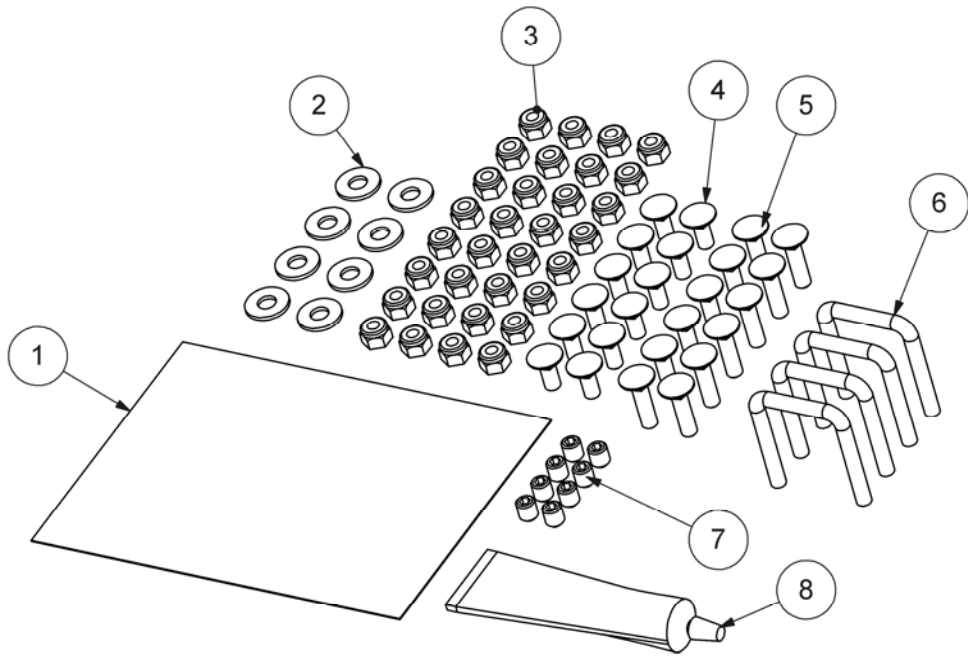

Step 01 Remove and inspect all components against Table of Contents, Contact ASCO Customer Care if components are missing and/or damaged during shipment.

Step 02 Attach all (6) Outer Foot Asm/s to the "Outer Truss Asm's". Do not fully tighten fasteners at this time.

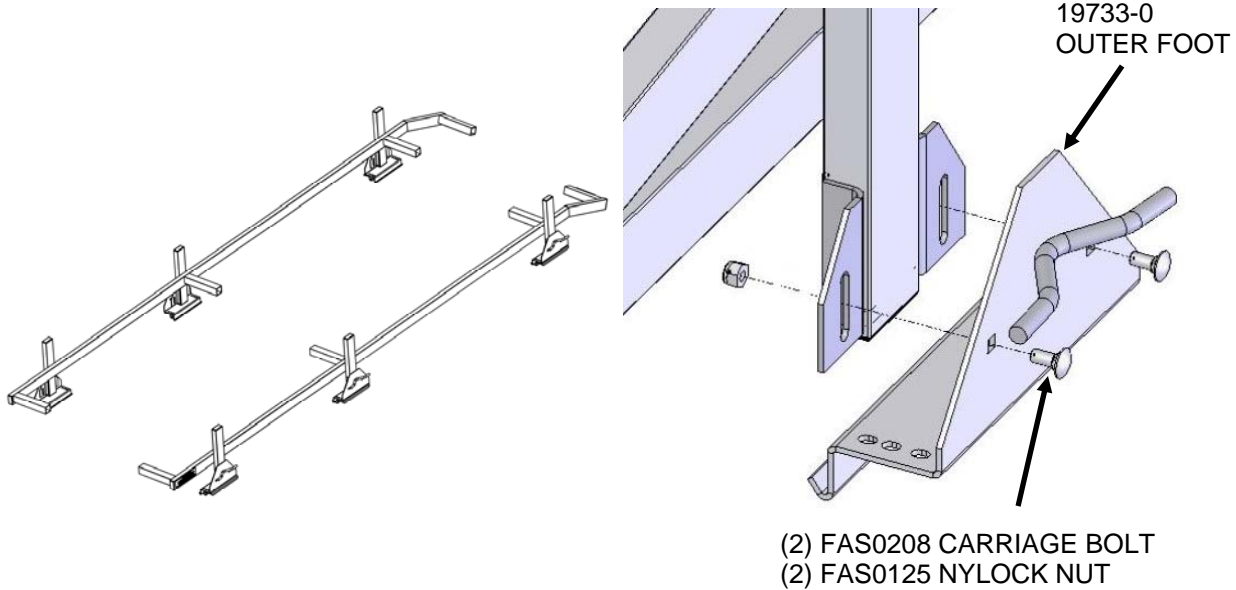

Step 03 & 04 Position the Street Side (Driver) "outer Truss Asm" on vehicle chassis drip rail edge and install four cross tubes as shown below. Use FAS0581 Socket Set Screw after rack is fully assembled.

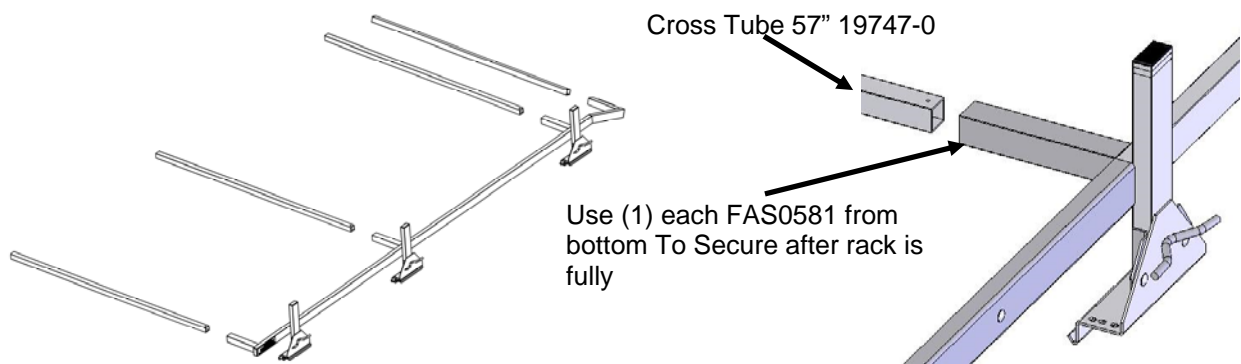

Position Flange on Outer Foot asm in Drip Rail Channel as shown at Right (Vehicle Specific)

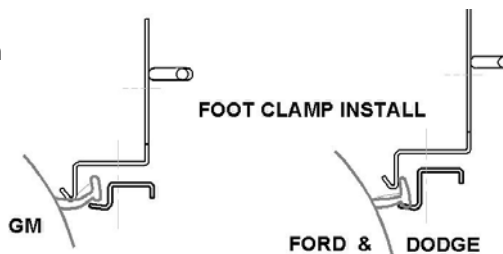

Step 05 Position the Curb Side (Passenger) “Outer Truss Asm” on vehicle chassis drip rail edge. All Four of the cross tubes must be inserted into the truss assembly before positioning the outer foot flange into the drip rail channel.

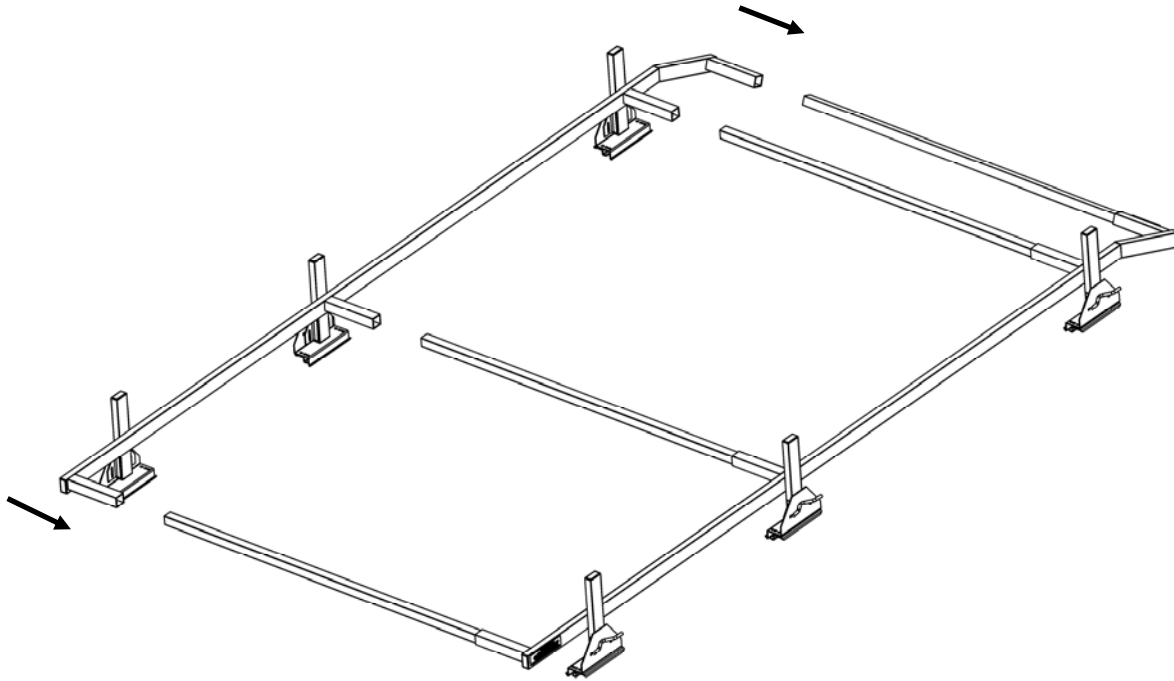

Step 06 Attach all (6) Foot Clamps (Vehicle Specific) to the Outer Foot Asm’s. Do not fully tighten fasteners at this time.

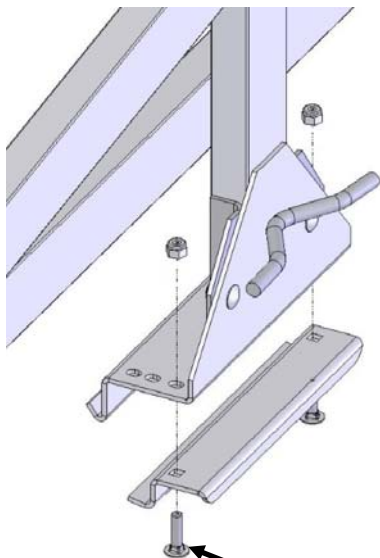

(2) FAS0213 CARRIAGE BOLT
(2) FAS0125 NYLOCK NUT

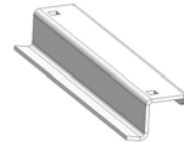

29118-0
Foot Clamp, VP1, FD/DG
Qty = 6



29119-0
Foot Clamp, VP1, CHV/GM
Qty = 6

Step 07 Square up the rack using either a carpenter's framing square or measuring outside corner to outside corner with a steel measuring tape. Adjust rack as required, this is why all fasteners were not fully tightened in previous steps.

Step 08 Check spacing from side to side to insure that the Outer Foot Asm. Rest in the drip rail correctly. Tighten up the fasteners securing all (6) Foot Clamps to the Outer Foot Weldment Asm's Do not over tighten these fasteners, drip rail flange is easily bent out of shape.

Step 09 Level the Rack to the van and tighten the fasteners securing the Outer Foot Asm to the Outer Truss Rail Weldments.

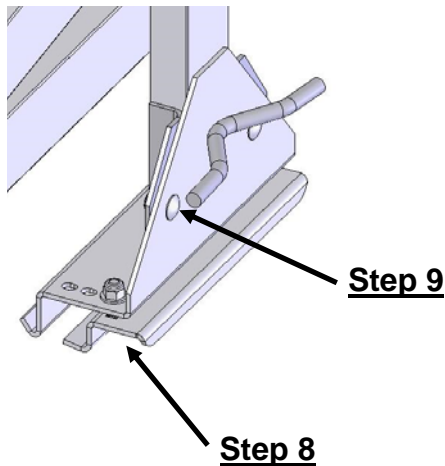

Step 10 Center all four Cross Tubes and secure in place by installing and tightening set screws.

Step 11 Apply Silicon sealant around Cross Tube Joints to prevent water seepage into the Rack Tubes.

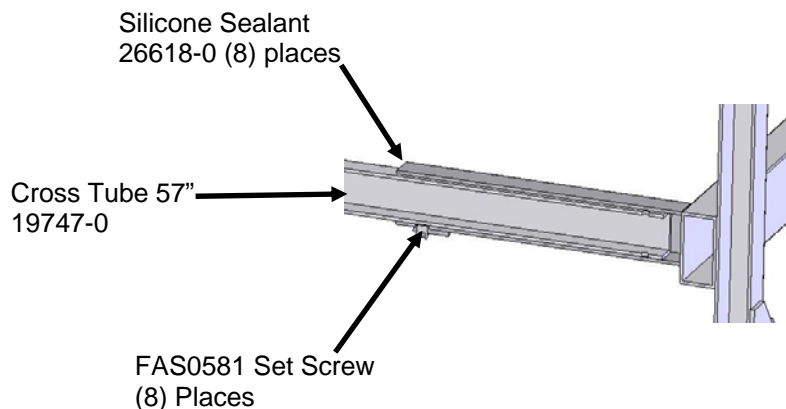

Step 12 Attach the Ladder Stops to the appropriate Crossbars according to end user ladder that will be stowed on the completed VP1 Perimeter Ladder Rack.

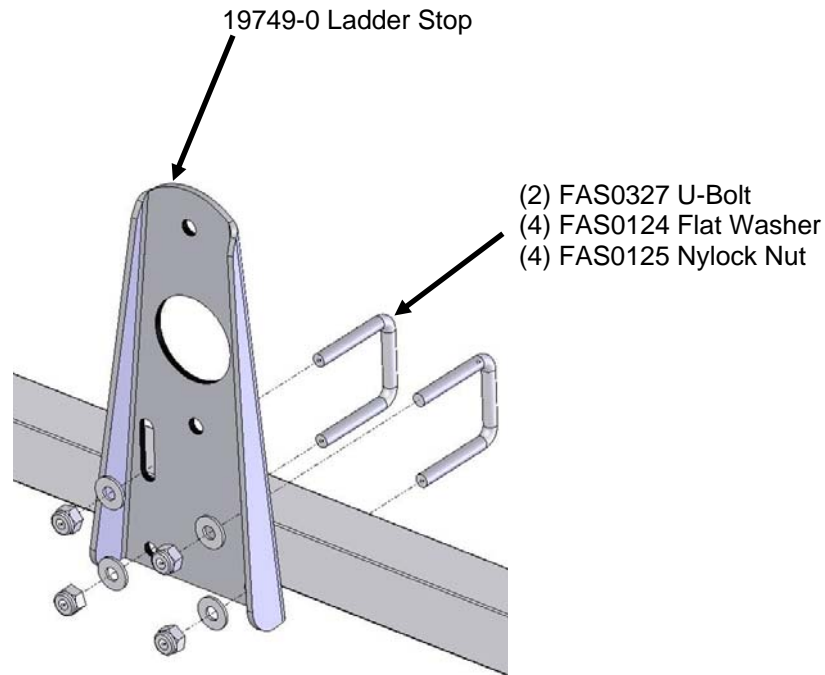

**DOUBLE CHECK ALL FASTENERS LOCATIONS TO BE SURE THAT ALL
FASTENERS ARE TIGHTENED TO SPECIFICATIONS.
YOUR INSTALLATION IS NOW COMPLETE!
STOW THIS COPY IN THE VEHICLE FOR FUTURE REFERENCES!**