

INSTR. NUMBER	PG.	REV.	ITEM NO.	PART NUMBER	DESCRIPTION	QTY.
: 66512	1	A	1	66538-B	TRUCK PLATE WLD,FDS/RPS,B	2
			2	66539-B	TRUCK PLATE WLD,FPS/RDS,B	2
PART NUMBER : FSPUMBKB			3	66504-B	FULL SIZE TRUCK MNT WLD,B	4
PART DESC. : FULL SIZE TRUCK MNT KIT,B			4	66509	UTILITY, TRUCK BOLT PLATE	4
NOTE: THIS INSTRUCTION IS VALID FOR: - FSPUMBKB - MSPUMBKB - SDPUMBKB			5	19157-0	FOAM TAPE, 0.25X2.50X192	1
			6*	63846-B	UTILITY, CROSSBOW, 68", B	2
			7*	63904	UTILITY, WEAR STRIP, 68"	2
			8*	63851	UTILITY RCK,END CAP,BLACK	4

ITEMS NOTED (#*) ARE PART OF: 2BARW

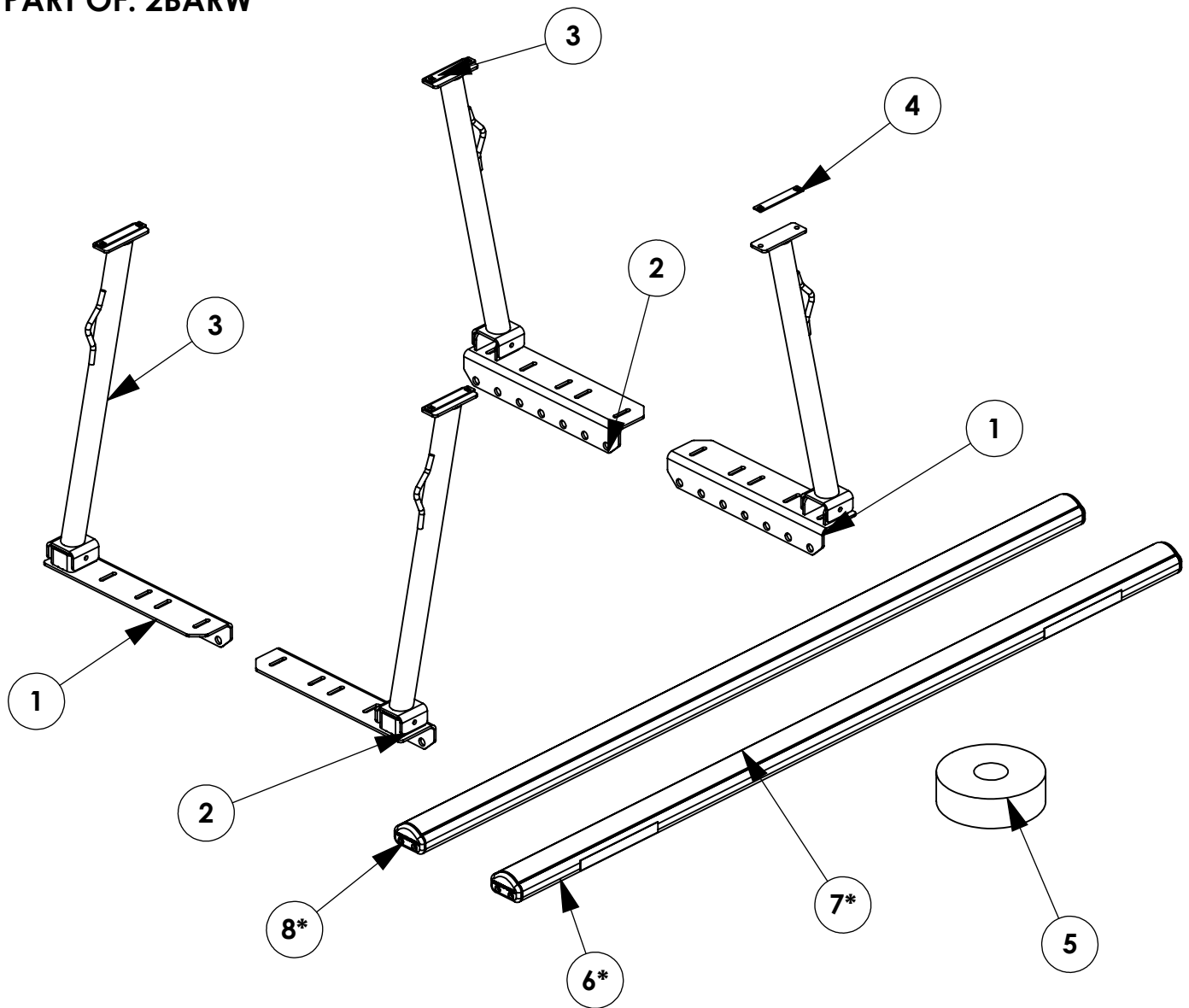

GET TO KNOW THE VEHICLE - AT THE BEGINNING OF ANY INSTALLATION, CHECK THE LOCATION OF THE FUEL TANK, FUEL LINES, BRAKE LINES, HIGH VOLTAGE BATTERIES AND WIRING HARNESES TO AVOID INJURY OR PROPERTY DAMAGE FROM TOOL CONTACT.

SEAL ALL EXTERIOR HOLES - ALL INSTALLATION HOLES SHOULD BE SEALED WITH BUTYL TAPE OR SILICON TO PREVENT WATER AND EXHAUST GASES FROM ENTERING THE VEHICLE.

CONTROL DRILL DEPTH - TO AVOID DAMAGE TO THE VEHICLE, USE A DRILL STOP OR CLEARED STEP BIT WHEN DRILLING INSTALLATION HOLES.

ALWAYS ADD PRIMER - WHEN ADDING INSTALLATION HOLES BE SURE TO USE A SELF-ETCHING PRIMER TO PREVENT CORROSION, FASTENER FAILURE AND INJURY.

MOUNTING POINTS MUST HAVE METAL-TO-METAL CONTACT - USE PROVIDED MOUNTING SPACERS TO ACCOMMODATE FOR VEHICLE FEATURES, CARPET OR SUBFLOORS.

PROVIDE CLEARANCE FOR SPACERS - IF THE INSTALLATION VEHICLE CONTAINS A CARPET OR SUBFLOOR, USE A 1-3/16" DIAMETER CARPET CUTTER (P/N: 31183-0) AT ALL MOUNTING LOCATIONS TO OPEN UP ROOM FOR SPACERS.

CHECK SPACER ORIENTATION - BE SURE THAT THE INDENT IN THE SPACER COVERS THE PLUSNUT HEAD; THIS ENSURES THE MOST METAL-TO-METAL CONTACT AND REDUCES VIBRATION.

PLUSNUT INSTALLATION - A PLUSNUT GUN IS RECOMMENDED FOR PLUSNUT INSTALLATION FOR ITS PRODUCTION SPEED. HOWEVER, A PLUSNUT SETTING TOOL CAN ALSO BE USED (P/N: 22200-0).

THRU-BOLT CLEARANCE - WHEN USING A THRU-BOLT AT ANY MOUNTING LOCATION, BE SURE THAT YOUR HOLE HAS 1/16" CLEARANCE.

FASTENERS USED

FAS0473
12X.75 SS
HH TEK SCREW
QTY: 8

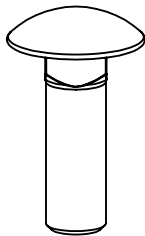

FAS0398
5/16-18X1.0 SS
CRG BOLT
QTY: 8

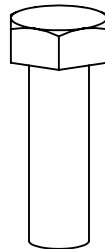

FAS0597
5/16-18X1 SS
HH SCREW
QTY: 8

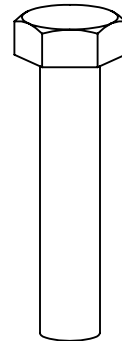

FAS0242
5/16-18X1.5 SS
HH SCREW
QTY: 8

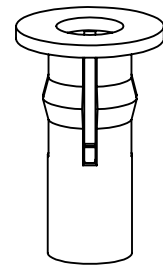

FAS0222
5/16-18 PB
PLUSNUT
QTY: 8



FAS0552
5/16 SS
FLAT WASHER
QTY: 40



FAS0164
5/16 ALUM
FLAT WASHER
QTY: 8



FAS0588
5/16 SS
SPLIT WASHER
QTY: 8



FAS0248
5/16-18 SS
NLK HEX NUT
QTY: 24

BEGIN ASSEMBLY
STEP 1 - ADD WEAR STRIPS

IF A CONDUIT KIT OR LADDER RACK ACCESSORY IS PRESENT, CHECK FOR ALTERATION INSTRUCTIONS NOW!

SLIDE WEAR STRIP INTO RAIL AND CENTER (1 PER CROSSBOW)

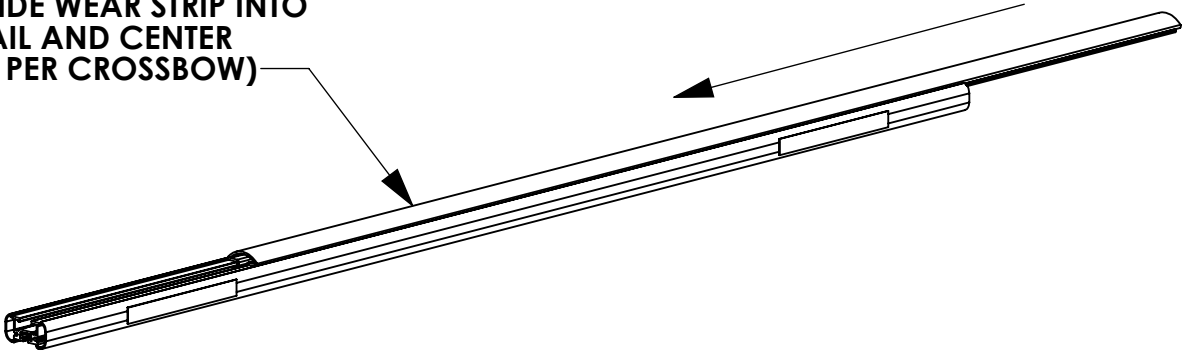

STEP 2 - INSTALL ACCESSORY SLIDES

CHECK FOR A MOUNTING BRACKET OR LADDER RACK ACCESSORY KIT FOR SLIDES.

**66509, (2)FAS0398
(2 PLACES FOR MOUNTING BRACKETS)**

ADDITIONAL SLIDE GUIDE

**(+1 PER UPRIGHT)
(+1 PER LADDER STOP)**

REFERENCE ACCESSORY KIT INSTRUCTIONS FOR SPECIFIC CARRIAGE BOLT AND PLATE PART NUMBERS

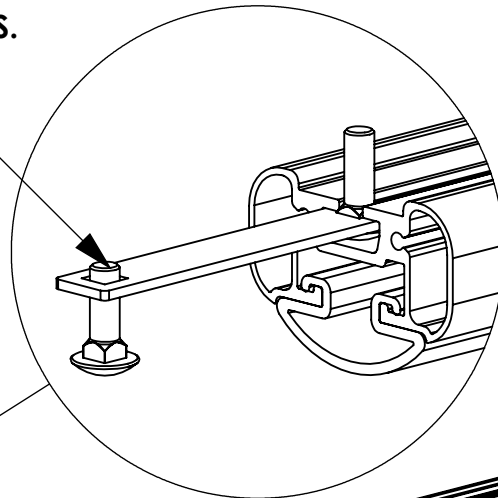

STEP 3 - ASSEMBLE MOUNTING WELDMENTS TO CROSSBOW

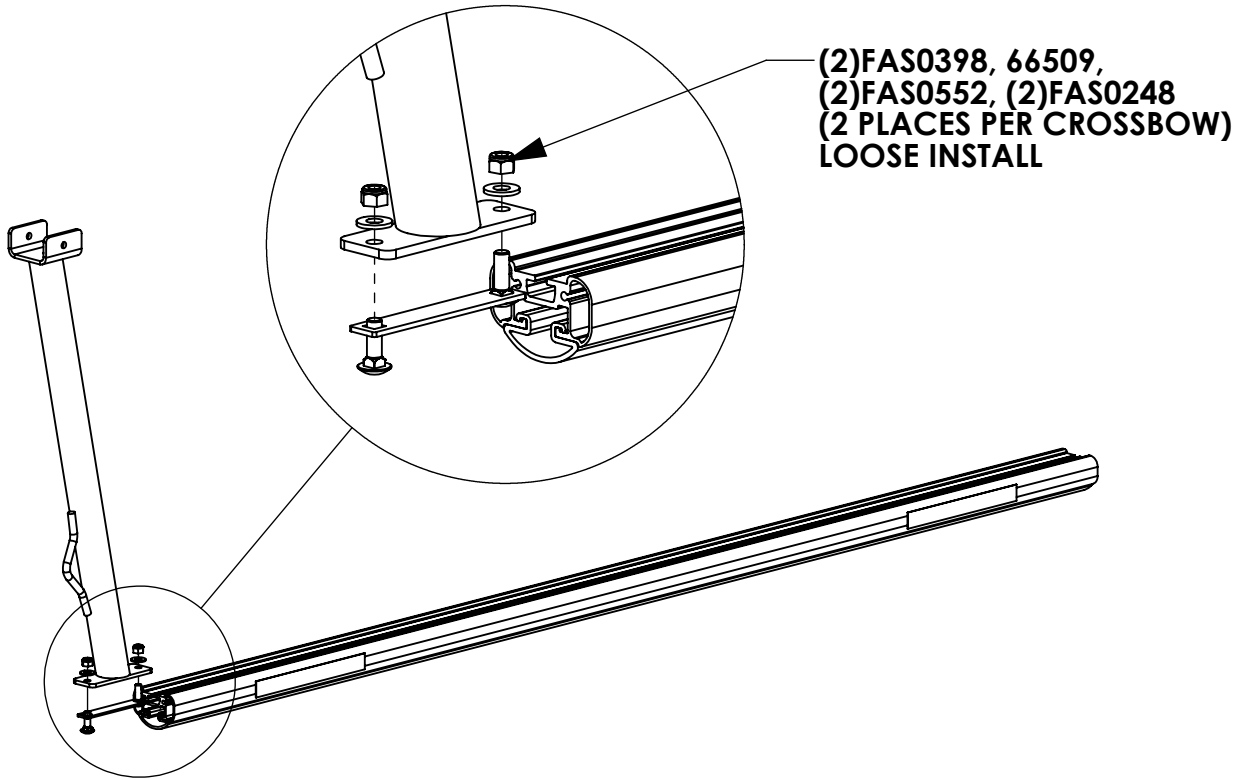

STEP 4 - ASSEMBLE END CAPS TO CROSSBOW

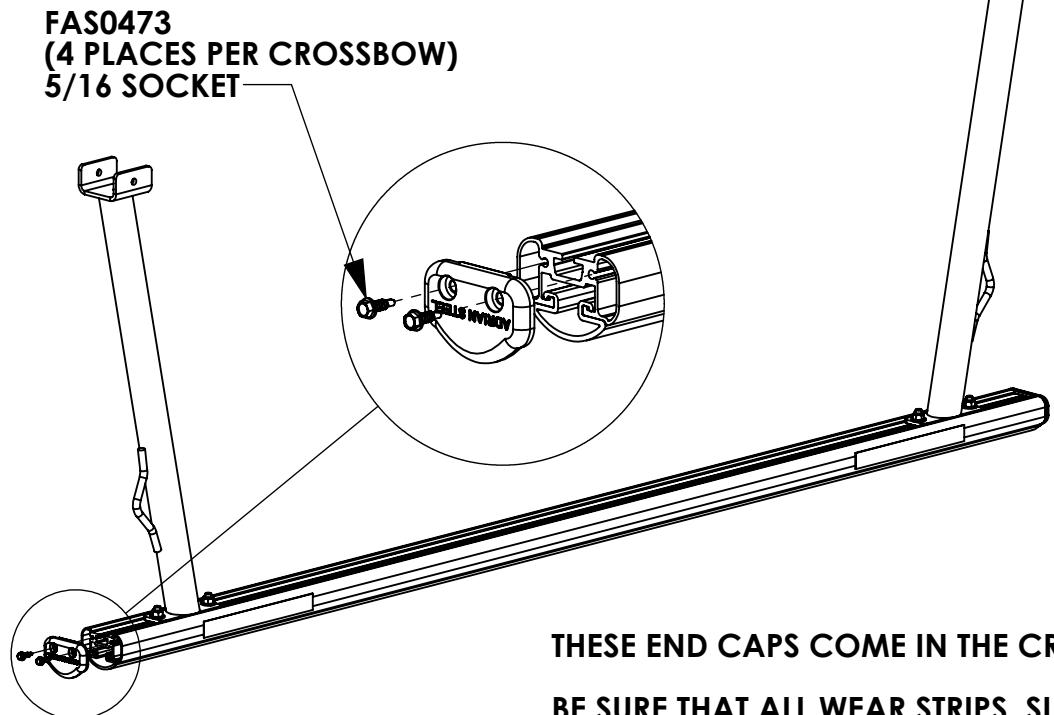

THESE END CAPS COME IN THE CROSSBOW KIT.

BE SURE THAT ALL WEAR STRIPS, SLIDES AND RACK ACCESSORIES ARE INSTALLED PRIOR TO ADDING END CAPS!

STEP 5 - MARK AND DRILL MOUNTING HOLES IN TRUCK BED RAIL

LOCATE THE MOUNTING PLATES ALONG THE BED RAILS WHERE TWO LOCATIONS CAN BE ACCESSED TO BOLT TO BED RAIL.

FRONT SET OF MOUNTING PLATES SHOULD BE AS FAR FORWARD AS POSSIBLE!

*****MAKE SURE PLATES ARE ALIGNED. ASSEMBLED GRIP-LOCK & PROLIFT RACKS BEFORE MARKING HOLES TO ENSURE CORRECT SPACING.*****

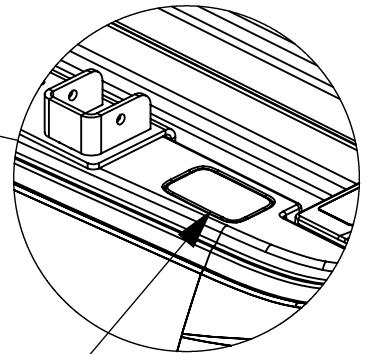
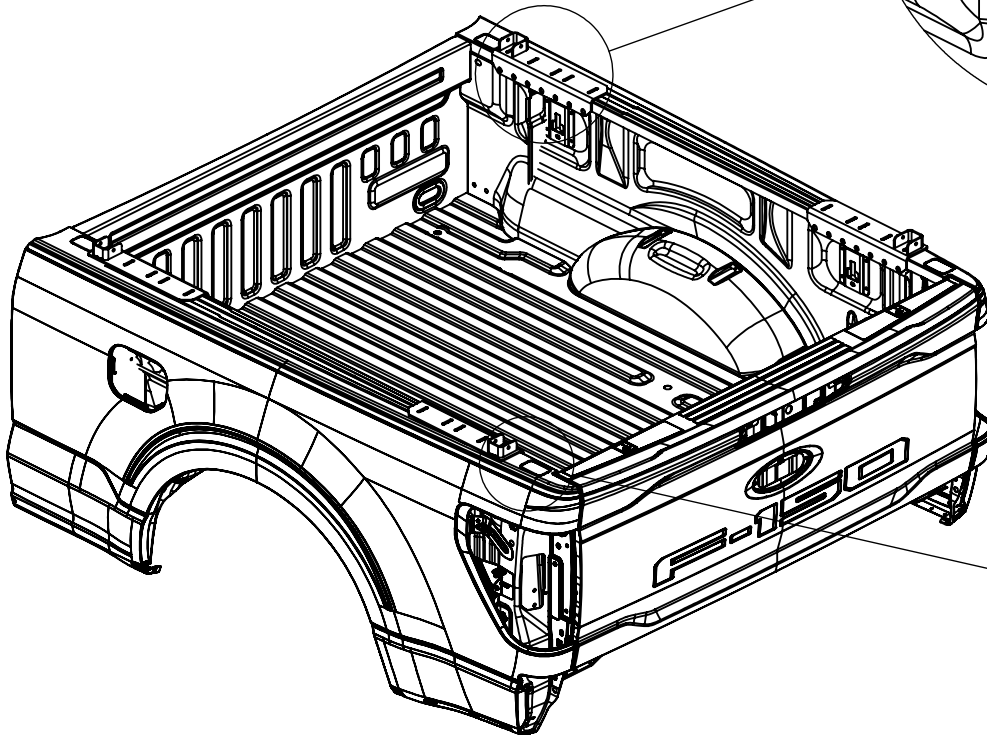
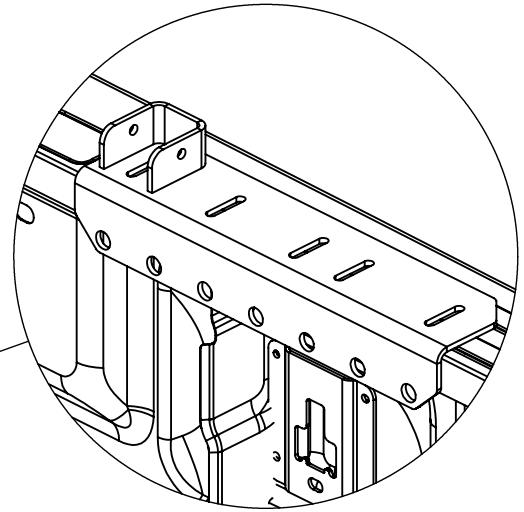

CHECK UNDERSIDE OF BED RAIL TO ENSURE THERE IS A FLAT METAL SURFACE FOR BOLT/PLUSNUT. AVOID MOUNTING OVER STAKE POCKET HOLES (FRONT AND REAR OF TRUCK BED)

ONE FASTENING LOCATION MUST BE IN SLOT BETWEEN BRACKET!

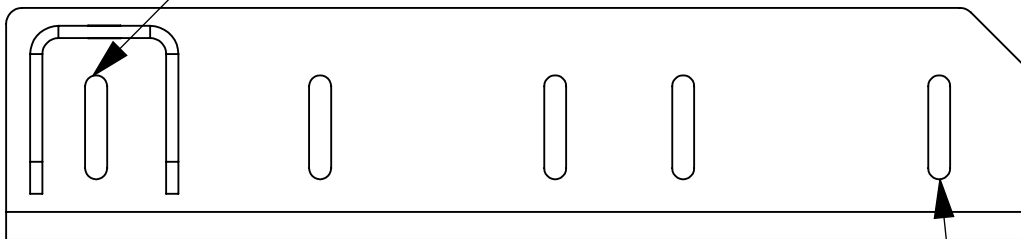

SPACE THE SECOND MOUNTING LOCATION IN FURTHEST SLOT POSSIBLE FROM FIRST MOUNTING LOCATION.

DRILL HOLE USING 1 1/32" DRILL BIT (8 PLACES)

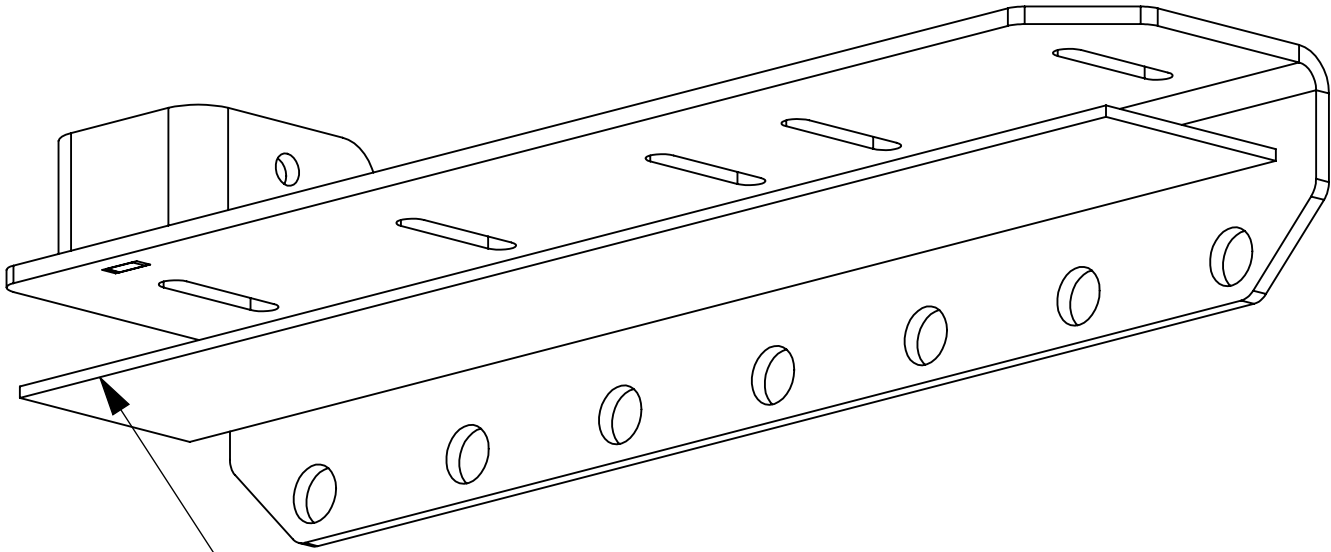
STEP 6 - APPLY FOAM TAPE TO BOTTOM OF MOUNTING PLATE

CUT 16" PIECE FROM 19157-0, REMOVE BACKING, AND APPLY TO THE BOTTOM OF MOUNTING PLATE

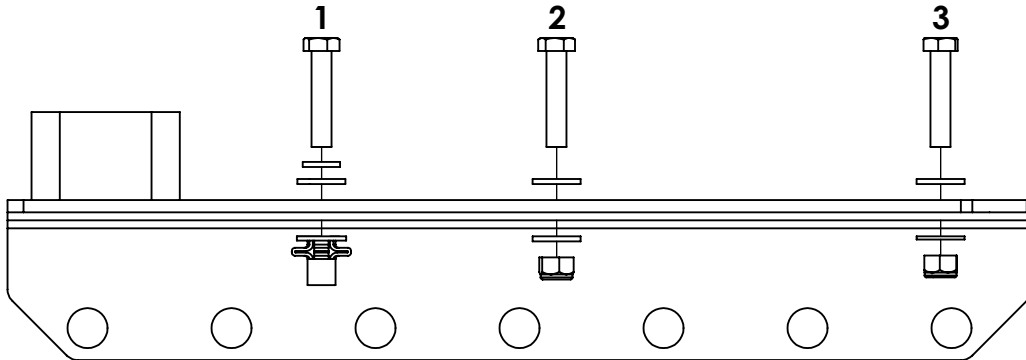
STEP 7 - ATTACH MOUNTING PLATES TO TRUCK BED RAIL (8 PLACES)

1 - FAS0242, FAS0588, FAS0552, FAS0222

USE IF YOU CANNOT GET ACCESS TO TIGHTEN NUT ON UNDERSIDE OF BED RAIL. CUT HOLE IN PLASTIC TRIM OF BED RAIL AROUND DRILLED HOLE USING 1 3/16" HOLE SAW BEFORE SETTING PLUSNUT! APPLY BUTYL TAPE AROUND THREADS OF BOLT, UNDER TOP WASHER.

2 - FAS0242, (2) FAS0552, FAS0248

USE WHEN THERE IS ENOUGH CLEARANCE TO TIGHTEN NUT AND THE BED IS NOT ALUMINUM. APPLY BUTYL TAPE AROUND THREADS OF BOLT, UNDER WASHER.

3 - FAS0242, FAS0552, FAS0164 (USED ON BOTTOM OF BED RAIL), FAS0248

USE WHEN THERE IS ENOUGH CLEARANCE TO TIGHTEN NUT AND THE BED IS ALUMINUM. APPLY BUTYL TAPE AROUND THREADS OF BOLT, UNDER WASHER.

1/2 SOCKET + 1/2 WRENCH OR PLUSNUT GUN/ 1 3/16" HOLE SAW

STEP 8 - ASSEMBLE CROSSBOW SUB-ASSEMBLIES WITH MOUNTING PLATES

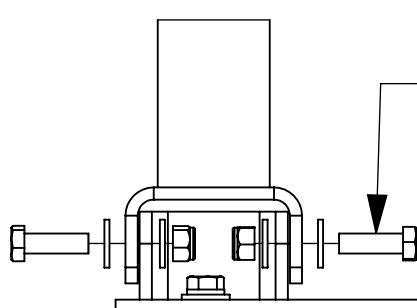
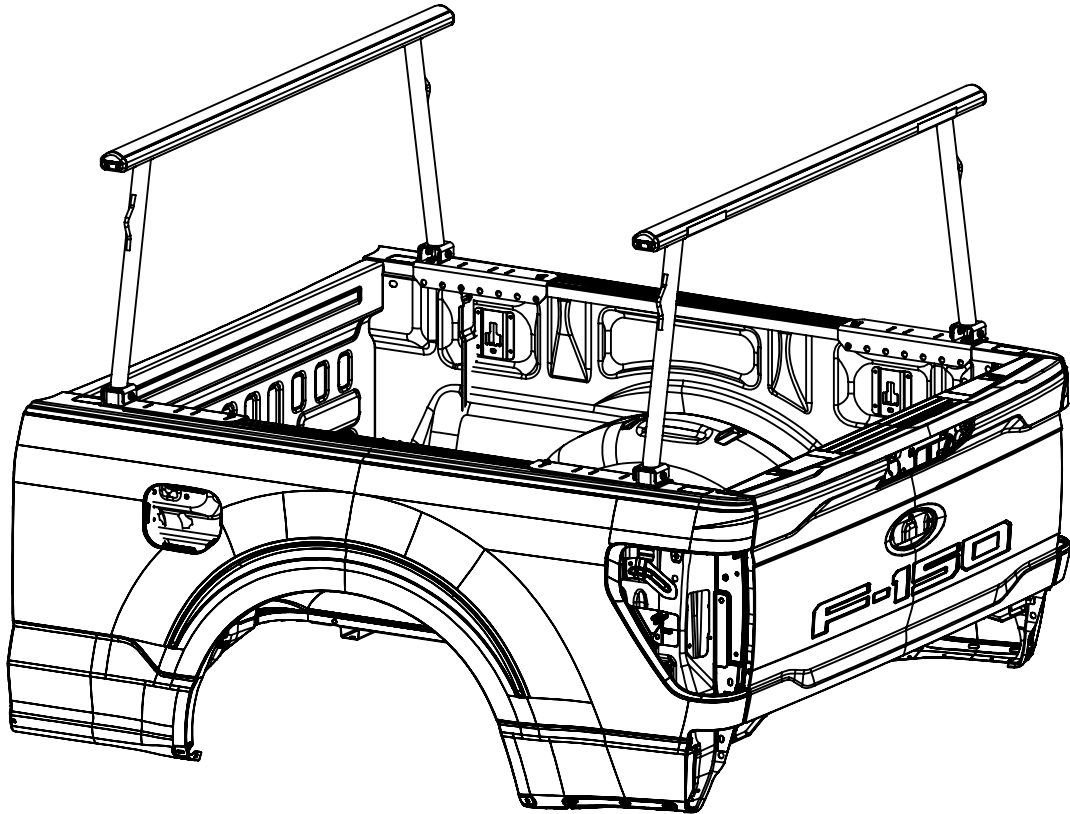

FAS0597, (2) FAS0552
FAS0248
(2 PLACES PER MOUNTING PLATE)
1/2 SOCKET
1/2 WRENCH

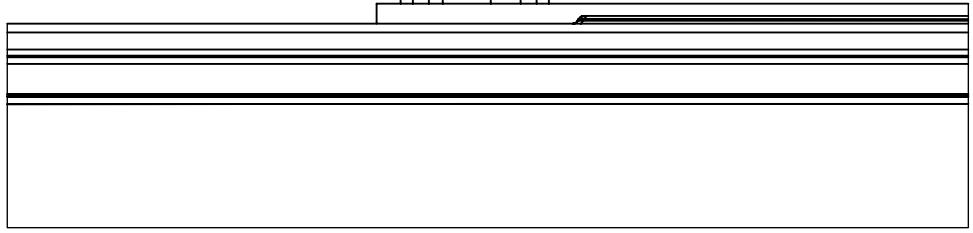

STEP 9 - TIGHTEN CROSSBOW BOLTS

**CENTER CROSSBOW AND
SECURE MOUNTING WELDMENTS
(4 PLACES PER CROSSBOW)
1/2 SOCKET**

