



PRODUCT WEIGHT
31 lbs

WIDTH x DEPTH x HEIGHT

CAPACITY
190

COLOR
Aluminum

CATALOG NUMBER
RRKFTM

PRODUCT FEATURES

This Roof Cross-bow Kit is designed to fit the Ford Transit Mid roof vehicle, 130 and 148 wheel base. This base kit allows mounting of the new re-designed drop down.

Cross-bow kits is secured to the Ford Transit by OEM supplied fastening points.

SEE PAGE 2 FOR APPLICATION NOTES AND ACCESSORIES, OTHER PRODUCTS THAT WORK WITH THIS UNIT.



**ROOF RAIL KIT, DROP DOWN LDRK, FORD
TRANSIT, MID ROOF**

CATALOG NUMBER RRKFTM

PRODUCT APPLICATION

This Roof Cross-bow Kit is designed to fit the Ford Transit, Mid roof vehicle, 130 and 148 wheel base. This will allow mounting of the new re-designed drop down ladder rack.

ACCESSORIES THAT WILL WORK WITH THIS PRODUCT

CATALOG NUMBER	DESCRIPTION
DDL61MCS	DROP DOWN LADDER RACK, CURB SIDE, MID
DDL61MSS	DROP DOWN LADDER RACK, STREET SIDE, MID

SPECIAL APPLICATION NOTES



Introduction / Comments:

THIS ROOF RAIL AND CROSS BOW KIT IS DESIGNED FOR THE FORD TRANSIT MID ROOF VANS, BOTH 130" AND 148" WHEEL BASE. IT IS THE BASE UNIT FOR ALL OF THE LADDER RACK COMBINATIONS FOR THIS VEHICLE. THE SINGLE AND DOUBLE DROP DOWN LADDER RACK.

Note:

It is advised that all fasteners used in this assembly and installation of this Rack should be checked for tightness at the following intervals: @ 2-weeks and again @ 6-weeks of operation. This preventive maintenance step must be completed to ensure your package gives you long service life.



RRKFTM ROOF RAIL AND CROSS BOW KIT FORD TRANSIT MID ROOF VANS

- PRECAUTIONS -





 **CAUTION** 
**THE USE OF AIR IMPACT TOOLS CAN
OVER-TORQUE FASTENERS AND
CAUSE FASTENER FAILURE!**



 **CAUTION** 
**ALL INSTALLATION HOLES SHOULD BE SEALED
WITH SILICON OR BUTYL SEALANT TO PREVENT
EXHAUST FUMES FROM ENTERING THE VEHICLE!**



 **DANGER** 
**INSPECT FOR FUEL TANK, FUEL LINES, BRAKE LINES, HIGH
VOLTAGE BATTERIES AND ELECTRICAL LINES PRIOR TO
DRILLING TO AVOID DAMAGING CRITICAL VEHICLE SYSTEMS
OR INJURY TO INSTALLER DURING INSTALLATION PROCESS!**



 **CAUTION** 
**TO AVOID DAMAGING THE VEHICLE ALWAYS
USE DRILL STOPS WHEN DRILLING ANY IN-
STALLATION HOLES!**



- IMPORTANT WARRANTY REQUIREMENTS -

1. SUBSTITUTING ADRIAN STEEL SPECIFIED FASTENERS FOR ASSEMBLY AND/OR INSTALLATION WILL VOID YOUR PRODUCT WARRANTY.
2. ALL HOLES DRILLED INTO VEHICLE SHOULD HAVE THE RAW METAL EDGES SEALED WITH A SELF-ETCHING PRIMER TO RESIST CORROSION AND POTENTIAL FASTENER POINT FAILURE.
3. ALL FASTENERS USED IN THE INSTALLATION OF THIS PRODUCT SHOULD BE TIGHTENED TO THE TORQUE(S) SPECIFIED IN THESE INSTRUCTIONS.
4. THESE INSTRUCTIONS SHOULD BE KEPT WITH THE VEHICLE.

THE BASIC TOOLS NEEDED FOR MOST INSTALLATIONS



DRILL



DRILL BIT WITH
STOP



RATCHET, SOCKETS
AND/OR WRENCHES



SCREWDRIVERS



MEASURING TAPE

ADDITIONAL TOOLS MAY BE NEEDED FOR THIS INSTALLATION AND THEY WILL BE IDENTIFIED IN THE STEPS THAT FOLLOW.

BAG50896 - FASTENER BAG

ITEM NO.	PART NUMBER	DESCRIPTION	BAG50896/QTY.
1	BAG0406-A	4" x 6" 3MIL AUTOBAG	1
2	FAS0552	Washer, Flat, 5/16, SST	16
3	FAS0597	Screw, Hex Hd, 5/16-18x 1.00 SST	8
4	FAS0248	Nut, Nylon Insert Lock, 5/16-18 SST	16
5	FAS0808	Bolt, Carriage, 5/16-18x3 1/2	8

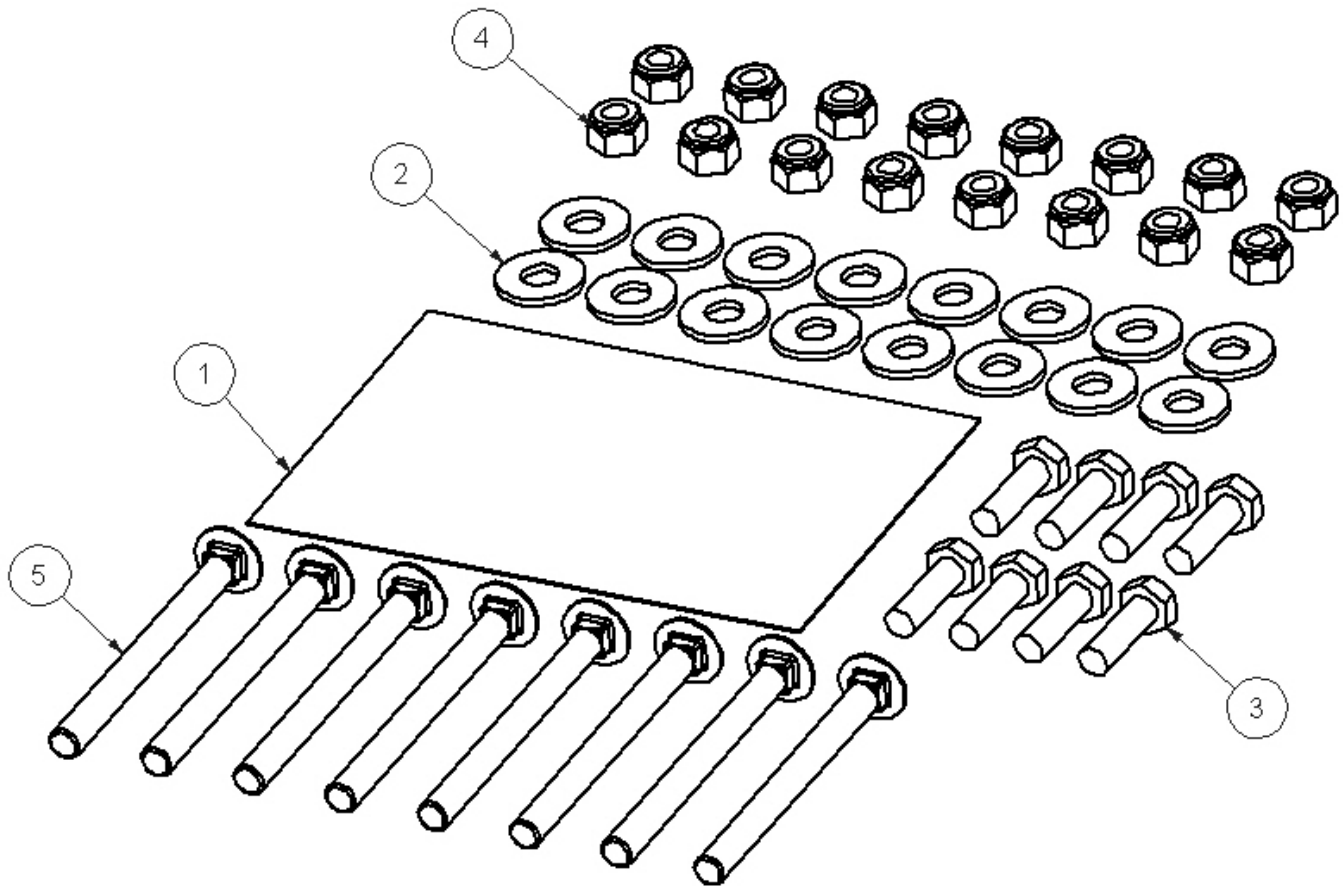

BAGRRKFTM—FASTENER BAG, ROOF RAIL KIT

ITEM NO.	PART NUMBER	DESCRIPTION	QTY.
1	BAG0406-A	4" x 6" 3MIL AUTOBAG	1
2	FAS0351	SCREW, HHCS, M8-1.25 X 40MM LG	6
3	FAS0552	Washer, Flat, 5/16, SST	6
4	FAS0588	Washer, Lock, Split, 5/16, SS	6
5	05586-0	Butyl Tape, T224 -1/2"X 1' Roll	1
6	26618-0	Silicone Sealant	1

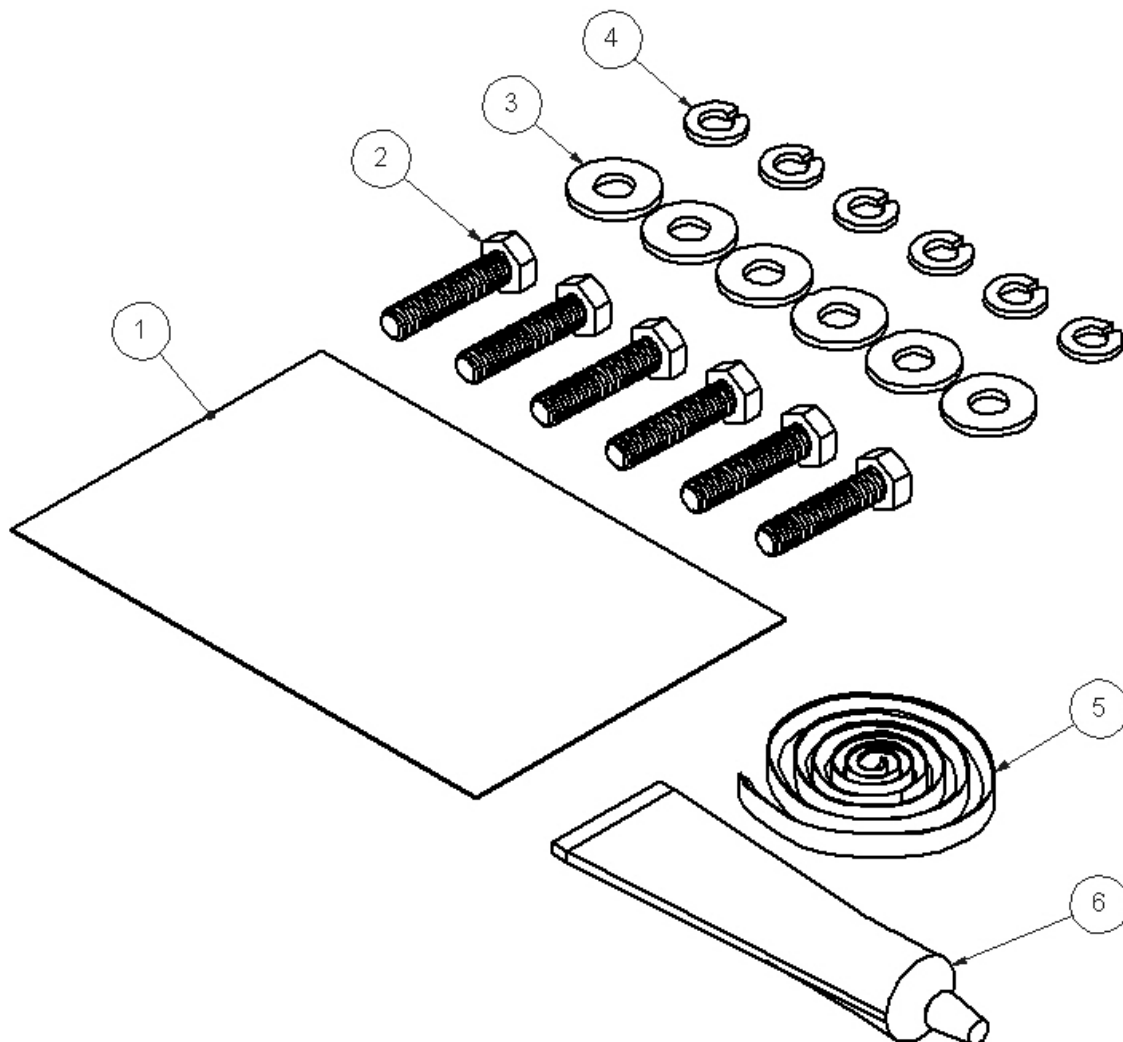



STEP #1 : PREP ROOF RAILS—130 WHEEL BASE

52036 STREET SIDE ROOF RAIL
TOE UP TO THE OUTSIDE

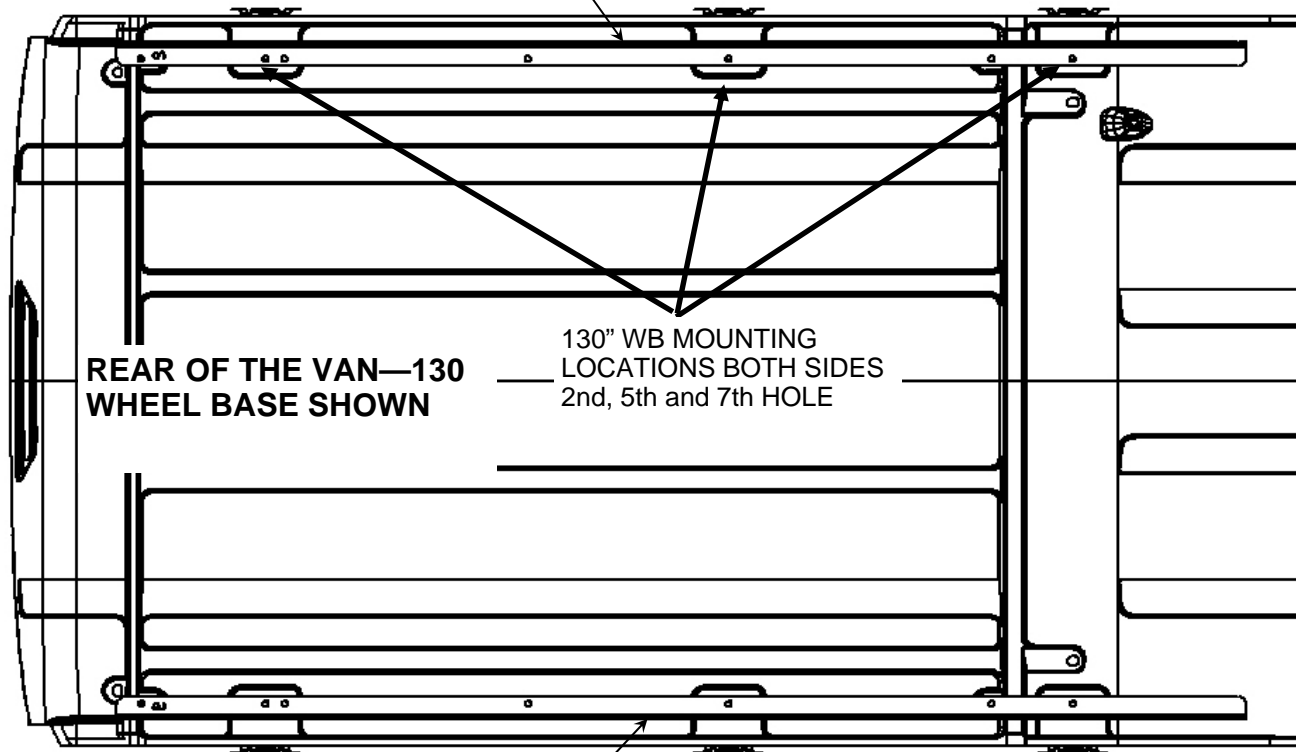

**REAR OF THE VAN—130
WHEEL BASE SHOWN**

130" WB MOUNTING
LOCATIONS BOTH SIDES
2nd, 5th and 7th HOLE

52037 CURB SIDE ROOF RAIL
TOE UP TO THE OUTSIDE

52036 STREET SIDE ROOF RAIL
TOE UP TO THE OUTSIDE

REAR OF VAN

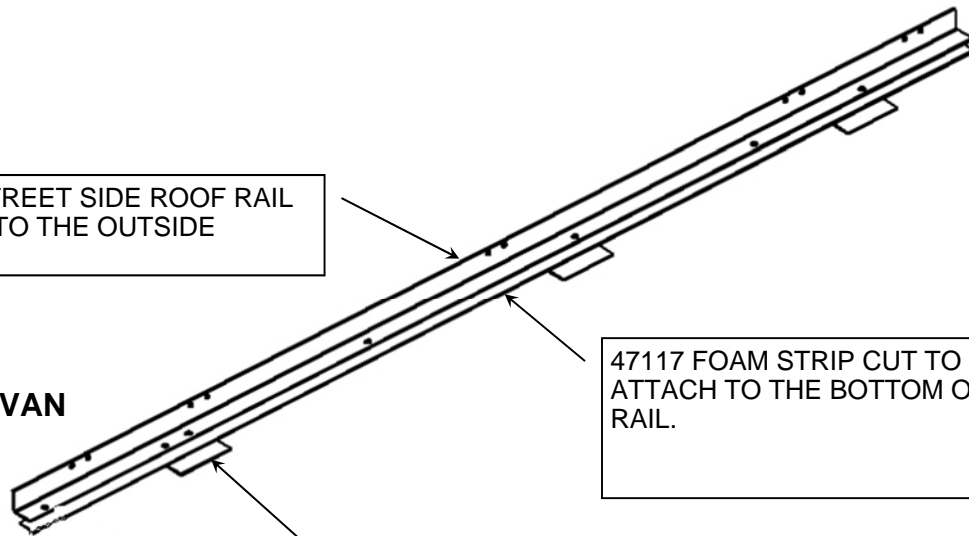

47117 FOAM STRIP CUT TO 95" AND
ATTACH TO THE BOTTOM OF THE
RAIL.

52710, PLACE THE 3/8 THICK RUBBER
SPACER UNDER EACH HOLE TO BE
USED AS SHOWN.



STEP #1 : PREP ROOF RAILS—148 WHEEL BASE

52036 STREET SIDE ROOF RAIL
TOE UP TO THE OUTSIDE

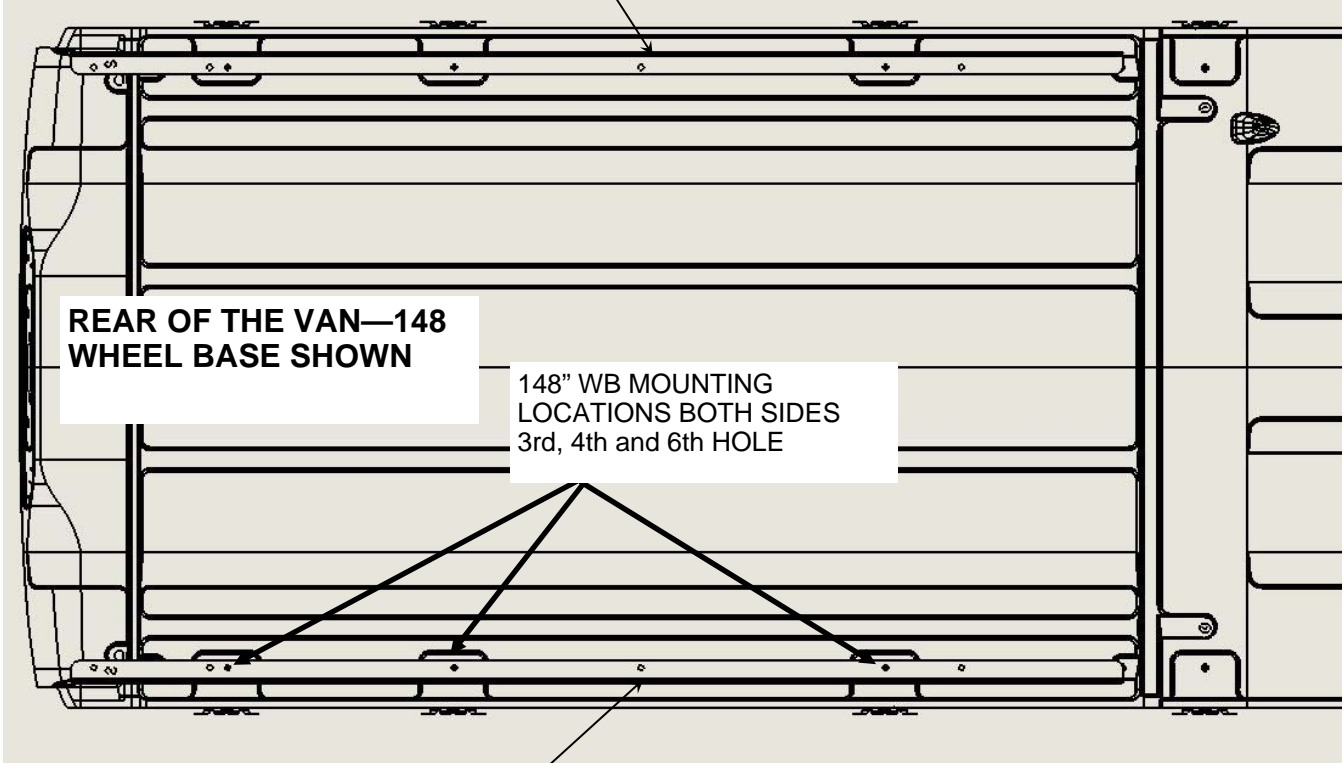

**REAR OF THE VAN—148
WHEEL BASE SHOWN**

148" WB MOUNTING
LOCATIONS BOTH SIDES
3rd, 4th and 6th HOLE

52037 CURB SIDE ROOF RAIL
TOE UP TO THE OUTSIDE

52036 STREET SIDE ROOF RAIL
TOE UP TO THE OUTSIDE

REAR OF VAN

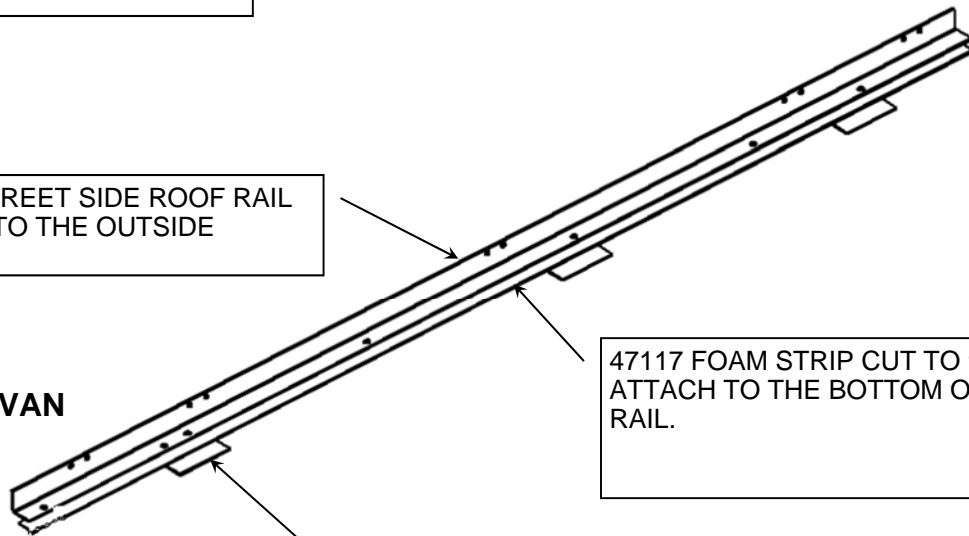

47117 FOAM STRIP CUT TO 95" AND
ATTACH TO THE BOTTOM OF THE
RAIL.

52710, PLACE THE 3/8 THICK RUBBER
SPACER UNDER EACH HOLE TO BE
USED AS SHOWN.



STEP #2 : ASSEMBLE REAR CROSS BOW TO THE ROOF RAILS

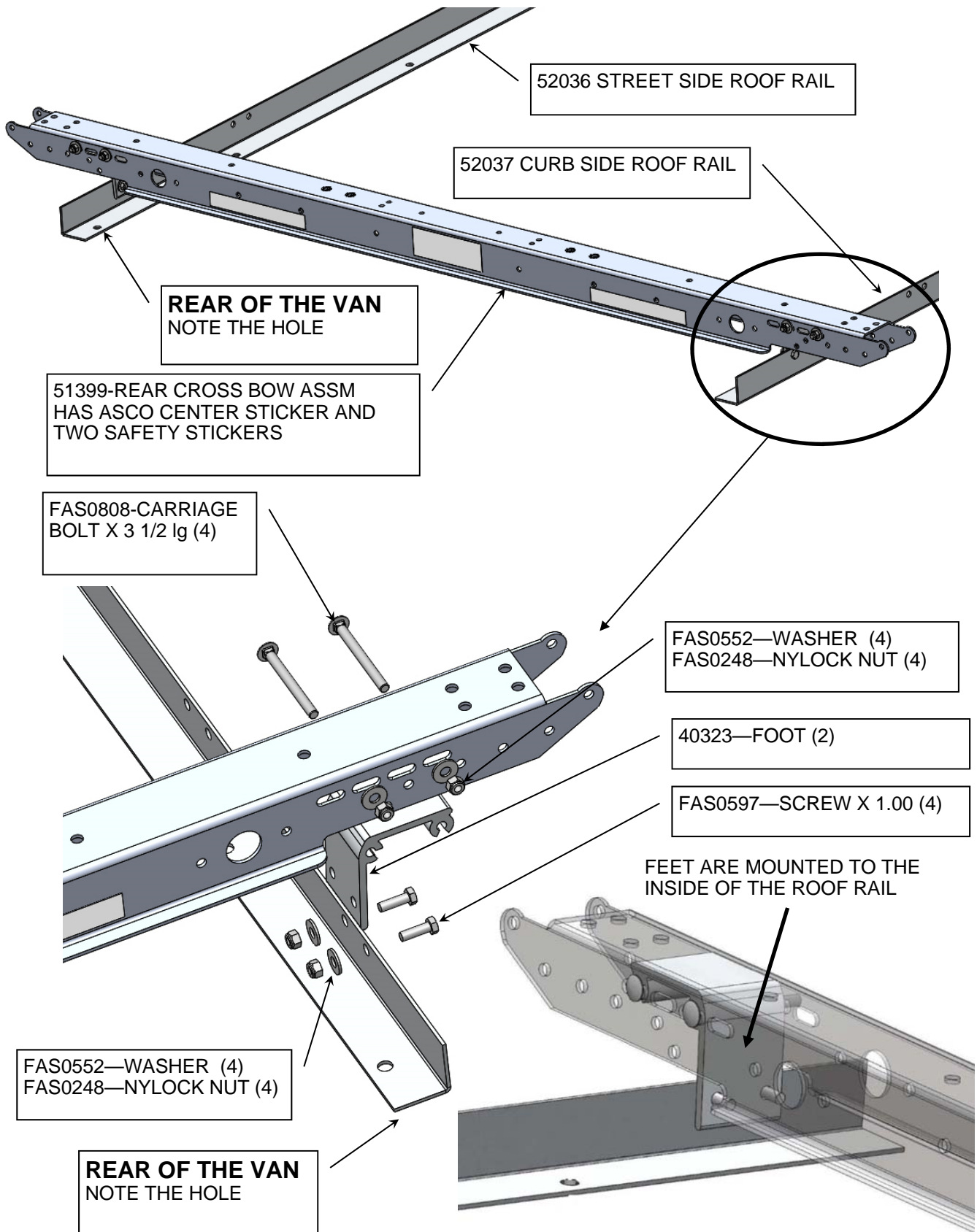



STEP #3 : ASSEMBLE FRONT CROSS BOW TO THE ROOF RAILS

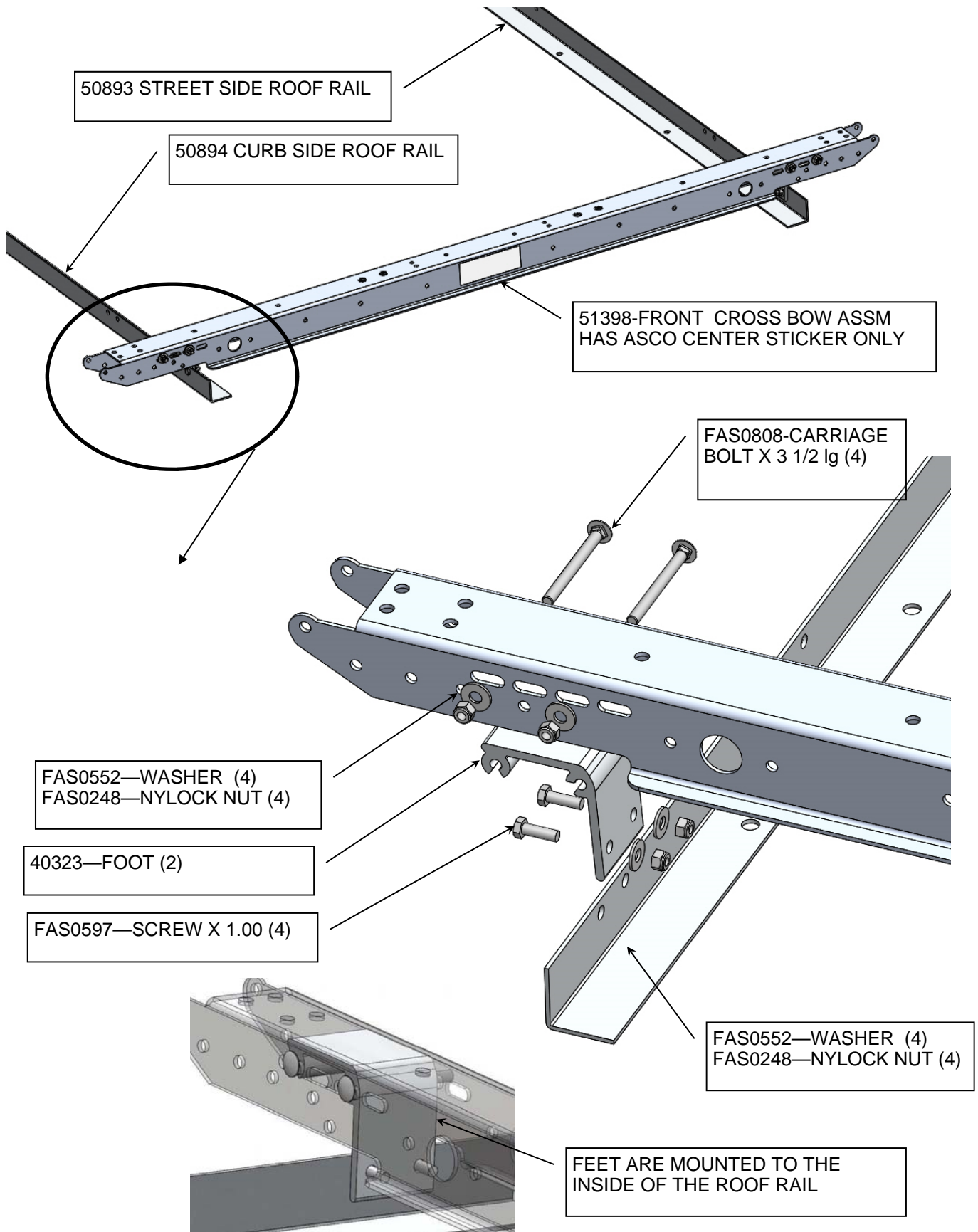



**STEP #4 : FOLLOWING THE DROP DOWN INSTURCTIONS,
ASSEMBLE WHAT YOU CAN PRIOR TO INSTALLING ON THE VEHICLE.
BELOW ARE A FEW EXAMPLES.**

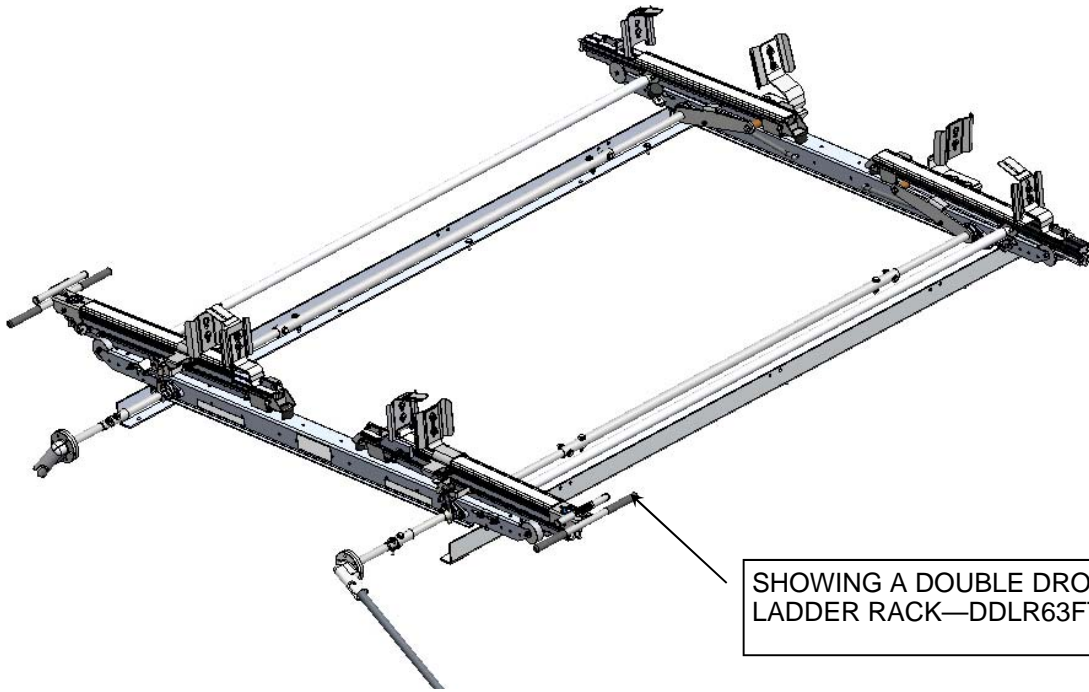

SHOWING A DOUBLE DROP DOWN
LADDER RACK—DDL63FTM

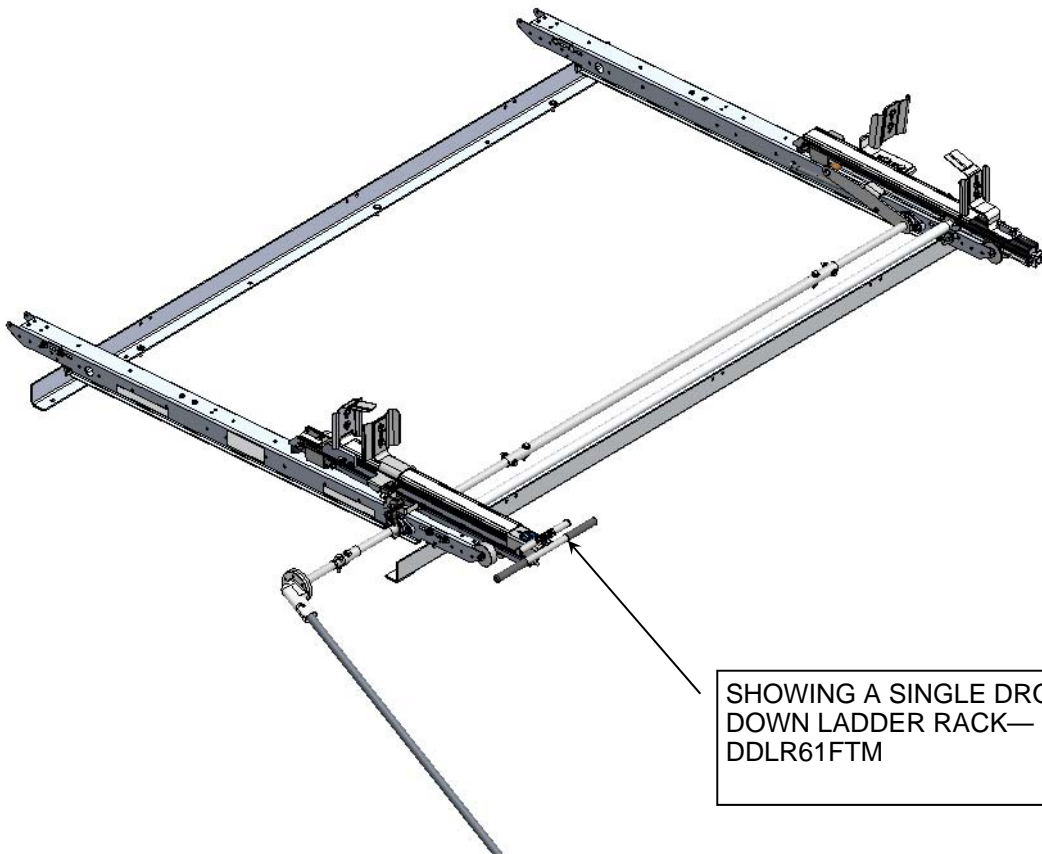

SHOWING A SINGLE DROP
DOWN LADDER RACK—
DDL61FTM

STEP #5 INSTALL RACK ON VEHICLE

REMOVE PLASTIC PLUGS FROM SQUARE DEPRESSIONS ONLY. THESE ARE THE FACTORY MOUNTING POINTS. DO **NOT** REMOVE OTHER PLUGS!! RUN M8-1.25 TAP, FULL DEPTH, TO CLEAN OUT THREADS IN OEM FASTENER IF NECESSARY. MAY HAVE TO REPEAT PROCESS TO GET FULLY CLEAN.

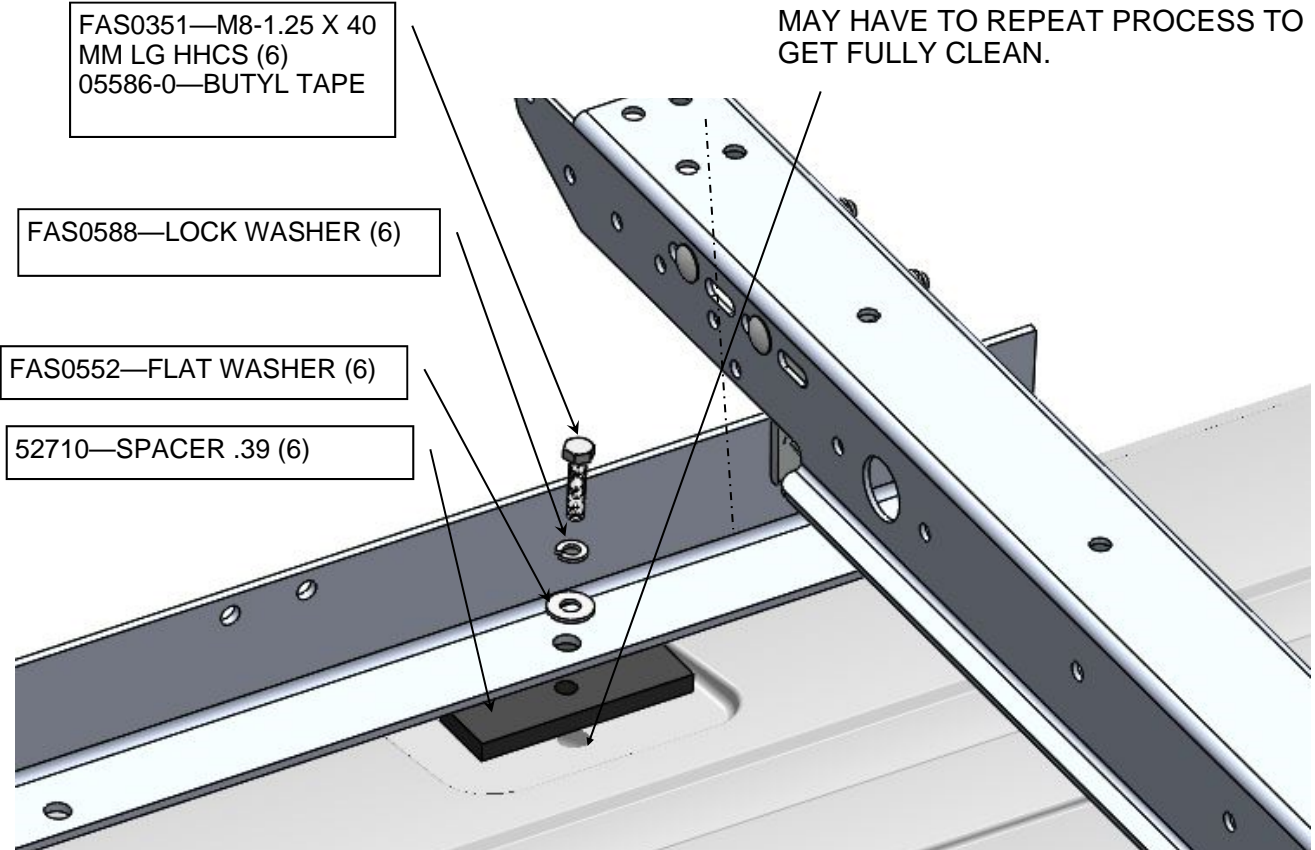

CAREFULLY REMOVE PLASTIC PLUGS FROM FACTORY ATTACHMENT POINTS. NOTE, THEY ARE INSTALLED PRIOR TO VEHICAL BEING PAINTED. IF ROOF CLEARANCE HOLES AND OEM FASTENER ARE MISALIGNED TOO FAR, HOLE IN ROOF SKIN MAY NEED TO BE ENLARGED (AND PRIMERED), AS WELL AS CORRESPONDING HOLE IN ROOF RAIL OF RACK. WRAP SCREWS WITH BUTYL TAPE BENEATH WASHERS, ENOUGH TO FILL HOLE IN RAIL. PUSH SCREWS THRU FOAM, AND RUBBER PAD,ADD ENOUGH SILICONE TO FILL EACH CAVITY. INSTALL SCREWS AND WASHERS AS SHOWN. TORQUE TO 10 TO 12 FT LBS. TORQUE ALL FASTENERS ON RACK ITSELF TO 10-12 FT LBS. DO NOT OVER-TORQUE AS THESE ARE STAINLESS STEEL FASTENERS!



MOUNTING SCREW WITH WASHERS AND BUTYL TAPE BEFORE INSTALLATION (LEFT) AND WHAT IT SHOULD LOOK LIKE AFTER INSTALLATION (RIGHT).

