

ITEM	PART NO.	DESCRIPTION	QTY.
A	FAS0056	1/4-20 HEX FLANGE NUT	4
B	FAS0139	1/2" FLAT WASHER DC	2
C	FAS0299	1/2-13 LOCK NUT	2
D	FAS0302	1/2-20 X 2" HEX HEAD BOLT	2
E	FAS0509	1/4-20 X 1-5/8 X 2" U-BOLT SS	2
1	19597-0	MOUNT PLATE	2
2	19598-0	BEARING	2
3	19599-0	PIPE - SCHED 40 / 1-11/16 X 57"	1

RR5
ASSIST ROLLER
 (VP1 CARGO RACK)

CHECKED BY	DRAWN BY	ECN #	DATE	PACKAGE #	ISSUE
<i>[Signature]</i>	JLC	12861	4/26/10	RR5	C
PACKAGE WEIGHT:	11.00	#	ACCESSORY WEIGHT:	#	

ADRIAN STEEL
 906 JAMES ST. ADRIAN MI. 49224
 (517) 265-6194

ASSEMBLY & INSTALLATION INSTRUCTIONS

- 1) Assemble Bolt (Item-D), Washer (Item-B), Mount Plate (Item-1), Bearing (Item-2), and Nut (Item-C) together as shown.
- 2) Insert the Bearings of these assemblies fully into ends of Pipe (schedule 40) as shown
- 3) Once the Bearings are inserted into each end of the Pipe (schedule 40), place the assembly onto the rear crossbar of the VP1 Cargo Rack and attach it to the rear crossbar by sliding the U-Bolts (Item-E) from underneath capturing the rear crossbar (VP1) and up through the Mount Plate (Item-1). Then, loosely attach the Flange Nuts (Item-A) to the U-Bolts (Item-E) to hold them in place.
- 4) Next center the whole assembly on the rear crossbar (VP1) side to side and then firmly tighten down the Flange Nuts (Item-A) onto the U-Bolts (Item-E). * NOW YOU ARE FINISHED *

REAR CROSSBAR (VP1 RACK)

DETAIL B
 SCALE 1 : 2
 Showing right side of assembly at Step #2

DETAIL A
 SCALE 1 : 2
 Showing left side of assembly at Step #1

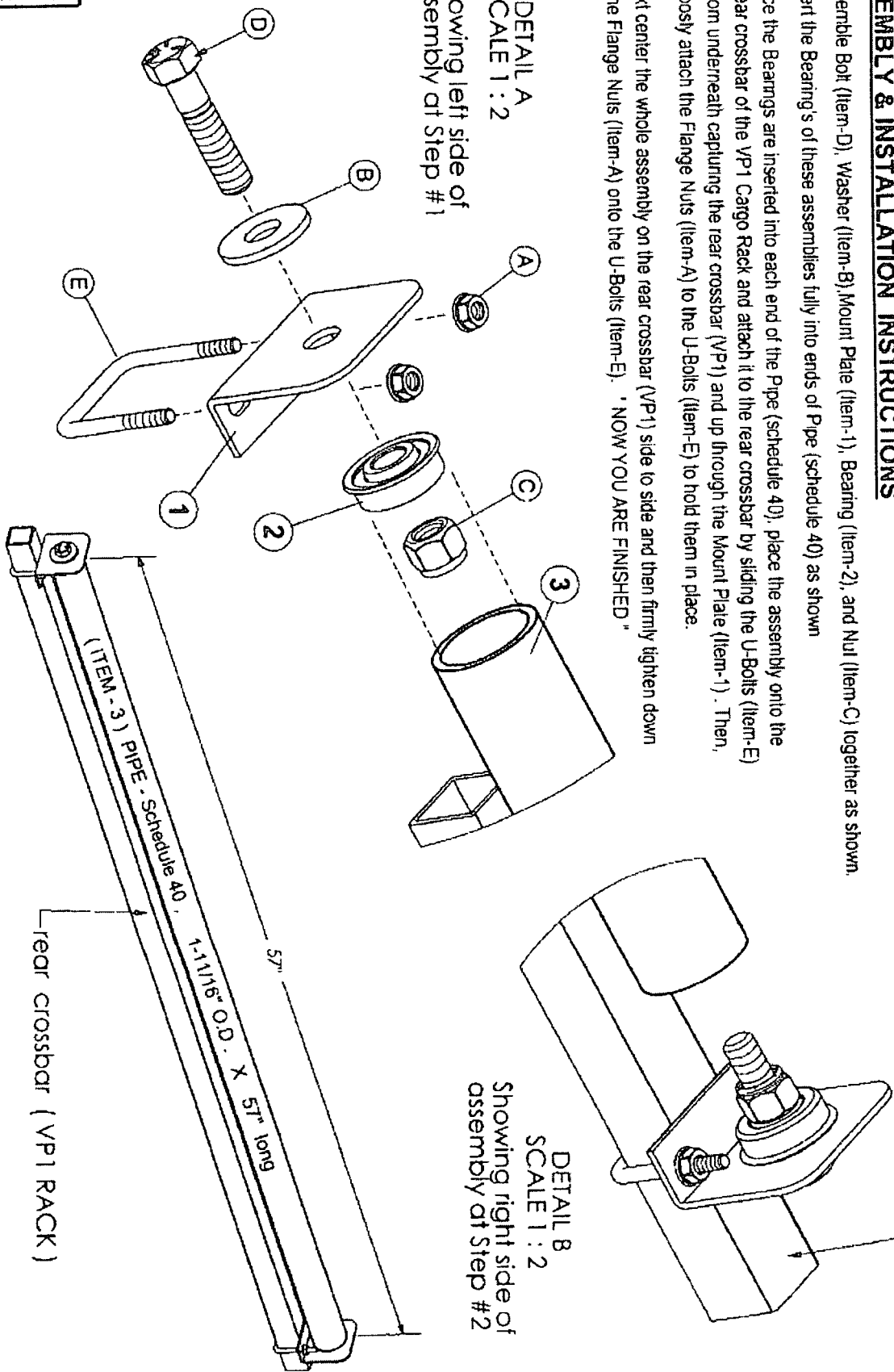

RR5
 DRAWING