

PART NUMBER

15372-0

**ITEM DESCRIPTION: FIRST AID KIT, CINTAS**

MANUFACTURER: CINTAS CORP.  
 MANUFACTURERS PART NUMBER: 600587

SPECIFICATIONS:      KIT INCLUDES:  
 (1) EMERGENCY FIRST AID POCKET GUIDE, (1) ½"X5YD.TAPE, (1) EYE WASH 4OZ., (1) ELASTIC GUAZE 2"X4.5YD., (1) DISPOSABLE FORCEPEP,  
 (1) WOUND SEAL, (2PR) NITRILE GLOVES, (1) 3-1 ANTIBIOTIC OINTMENT  
 (1) WATERJEL BURN PAK, (1) ICE PACK SMALL, (1) 40" TRANGULAR BANDAGE,  
 (1) 4" COMPRESS BANDAGE, (10) FINGERTIP BANDAGES, (10) KNUCKLE BANDAGES, (16) PLASTIC 1"X3" BANDAGE, (1) 2OZ ANTISEPTIC SPRAY,  
 (10) CLEAN WIPES, (4) 3"X3" GUAZE PADS, (1) METAL KIT BOX.

SPECIAL NOTES: N/A

**SUPPLIED BY: THIS ITEM IS ADRIAN AVAILABLE!**

### PURCHASED PRODUCT DATA SHEET (PPDS)

THIS DRAWING/INFORMATION IS THE PROPERTY OF ADRIAN STEEL COMPANY AND IS NOT TO BE USED IN ANY MANNER THAT IS DETRIMENTAL TO THE INTEREST OF ADRIAN STEEL. COPYRIGHTS AND OR PATENTS THAT MAY BE THE PROPERTY OF APPLICABLE OWNERS MAY PROTECT INFORMATION AND/OR DRAWINGS OF SUPPLIED PRODUCTS.



906 JAMES STREET  
 ADRIAN, MI 49221  
 517-265-6194  
 WWW.ADRIANSTEEL.COM



**WHEN INSTALLING EQUIPMENT IN OR ON VEHICLES CHECK FOR FUEL TANKS, FUEL LINES, CONTROL LINES AND ELECTRICAL WIRING BEFORE DRILLING! ALWAYS USE DRILL BITS WITH INTEGRAL STOPS WHENEVER POSSIBLE!**

DRAWN BY  
BDS

DATE DRAWN  
10/13/2009

ECN NUMBER  
16168

ECN DATE  
06/29/2016

PART WEIGHT  
3.11 LBS.

REV. LEVEL  
C

PART NUMBER

**15372-0**

**Introduction / Comments:**

This Ladder Holder & Tote Rack Asm is designed to fit in your GM/Chevrolet 135" WB Van, Curb side mounting only. This ladder holder will hold your 5 foot or 6 foot standard ladder securely in place.

**Note:**

It is advised that all fasteners used in this assembly and installation should be checked for tightness at the following intervals: @ 2-weeks and again @ 6-weeks of operation. This preventive maintenance step must be completed to ensure your Partition gives you long service life.

ITEM NO.	PART NUMBER	DESCRIPTION	LHTOTEGM/QTY.
1	52473	Ldr Shelf Asm, LHTOTEGM	1
2	CHPPC5SM	Case Holder, PPCS	1
3	15372-0	FIRST AID KIT, CINTAS	1

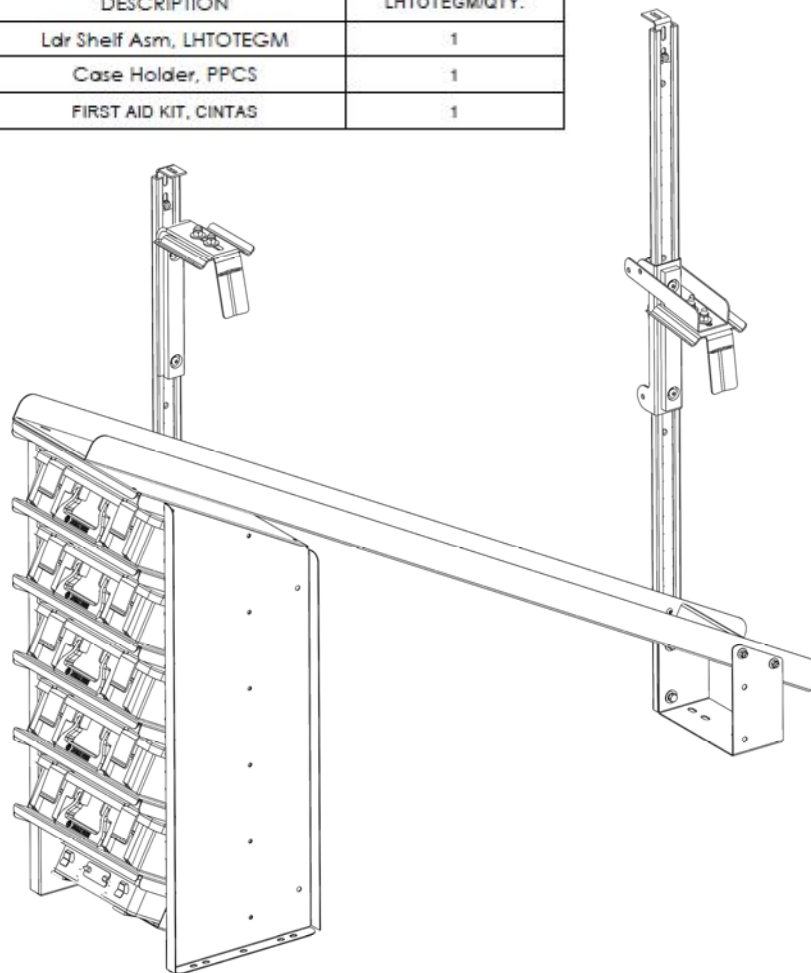

**LHTOTEGM  
LADDER HOLDER & TOTE RACK ASM.  
GM/CHEVY 135"WB**

## - PRECAUTIONS -





 **CAUTION**   
**THE USE OF AIR IMPACT TOOLS CAN  
OVER-TORQUE FASTENERS AND  
CAUSE FASTENER FAILURE!**





 **CAUTION**   
**ALL INSTALLATION HOLES SHOULD BE SEALED  
WITH SILICON OR BUTYL SEALANT TO PREVENT  
EXHAUST FUMES FROM ENTERING THE VEHICLE!**



 **DANGER**   
**INSPECT FOR FUEL TANK, FUEL LINES, BRAKE LINES, HIGH  
VOLTAGE BATTERIES AND ELECTRICAL LINES PRIOR TO  
DRILLING TO AVOID DAMAGING CRITICAL VEHICLE SYSTEMS  
OR INJURY TO INSTALLER DURING INSTALLATION PROCESS!**



 **CAUTION**   
**TO AVOID DAMAGING THE VEHICLE ALWAYS USE DRILL  
STOPS WHEN DRILLING ANY INSTALLATION HOLES!  
ADRIAN AVAILABLE PART #'S 31121-0 (1/2" DEEP),  
31122-0 (3/4" DEEP)**



## - IMPORTANT WARRANTY REQUIREMENTS -

1. SUBSTITUTING ADRIAN STEEL SPECIFIED FASTENERS FOR ASSEMBLY AND/OR INSTALLATION WILL VOID YOUR PRODUCT WARRANTY.
2. ALL HOLES DRILLED INTO VEHICLE SHOULD HAVE THE RAW METAL EDGES SEALED WITH A SELF-ETCHING PRIMER TO RESIST CORROSION AND POTENTIAL FASTENER POINT FAILURE.
3. ALL FASTENERS USED IN THE INSTALLATION OF THIS PRODUCT SHOULD BE TIGHTENED TO THE TORQUE(S) SPECIFIED IN THESE INSTRUCTIONS.
4. THESE INSTRUCTIONS SHOULD BE KEPT WITH THE VEHICLE.

### THE BASIC TOOLS NEEDED FOR MOST INSTALLATIONS



DRILL



DRILL BIT WITH  
STOP



RATCHET, SOCKETS  
AND/OR WRENCHES



SCREWDRIVERS



MEASURING TAPE

ADDITIONAL TOOLS MAY BE NEEDED FOR THIS INSTALLATION AND THEY WILL BE IDENTIFIED IN THE STEPS THAT FOLLOW.

If your vehicle contains carpet or a rubber floor mat you will need to prepare the mounting location. Position the product to be installed into the vehicle and once you are satisfied with the mounting locations, mark the mounting locations. Using a 1-3/16" diameter carpet cutter (P/N: 31183-0). Select the appropriate floor spacers as shown in the illustration. Set those aside for use later into the installation process.

Using the correct drill bit size for the selected plusnut, drill the mounting holes in the vehicle sheet metal to prepare for installing the plusnuts.

If you are thru-bolting at any of the locations simply drill a hole that is 1/16" larger than the bolt size(s) for those locations.

Once you have drilled the holes into the vehicle, the raw metal edges should be sealed using a self-etching primer to resist corrosion and potential fastener point failure.

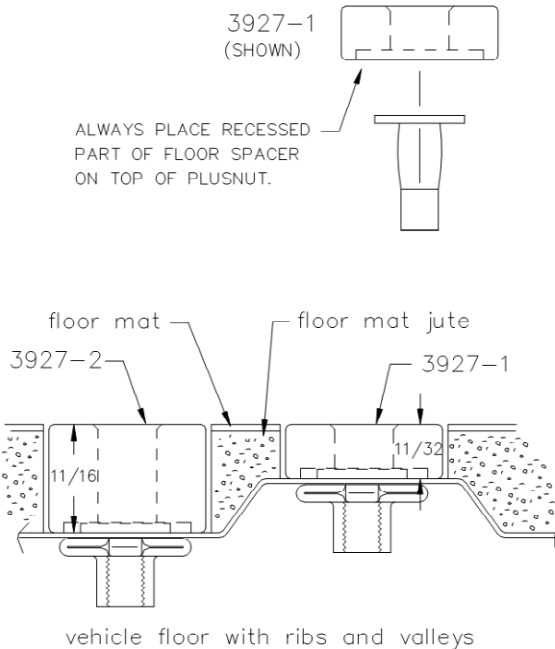

A PLUSNUT (RIVNUT) SETTING TOOL IS REQUIRED FOR PLUSNUT (RIVNUT) INSTALLATION AND IS NOT SUPPLIED WITH THIS KIT. OR USE AN AIR POWERED PLUSNUT SETTING GUN.

1/4-20UNC Plusnut (FAS0052) Use 3/8" dia. drill w/stop  
 FAS0080 SCREW, HXHD, 1/4-20UNCx2.00", G8  
 FAS0067 WASHER, FLAT, 1/4"ID  
 22200-0 PLUSNUT TOOL

5/16-18UNC Plusnut (FAS0091) Use 1/2" dia. drill w/stop  
 FAS0095 SCREW, HXHD, 5/16-18UNCx2.00", G8  
 FAS0086 WASHER, FLAT, 5/16"ID  
 22200-0 PLUSNUT TOOL

Place barrel of the plusnut body in sheet metal thru hole until flange is flush with sheet metal. Using a 9/16" combination wrench of plusnut tool body and a second hand wrench, ratchet, or air tool, rotate the hex bolt head CW to draw plus nut flanges up (set the plusnut).

## Assembly and Installation Fastener Identification Sheet BAG49645 For Ladder Shelf

ITEM NO.	PART NUMBER	DESCRIPTION	BAG49645/QTY.
1	FAS0668	Screw, Button Hd Hex Soc, 5/16-18X.75, NI-ZN	2
2	FAS0165	Screw, Hex Hd, 5/16-18x.625	10
3	FAS0820	SCREW, BHCS 3/8-16X1.0 SS	4
4	30015-0	THREADED BALL STUD	2
5	FAS0161	Shoulder Bolt,	1
6	FAS0242	Screw, Hex Hd, 5/16-18x1.50 Stainless Steel	3
7	FAS0037	SCREW, BHCS 1/4-20X.625 ZP	10
8	FAS0552	Washer, Flat, 5/16, SST	18
9	FAS0588	Washer, Lock, Split, 5/16, SS	18
10	FAS0104	Washer, Flat, 3/8, NI ZN	4
11	FAS0110	Nut, Hex Nylk 3/8-16 SS W	4
12	FAS0090	Nut, Nylon Insert Lock, 5/16-18, Zi	2
13	FAS0091	Plusnut, 5/16	5
14	10103-0	5/16 Nylon Washer	2
15	FAS0813	Screw, BHCS, 5/16-18X1.00, SS	2
16	BAG0507-A	5" x 7" 3MIL AUTOBAG	1
17	FAS0055	Nut, Hex Flange, Nylock 1/4-20	11
18	FAS0095	Screw, Hex Hd, 5/16-18x2.00, Grade 8	2
19	03927-2	Tall Floor Spacer	2

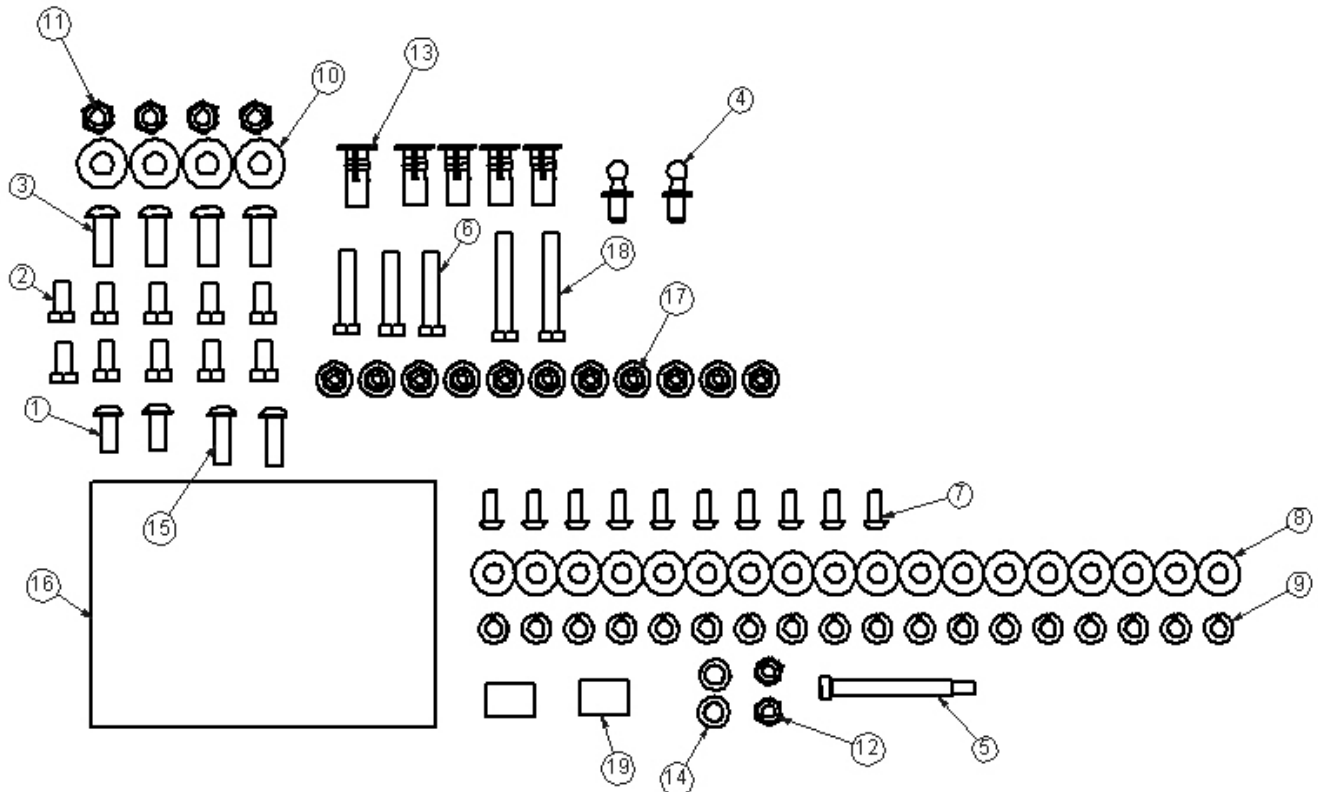

## Assembly and Installation Fastener Identification Sheet BAGCHPPCS For Tote Rack

ITEM NO.	PART NUMBER	DESCRIPTION	BAGCHPPCS/QTY.
1	BAG0406-A	4" x 6" 3MIL AUTOBAG	1
2	FAS0018	SCREW,HH SFLNG 1/4-20X.62 ZP	2
3	FAS0242	Screw, Hex Hd, 5/16-18x1.50 Stainless Steel	1
4	FAS0552	Washer, Flat, 5/16, SST	5
5	FAS0588	Washer, Lock, Split, 5/16, SS	5
6	FAS0091	Plusnut, 5/16	5
7	FAS0055	Nut, Hex Flange, Nylock 1/4-20	2
8	FAS0095	Screw, Hex Hd, 5/16-18x2.00, Grade 8	4
9	03927-2	Tall Floor Spacer	4

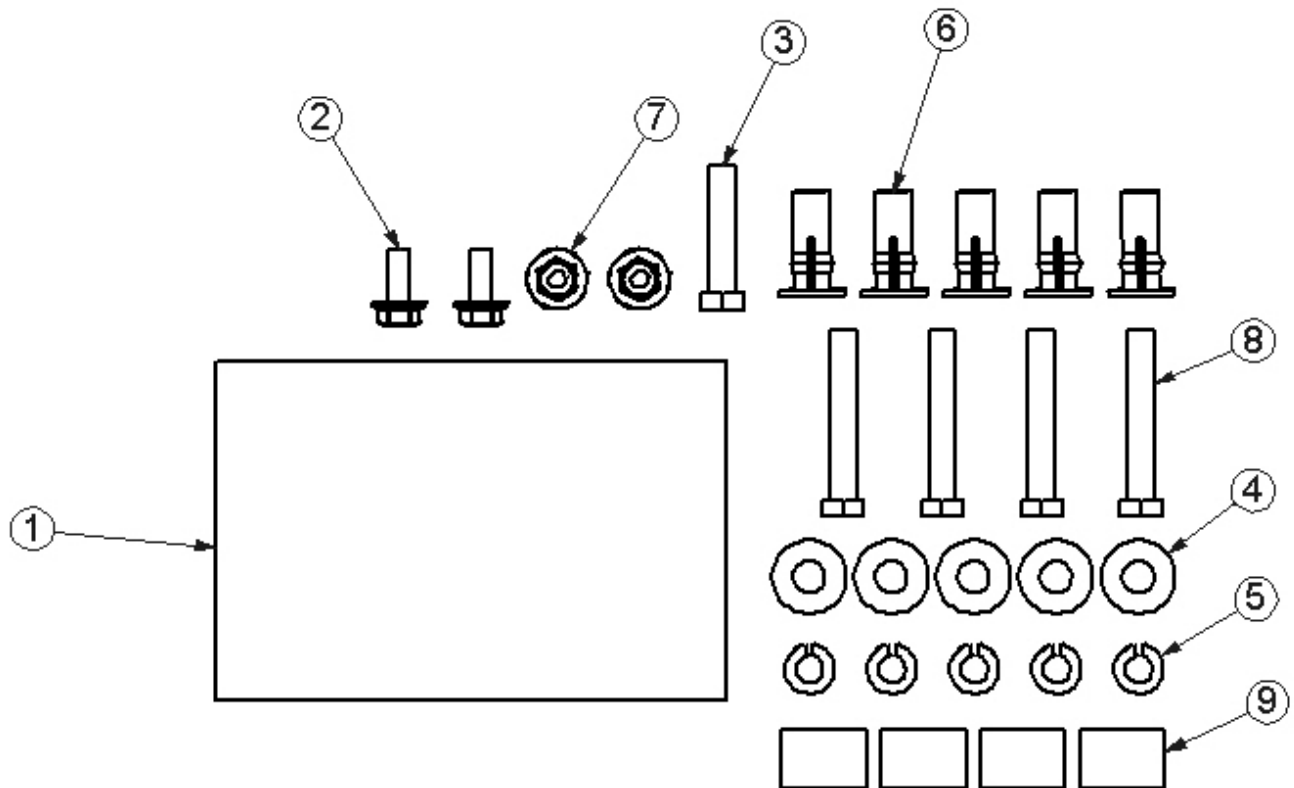

**STEP 01 ASSEMBLE LADDER SHELF & REAR BRACKETRY.**

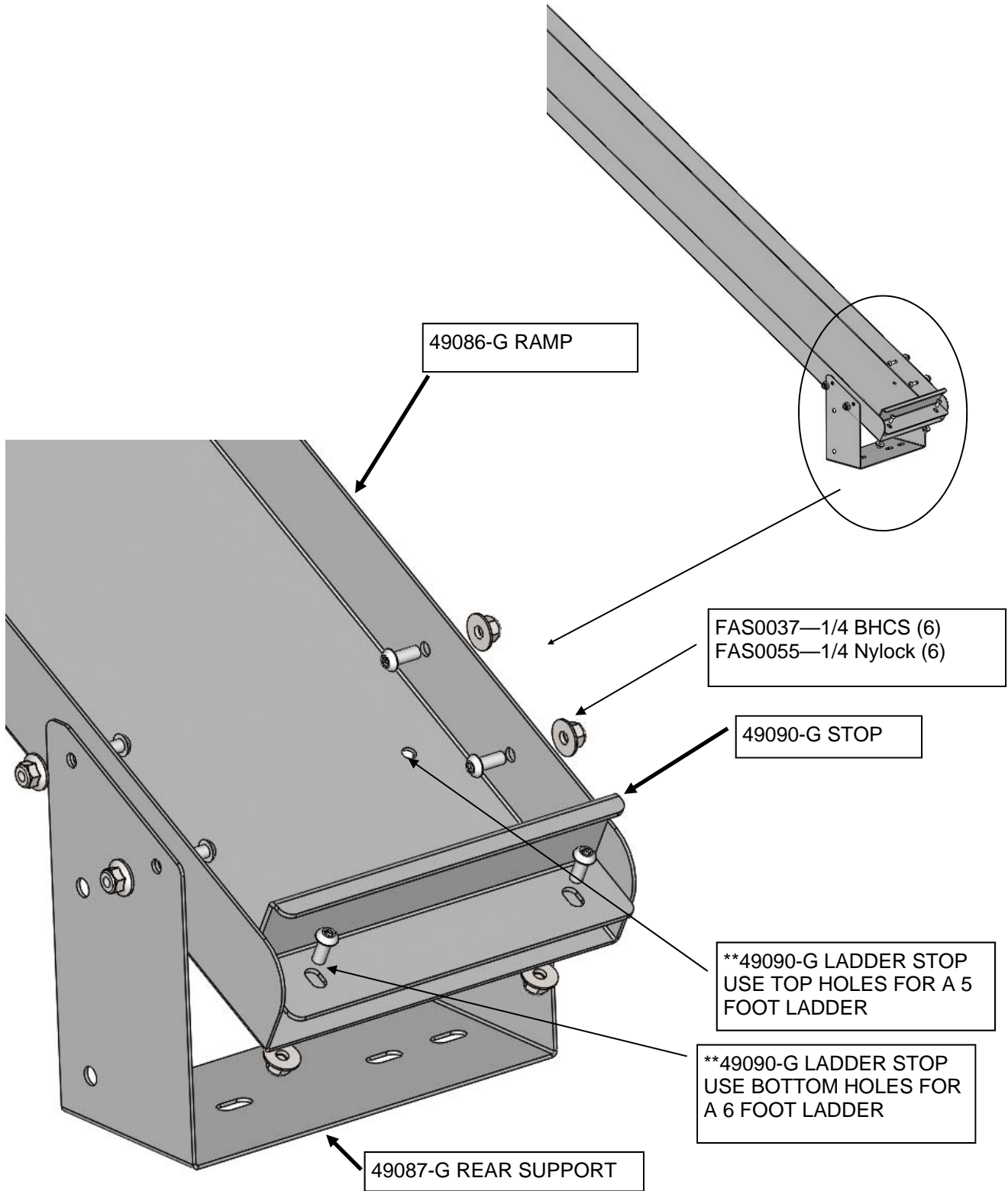

**STEP 02 ON A FLAT TABLE OR FLOOR, ADD 49" LG REAR VERTICAL RAIL**

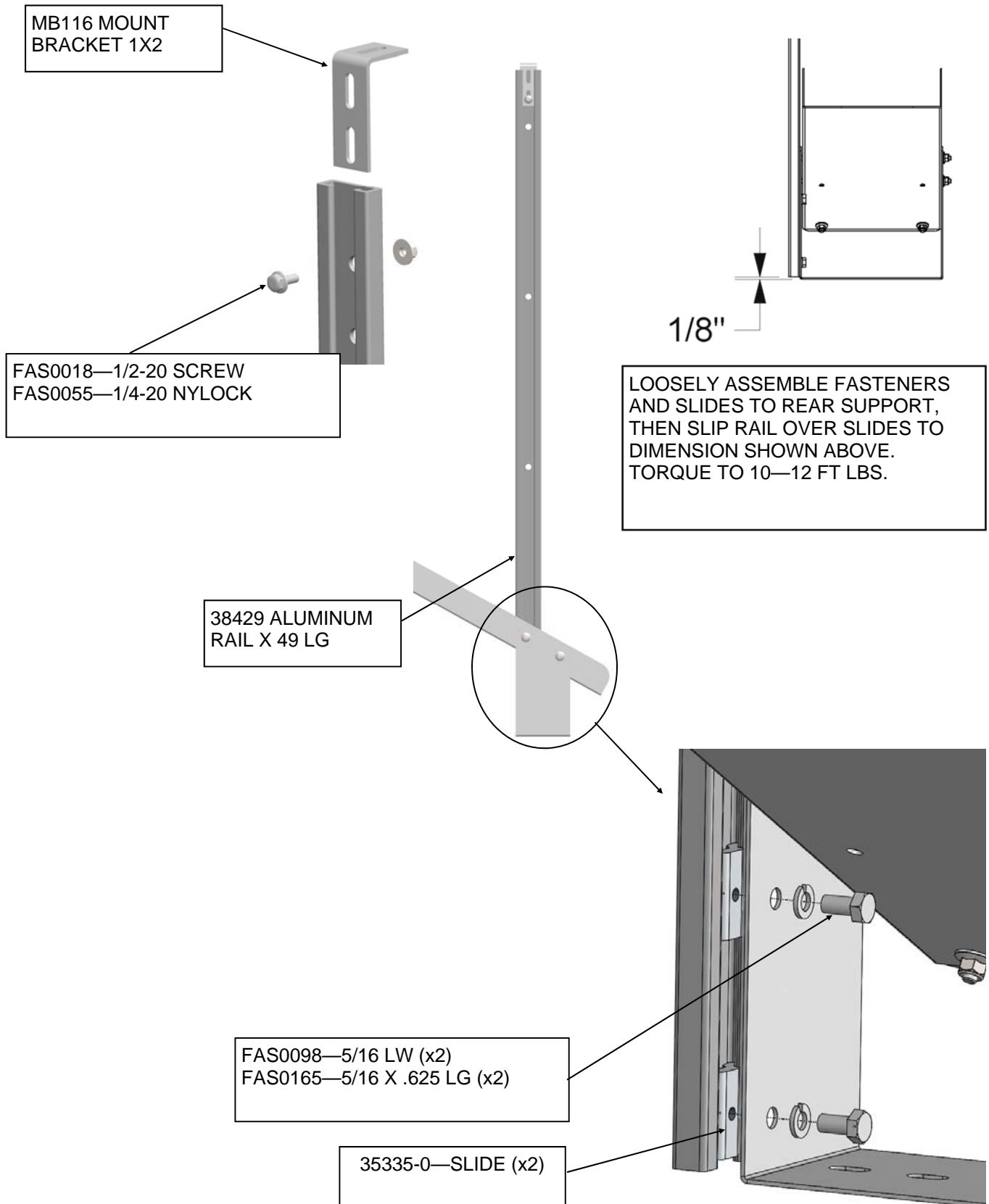



**STEP 03 INSTALL FRONT LADDER STOP**

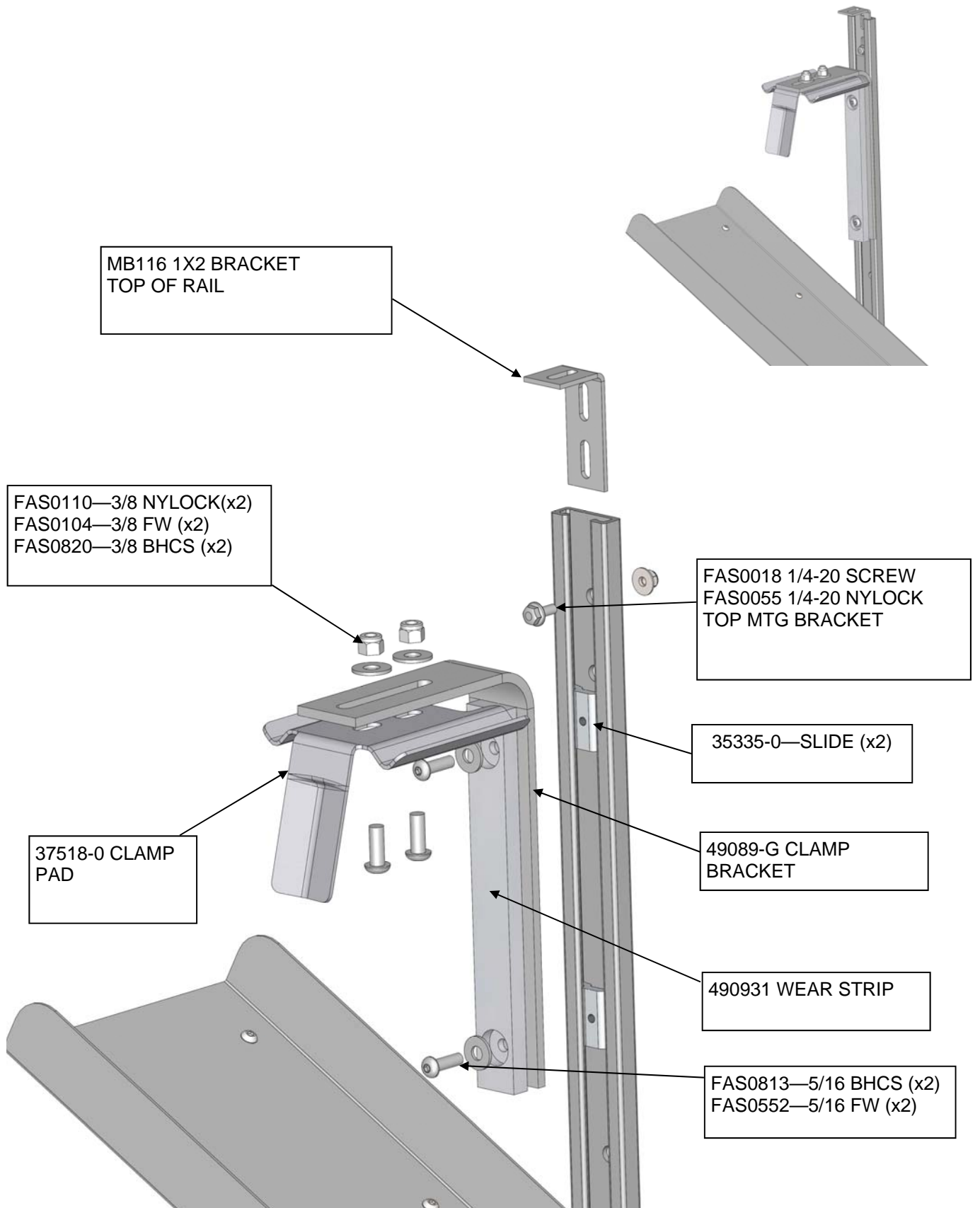

**STEP 04 ASSEMBLE FRONT RAIL TO TOTE RACK**

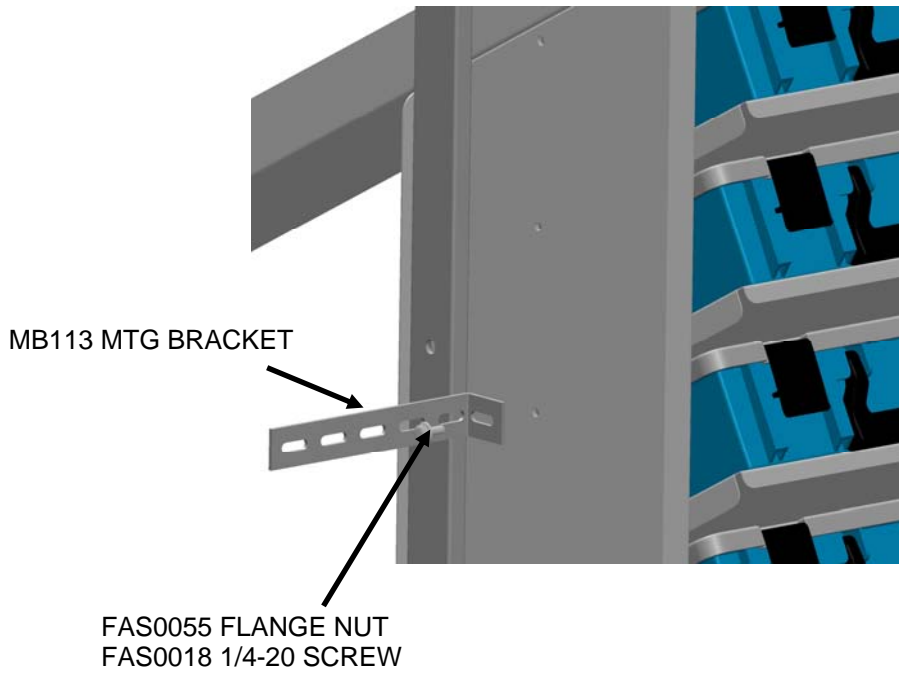

FAS0165 HEX SCREW  
FAS0552 WASHER  
FAS0588 LOCK WSHR  
35335-0 SLIDE  
LOOSELY ASSEMBLE 2 OF EACH TO TOTE  
RACK, THEN SLIDE FRONT RAIL ASSEMBLY  
DOWN OVER SLIDES.  
TIGHTEN FASTENERS TO 10-12 FT LBS.

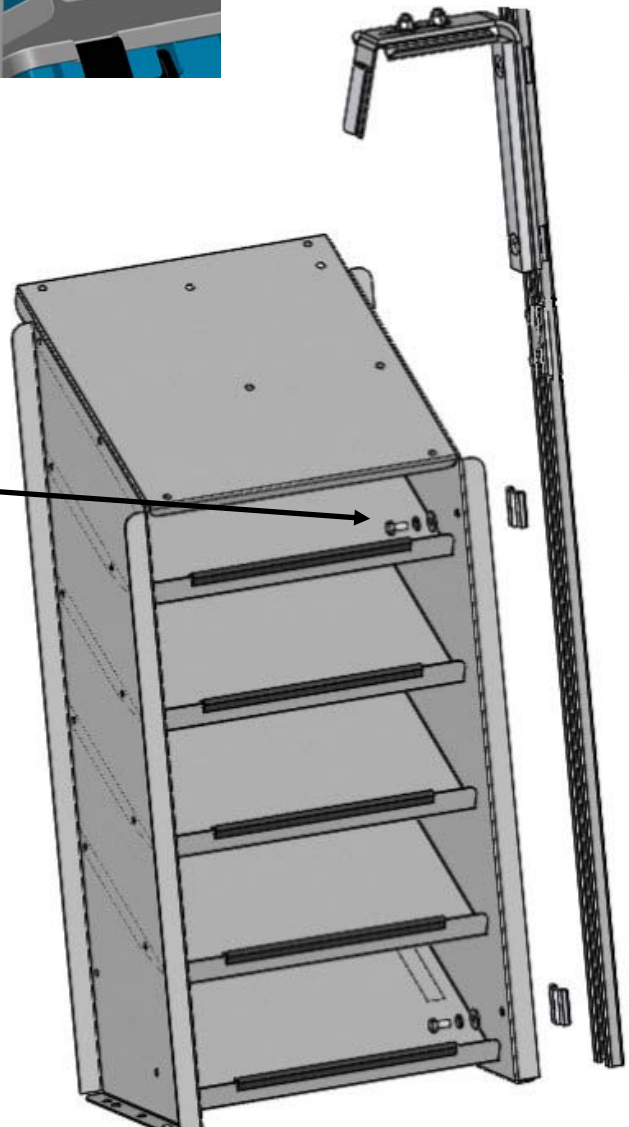

**STEP 05 SUB-ASSEMBLE REAR LADDER CLAMP**

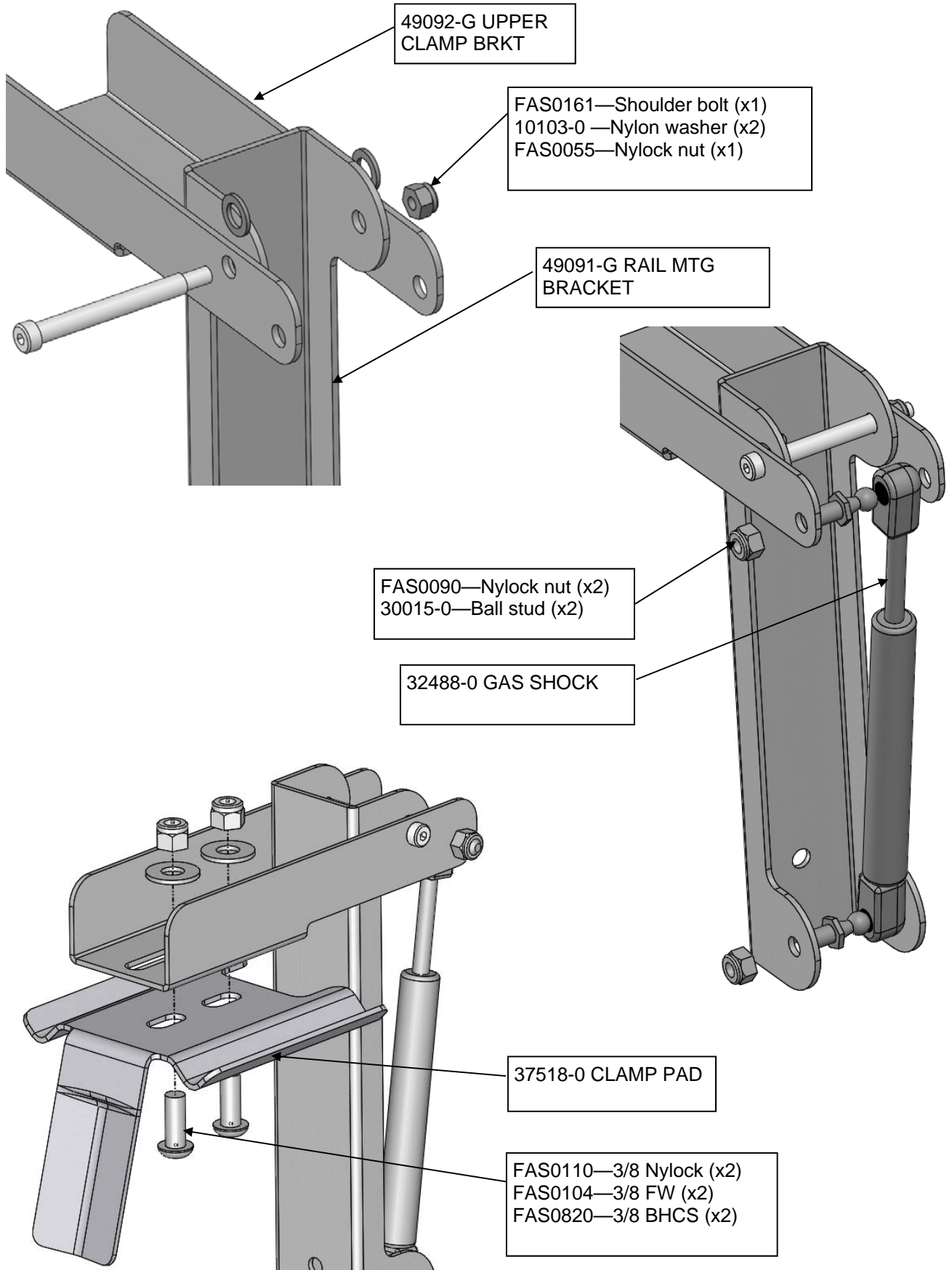

**STEP 06 SUB-ASSEMBLE REAR LADDER CLAMP**

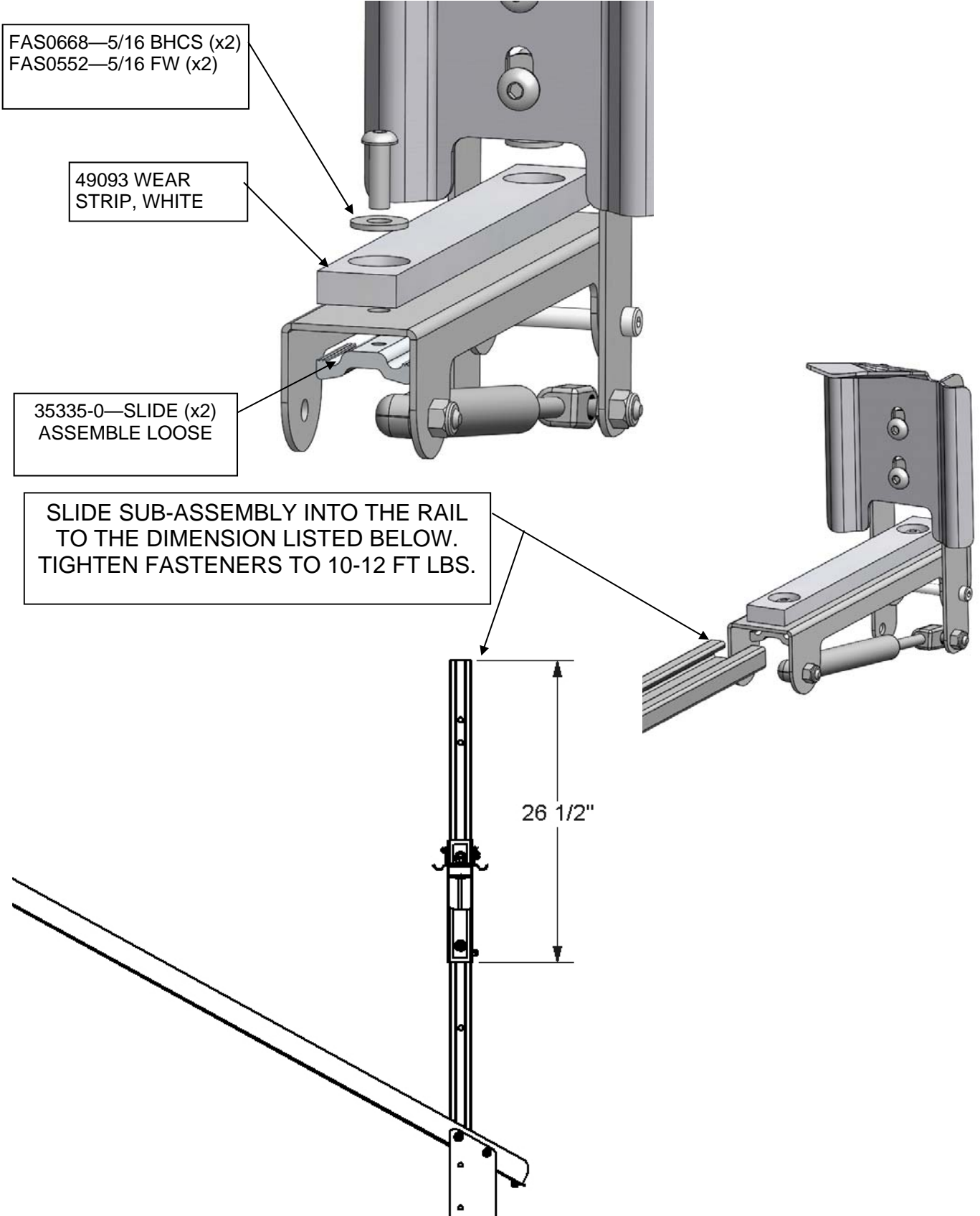

**STEP 07 FINISH ASSEMBLING UNIT.**

ALIGN 4 HOLES IN RAMP WITH 4 HOLES IN TOP OF TOTE RACK. ASSEMBLE WITH : FAS0037 BUTTON HD SCREWS AND FAS0055 HEX FLANGE NUTS, 4 EACH. TORQUE TO 8-10 FT LBS.

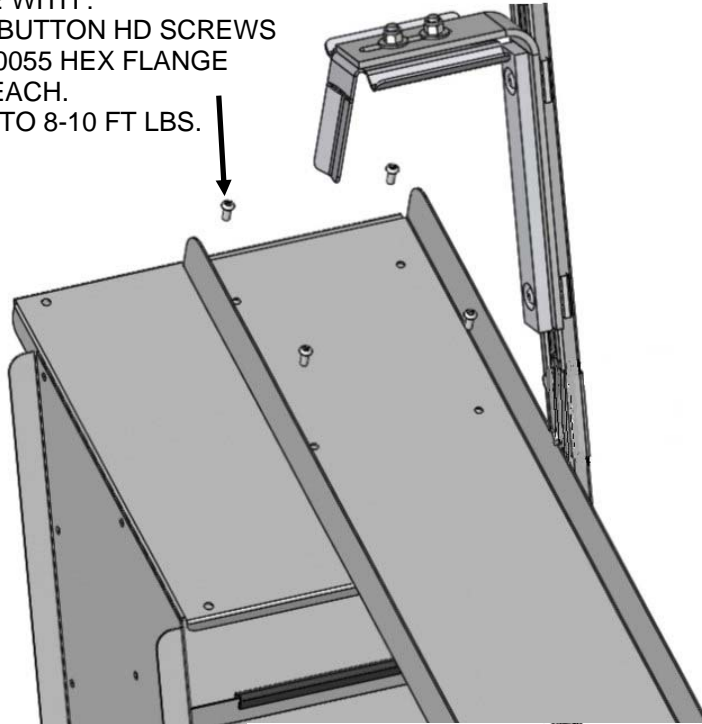

2 PIECES OF 37272-0 TAPE EACH CUT IN HALF. STICK ONE AT FRONT OF RAMP AND EQUALLY SPACE OTHER 3. PLACE SKID PLATE ON AND PRESS DOWN INTO TAPE WITH CHAMFER END UP AND AT FRONT TOP OF ASSEMBLY, HOLES CENTERED OVER SCREWS.

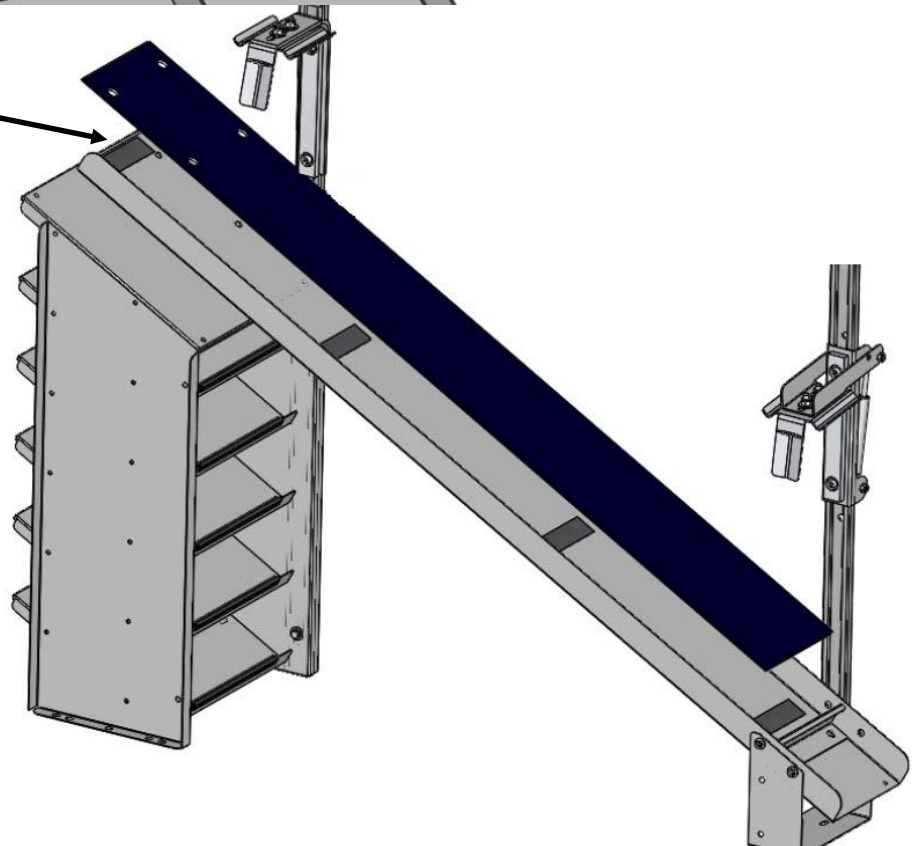



**STEP 08 PLACE UNIT IN VAN. CURB SIDE TO REAR OF SIDE DOOR OPENING.**



MOUNTING BRACKET ON SIDE OF TOTE RACK WILL MOUNT TO C-PILLAR. MARK THIS HOLE AND DRILL 9/32 USING DRILL BIT WITH STOP. ATTACH BRACKET WITH FAS0018 SCREW AND FAS0055 NY-LOCK NUT.



**STEP 09 LOCATE AND SET PLUSNUTS IN THE FLOOR**



MARK FLOOR AT FORWARD MOST AND REAR MOST SLOTS IN END PANELS. FOR END PANEL CLOSEST TO SIDE WALL USE CENTER HOLE AND NEXT HOLE FORWARD. DRILL HOLES AND SET PLUSNUTS AS DESCRIBED BELOW.

ATTACH RACK WITH  
FAS0095 5/16-18X2.0 HEX SCREWS  
FAS0552 WASHERS  
FAS0588 LOCK WASHERS  
4 OF EACH  
TORQUE TO 10-12 FT LBS.

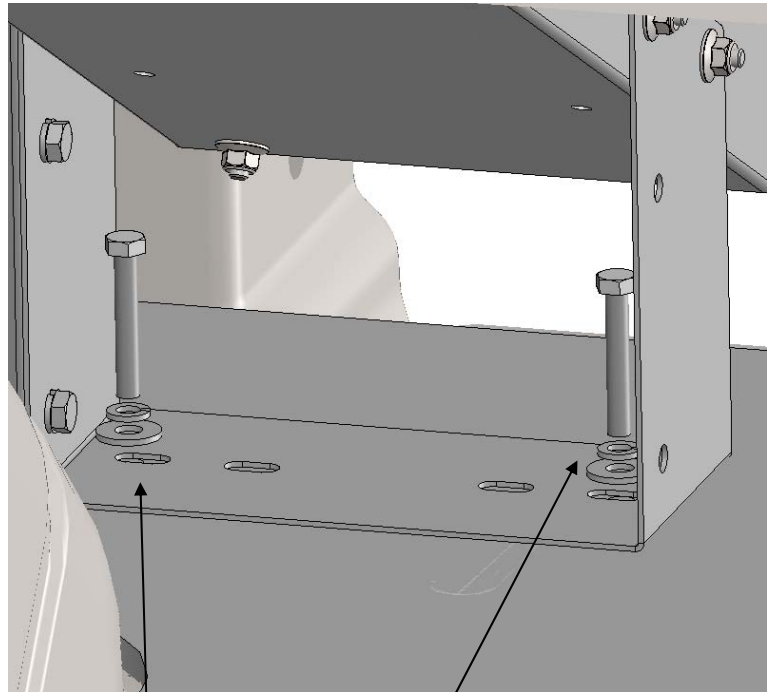

TRANSFER MTG HOLES  
USE CARPET HOLE SAW,  
1/2" DRILL WITH DRILL STOP  
SET PLUSNUT  
FAS0091—5/16 PLUSNUT (2)

FAS0552—5/16 FW (2)  
FAS0588—5/16 LW (2)  
FAS0095—5/16 X 2 LG (2)  
03927-2—TALL SPACER (2)

**STEP 10 LOCATE AND SET PLUSNUTS FOR THE TOP MTG BRACKETS**

FAS0552—5/16 FW (x2)  
FAS0588—5/16 LW (x2)  
FAS0242—5/16 X 1.5 LG (x2)  
TORQUE TO 10-12 FT LBS.

TRANSFER MTG HOLE  
DRILL WITH DRILL STOP  
SET PLUSNUT  
FAS0091—5/16 PLUSNUT (x2)





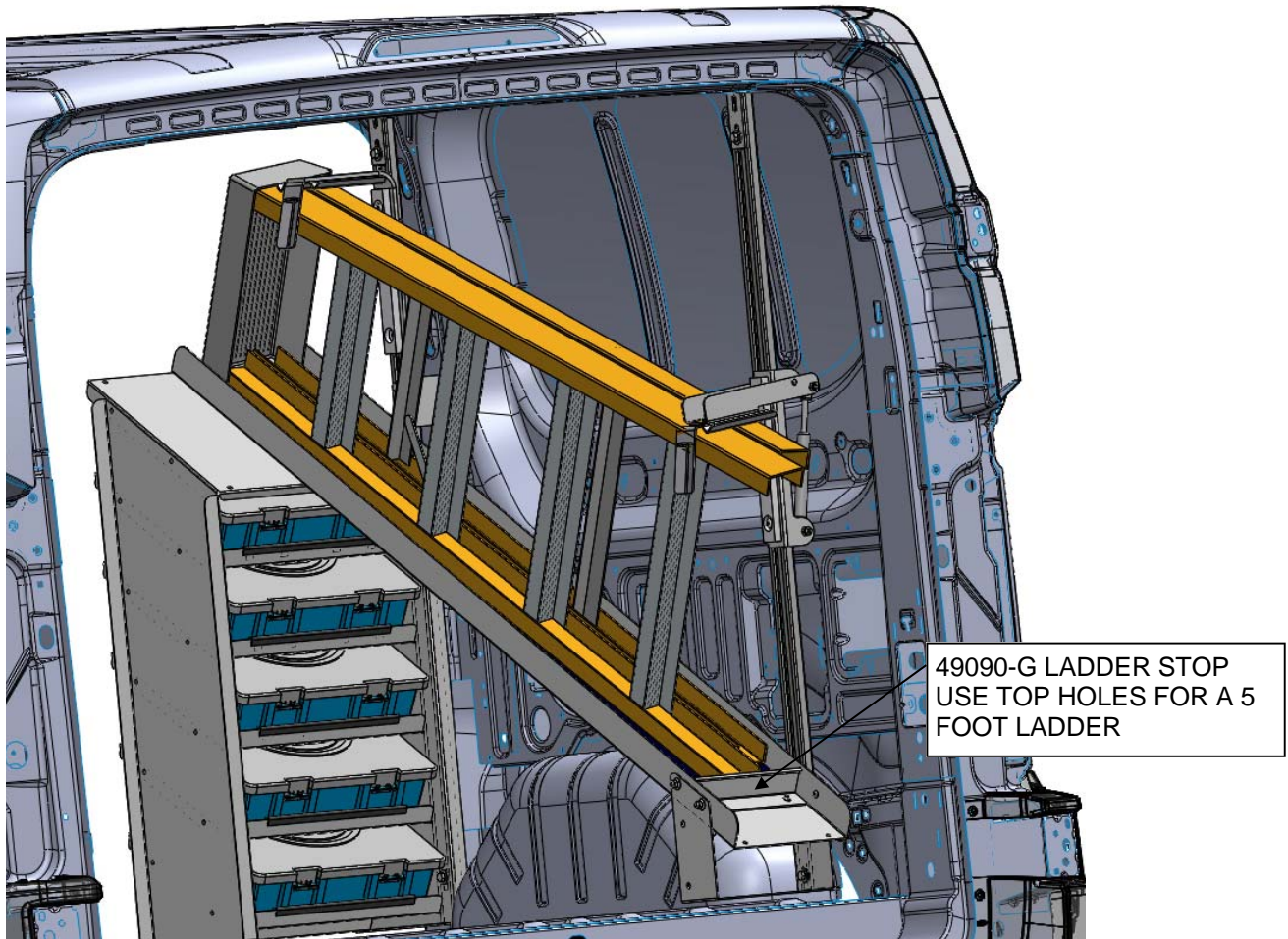
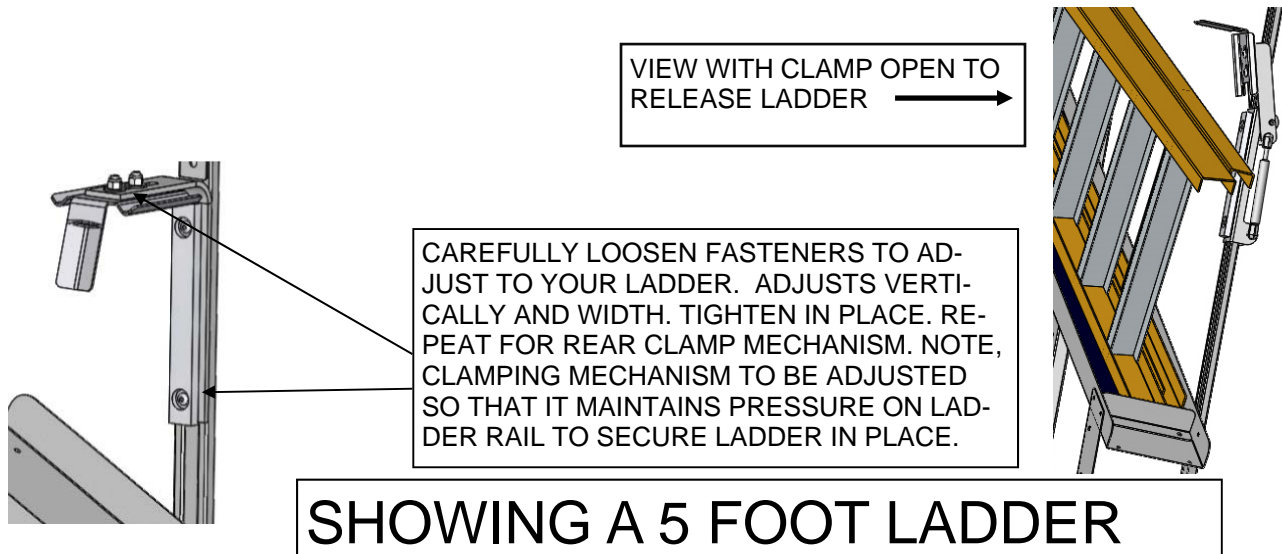

**DOUBLE CHECK ALL FASTENERS LOCATIONS TO BE SURE THAT ALL FASTENERS ARE TIGHTENED TO SPECIFICATIONS.**

**YOUR INSTALLATION IS NOW COMPLETE!**

**STOW THIS COPY IN THE VEHICLE FOR FUTURE REFERENCES!**

**YOUR INSTALLATION IS NOW COMPLETE!**

**Introduction / Comments:**

**Rack for 5 PPCS Small Parts Totes. Will also hold a 15372-0 First Aid Kit in pocket under bottom shelf.**

**Note:**

It is advised that all fasteners used in this assembly and installation should be checked for tightness at the following intervals: @ 2-weeks and again @ 6-weeks of operation. This preventive maintenance step must be completed to ensure your Product gives you long service life.

ITEM NO.	PART NUMBER	DESCRIPTION	QTY.
1	49647-G	RACK WELDMENT	1
2	BAGCHPPCS	FAS BAG, TOTE RACK	1
3	PPCS	PPCS	5

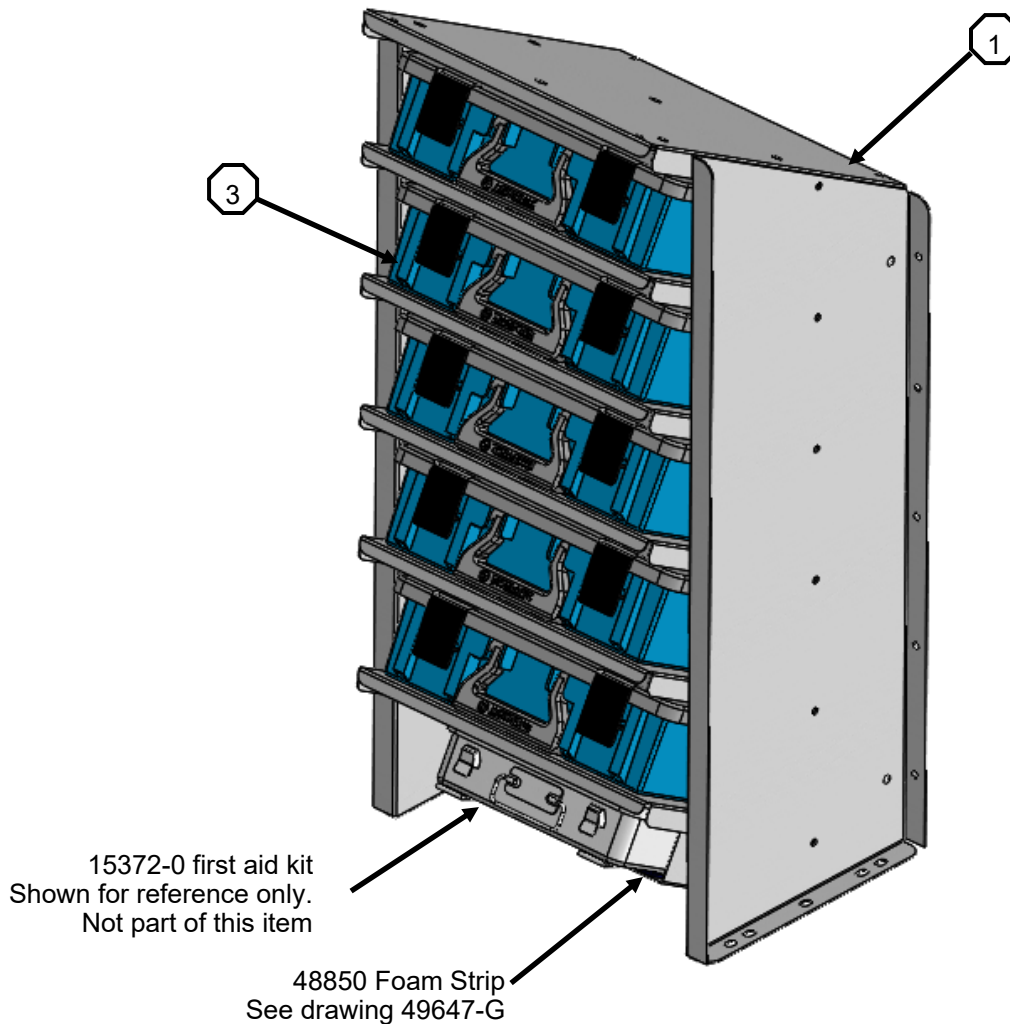

**57195 Tote Rack**

## - PRECAUTIONS -





 **CAUTION**   
**THE USE OF AIR IMPACT TOOLS CAN  
OVER-TORQUE FASTENERS AND  
CAUSE FASTENER FAILURE!**





 **CAUTION**   
**ALL INSTALLATION HOLES SHOULD BE SEALED  
WITH SILICON OR BUTYL SEALANT TO PREVENT  
EXHAUST FUMES FROM ENTERING THE VEHICLE!**



 **DANGER**   
**INSPECT FOR FUEL TANK, FUEL LINES, BRAKE LINES, HIGH  
VOLTAGE BATTERIES AND ELECTRICAL LINES PRIOR TO  
DRILLING TO AVOID DAMAGING CRITICAL VEHICLE SYSTEMS  
OR INJURY TO INSTALLER DURING INSTALLATION PROCESS!**



 **CAUTION**   
**TO AVOID DAMAGING THE VEHICLE ALWAYS USE DRILL  
STOPS WHEN DRILLING ANY INSTALLATION HOLES!  
ADRIAN AVAILABLE PART #'S 31121-0 (1/2" DEEP),  
31122-0 (3/4" DEEP)**



## - IMPORTANT WARRANTY REQUIREMENTS -

1. SUBSTITUTING ADRIAN STEEL SPECIFIED FASTENERS FOR ASSEMBLY AND/OR INSTALLATION WILL VOID YOUR PRODUCT WARRANTY.
2. ALL HOLES DRILLED INTO VEHICLE SHOULD HAVE THE RAW METAL EDGES SEALED WITH A SELF-ETCHING PRIMER TO RESIST CORROSION AND POTENTIAL FASTENER POINT FAILURE.
3. ALL FASTENERS USED IN THE INSTALLATION OF THIS PRODUCT SHOULD BE TIGHTENED TO THE TORQUE(S) SPECIFIED IN THESE INSTRUCTIONS.
4. THESE INSTRUCTIONS SHOULD BE KEPT WITH THE VEHICLE.

### THE BASIC TOOLS NEEDED FOR MOST INSTALLATIONS



DRILL



DRILL BIT WITH  
STOP



RATCHET, SOCKETS  
AND/OR WRENCHES



SCREWDRIVERS



MEASURING TAPE

ADDITIONAL TOOLS MAY BE NEEDED FOR THIS INSTALLATION AND THEY WILL BE IDENTIFIED IN THE STEPS THAT FOLLOW.

If your vehicle contains carpet or a rubber floor mat you will need to prepare the mounting location. Position the product to be installed into the vehicle and once you are satisfied with the mounting locations, mark the mounting locations. Using a 1-3/16" diameter carpet cutter (P/N: 31183-0). Select the appropriate floor spacers as shown in the illustration. Set those aside for use later into the installation process. Using the correct drill bit size for the selected plusnut, drill the mounting holes in the vehicle sheet metal to prepare for installing the plusnuts. If you are thru-bolting at any of the locations simply drill a hole that is 1/16" larger than the bolt size(s) for those locations. Once you have drilled the holes into the vehicle, the raw metal edges should be sealed using a self-etching primer to resist corrosion and potential fastener point failure.

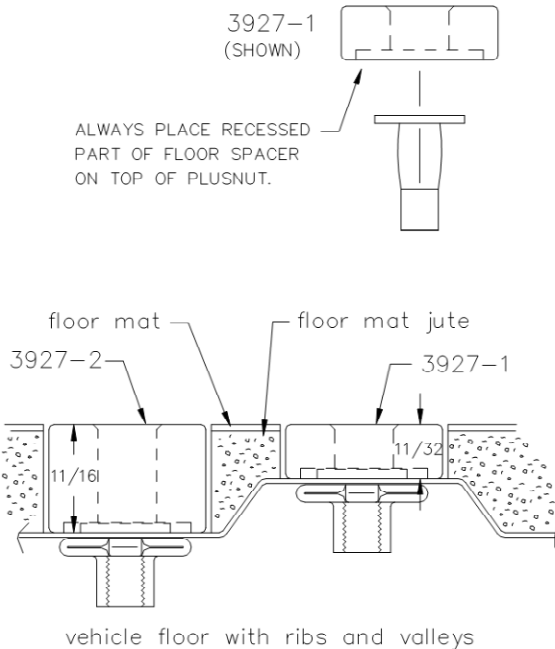

A PLUSNUT (RIVNUT) SETTING TOOL IS REQUIRED FOR PLUSNUT (RIVNUT) INSTALLATION AND IS SUPPLIED WITH THIS KIT. OR USE AN AIR POWERED PLUSNUT SETTING GUN.

1/4-20UNC Plusnut (FAS0052) Use 3/8" dia. drill w/stop  
 FAS0080 SCREW, HXHD, 1/4-20UNCx2.00", G8  
 FAS0067 WASHER, FLAT, 1/4"ID  
 22200-0 PLUSNUT TOOL

5/16-18UNC Plusnut (FAS0091) Use 1/2" dia. drill w/stop  
 FAS0095 SCREW, HXHD, 5/16-18UNCx2.00", G8  
 FAS0086 WASHER, FLAT, 5/16"ID  
 22200-0 PLUSNUT TOOL

Place barrel of the plusnut body in sheet metal thru hole until flange is flush with sheet metal. Using a 9/16" combination wrench of plusnut tool body and a second hand wrench, ratchet, or air tool, rotate the hex bolt head CW to draw plus nut flanges up (set the plusnut).

**Installation and/or Assembly Fasteners**  
**BAGCHPPCS**

ITEM NO.	PART NUMBER	DESCRIPTION	BAGCHPPCS/QTY.
1	BAG0406-A	4" x 6" 3MIL AUTOBAG	1
2	FAS0018	SCREW,HH SFLNG 1/4-20X.62 ZP	2
3	FAS0242	Screw, Hex Hd, 5/16-18x1.50 Stainless Steel	1
4	FAS0552	Washer, Flat, 5/16, SST	5
5	FAS0588	Washer, Lock, Split, 5/16, SS	5
6	FAS0091	Plusnut, 5/16	5
7	FAS0055	Nut, Hex Flange, Nylock 1/4-20	2
8	FAS0095	Screw, Hex Hd, 5/16-18x2.00, Grade 8	4
9	03927-2	Tall Floor Spacer	4

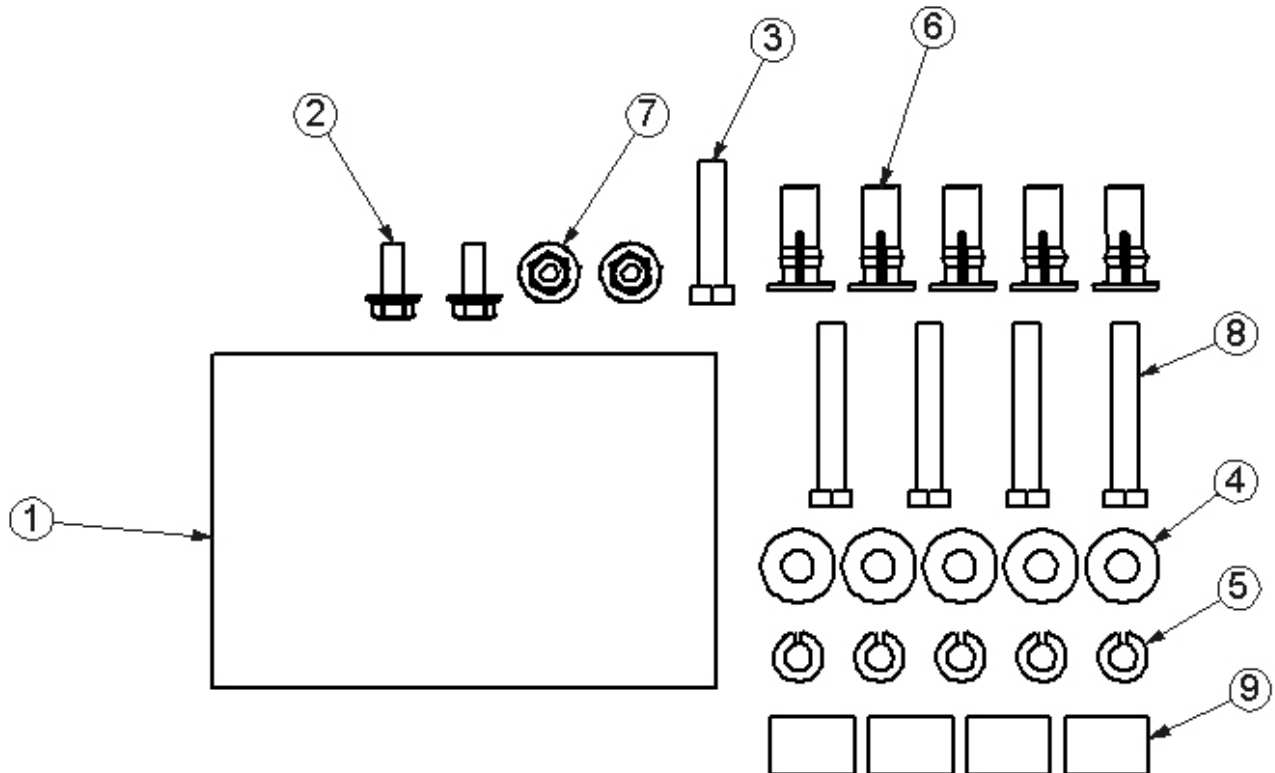

**Step 01 Remove Totes from Rack**

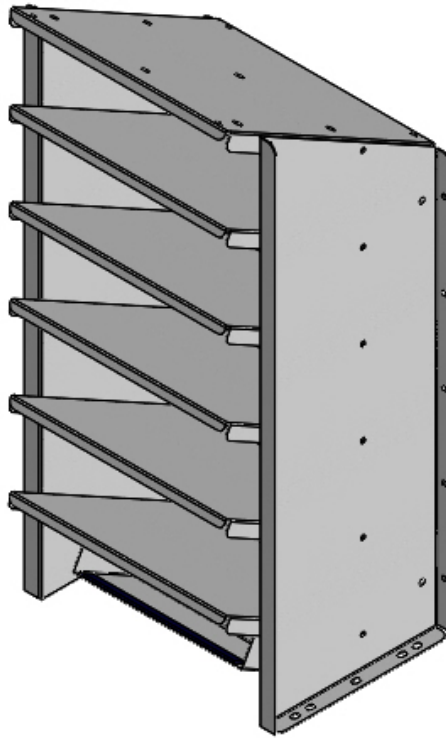

**“DISCLAIMER”  
Attach Upper Mounting Bracket Only  
IF MOUNTING IN VEHICLE**

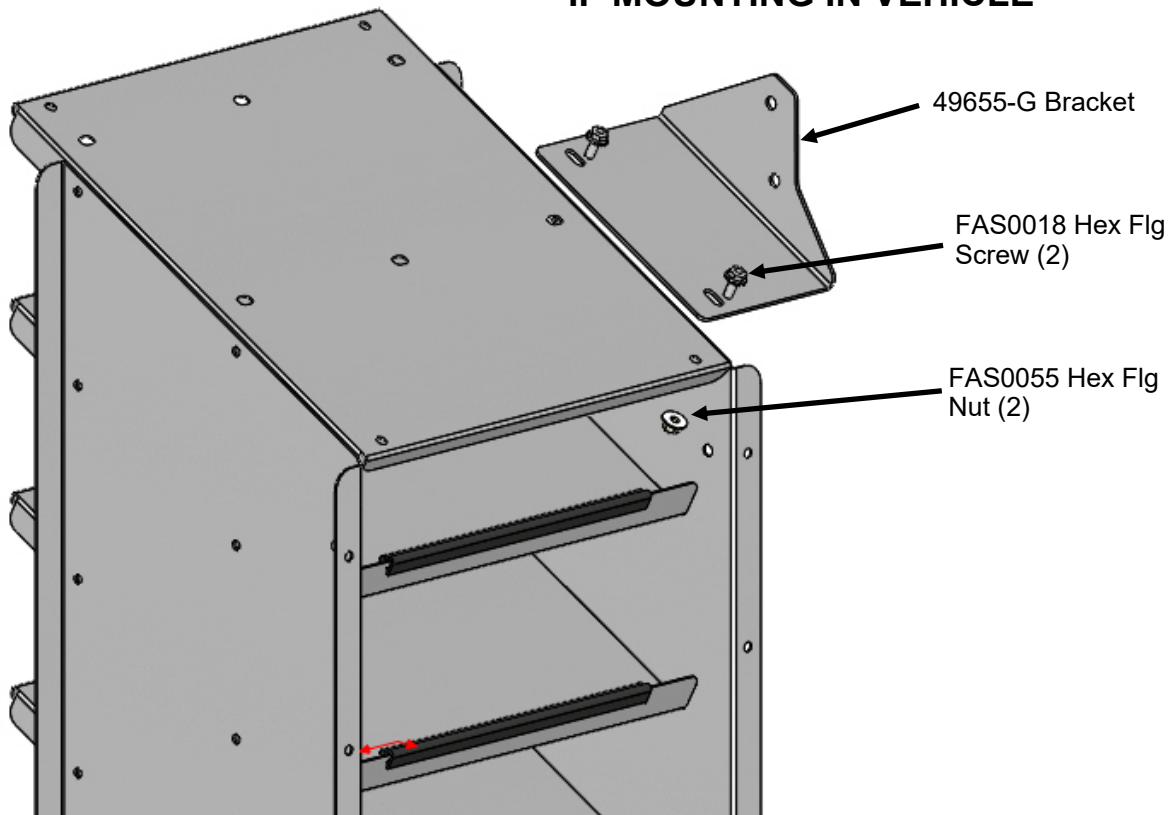



**Step 02 Place in Van and mark Mounting Hole locations Drill and set Plusnuts.**

This installation is for the Ford Transit Van. Rack is located just inside and at rear of side door. If installed in other location or vehicle, refer to the PDS for mounting and bracketry.

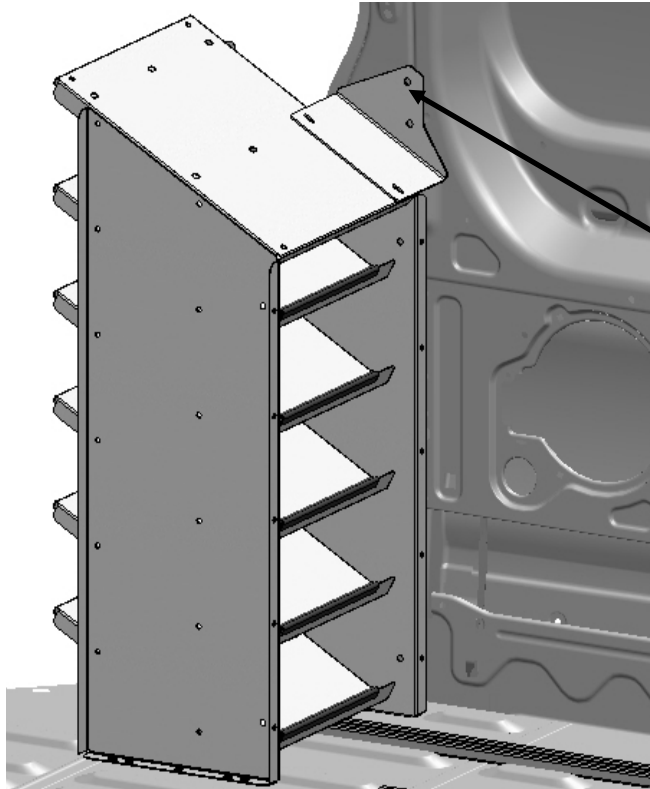

**CAUTION!** Use drill bits with integral stops to drill holes. Check for wiring, fuel and brake lines etc. prior to drilling!

**Only if mounting in Vehicle**

Holes in Upper Mtg Brkt line up with existing holes in Van. Adjust Upper Mtg Brkt as necessary. Torque fasteners to 10 Ft Lbs. Mark top hole and drill

Mark floor at forward most and rear most slots in Rack End Panels. Drill 1/2" holes and set (4) FAS0091 Plusnuts

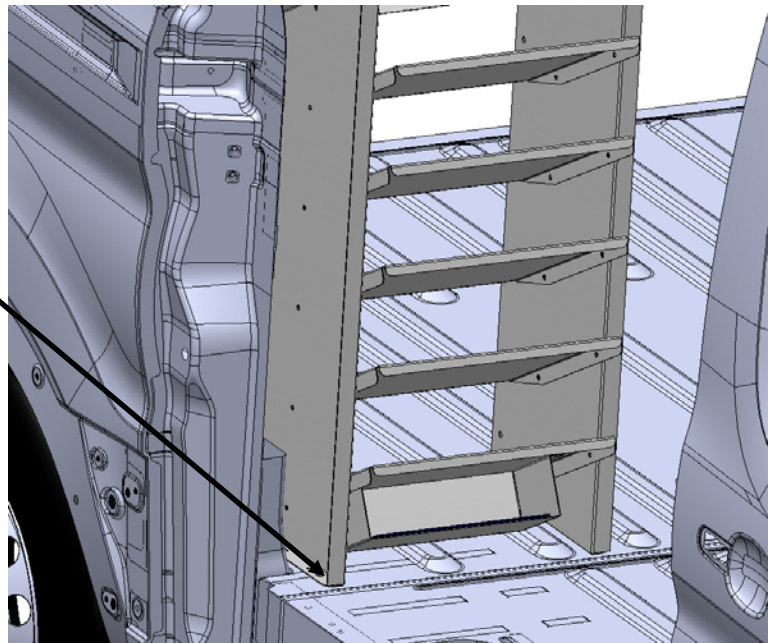

### Step 03 Mount Rack in Van

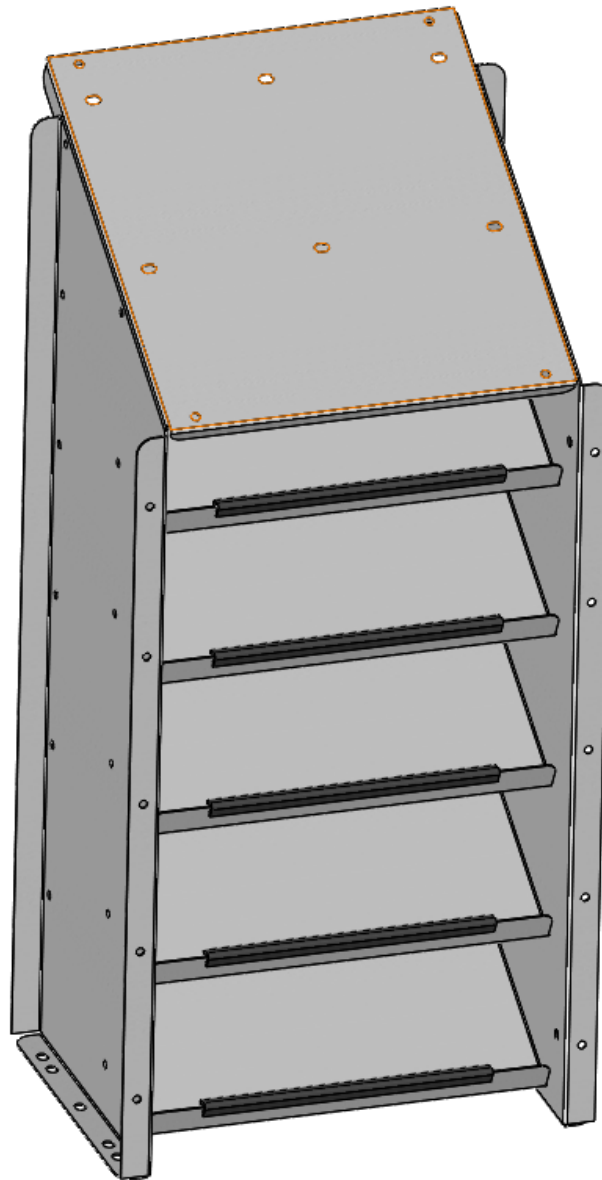

FAS0095 5/16-18X2  
Hex Screw  
FAS0552 Washer  
FAS0588 Lock Wshr  
03927-2 Spacer  
4 each  
Torque 10-12 Ft Lbs

FAS0091 Plusnuts, 4 in  
floor, one in wall, from previ-  
ous step.

After Mounting Rack is complete, re-install  
Totes

**DOUBLE CHECK ALL FASTENERS LOCATIONS TO BE SURE THAT ALL  
FASTENERS ARE TIGHTENED TO SPECIFICATIONS.  
YOUR INSTALLATION IS NOW COMPLETE!  
STOW THIS COPY IN THE VEHICLE FOR FUTURE REFERENCES!**