

INSTR. NUMBER : 68709		PG: 1	REV: B	ITEM NO.	PART NUMBER	DESCRIPTION	GL-SLKFSVW	GL-SLKCVW	GL-SLKTOPW
PART NUMBER	• GL-SLKFSV, GL-SLKCV	• GL-SLKTOP	1	68702-B	SLK,G/L,FSV, MOUNTING TUBE	1	-	-	
			2	68703-W	SLK,G/L, PLATFORM ASSM,WHT	1	1	1	
PART DESC.	• GRIP-LOCK,SLK,FSV	• GRIP-LOCK,SLK,CV	• GRIP-LOCK,SLK,TOP	3	54588	SLK G/L BRACKET	1	1	1
				4	68708-B	SLK,G/L,CV, MOUNTING TUBE	-	1	-
NOTE: THIS INSTRUCTION IS VALID FOR THE FOLLOWING KITS:				5	68706-W	SLK,G/L, PLATFORM CLAMP	1	1	1
				6	68707	SLK,G/L,TUBE SPACER	1	1	1
				7	71626-B	SLK,G/L,TOP,MOUNTIN G TUBE	-	-	1

- GL-SLKFSVW
- GL-SLKFSVB
- GL-SLKCVW
- GL-SLKCVB
- GL-SLKTOPW
- GL-SLKTOPB

-PART NUMBERS WITH "-W" SUFFIX ARE PAINTED WHITE
-FOR BLACK KITS, REPLACE "-W" PARTS WITH "-B" PARTS

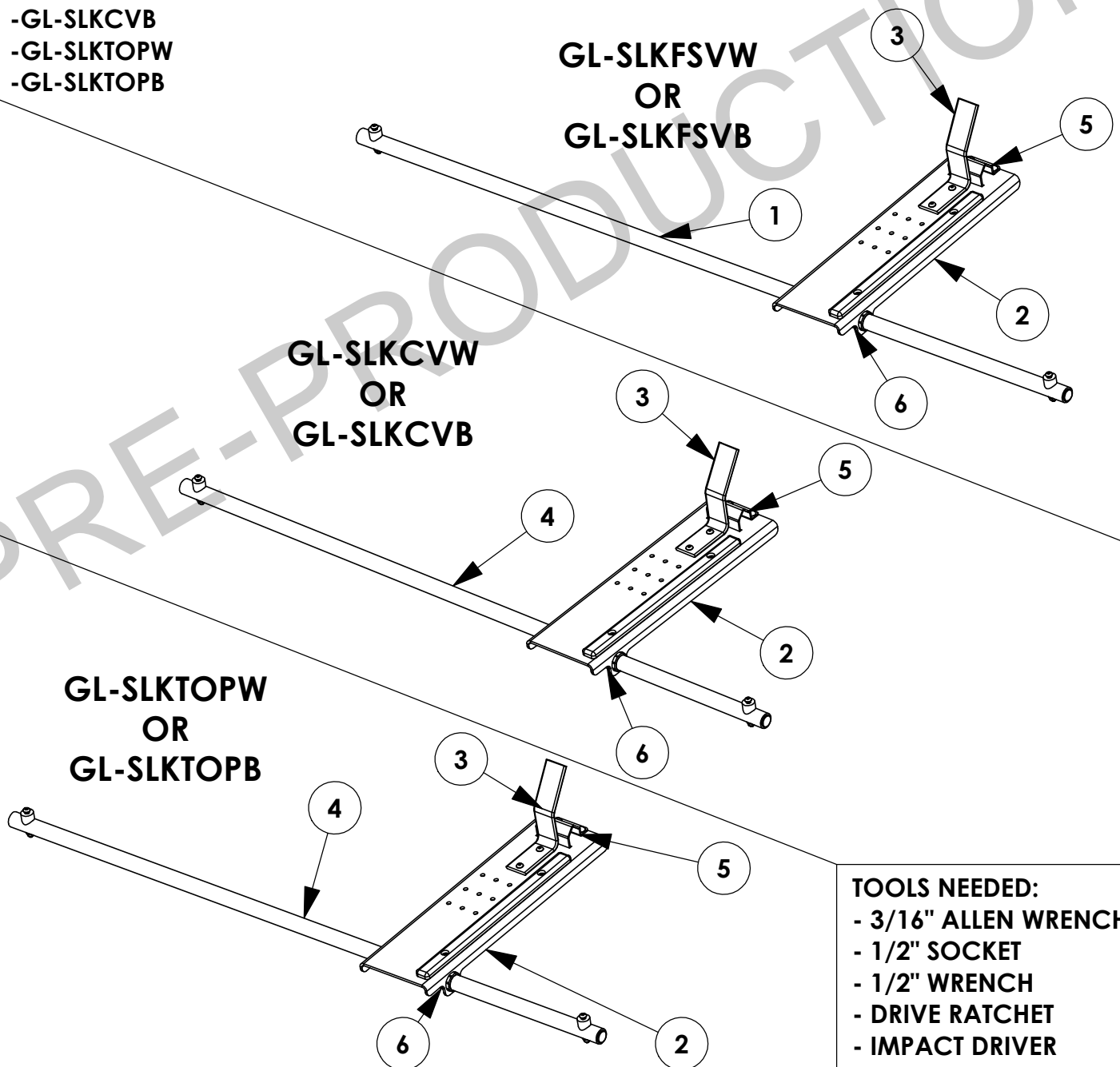

- TOOLS NEEDED:**
- 3/16" ALLEN WRENCH
 - 1/2" SOCKET
 - 1/2" WRENCH
 - DRIVE RATCHET
 - IMPACT DRIVER

GET TO KNOW THE VEHICLE - AT THE BEGINNING OF ANY INSTALLATION, CHECK THE LOCATION OF THE FUEL TANK, FUEL LINES, BRAKE LINES, HIGH VOLTAGE BATTERIES AND WIRING HARNESSSES TO AVOID INJURY OR PROPERTY DAMAGE FROM TOOL CONTACT.

SEAL ALL EXTERIOR HOLES - ALL INSTALLATION HOLES SHOULD BE SEALED WITH BUTYL TAPE OR SILICON TO PREVENT WATER AND EXHAUST GASES FROM ENTERING THE VEHICLE.

CONTROL DRILL DEPTH - TO AVOID DAMAGE TO THE VEHICLE, USE A DRILL STOP OR CLEARED STEP BIT WHEN DRILLING INSTALLATION HOLES.

ALWAYS ADD PRIMER - WHEN ADDING INSTALLATION HOLES BE SURE TO USE A SELF-ETCHING PRIMER TO PREVENT CORROSION, FASTENER FAILURE AND INJURY.

MOUNTING POINTS MUST HAVE METAL-TO-METAL CONTACT - USE PROVIDED MOUNTING SPACERS TO ACCOMMODATE FOR VEHICLE FEATURES, CARPET OR SUBFLOORS.

PROVIDE CLEARANCE FOR SPACERS - IF THE INSTALLATION VEHICLE CONTAINS A CARPET OR SUBFLOOR, USE A 1-3/16" DIAMETER CARPET CUTTER (P/N: 31183-0) AT ALL MOUNTING LOCATIONS TO OPEN UP ROOM FOR SPACERS.

CHECK SPACER ORIENTATION - BE SURE THAT THE INDENT IN THE SPACER COVERS THE PLUSNUT HEAD; THIS ENSURES THE MOST METAL-TO-METAL CONTACT AND REDUCES VIBRATION.

PLUSNUT INSTALLATION - A PLUSNUT GUN IS RECOMMENDED FOR PLUSNUT INSTALLATION FOR ITS PRODUCTION SPEED. HOWEVER, A PLUSNUT SETTING TOOL CAN ALSO BE USED (P/N: 22200-0).

THRU-BOLT CLEARANCE - WHEN USING A THRU-BOLT AT ANY MOUNTING LOCATION, BE SURE THAT YOUR HOLE HAS 1/16" CLEARANCE.

FASTENERS USED

BAG REFERENCE: BAG68711

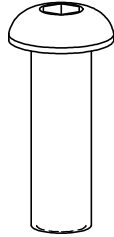

FAS0813
SCREW, BHCS
5/16-18X1.0 SS
QTY: 02

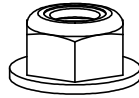

FAS0861
NUT, HEX NLK FLG
5/16-18SS
QTY: 06

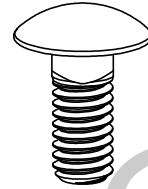

FAS0866
BOLT, CRG
5/16-18X.75 SS
QTY: 02

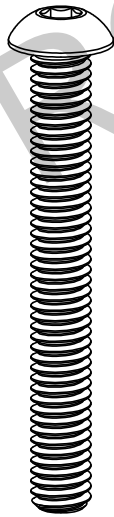

FAS0868
SCREW, BHCS
5/16-18X2.50SS
QTY: 02

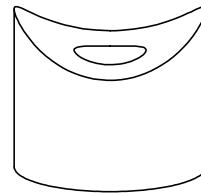

68705
SLK, G/L
MOUNTING SPACER
QTY: 02

PRE-PRODUCTION

INTENTIONALLY LEFT BLANK

PRE-PRODUCTION

STEP 1 - INSERT TUBE THRU PLATFORM AND TUBE SPACER

Step 1.1
INSERT TUBE INTO
STEP LADDER KIT
PLATFORM
BUSHING & 68707
SPACER

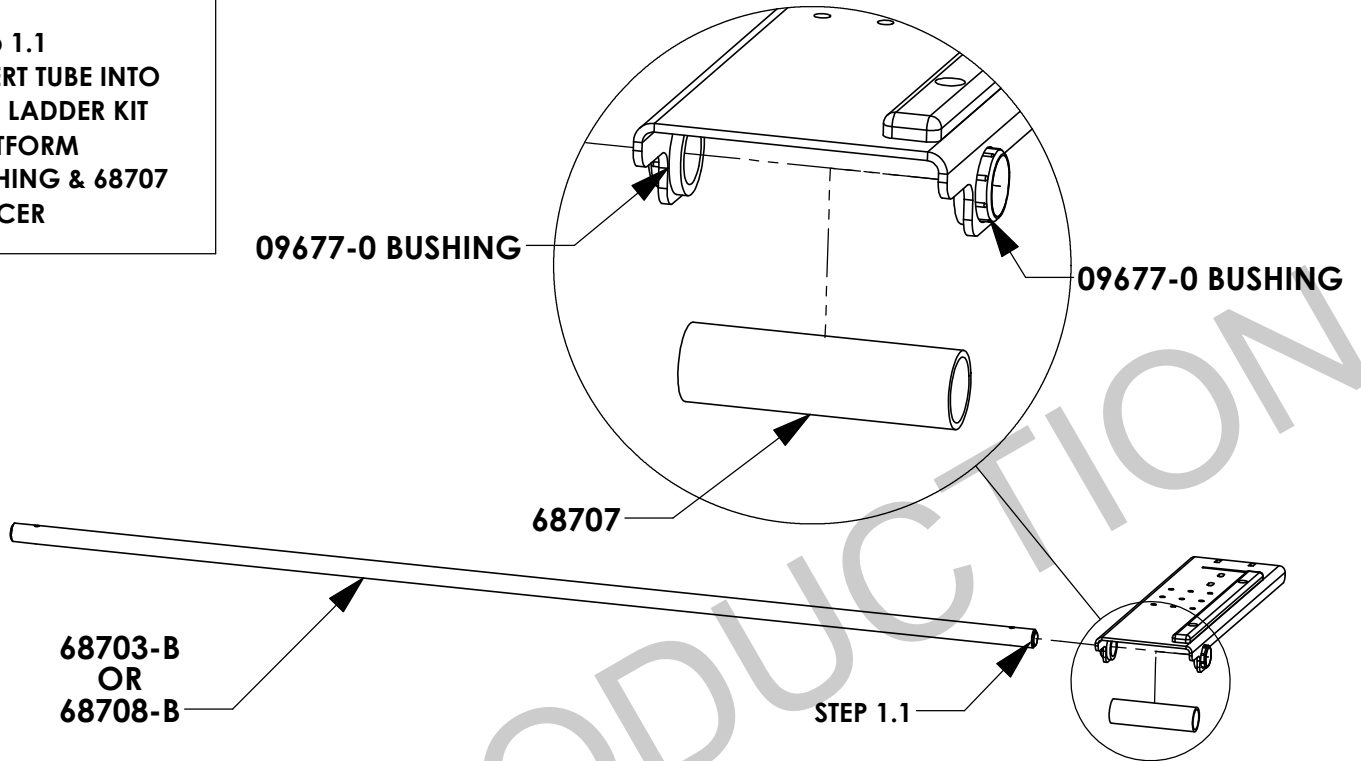

STEP 2 - BOLT INNER TUBE TO GRIP-LOCK LADDER RACK PLATFORMS

Step 2.1
FULLY TIGHTEN
FAS0868, FAS0861,
68705
(01 PLACE EACH
END)
3/16" ALLEN
1/2" SOCKET

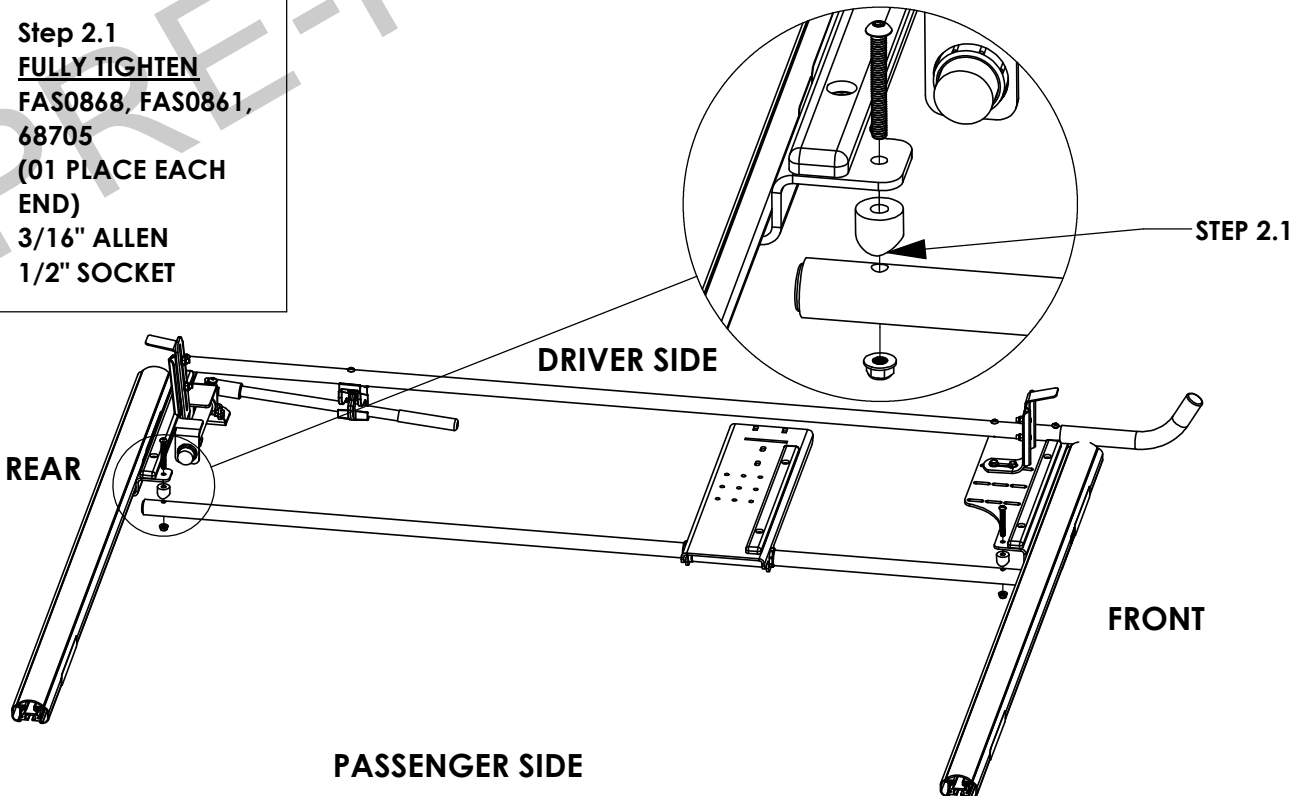

STEP 3 - CLAMP PLATFORM TO OUTER TUBE

Step 3.1
INSERT 68727-W
INTO SLOT OF
68703-W

Step 3.2
FULLY TIGHTEN
FAS0866, FAS0861
(02 PLACES)
1/2" SOCKET

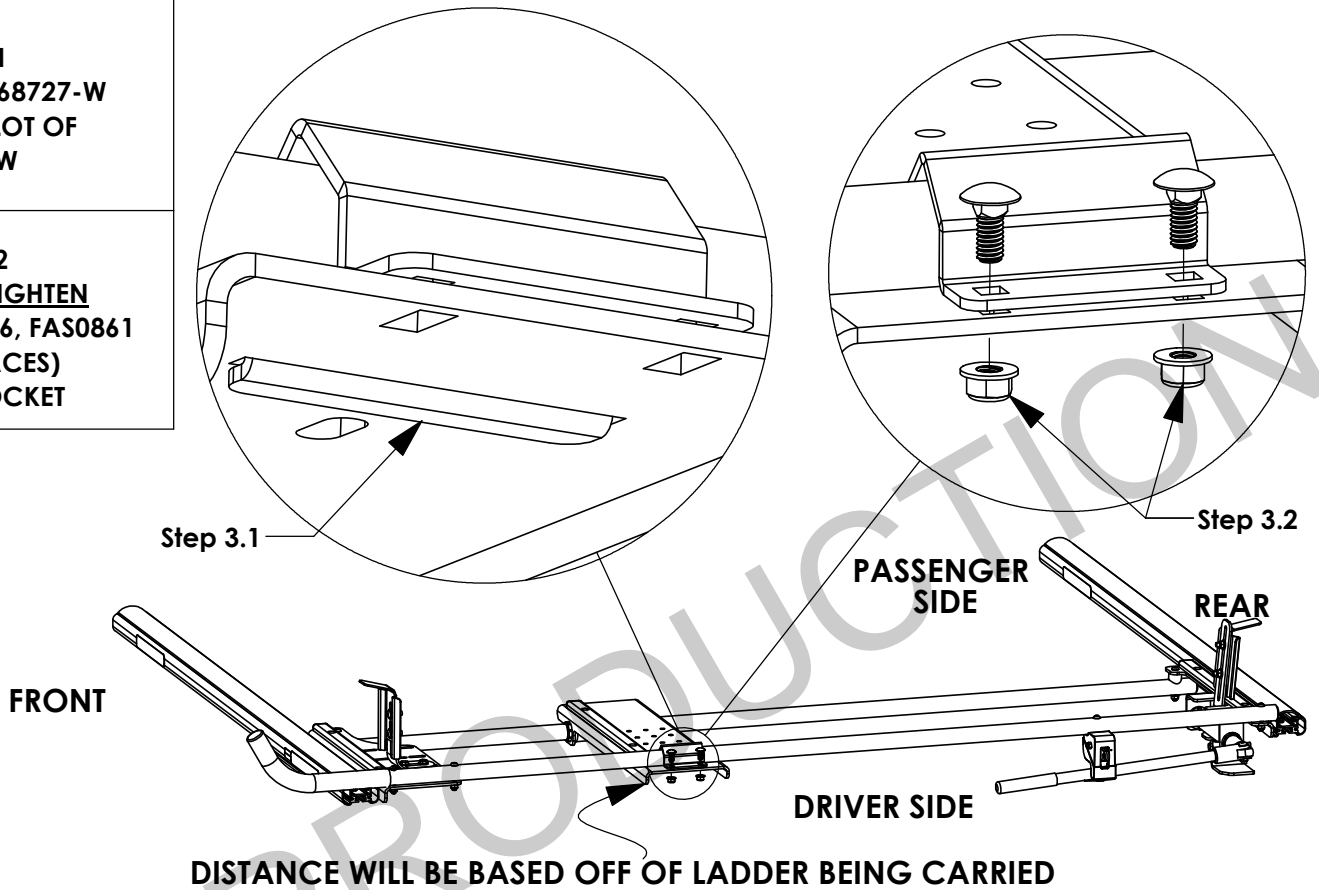

STEP 4 - INSTALL STEP LADDER KIT HORN BRACKET

Step 4.1
FULLY TIGHTEN
FAS0813, FAS0861
(02 PLACES)
3/16" ALLEN
1/2" SOCKET

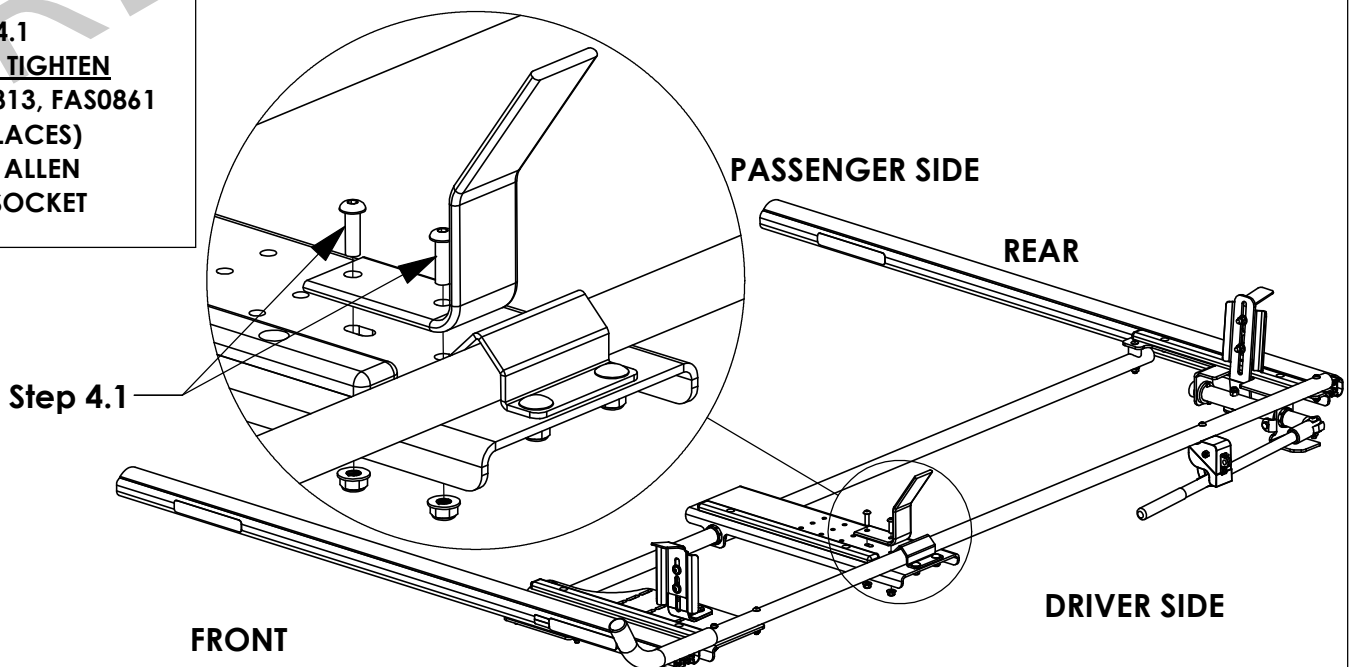

STEP 5 - SIDE SPECIFIC CLAMP RELOCATION

Step 5.1
 REMOVE CLAMP
 FROM PASSENGER
 SIDE FRONT
 PLATFORM
 3/16" ALLEN
 1/2" SOCKET
 1/2" WRENCH

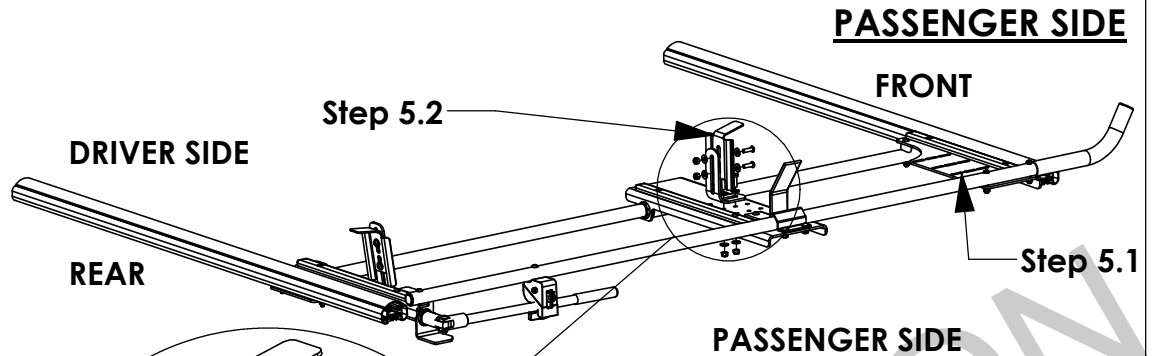

Step 5.2
 REINSTALL ON STEP
 LADDER KIT AS
 SHOWN
 3/16" ALLEN
 1/2" SOCKET
 1/2" WRENCH

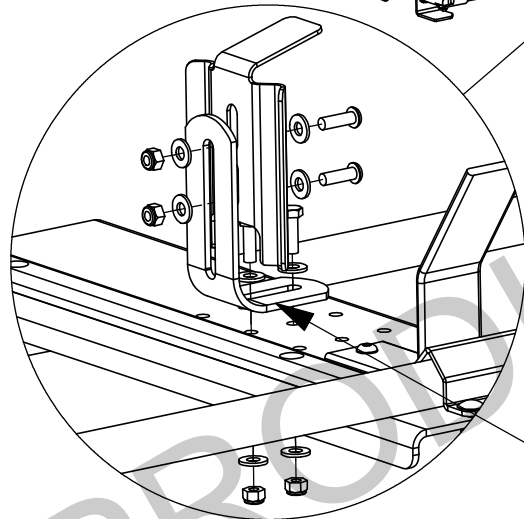

NOTE ORIENTATION!

Step 5.3
 REMOVE CLAMP
 FROM DRIVER SIDE
 FRONT PLATFORM
 3/16" ALLEN
 1/2" SOCKET
 1/2" WRENCH

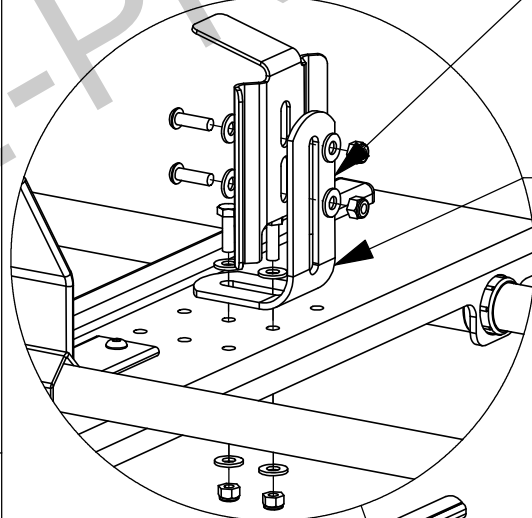

DRIVER SIDE

Step 5.4
 REINSTALL ON STEP
 LADDER KIT AS
 SHOWN
 3/16" ALLEN
 1/2" SOCKET
 1/2" WRENCH

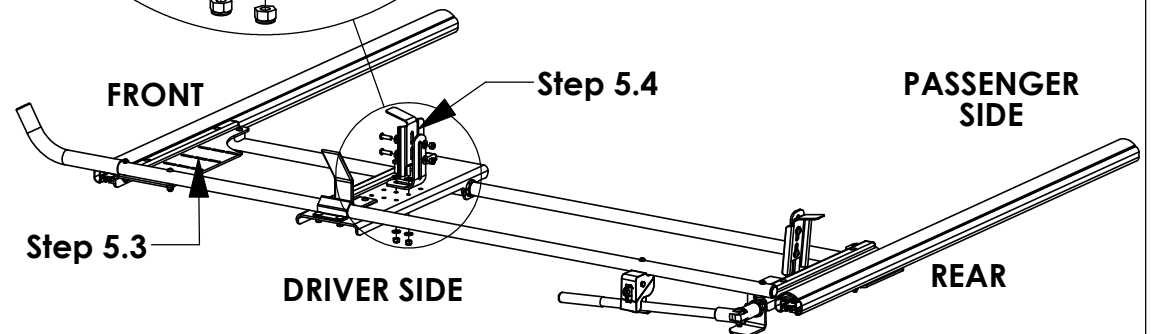

ENSURE ALL FASTENERS HAVE BEEN TIGHTENED.

INSTALLATION COMPLETE. REFER TO END USER INSTRUCTIONS FOR FINAL ADJUSTMENT.