



**PRODUCT WEIGHT**  
10 lbs

**WIDTH x DEPTH x HEIGHT**

**CAPACITY**  
STEP LADDERS

**COLOR**  
Aluminum / Black

**CATALOG NUMBER**

DDLRSCLKHR

**PRODUCT FEATURES**

**THIS STEP LADDER KIT WORKS ON ALL DDLR SERIES HIGH ROOF LADDER RACKS. IT IS ADJUSTABLE TO FIT ANY STEP LADDER SHORTER THEN 8' LONG.**

**SEE PAGE 2 FOR APPLICATION NOTES AND ACCESSORIES, OTHER PRODUCTS THAT WORK WITH THIS UNIT.**

**CATALOG NUMBER**     DDLRSLKHR

***PRODUCT APPLICATION***

**THIS STEP LADDER KIT WORKS WITH ALL HIGH ROOF LADDER RACK (DDLRSERIES)**

***ACCESSORIES THAT WILL WORK WITH THIS PRODUCT***

**CATALOG NUMBER**                      **DESCRIPTION**

**DDL61HCS**     **HIGH ROOF LADDER RACK SS**

**DDL61HSS**     **HIGH ROOF LADDER RACK CS**

***SPECIAL APPLICATION NOTES***

**Introduction / Comments:**

DDLRSLK2 AND DDLRSLKHR STEP LADDER KIT ASSEMBLY INSTALLATION INSTRUCTIONS FOR THE ADRIAN STEEL DDLR SERIES LADDER RACK. THE STEP LADDER KIT WILL FIT ON ALL DDLR LADDER RACKS AND CAN ACCOMMODATE A WIDE VARIETY OF STEP LADDERS.

**Note:**

It is advised that all fasteners used in this assembly and installation should be checked for tightness at the following intervals: @ 2-weeks and again @ 6-weeks of operation. This preventive maintenance step must be completed to ensure your Product gives you long service life.

ITEM NO.	PART NUMBER	DESCRIPTION	QE5034-305/QTY.	
1	39991-B	BOLT PLATE, BLACK	1	
2	54660	SLK CROSSBEAM WELDMENT	1	
3	54656-B	SLK UPRIGHT, BLACK PLS	1	
4	54657-B	SLK LADDER SUPPORT, BLACK	1	
5	BAG54663	FAS BAG FOR DDLRSLK2	1	NOT SHOWN
6	54661	INS INSTRUCT, DDLRSLK2	1	NOT SHOWN

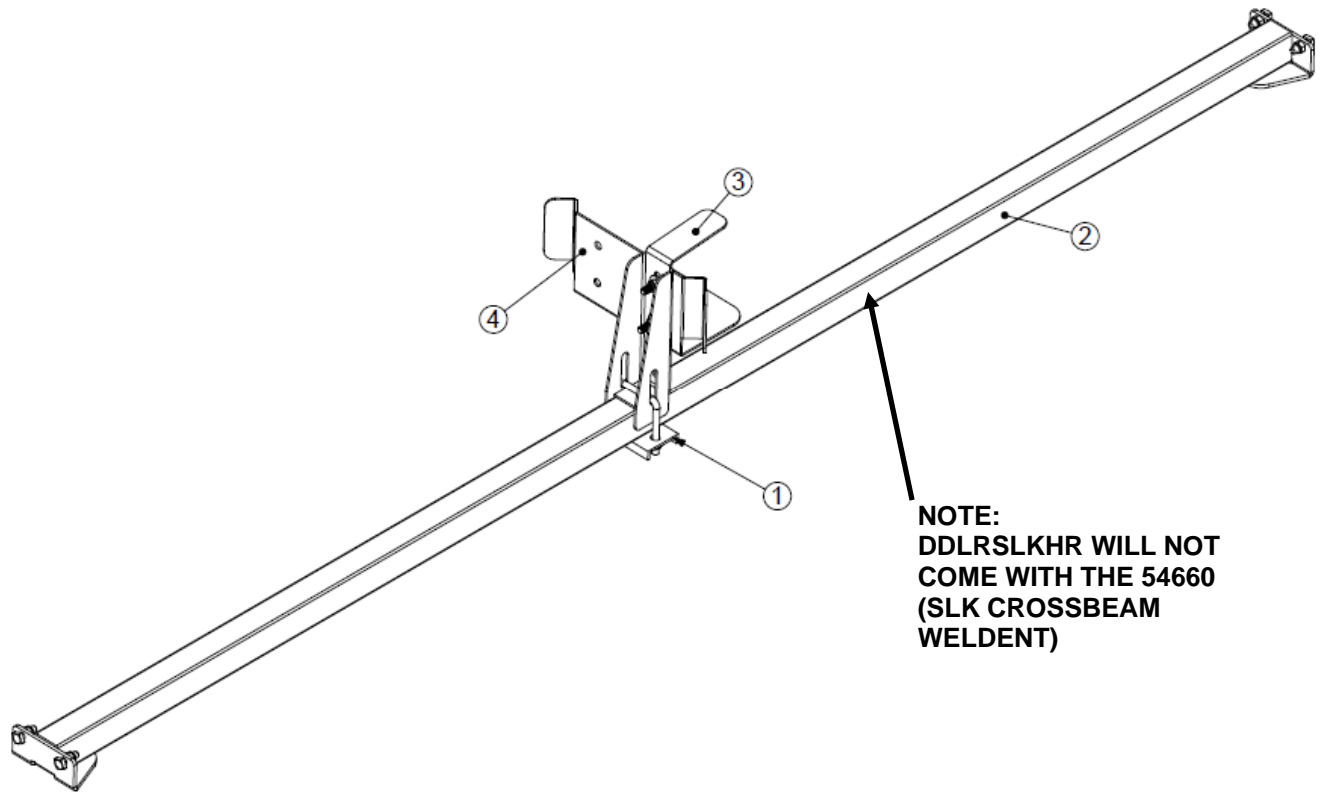

**DDLRSLK2 & DDLRSLKHR  
STEP LADDER KIT FOR DDLR SERIES**

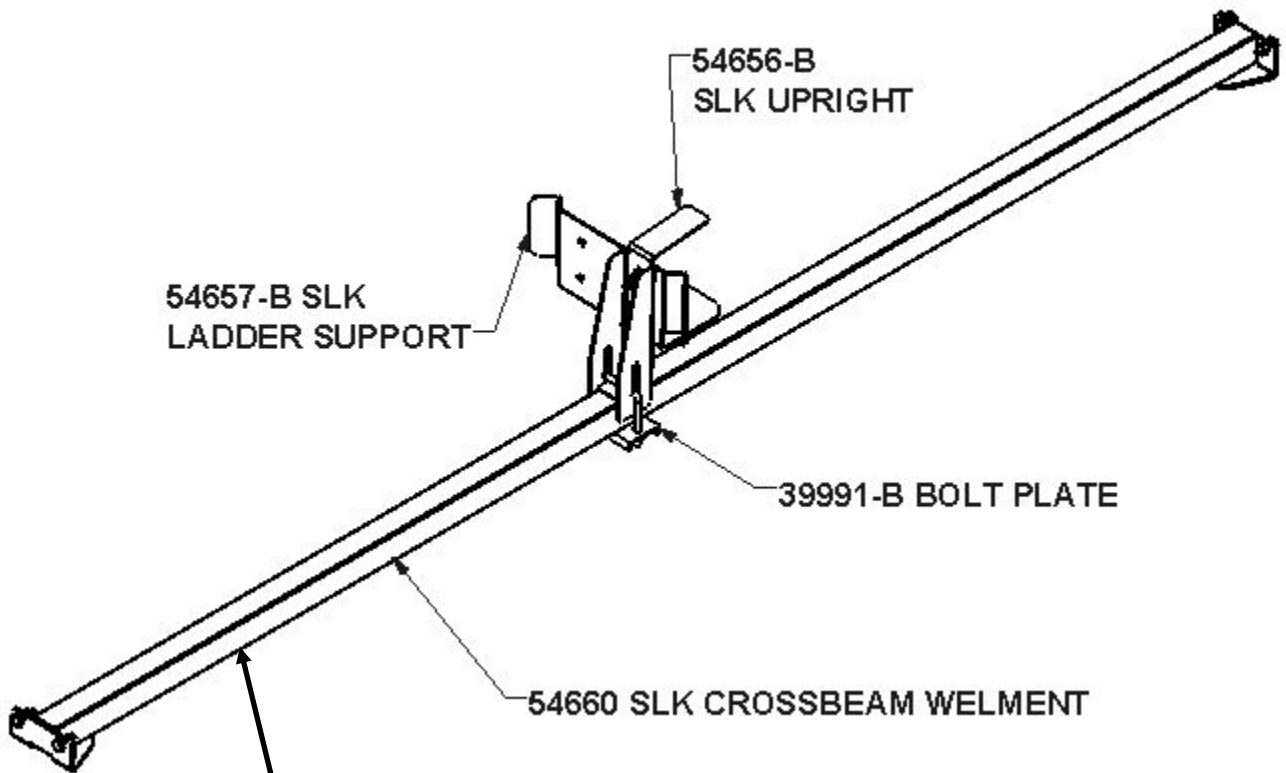

NOTE:  
DDLRSLKHR WILL NOT  
COME WITH THE 54660  
(SLK CROSSBEAM  
WELMENT)

**NOTE:  
IF YOU ARE INSTALLING  
THE DDLRSLKHR SKIP TO  
STEP #4 AT THIS TIME.**

## - PRECAUTIONS -



**CAUTION**  
THE USE OF AIR IMPACT TOOLS CAN OVER-TORQUE FASTENERS AND CAUSE FASTENER FAILURE!



**CAUTION**  
ALL INSTALLATION HOLES SHOULD BE SEALED WITH SILICON OR BUTYL SEALANT TO PREVENT EXHAUST FUMES FROM ENTERING THE VEHICLE!



**DANGER**  
INSPECT FOR FUEL TANK, FUEL LINES, BRAKE LINES, HIGH VOLTAGE BATTERIES AND ELECTRICAL LINES PRIOR TO DRILLING TO AVOID DAMAGING CRITICAL VEHICLE SYSTEMS OR INJURY TO INSTALLER DURING INSTALLATION PROCESS!



**CAUTION**  
TO AVOID DAMAGING THE VEHICLE ALWAYS USE DRILL STOPS WHEN DRILLING ANY INSTALLATION HOLES!  
ADRIAN AVAILABLE PART #'S 31119-0 (3/8" X 1/2" DEEP), 31121-0 (1/2" x 1/2" DEEP)



## - IMPORTANT WARRANTY REQUIREMENTS -

1. SUBSTITUTING ADRIAN STEEL SPECIFIED FASTENERS FOR ASSEMBLY AND/OR INSTALLATION WILL VOID YOUR PRODUCT WARRANTY.
2. ALL HOLES DRILLED INTO VEHICLE SHOULD HAVE THE RAW METAL EDGES SEALED WITH A SELF-ETCHING PRIMER TO RESIST CORROSION AND POTENTIAL FASTENER POINT FAILURE.
3. ALL FASTENERS USED IN THE INSTALLATION OF THIS PRODUCT SHOULD BE TIGHTENED TO THE TORQUE(S) SPECIFIED IN THESE INSTRUCTIONS.
4. THESE INSTRUCTIONS SHOULD BE KEPT WITH THE VEHICLE.

### THE BASIC TOOLS NEEDED FOR MOST INSTALLATIONS



DRILL



DRILL BIT WITH STOP



RATCHET, SOCKETS AND/OR WRENCHES



SCREWDRIVERS



MEASURING TAPE

ADDITIONAL TOOLS MAY BE NEEDED FOR THIS INSTALLATION AND THEY WILL BE IDENTIFIED IN THE STEPS THAT FOLLOW.

If your vehicle contains carpet or a rubber floor mat you will need to prepare the mounting location. Position the product to be installed into the vehicle and once you are satisfied with the mounting locations, mark the mounting locations. Using a 1-3/16" diameter carpet cutter (P/N: 31183-0). Select the appropriate floor spacers as shown in the illustration. Set those aside for use later into the installation process. Using the correct drill bit size for the selected plusnut, drill the mounting holes in the vehicle sheet metal to prepare for installing the plusnuts. If you are thru-bolting at any of the locations simply drill a hole that is 1/16" larger than the bolt size(s) for those locations. Once you have drilled the holes into the vehicle, the raw metal edges should be sealed using a self-etching primer to resist corrosion and potential fastener point failure.

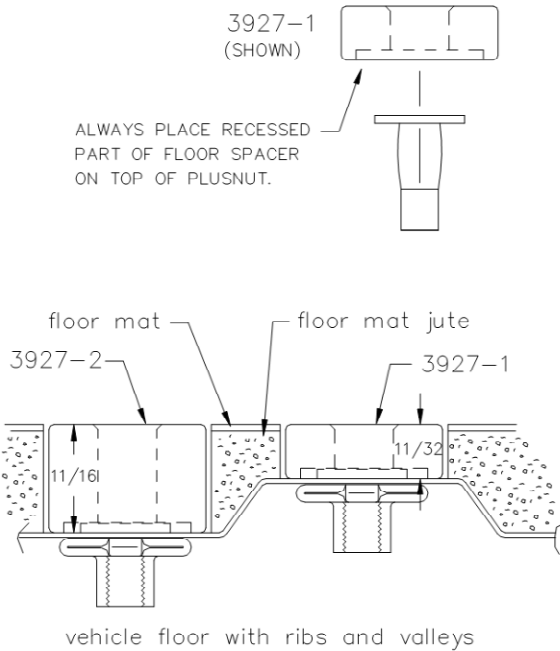

A PLUSNUT (RIVNUT) SETTING TOOL IS REQUIRED FOR PLUSNUT (RIVNUT) INSTALLATION . PLUS NUT SETTING TOOL CAN BE ORDERED THROUGH ADRIAN STEEL, OR USE AN AIR POWERED PLUSNUT SETTING GUN.

1/4-20UNC Plusnut (FAS0052) Use 3/8" dia. drill w/stop  
 FAS0080 SCREW, HXHD, 1/4-20UNCx2.00", G8  
 FAS0067 WASHER, FLAT, 1/4"ID  
 22200-0 PLUSNUT TOOL

5/16-18UNC Plusnut (FAS0091) Use 1/2" dia. drill w/stop  
 FAS0095 SCREW, HXHD, 5/16-18UNCx2.00", G8  
 FAS0086 WASHER, FLAT, 5/16"ID  
 22200-0 PLUSNUT TOOL

Place barrel of the plusnut body in sheet metal thru hole until flange is flush with sheet metal. Using a 9/16" combination wrench of plusnut tool body and a second hand wrench, ratchet, or air tool, rotate the hex bolt head CW to draw plus nut flanges up (set the plusnut).

**Installation and/or Assembly Fasteners  
BAG54663**

ITEM NO.	PART NUMBER	DESCRIPTION	BAG54663/QTY.
1	BAG0406-A	4" x 6" 3MIL AUTOBAG	1
2	FAS0598	U-Bolt, square, 5/16-18 2.12x2.75	1
3	FAS0248	Nut, Nylon Insert Lock, 5/16-18 SST	8
4	FAS0552	Washer, Flat, 5/16, SST	6
5	FAS0035	BOLT,SQ HD,5/16-18X1.0 SS	4
6	FAS0830	Screw, Hex Hd, 5/16-18 X 1.25 SS	2

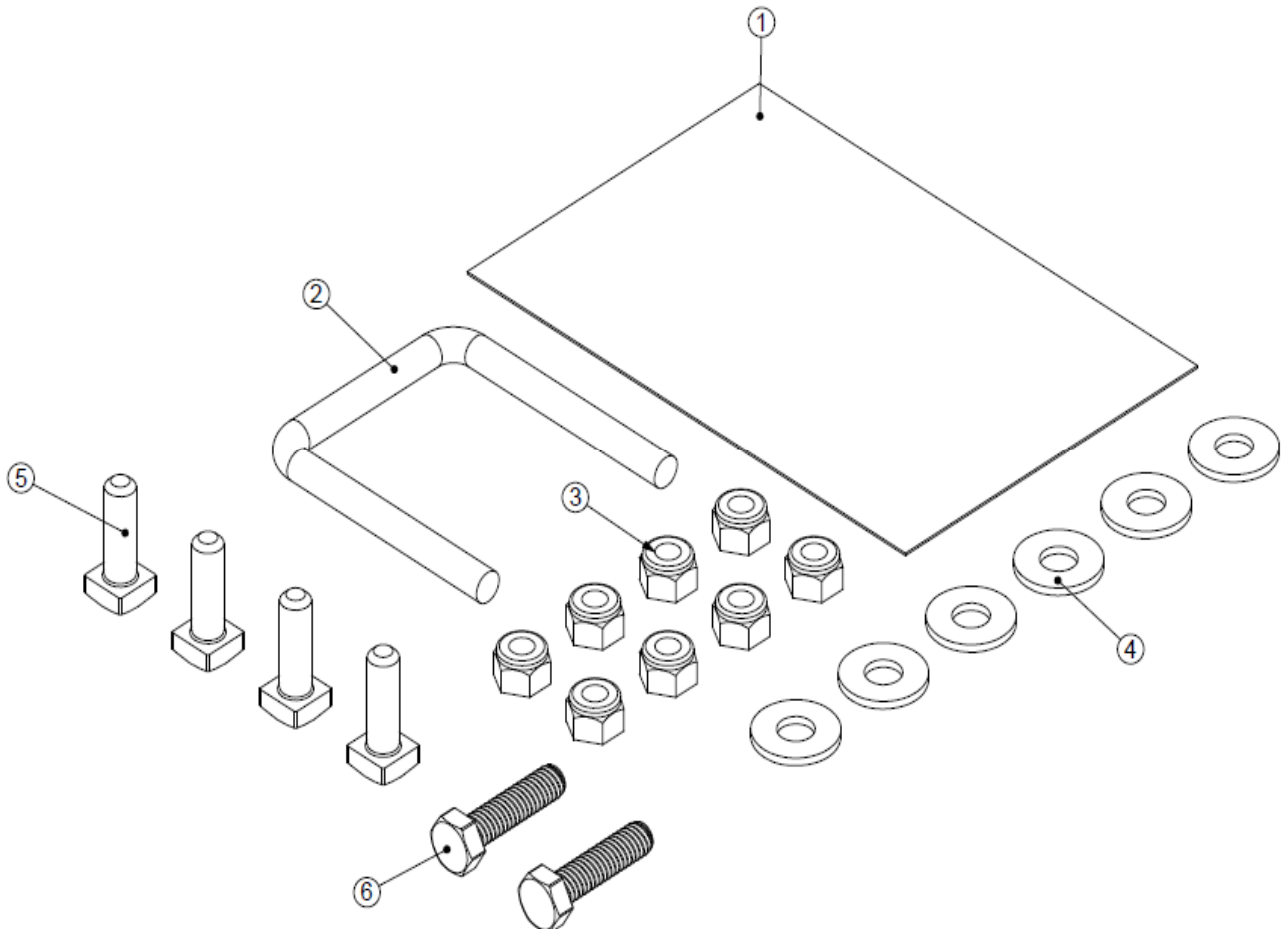

**Step 01** Unfasten the 4 nuts that hold the stub shafts to the front and rear primary drop assemblies. Remove both the ladder assist tube and the (2) stub shafts from the ladder rack. If the ladder assist tube and stub shafts are not yet on the ladder rack, skip to step 2.

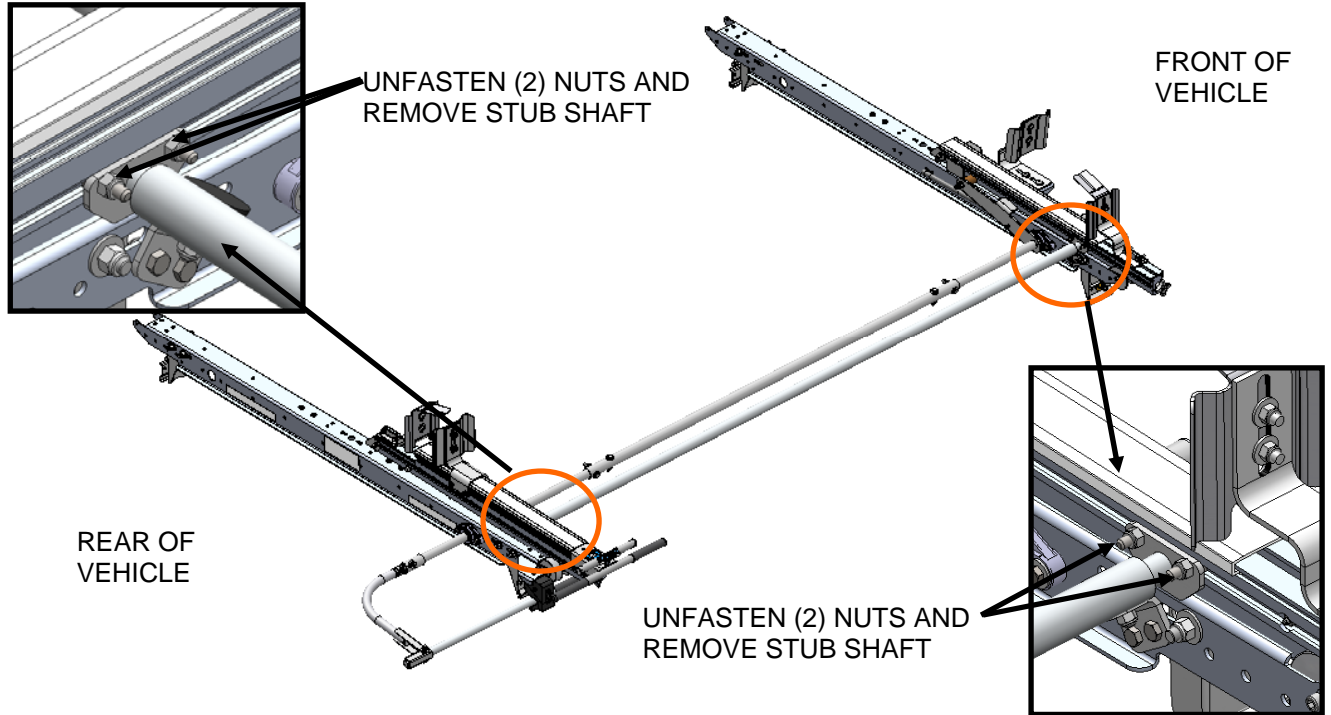

**Step 02** REPLACE THE STUB SHAFTS AND LADDER ASSIST TUBE WITH THE SLK CROSSBEAM (54660). USE THE NEW FAS0248 NYLOCK NUTS TO SECURE THE CROSSBEAM, THE SQUARE HEAD BOLTS IN THE DROP ASSEMBLIES MAY BE RE-USED OR REPLACED. NOTE—DO NOT TIGHTEN FASTENERS.

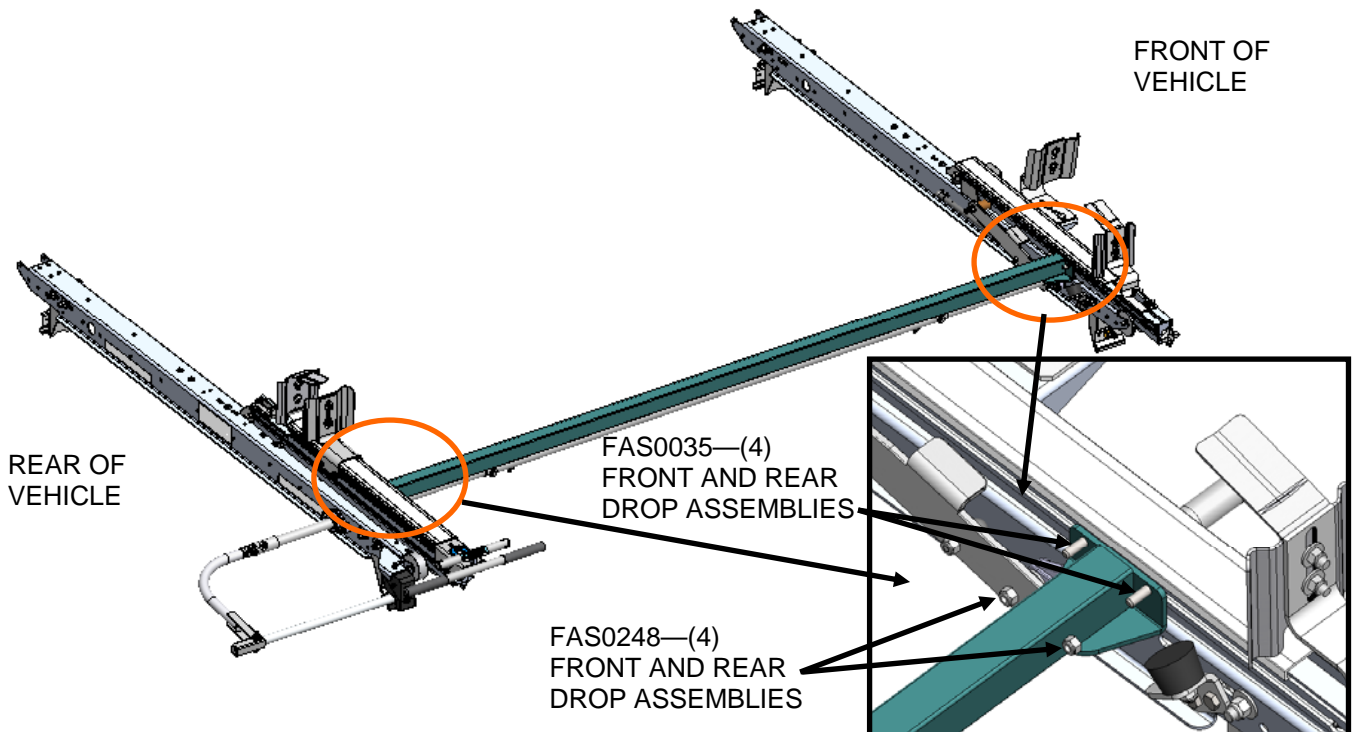



**Step 03** TIGHTEN THE FASTENERS WITH THE CROSSBEAM 14" FROM THE END OF THE DROP ASSEMBLY (FRONT AND REAR DROP ASSEMBLIES), AS SEEN BELOW.

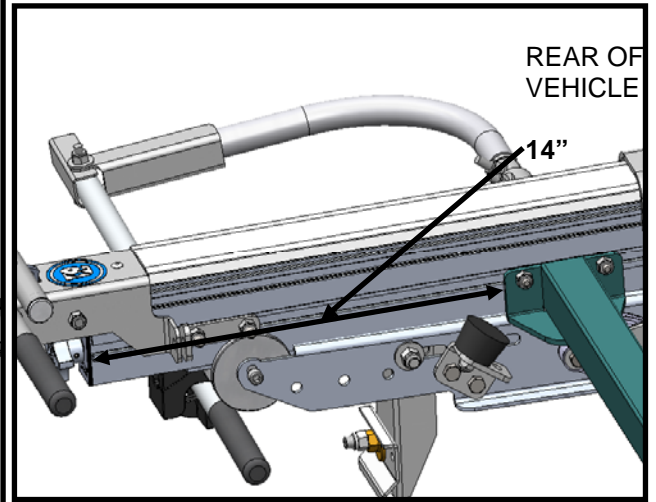
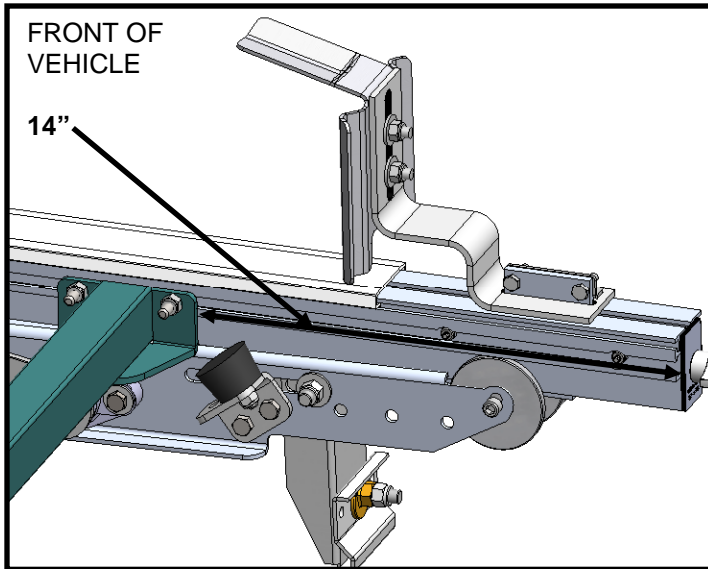

**Step 04** INSTALL THE SLK UPRIGHT BRACKET (54656-B) TO THE CROSSBEAM (54660). SEE BELOW. **NOTE—DO NOT FULLY TIGHTEN U BOLT FASTENERS, THE ASSEMBLY WILL NEED TO BE ADJUSTED FOR YOUR STEP LADDER BEFORE FULLY FASTENING.**

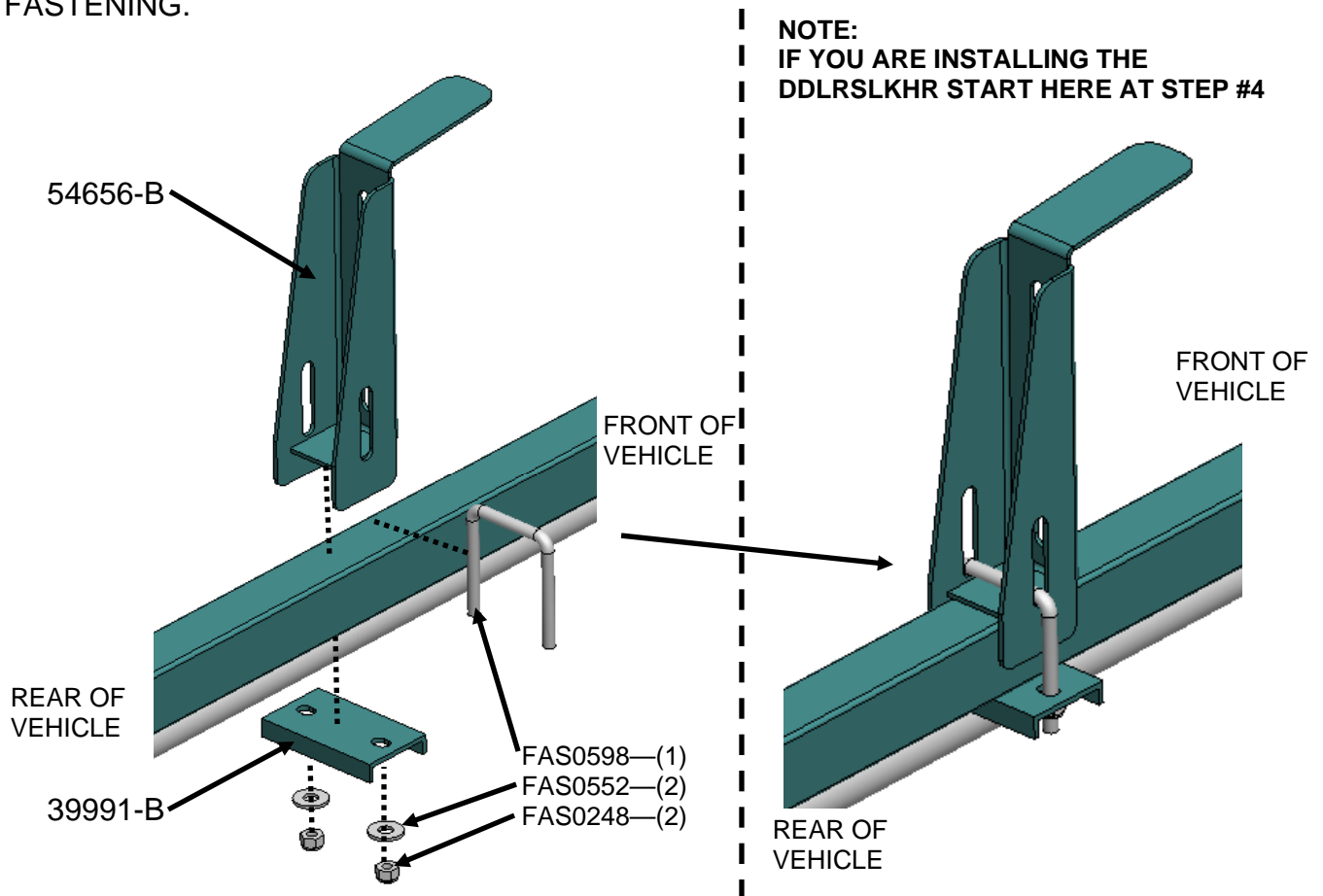

**Step 05-A** ASSEMBLE THE SLK LADDER SUPPORT (54657-B) TO THE SLK UPRIGHT BRACKET (54656-B). **NOTE—DO NOT TIGHTEN**, USE THE SLOTS TO ADJUST THE LADDER SUPPORT SNUGGLY TO THE RUNGS OF THE STEP LADDER.

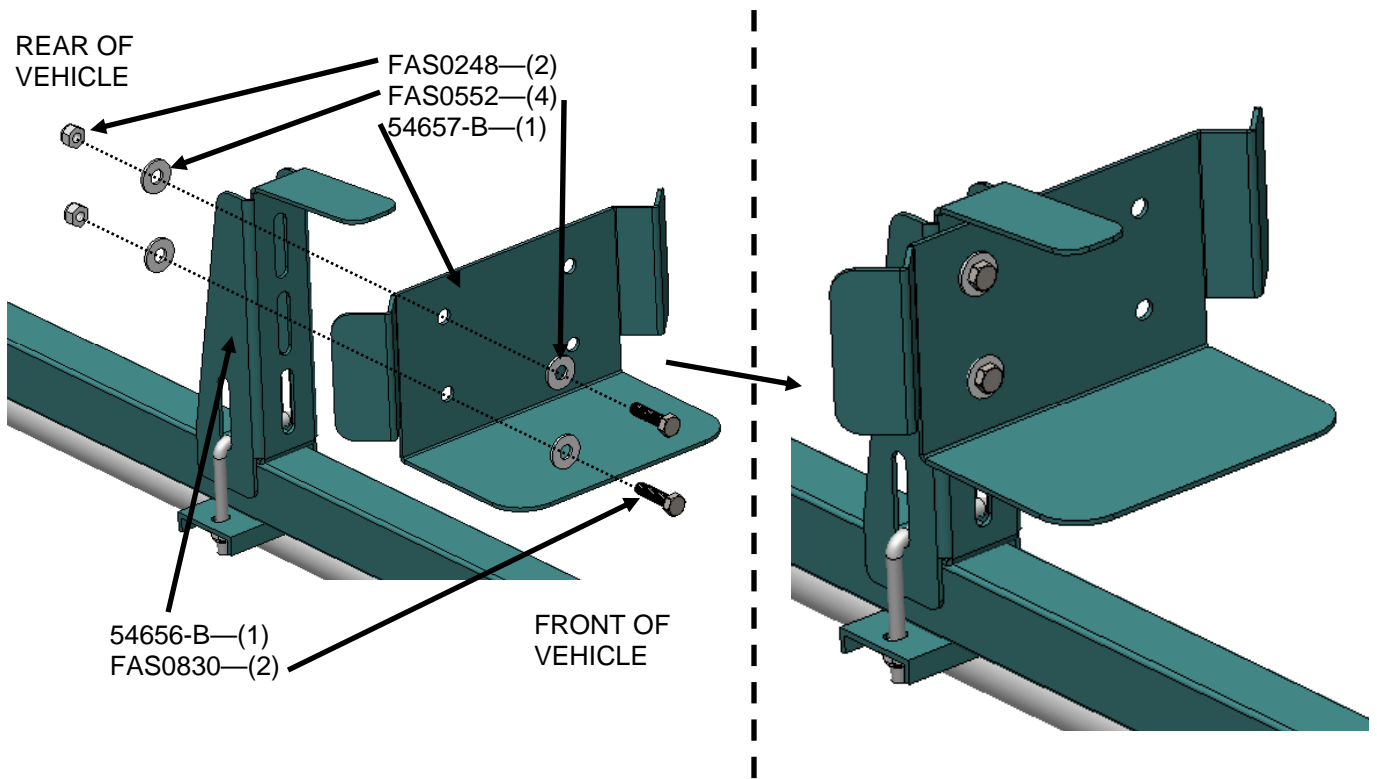

**Step 05-B** WHEN INSTALLING THE SLK LADDER SUPPORT MAKE SURE TO USE THE HOLES TO THE OUTSIDE OF THE VEHICLE (DEPENDING ON IF THE STEP LADDER KIT IS USED ON THE CURB OR STREET SIDE OF THE VEHICLE. SEE BELOW FOR ASSEMBLY ORIENTATION.

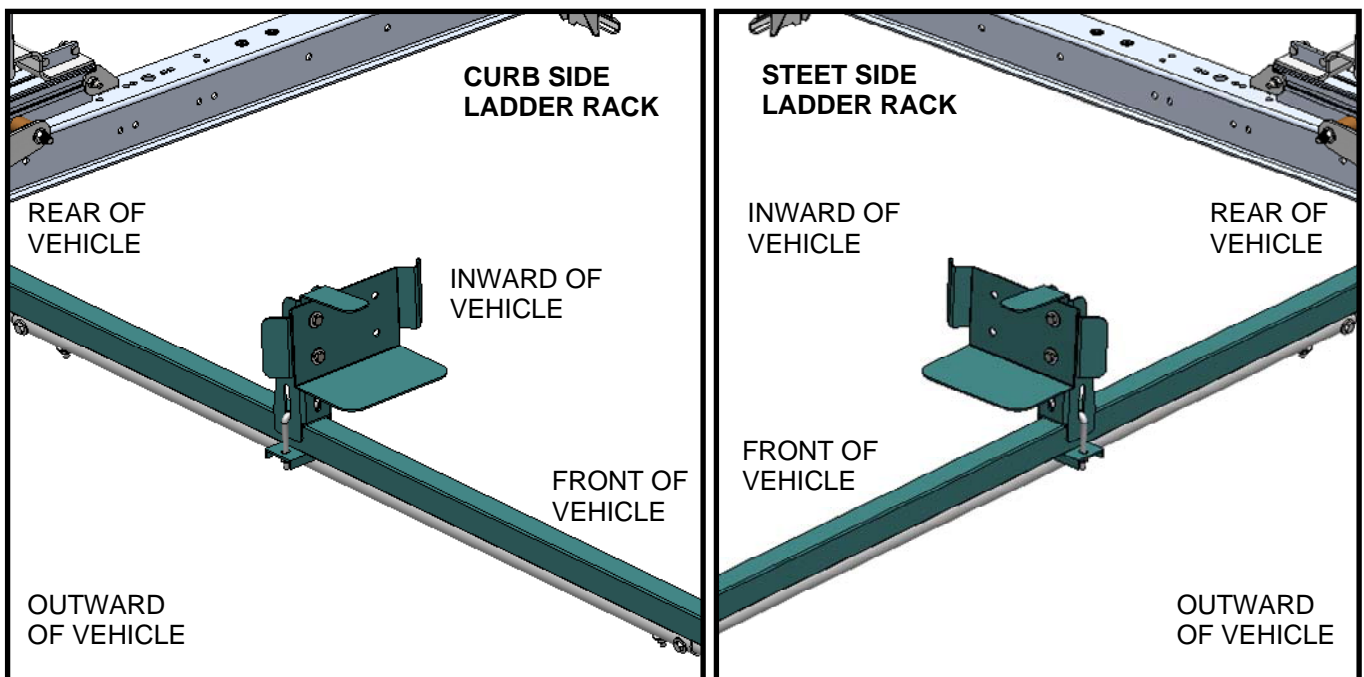

**Step 06** ADJUST THE STEP LADDER BRACKETS FORWARD/BACKWARD AND UP/DOWN DEPENDING ON LADDER RUNG SPACING AND HEIGHT. THE STEP LADDER BRACKETS SHOULD FIT THE LADDER TIGHTLY TO AVOID VIBRATION, BUT SHOULD BE LOOSE ENOUGH TO LOAD/REMOVE THE LADDER WITHOUT BINDING.

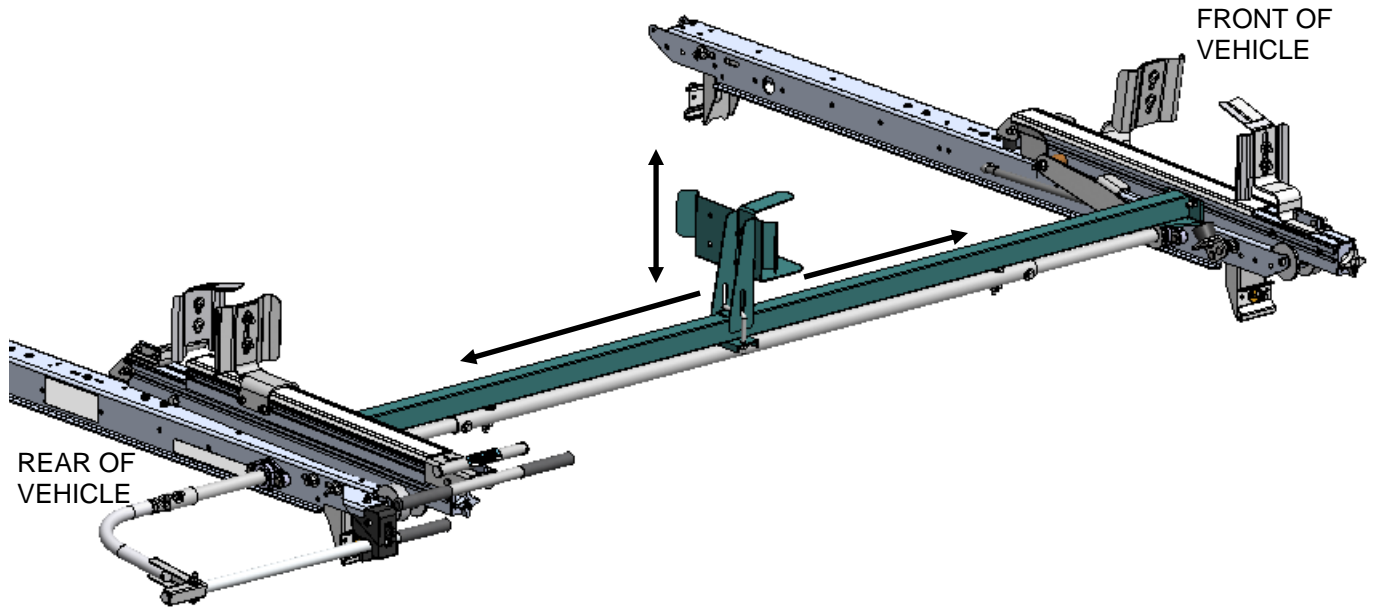

**Step 07** ONCE THE STEP LADDER BRACKETS HAVE BEEN ADJUSTED TO FIT YOUR LADDER, THIGHTEN THE ALL THE FASTENERS TO LOCK THE ASSEMBLY IN PLACE.

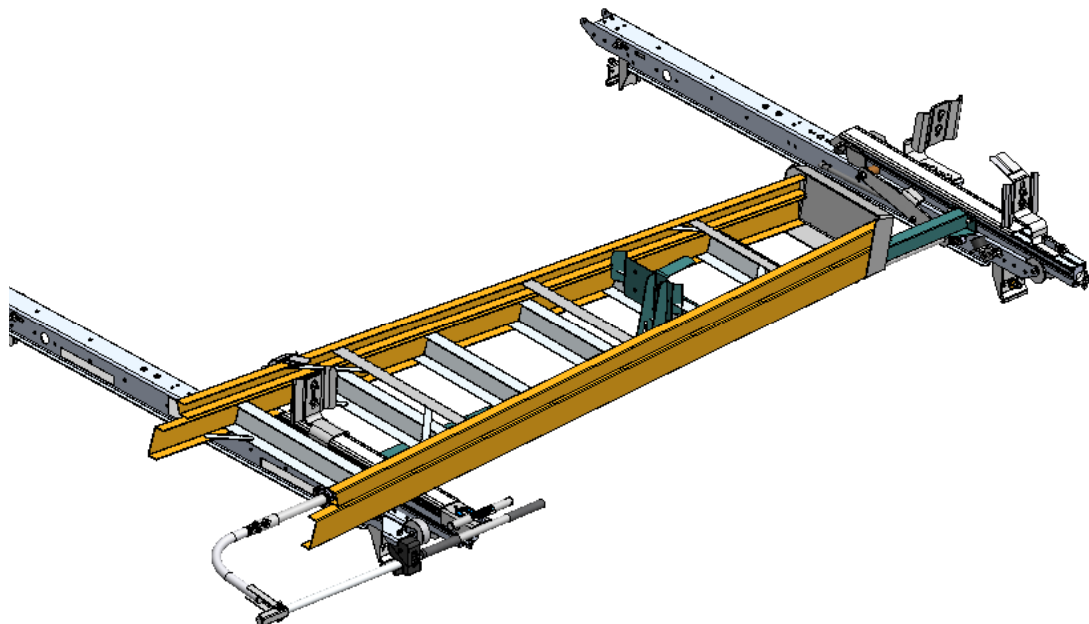



**INSTALLATION IS NOW COMPLETE!**

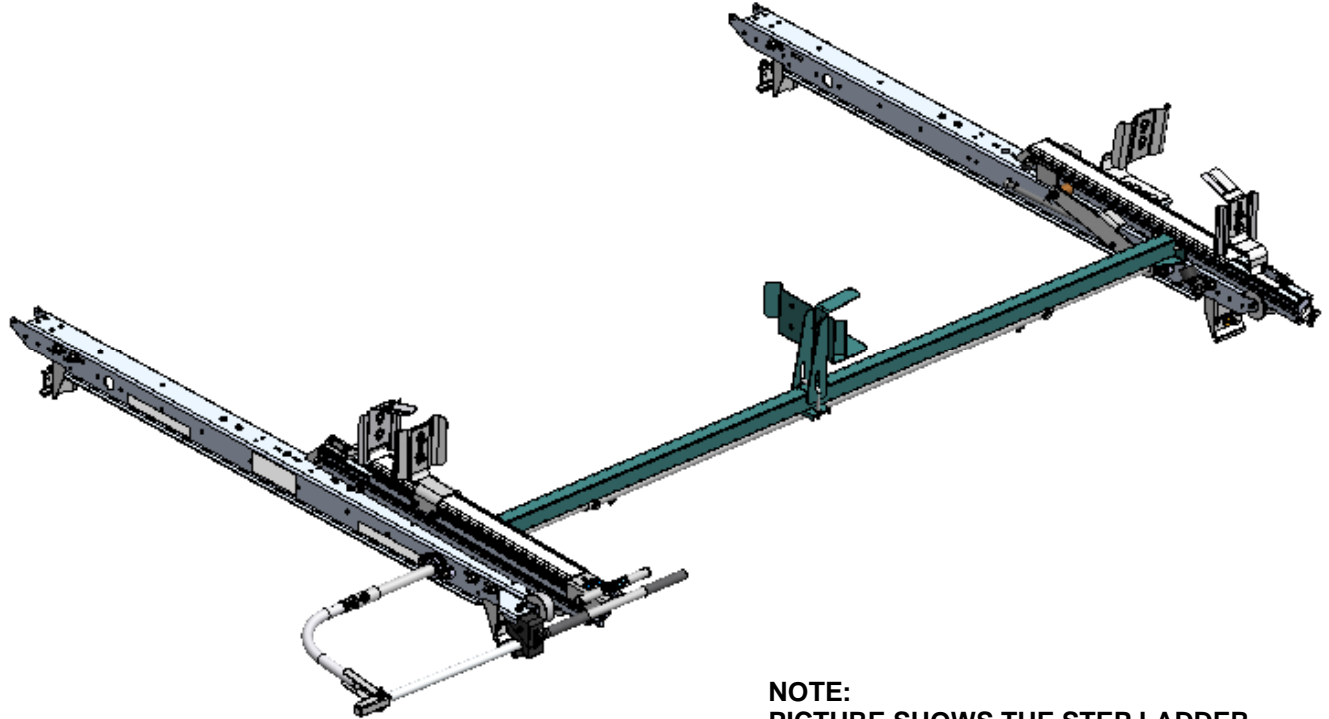

**NOTE:**  
PICTURE SHOWS THE STEP LADDER  
KIT ON THE LOW ROOF DDLR LADDER  
RACK. IF YOU ARE INSTALLING THE  
DDLRSLKHR YOUR INSTALLATION  
MAY LOOK DIFFERENT.

**NOTE:**  
AS SHOWN ABOVE , CURBSIDE IS THE DEFUALT LOCATION OF THE  
STEP LADDER KIT.

**DOUBLE CHECK ALL FASTENERS LOCATIONS TO BE SURE THAT ALL  
FASTENERS ARE TIGHTENED TO SPECIFICATIONS.  
YOUR INSTALLATION IS NOW COMPLETE!  
STOW THIS COPY IN THE VEHICLE FOR FUTURE REFERENCES!**