

## 70-2LR Conduit Carrier Kit 6"

This view is the final assembly view. The 70-2LR does NOT come with the PVC, or cross-supports.

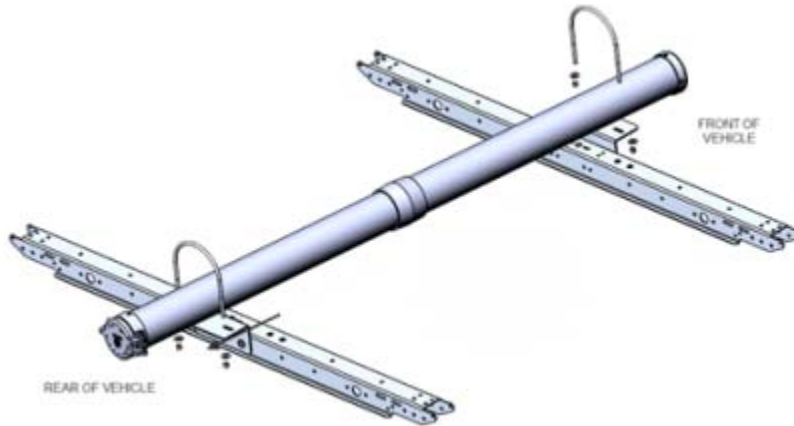

**PRODUCT WEIGHT**  
7 LBS

**WIDTH x DEPTH x HEIGHT**

**CAPACITY**

Image of product you will receive with your 70-2LR

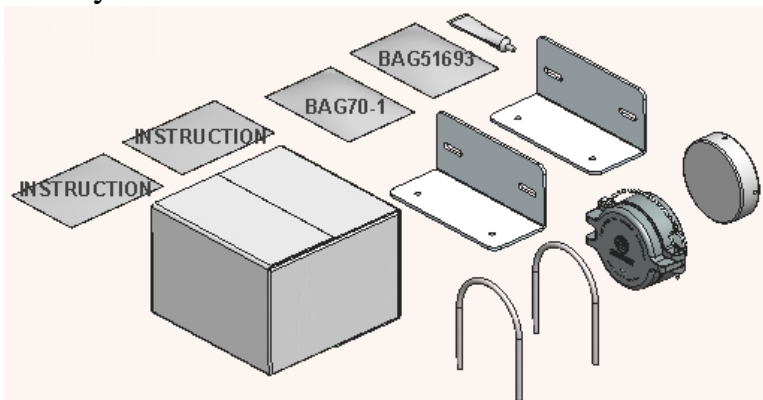

**PRODUCT FEATURES**

**COLOR**  
Aluminum &  
Stainless Steel

**CATALOG NUMBER**  
70-2LR

**Cast aluminum ends to attach to 6" PVC tubing. Attachments are stainless steel U-bolts that wrap around the 6" PVC tubing and then attach to a mounting brackets (51696). This product is to be used only with the DDLR series ladder racks (Ford or GM).**

**SEE PAGE 2 FOR APPLICATION NOTES AND ACCESSORIES, OTHER PRODUCTS THAT WORK WITH THIS UNIT.**



**CATALOG NUMBER** 70-2LR

**PRODUCT APPLICATION**

This product is designed to be installed on the DDLR Series Ladder Racks.

**ACCESSORIES THAT WILL WORK WITH THIS PRODUCT**

<b>CATALOG NUMBER</b>	<b>DESCRIPTION</b>
<b>DDL61FTL</b>	<b>Single Drop-Down Ladder Rack, Ford Transit Low Roof</b>
<b>DDL63FTL</b>	<b>Double Drop-Down Ladder Rack, Ford Transit Low Roof</b>
<b>DDL64FTL</b>	<b>Drop-Down Ladder Rack Combo, Ford Transit Low Roof</b>
<b>61-GLFTL</b>	<b>Single Grip Lock Ladder Rack, Ford Transit Low Roof</b>
<b>63-GLFTL</b>	<b>Double Grip Lock Ladder Rack, Ford Transit Low Roof</b>
<b>64-GLFTL</b>	<b>Grip Lock Ladder Rack W/SLK, Ford Transit Low Roof</b>
<b>61-GLGM</b>	<b>Single Grip Lock Ladder Rack, GM FSV</b>
<b>63-GLGM</b>	<b>Double Grip Lock Ladder Rack, GM FSV</b>
<b>64-GLGM</b>	<b>Grip Lock Ladder Rack W/SLK, GM FSV</b>
<b>DDL61GM</b>	<b>Single Drop-Down Ladder Rack for GM FSV</b>
<b>DDL63GM</b>	<b>Drop-Down Ladder Rack Double FSV</b>
<b>DDL64GM</b>	<b>Drop-Down Ladder Rack Combo</b>
<b>DDL61SLKGM</b>	<b>Step Ladder Kit, DDL61, GM</b>
<b>DDL61SLK</b>	<b>Step Ladder Kit, DDL61</b>

**SPECIAL APPLICATION NOTES**

Only 1 conduit kit can be installed per product noted above. For ease of installation, install the conduit mtg bracket to cross bars prior to installing cross bars to roof of vehicle.



**CATALOG NUMBER** 70-2LR

**PRODUCT APPLICATION**

This product is designed to be installed on the DDLR Series Ladder Racks.

**ACCESSORIES THAT WILL WORK WITH THIS PRODUCT**

<b>CATALOG NUMBER</b>	<b>DESCRIPTION</b>
<b>DDL61NVL</b>	<b>Single Drop-Down Ladder Rack, Nissan Low Roof</b>
<b>DDL63NVL</b>	<b>Double Drop-Down Ladder Rack, Nissan Low Roof</b>
<b>DDL64NVL</b>	<b>Drop-Down Ladder Rack Combo, Nissan Low Roof</b>
<b>61-GLNVL</b>	<b>Single Grip Lock Ladder Rack, Nissan Low Roof</b>
<b>63-GLNVL</b>	<b>Double Grip Lock Ladder Rack, Nissan Low Roof</b>
<b>64-GLNVL</b>	<b>Grip Lock Ladder Rack W/SLK, Nissan Low Roof</b>

**SPECIAL APPLICATION NOTES**

Only 1 conduit kit can be installed per product noted above. For ease of installation, install the conduit mtg bracket to cross bars prior to installing cross bars to roof of vehicle.

### Introduction / Comments:

**THESE KITS, WHEN COMBINED WITH YOUR PVC PIPE, AND INSTALLED ON THE UTILITY OR LADDER RACK PROVIDE STORAGE FOR CONDUIT AND SIMILAR ITEMS ON THE ROOF OF YOUR VAN.**

**Note:**

It is advised that all fasteners used in this assembly and installation of this Rack should be checked for tightness at the following intervals: @ 2-weeks and again @ 6-weeks of operation. This preventive maintenance step must be completed to ensure your package gives you long service life.

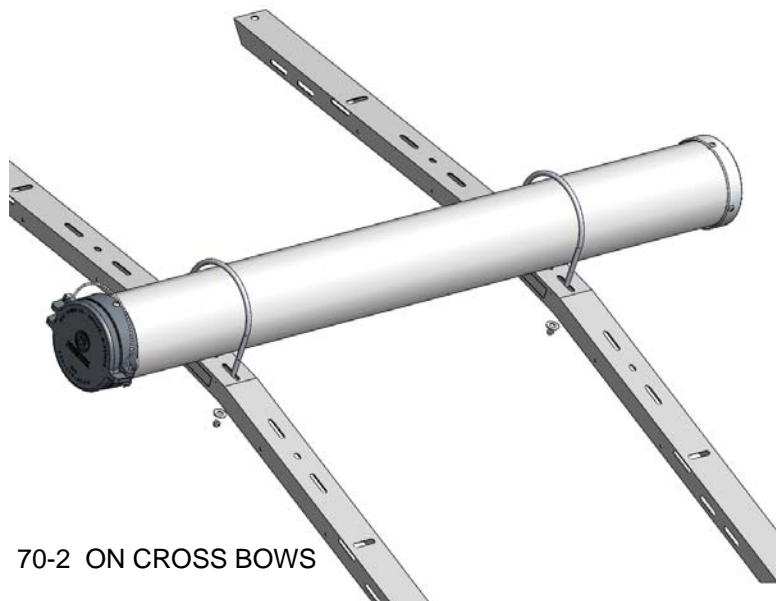

70-2 ON CROSS BOWS

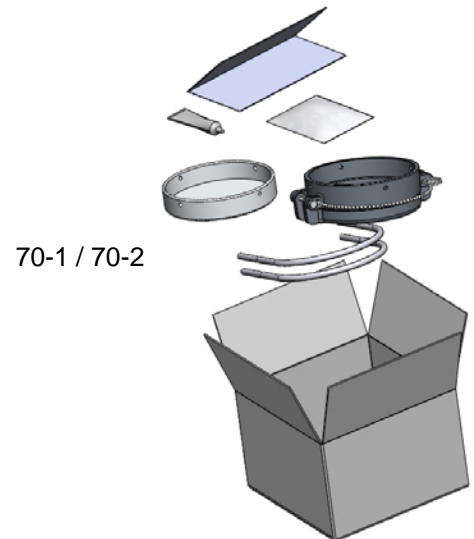

70-1 / 70-2

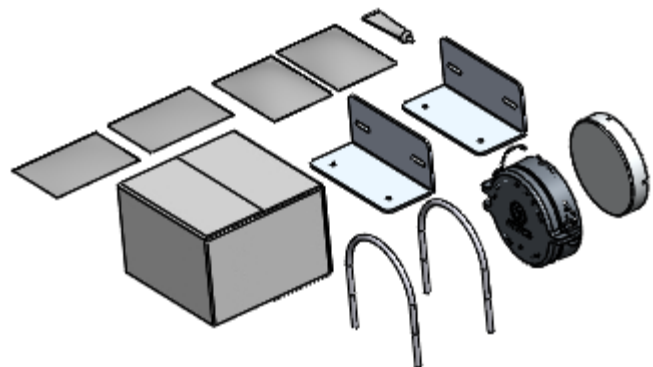

70-1LR / 70-2LR

**NOTE:**

RECOMMENDED USE OF A 6.4mm SETTING CAPACITY GUN FOR INSTALLATION. FOR INSTALLATION WE RECOMMEND THE USE OF THE FOLLOWING RIVET GUN MODELS (BOTH ARE POP® BRAND RIVET GUNS).

**DESCRIPTION:**

ProSet® 3400

ProSet® 3400MCS

**ARTICLE NUMBER:**

63407

63408

## **70-1 / 70-1LR (4") & 70-2 / 70-2LR (6") CONDUIT CARRIER KITS**

## - PRECAUTIONS -



**CAUTION**

**THE USE OF AIR IMPACT TOOLS CAN OVER-TORQUE FASTENERS AND CAUSE FASTENER FAILURE!**



**CAUTION**

**ALL INSTALLATION HOLES SHOULD BE SEALED WITH SILICON OR BUTYL SEALANT TO PREVENT EXHAUST FUMES FROM ENTERING THE VEHICLE!**



**DANGER**

**INSPECT FOR FUEL TANK, FUEL LINES, BRAKE LINES, HIGH VOLTAGE BATTERIES AND ELECTRICAL LINES PRIOR TO DRILLING TO AVOID DAMAGING CRITICAL VEHICLE SYSTEMS OR INJURY TO INSTALLER DURING INSTALLATION PROCESS!**



**CAUTION**

**TO AVOID DAMAGING THE VEHICLE ALWAYS USE DRILL STOPS WHEN DRILLING ANY INSTALLATION HOLES!**



## - IMPORTANT WARRANTY REQUIREMENTS -

1. SUBSTITUTING ADRIAN STEEL SPECIFIED FASTENERS FOR ASSEMBLY AND/OR INSTALLATION WILL VOID YOUR PRODUCT WARRANTY.
2. ALL HOLES DRILLED INTO VEHICLE SHOULD HAVE THE RAW METAL EDGES SEALED WITH A SELF-ETCHING PRIMER TO RESIST CORROSION AND POTENTIAL FASTENER POINT FAILURE.
3. ALL FASTENERS USED IN THE INSTALLATION OF THIS PRODUCT SHOULD BE TIGHTENED TO THE TORQUE(S) SPECIFIED IN THESE INSTRUCTIONS.
4. THESE INSTRUCTIONS SHOULD BE KEPT WITH THE VEHICLE.

### THE BASIC TOOLS NEEDED FOR MOST INSTALLATIONS



DRILL



DRILL BIT WITH STOP



RATCHET, SOCKETS AND/OR WRENCHES



SCREWDRIVERS



MEASURING TAPE

ADDITIONAL TOOLS MAY BE NEEDED FOR THIS INSTALLATION AND THEY WILL BE IDENTIFIED IN THE STEPS THAT FOLLOW.

**BAG70-1 FASTENER BAG**

ITEM NO.	PART NUMBER	DESCRIPTION	QTY.
1	FAS0110	Nut, Hex Nylk 3/8-16 SS W	4
2	FAS0104	Washer, Flat, 3/8, NI ZN	4
3	BAG0406-A	4" x 6" 3MIL AUTOBAG	1
4	FAS 0652 uncrimped	Rivet, Blind, Splitting, Buttonhead, 1/4x.25 Grip	8

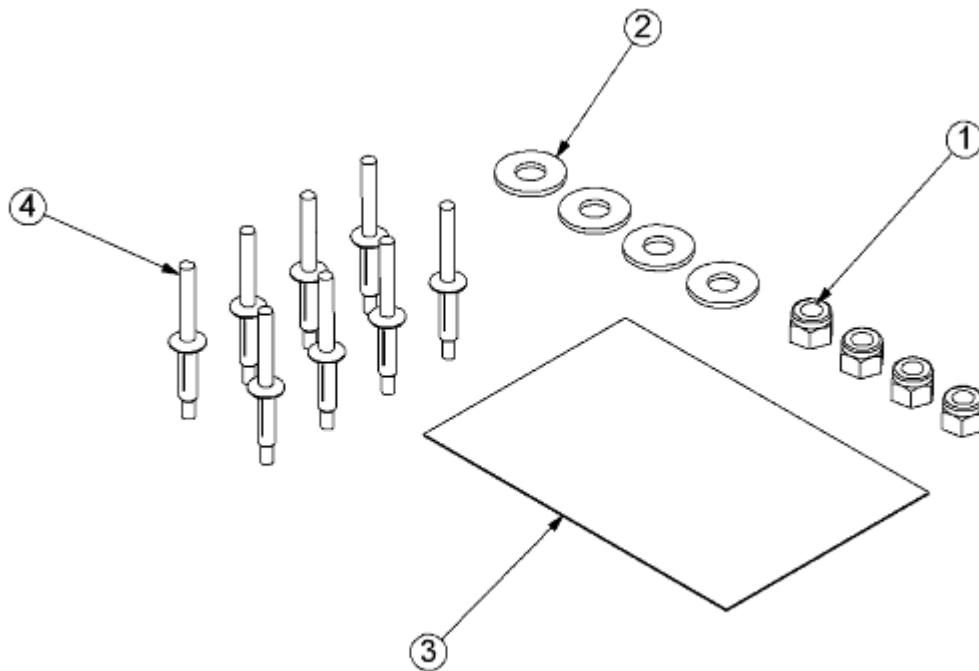

**BAG51693 FASTENER BAG**

(FOR 70-1LR AND 70-2LR)

ITEM NO.	PART NUMBER	DESCRIPTION	QTY.
1	BAG51693	BAG, FAS, ASM, 51693	1
2	FAS0248	Nut, Nylon Insert Lock, 5/16-18 SST	4
3	FAS0813	Screw, BHCS, 5/16-18X1.00, SS	4
4	FAS0552	Washer, Flat, 5/16, SST	4

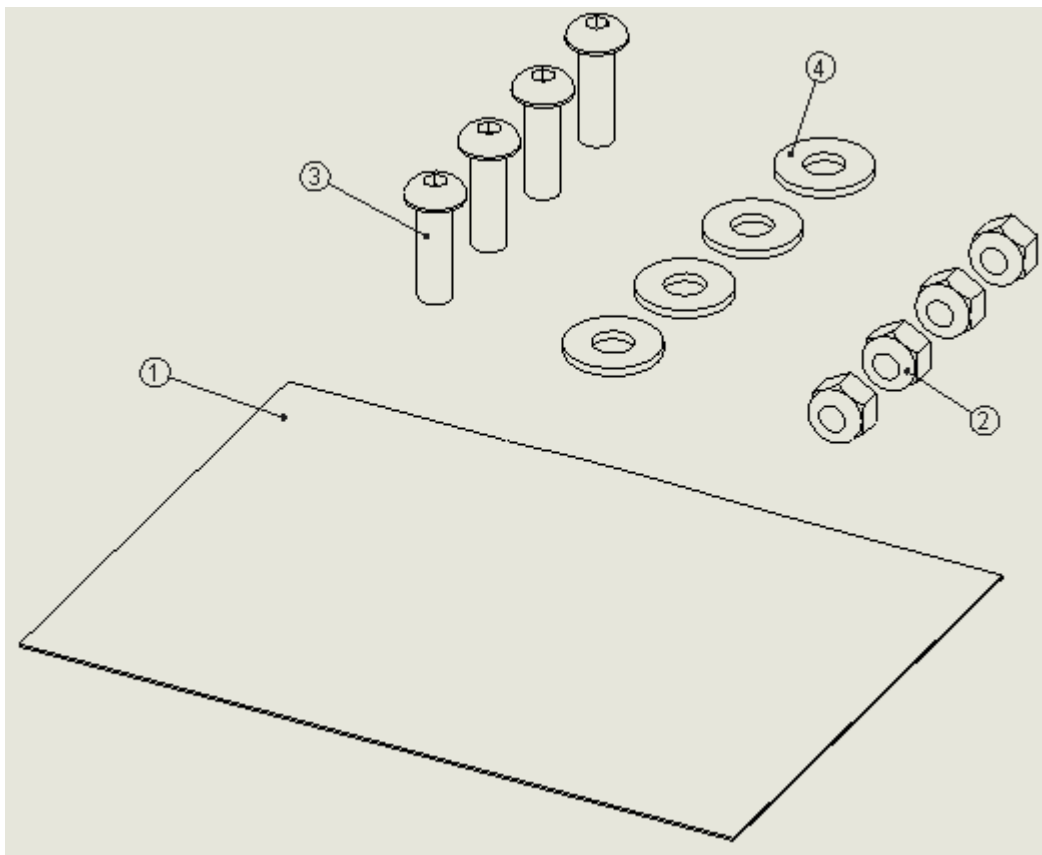

**STEP #1 : ASSEMBLE CONDUIT CARRIER**

**CUT PVC PIPE TO LENGTH. ENDS MUST BE SQUARE WITHIN +/- 1/16". CUT APPROX 6" LONGER THAN WHAT YOU WILL BE CARRYING. NOTE: ON FULL SIZE VANS, CROSS BOWS ARE TYPICALLY SPACED 7' ON CENTER. CONDUIT CARRIER NEEDS TO BE LONG ENOUGH TO REACH BEYOND BOWS AND EXTEND TO NEAR THE REAR END OF VAN FOR ACCESS.**

CLEAN PVC ENDS AND INSIDE END CAPS. MUST BE FREE OF OIL, DIRT, AND BURRS. APPLY SILICONE ADHESIVE TO BOTH THE OUTSIDE OF PVC AND INSIDE OF END CAPS. ASSEMBLE END CAPS ON TO PIPE. DRILL 4 HOLES IN EACH END USING HOLES IN END CAP AND LID ASM AS GUIDES. RIVET TOGETHER AS SHOWN USING RIVET TOOL FOR 5/32" MANDREL. REMOVE EXCESS SILICONE. CURES FULLY IN 24 HOURS.

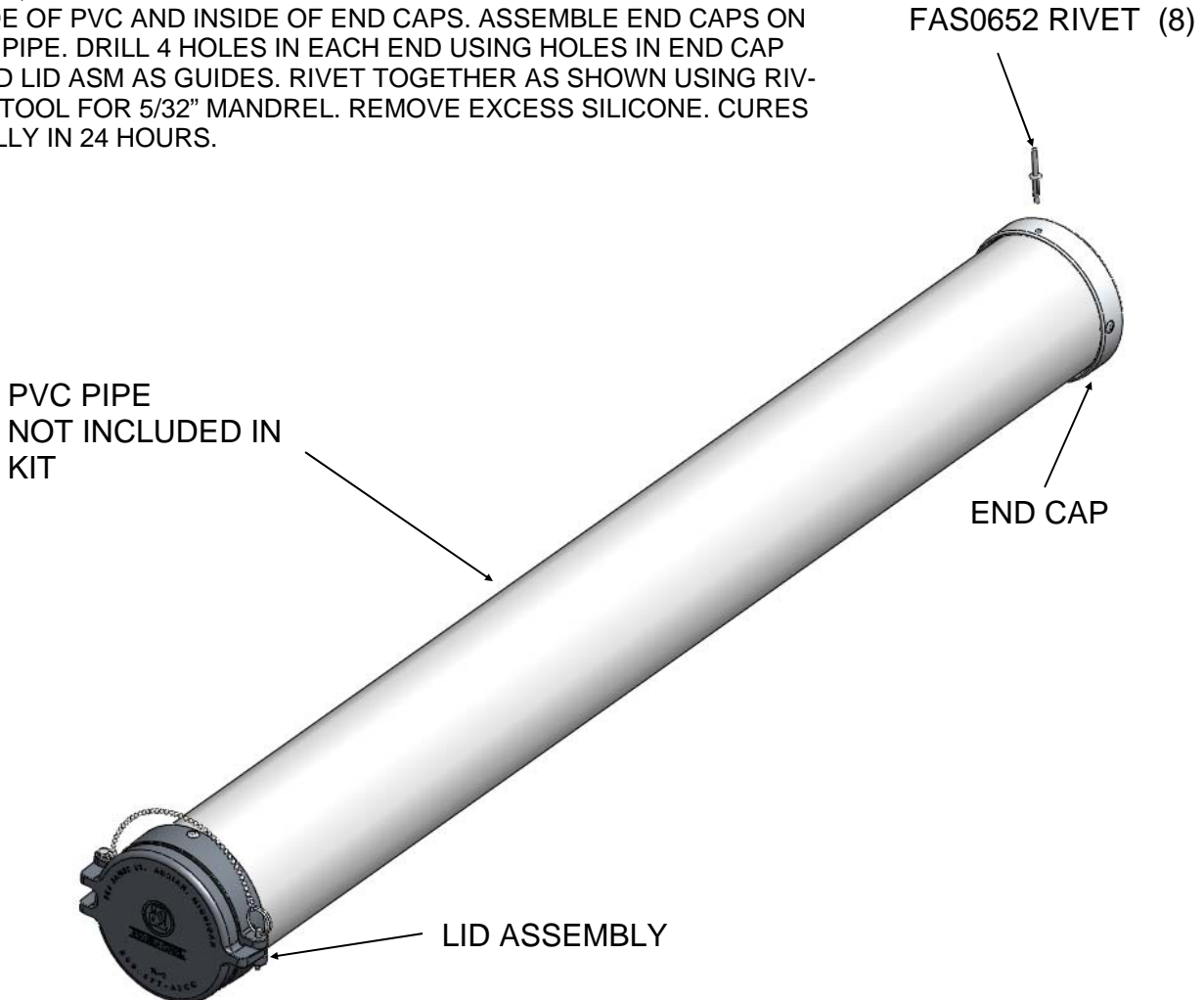



CROSS BOW OF ADRIAN STEEL  
LADDER RACK 70-1 / 70-2

CONDUIT CARRIER KIT

U-BOLT (2)

FAS0104 WASHER AND  
FAS0110 LOCKNUT  
TIGHTEN TO 20 FT LBS TORQUE.  
4 PLACES.

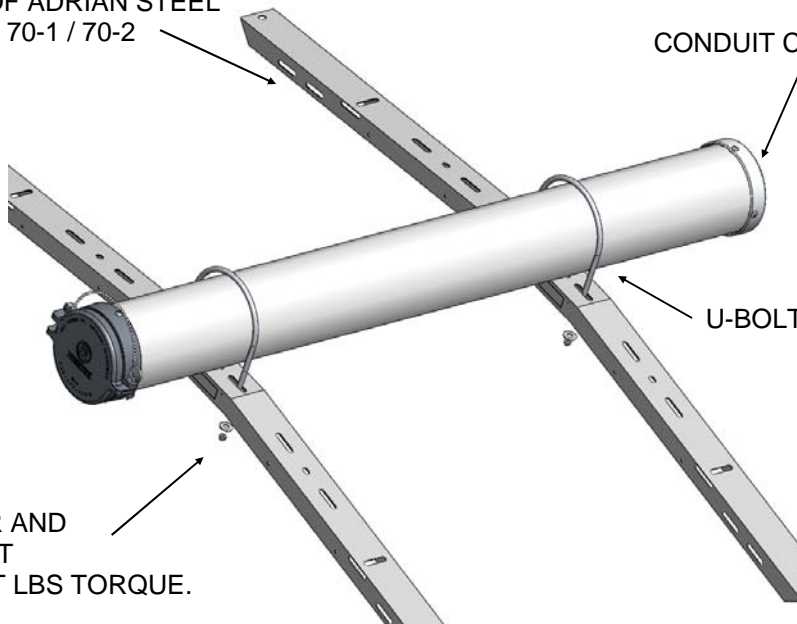

CROSS BOW OF ADRIAN STEEL  
ALUMINUM LADDER RACK 70-  
1LR / 70-2LR (W / BRACKET).  
TIGHTEN TO 20 FT LBS TORQUE.  
4 PLACES.

FRONT OF  
VEHICLE

FAS0104 FLAT WASHER = 4  
FAS0110 NUT 3/8-16 SS = 4  
  
ONE SET OF WASHER/NUT  
COMBINATION ATTACHED TO  
U-BOLT THROUGH  
UNDERSIDE OF CONDUIT  
BRACKET

REAR OF VEHICLE

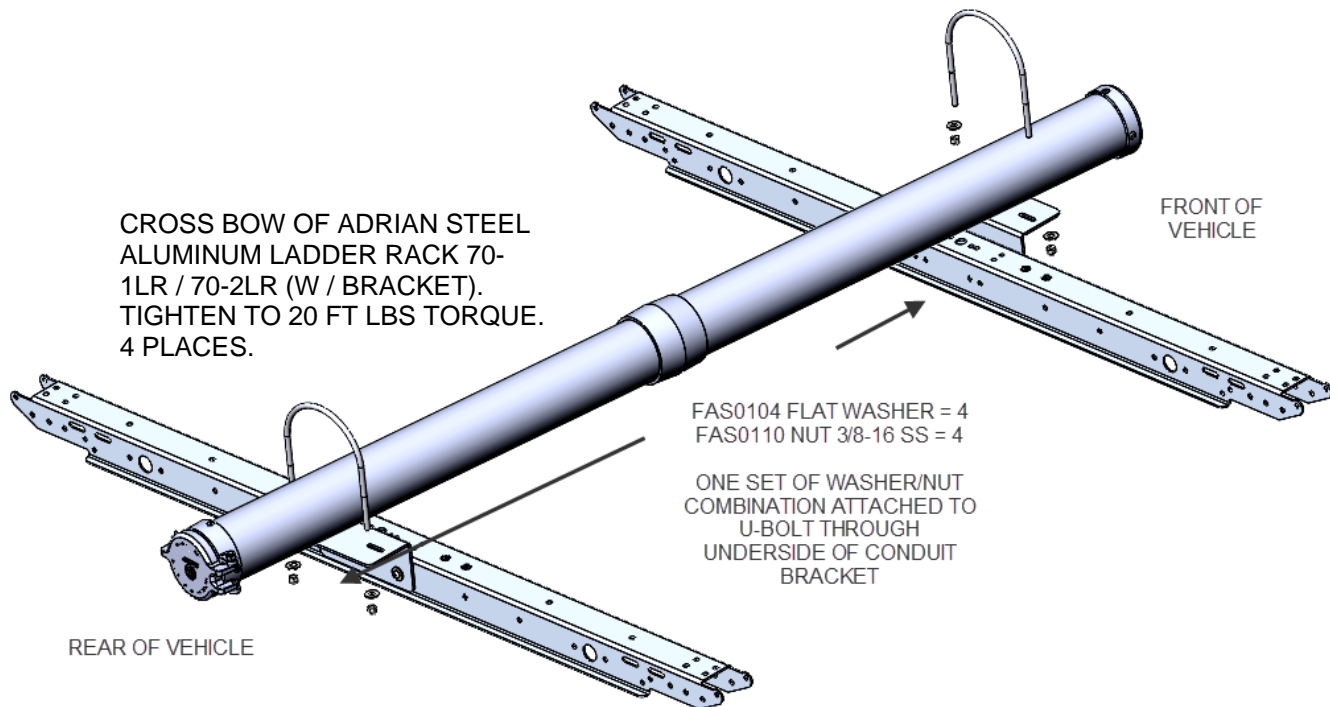

TYPICAL INSTALLATION ON ADRIAN STEEL LADDER RACKS.



**DOUBLE-CHECK ALL FASTENER LOCATIONS TO  
BE SURE THAT ALL FASTENERS ARE TIGHTENED  
TO SPECIFICATIONS!**



**Introduction / Comments:**

Mounting bracket kit to support 4" & 6" PVC conduit. Attached to RRK series ladder rack cross supports.

**Note:**

It is advised that all fasteners used in this assembly and installation should be checked for tightness at the following intervals: @ 2-weeks and again @ 6-weeks of operation. This preventive maintenance step must be completed to ensure your Product gives you long service life.



**4" & 6" PVC Conduit Carrier Mounting  
Bracket Installation**

## - PRECAUTIONS -



**CAUTION**



THE USE OF AIR IMPACT TOOLS CAN OVERTORQUE FASTENERS AND CAUSE FASTENER FAILURE!



**CAUTION**



ALL INSTALLATION HOLES SHOULD BE SEALED WITH SILICON OR BUTYL SEALANT TO PREVENT EXHAUST FUMES FROM ENTERING THE VEHICLE!



**DANGER**



INSPECT FOR FUEL TANK, FUEL LINES, BRAKE LINES, HIGH VOLTAGE BATTERIES AND ELECTRICAL LINES PRIOR TO DRILLING TO AVOID DAMAGING CRITICAL VEHICLE SYSTEMS OR INJURY TO INSTALLER DURING INSTALLATION PROCESS!



**CAUTION**



TO AVOID DAMAGING THE VEHICLE ALWAYS USE DRILL STOPS WHEN DRILLING ANY INSTALLATION HOLES! ADRIAN AVAILABLE PART #'S 31121-0 (3/8" X 1/2" DEEP), 31121-0 (1/2" x 1/2" DEEP)



## - IMPORTANT WARRANTY REQUIREMENTS -

1. SUBSTITUTING ADRIAN STEEL SPECIFIED FASTENERS FOR ASSEMBLY AND/OR INSTALLATION WILL VOID YOUR PRODUCT WARRANTY.
2. ALL HOLES DRILLED INTO VEHICLE SHOULD HAVE THE RAW METAL EDGES SEALED WITH A SELF-ETCHING PRIMER TO RESIST CORROSION AND POTENTIAL FASTENER POINT FAILURE.
3. ALL FASTENERS USED IN THE INSTALLATION OF THIS PRODUCT SHOULD BE TIGHTENED TO THE TORQUE(S) SPECIFIED IN THESE INSTRUCTIONS.
4. THESE INSTRUCTIONS SHOULD BE KEPT WITH THE VEHICLE.

## THE BASIC TOOLS NEEDED FOR MOST INSTALLATIONS



DRILL



DRILL BIT WITH STOP



RATCHET, SOCKETS AND/OR WRENCHES



SCREWDRIVERS



MEASURING TAPE

ADDITIONAL TOOLS MAY BE NEEDED FOR THIS INSTALLATION AND THEY WILL BE IDENTIFIED IN THE STEPS THAT FOLLOW.

If your vehicle contains carpet or a rubber floor mat you will need to prepare the mounting location. Position the product to be installed into the vehicle and once you are satisfied with the mounting locations, mark the mounting locations. Using a 1-3/16" diameter carpet cutter (P/N: 31183-0). Select the appropriate floor spacers as shown in the illustration. Set those aside for use later into the installation process.

Using the correct drill bit size for the selected plusnut, drill the mounting holes in the vehicle sheet metal to prepare for installing the plusnuts.

If you are thru-bolting at any of the locations simply drill a hole that is 1/16" larger than the bolt size(s) for those locations.

Once you have drilled the holes into the vehicle, the raw metal edges should be sealed using a self-etching primer to resist corrosion and potential fastener point failure.

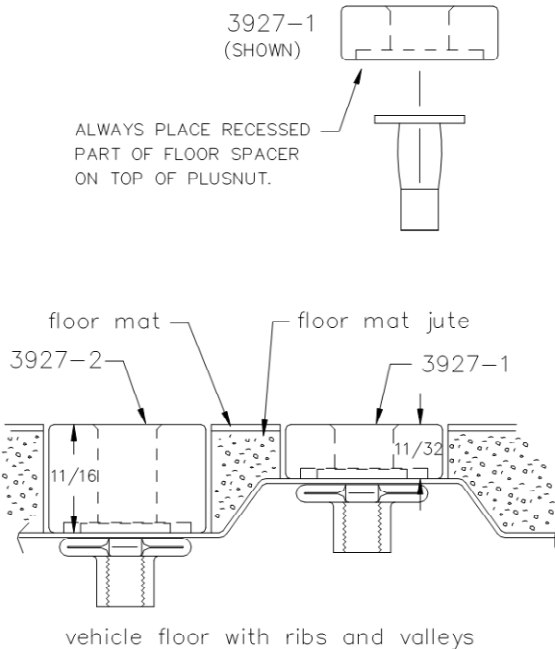

A PLUSNUT (RIVNUT) SETTING TOOL IS REQUIRED FOR PLUSNUT (RIVNUT) INSTALLATION . PLUS NUT SETTING TOOL CAN BE ORDERED THROUGH ADRIAN STEEL, OR USE AN AIR POWERED PLUSNUT SETTING GUN.

1/4-20UNC Plusnut (FAS0052) Use 3/8" dia. drill w/stop  
 FAS0080 SCREW, HXHD, 1/4-20UNCx2.00", G8  
 FAS0067 WASHER, FLAT, 1/4"ID  
 22200-0 PLUSNUT TOOL

5/16-18UNC Plusnut (FAS0091) Use 1/2" dia. drill w/stop  
 FAS0095 SCREW, HXHD, 5/16-18UNCx2.00", G8  
 FAS0086 WASHER, FLAT, 5/16"ID  
 22200-0 PLUSNUT TOOL

PLACE BARREL OF PLUSNUT BODY IN SHEET METAL THRU HOLE UNTIL FLANGE IS FLUSH WITH SHEET METAL.  
 USING A 9/16" COMBINATION WRENCH OF PLUSNUT TOOL BODY AND A SECOND HAND WRENCH, RATCHET OR AIR TOOL. ROTATE THE HEX BOLT HEAD CW TO DRAW PLUS NUT FLANGES UP (SET THE PLUSNUT).

**Installation and/or Assembly Fasteners**  
**(BAG51693)**

ITEM NO.	PART NUMBER	DESCRIPTION	QTY.
1	BAG51693	BAG, FAS, ASM, 51693	1
2	FAS0248	Nut, Nylon Insert Lock, 5/16-18 SST	4
3	FAS0813	Screw, BHCS, 5/16-18X1.00, SS	4
4	FAS0552	Washer, Flat, 5/16, SST	8

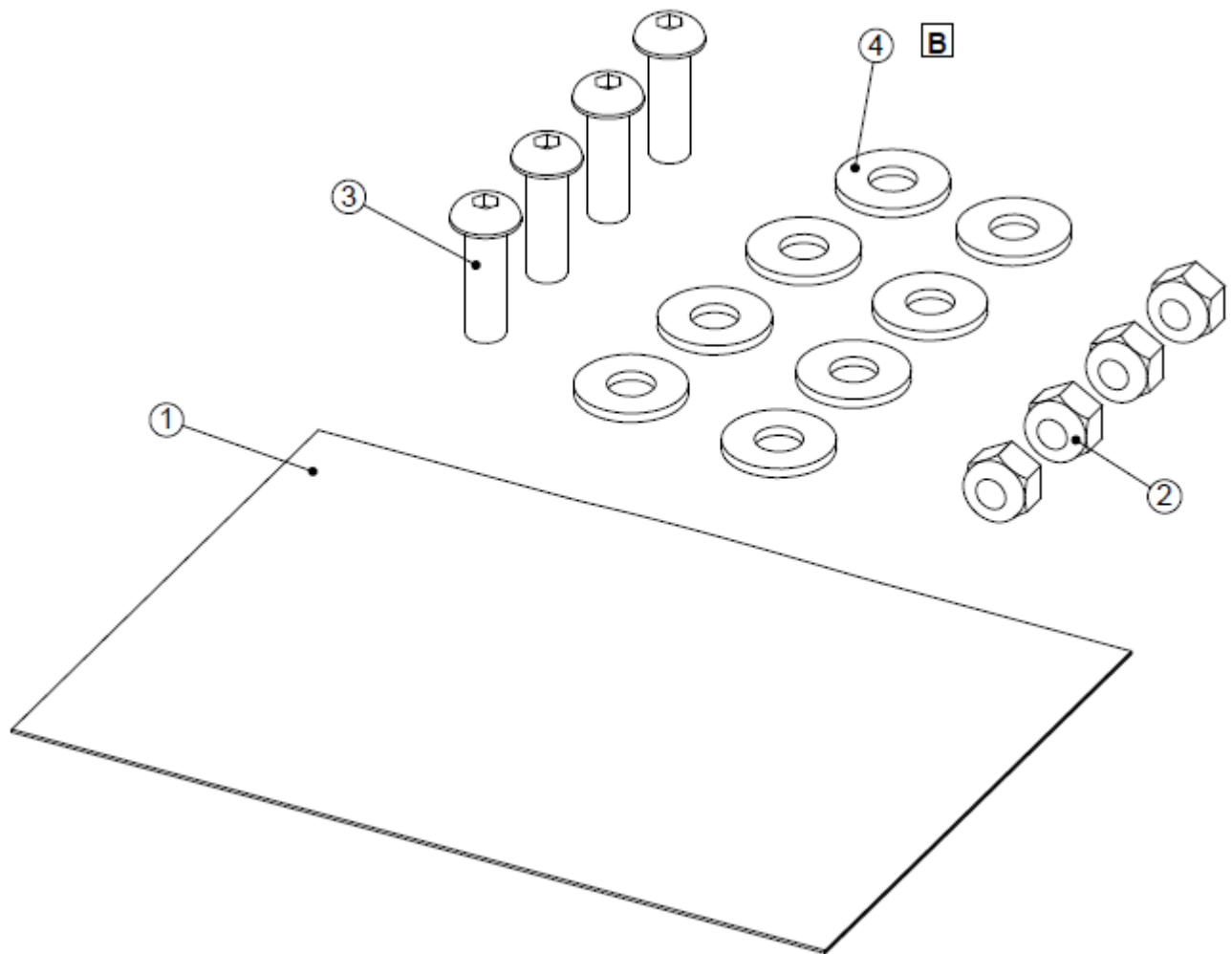

Attach brackets to RRK series cross support (front and rear). The flange must be facing outward on both the front and rear cross supports. Insert button head screws (FAS0813) with flat washer (FAS0552) into bracket and cross supports. Fasten flat washers (FAS0552) and hex nuts (FAS0248) on the inside of cross support channels. Torque to 14 in/lbs.

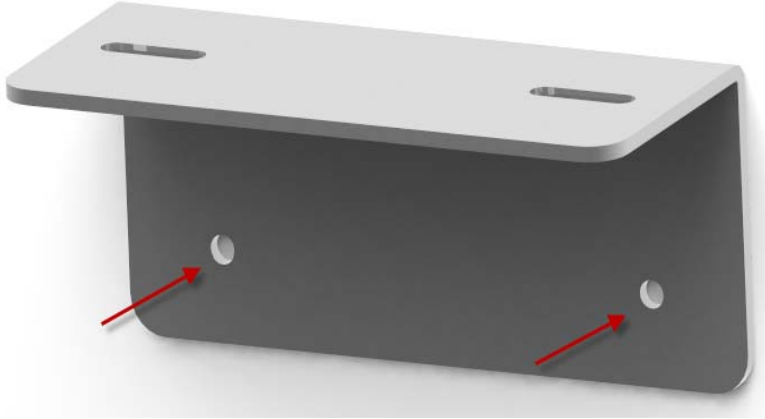

(Screw orientation)

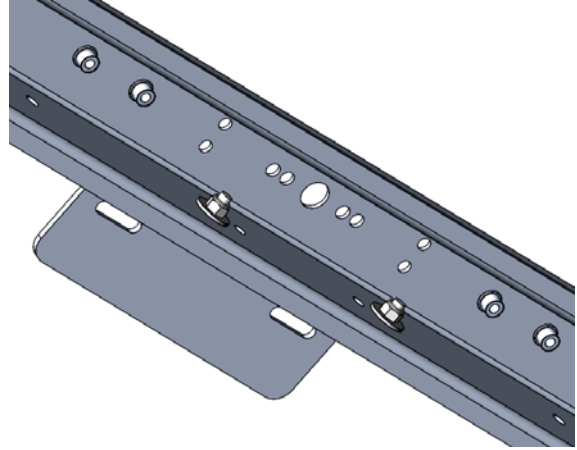

(Inside view of cross supports installed)

**SHIP THRU ONLY!!!**

After brackets are installed on cross supports, box and stow remaining conduit kit product in vehicle for ship thru.

(Bracket orientation)

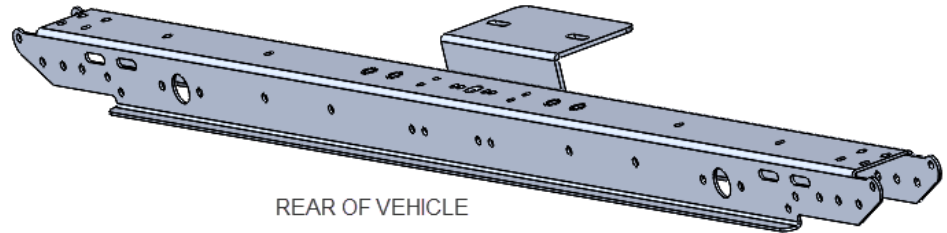

REAR OF VEHICLE

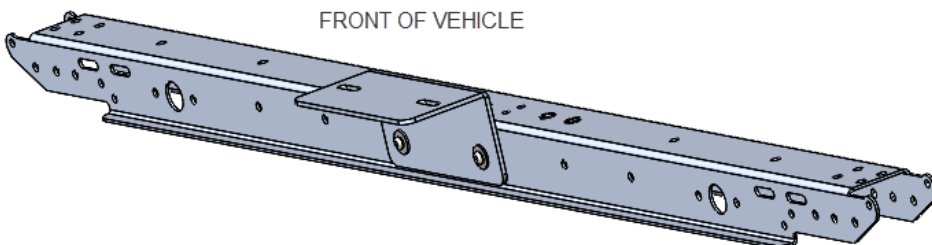

FRONT OF VEHICLE

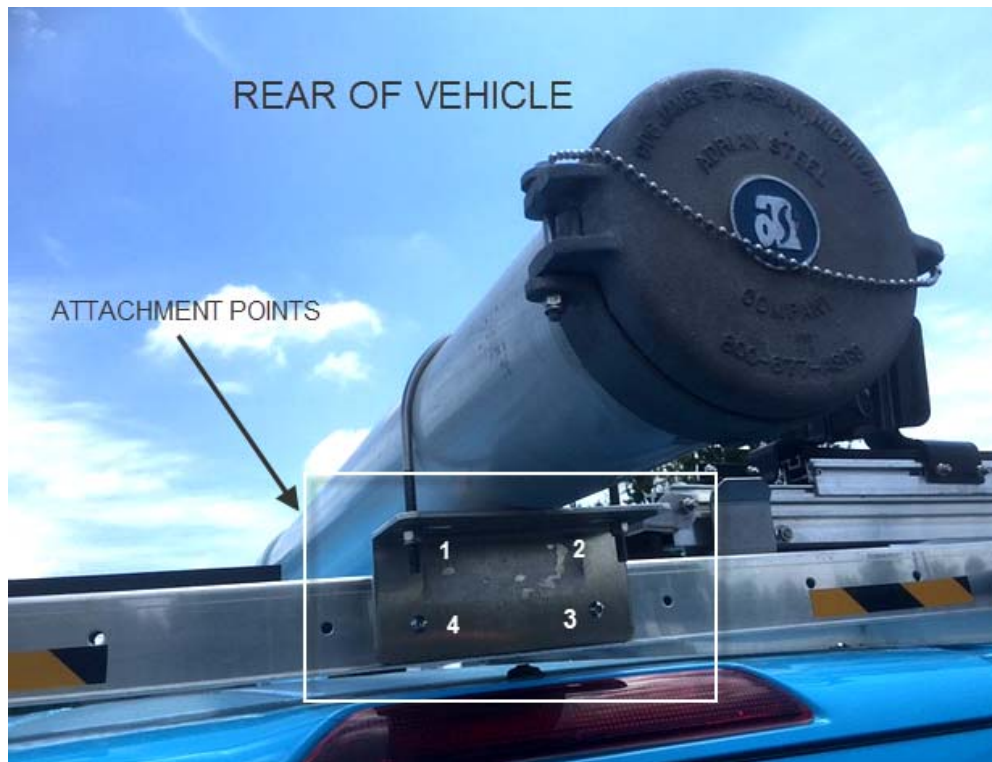

**DOUBLE CHECK ALL FASTENERS LOCATIONS TO BE SURE THAT ALL FASTENERS ARE TIGHTENED TO SPECIFICATIONS.**

**YOUR INSTALLATION IS NOW COMPLETE!  
STOW THIS COPY IN THE VEHICLE FOR FUTURE REFERENCES!**