

4" End Cap for PVC Conduit

PRODUCT WEIGHT
5 LBS

DIAMETER
4"

CAPACITY
N/A

COLOR

WHITE

CATALOG NUMBER

70-1NGLR



PRODUCT FEATURES

End caps and mounting straps for 4" diameter PVC conduit kit for PROFILE™ HD Utility, grip lock, drop down, and combo ladder racks. Works on all vehicle platforms. **DOES NOT** work with the Dual-Sided ProLift ladder rack on high roof vehicles (ex. PLM63 ____). Works with all uprights and rear rollers. **PVC NOT INCLUDED!**

Utility style ladder racks are not recommended for medium and high roof vehicles!

Please refer to OEM specific mounting kit and rail kit for additional information on compatible accessories.

SEE PAGE 2 FOR APPLICATION NOTES AND ACCESSORIES, OTHER PRODUCTS THAT WORK WITH THIS UNIT.



CATALOG NUMBER 70-1NGLR

PRODUCT APPLICATION

This product is for PROFILE™ HD Utility, grip lock, drop down, and combo ladder racks. Works on all vehicle platforms. DOES NOT work with the Dual-Sided ProLift Ladder rack on high roof vehicles (ex. PLM63___). Utility and grip lock style ladder racks are not recommended for medium or high roof vehicles!

ACCESSORIES THAT WILL WORK WITH THIS PRODUCT

CATALOG NUMBER	DESCRIPTION
2BARW	2-Crossbar Kit, 68”, White, Full Size Van
2BARCW	2-Crossbar Kit, 58”, White, Minivan
1BARW	Single Crossbar Kit, 68”, White, Full Size Van
1BARCW	Single Crossbar Kit, 58”, White, Minivan

INSTR. NUMBER : 64437	PG: 1	REV: B	ITEM NO.	PART NUMBER	DESCRIPTION	70-2NGLR	70-1NGLR
PART NUMBER • 70-2NGLR PART NUMBER • 70-1NGLR			1	12849-0	Canister Lid 6in. Assembly	1	-
			2	12846-0	Canister Back Cap 6"	1	-
PART • CONDUIT KIT, 6" PVC, NGLR DESC. • CONDUIT KIT, 4" PVC, NGLR			3	63745-W	CONDUIT STRAP, 6", WHITE	2	-
			4	63947-W	CONDUIT SPACER, 6", WHITE	2	-
			5	BAG64176	BAG FOR CONDUIT KIT,4"&6"	1	1
			6	11033-0	Silicone Sealant, 2.8oz tube	1	1
			7	12834-0	CANISTER LID 4in. ASM	-	1
			8	12831-0	END CAP 4"	-	1
			9	63948-W	CONDUIT SPACER, 4", WHITE	-	2
			10	63748-W	CONDUIT STRAP, 4", WHITE	-	2

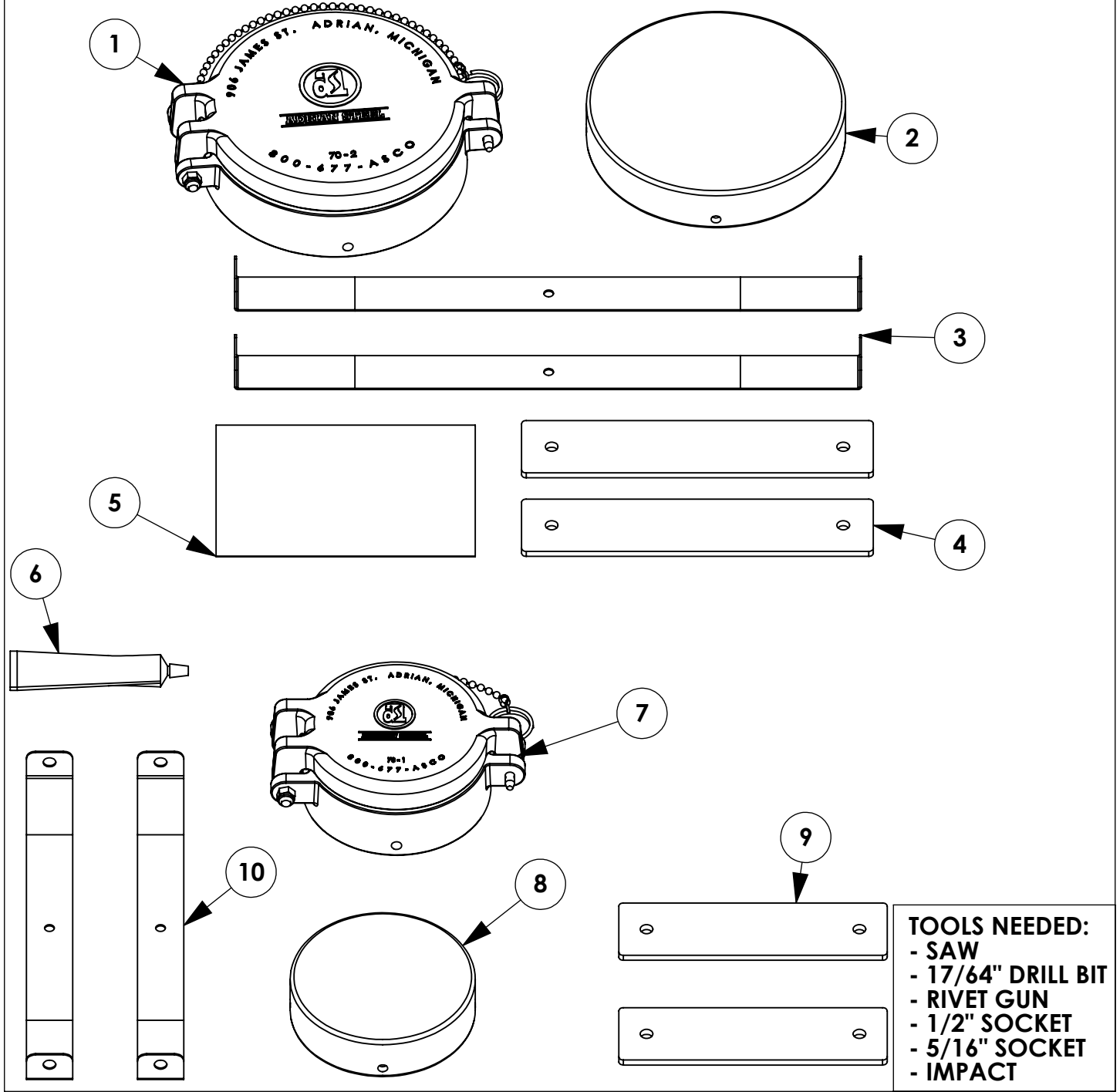

- TOOLS NEEDED:**
- SAW
 - 17/64" DRILL BIT
 - RIVET GUN
 - 1/2" SOCKET
 - 5/16" SOCKET
 - IMPACT

GET TO KNOW THE VEHICLE - AT THE BEGINNING OF ANY INSTALLATION, CHECK THE LOCATION OF THE FUEL TANK, FUEL LINES, BRAKE LINES, HIGH VOLTAGE BATTERIES AND WIRING HARNESES TO AVOID INJURY OR PROPERTY DAMAGE FROM TOOL CONTACT.

SEAL ALL EXTERIOR HOLES - ALL INSTALLATION HOLES SHOULD BE SEALED WITH BUTYL TAPE OR SILICON TO PREVENT WATER AND EXHAUST GASES FROM ENTERING THE VEHICLE.

CONTROL DRILL DEPTH - TO AVOID DAMAGE TO THE VEHICLE, USE A DRILL STOP OR CLEARED STEP BIT WHEN DRILLING INSTALLATION HOLES.

ALWAYS ADD PRIMER - WHEN ADDING INSTALLATION HOLES BE SURE TO USE A SELF-ETCHING PRIMER TO PREVENT CORROSION, FASTENER FAILURE AND INJURY.

MOUNTING POINTS MUST HAVE METAL-TO-METAL CONTACT - USE PROVIDED MOUNTING SPACERS TO ACCOMMODATE FOR VEHICLE FEATURES, CARPET OR SUBFLOORS.

PROVIDE CLEARANCE FOR SPACERS - IF THE INSTALLATION VEHICLE CONTAINS A CARPET OR SUBFLOOR, USE A 1-3/16" DIAMETER CARPET CUTTER (P/N: 31183-0) AT ALL MOUNTING LOCATIONS TO OPEN UP ROOM FOR SPACERS.

CHECK SPACER ORIENTATION - BE SURE THAT THE INDENT IN THE SPACER COVERS THE PLUSNUT HEAD; THIS ENSURES THE MOST METAL-TO-METAL CONTACT AND REDUCES VIBRATION.

PLUSNUT INSTALLATION - A PLUSNUT GUN IS RECOMMENDED FOR PLUSNUT INSTALLATION FOR ITS PRODUCTION SPEED. HOWEVER, A PLUSNUT SETTING TOOL CAN ALSO BE USED (P/N: 22200-0).

THRU-BOLT CLEARANCE - WHEN USING A THRU-BOLT AT ANY MOUNTING LOCATION, BE SURE THAT YOUR HOLE HAS 1/16" CLEARANCE.

FASTENERS AND HARDWARE USED

BAG REFERENCE: BAG64176

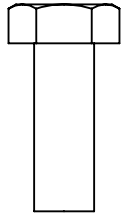

**FAS0283
5/16-18X0.875 SS
HH SCREW
QTY: 4**

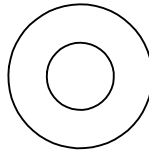

**FAS0552
5/16 SS
FLAT WASHER
QTY: 4**

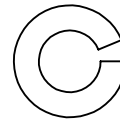

**FAS0588
5/16 SS
LOCK WASHER
QTY: 4**

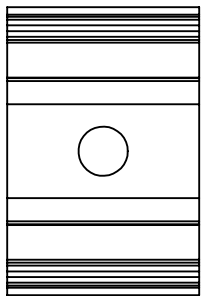

**63490
RAIL SLIDE, 1"
QTY: 4**

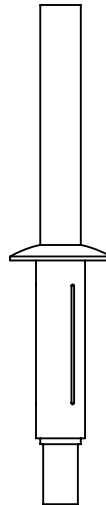

**FAS0652
.25X.62 AL
BLND RIVET
QTY: 10**

FASTENERS USED

INTENTIONALLY LEFT BLANK

STEP 1 - CHECK RACK PROGRESS

Step 1.1
CONDUIT KIT IS MOST EASILY INSTALLED WHEN RACK IS ON THE ROOF. BE SURE THAT THE WEAR STRIP AND DRIVER'S SIDE END CAPS ARE NOT INSTALLED.

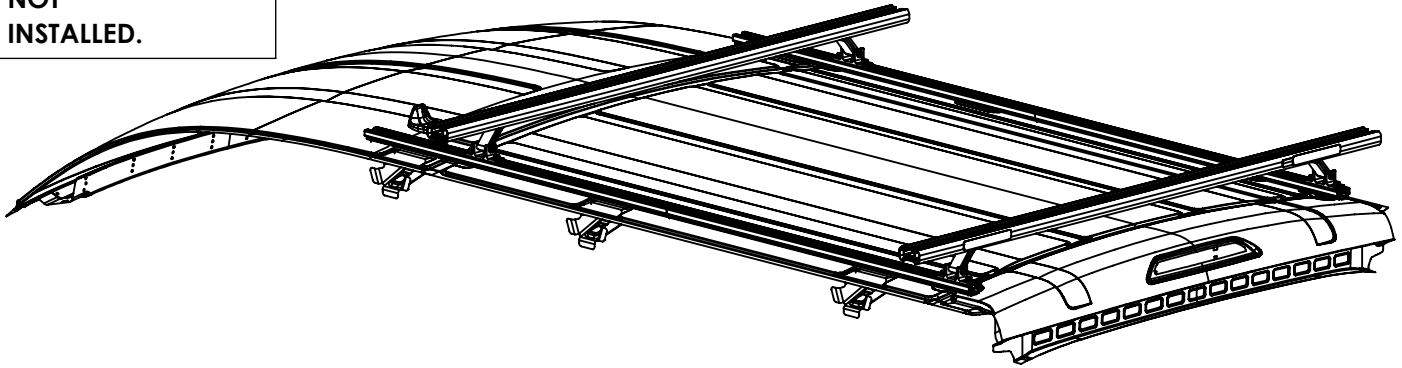

STEP 2 - CUT WEAR STRIP

Step 2.1
CUT WEAR STRIP DOWN
SAW

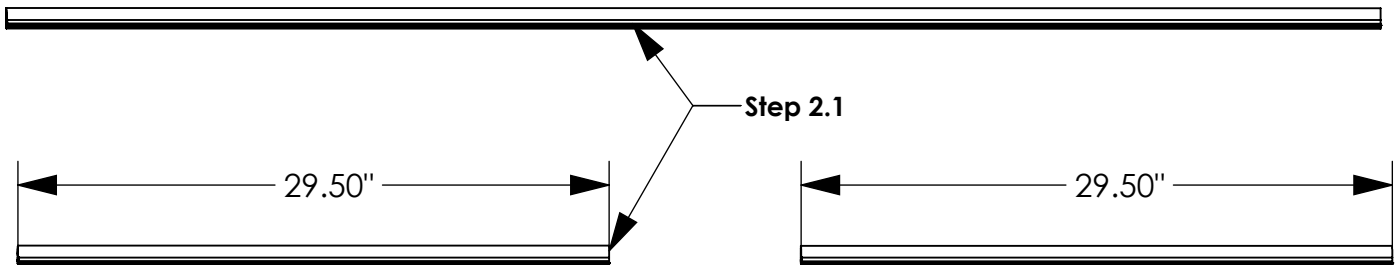

ADD ONE OF THE CUT WEAR STRIPS TO EACH OF THE CROSSBOWS.

FOR 70-1NGLR, CUT WEAR STRIPS TO LENGTH OF 30.625"

STEP 3 - ASSEMBLE END CAPS TO PVC PIPE

Step 3.1
MARK AND DRILL
OUT
END CAP HOLES.
17/64 DRILL BIT

Step 3.2
FAS0652
(4 PLACES PER
END CAP)
RIVET GUN

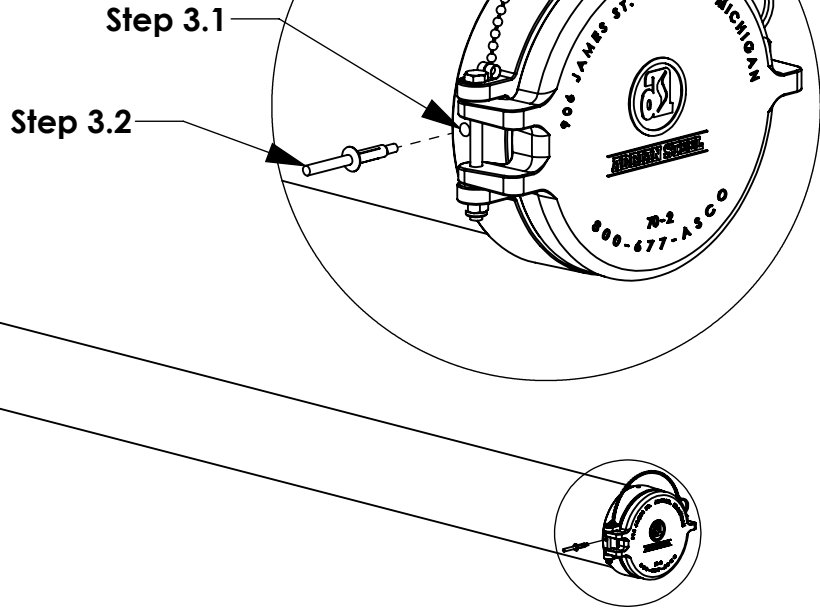

STEP 4 - ASSEMBLE CONDUIT KIT BRACKETS

Step 4.1
FAS0597, FAS0588
FAS0552, 35335-0
(4 PLACES)
LOOSE INSTALL

KEEP LOOSE ENOUGH TO
SLIDE DOWN THE PVC
PIPE FOR ALIGNMENT

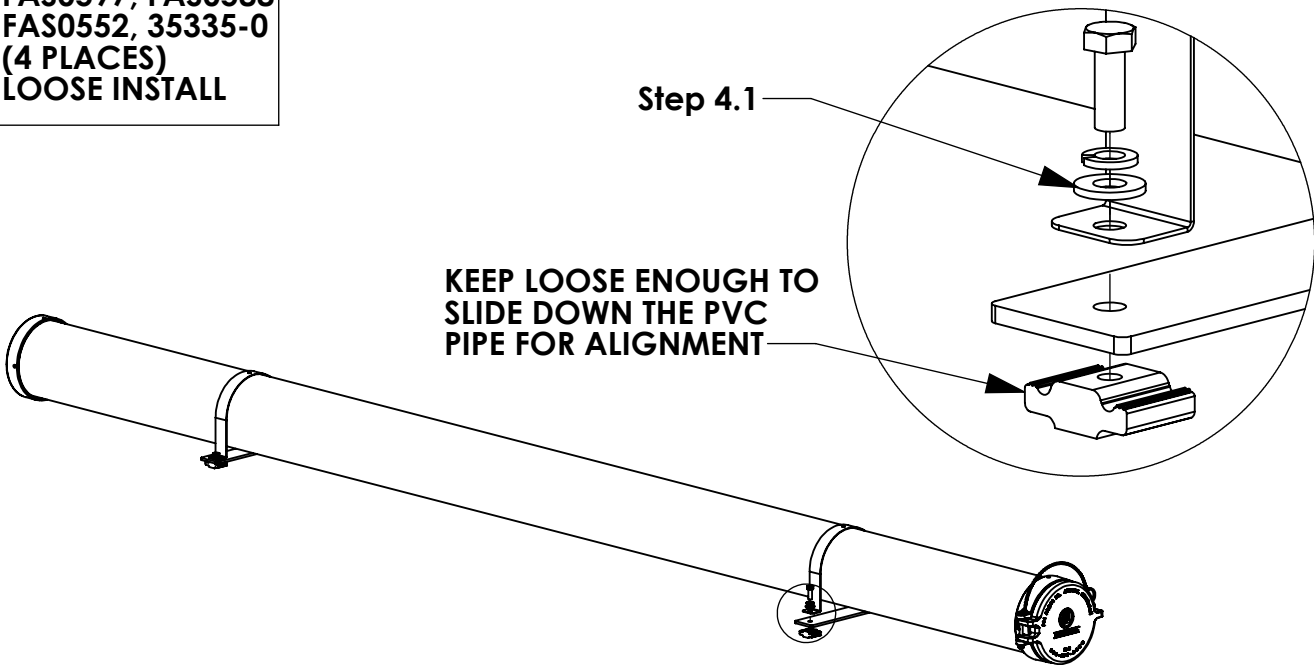

STEP 5 - INSTALL CONDUIT KIT ONTO RACK

**Step 5.1
MAKE SURE THE
HINGED END
CAP IS AT THE
REAR**

**Step 5.2
SLIDE THE
CONDUIT KIT
ASSEMBLY INTO
THE
CENTER OF THE
CROSSBOW**

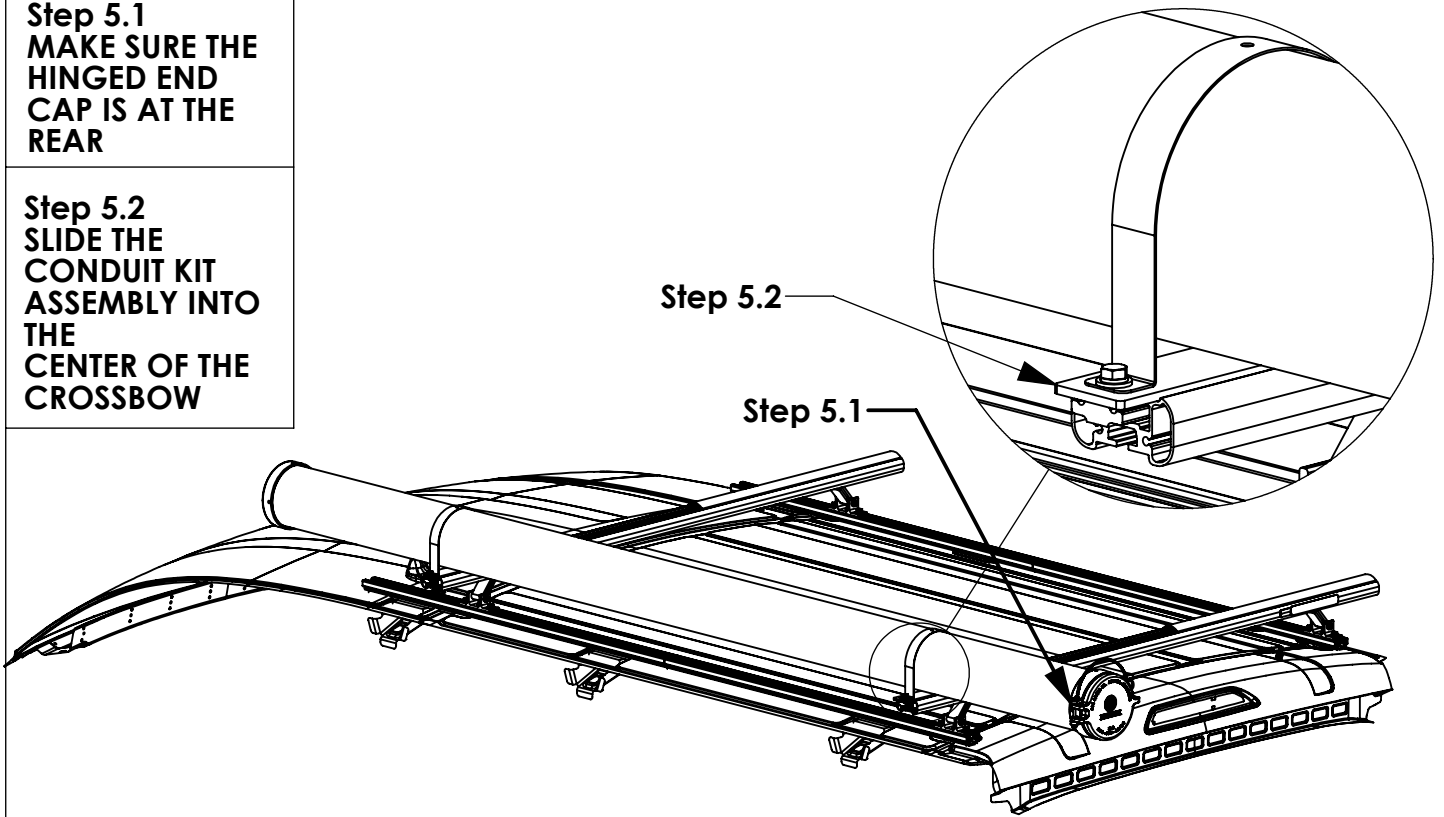

STEP 6 - SECURE CONDUIT KIT

**Step 6.1
ALIGN THE END
OF THE
CONDUIT KIT
WITH THE
REAR OF THE
VEHICLE**

**Step 6.2
SECURE
CONDUIT KIT
1/2 SOCKET
(4 PLACES)**

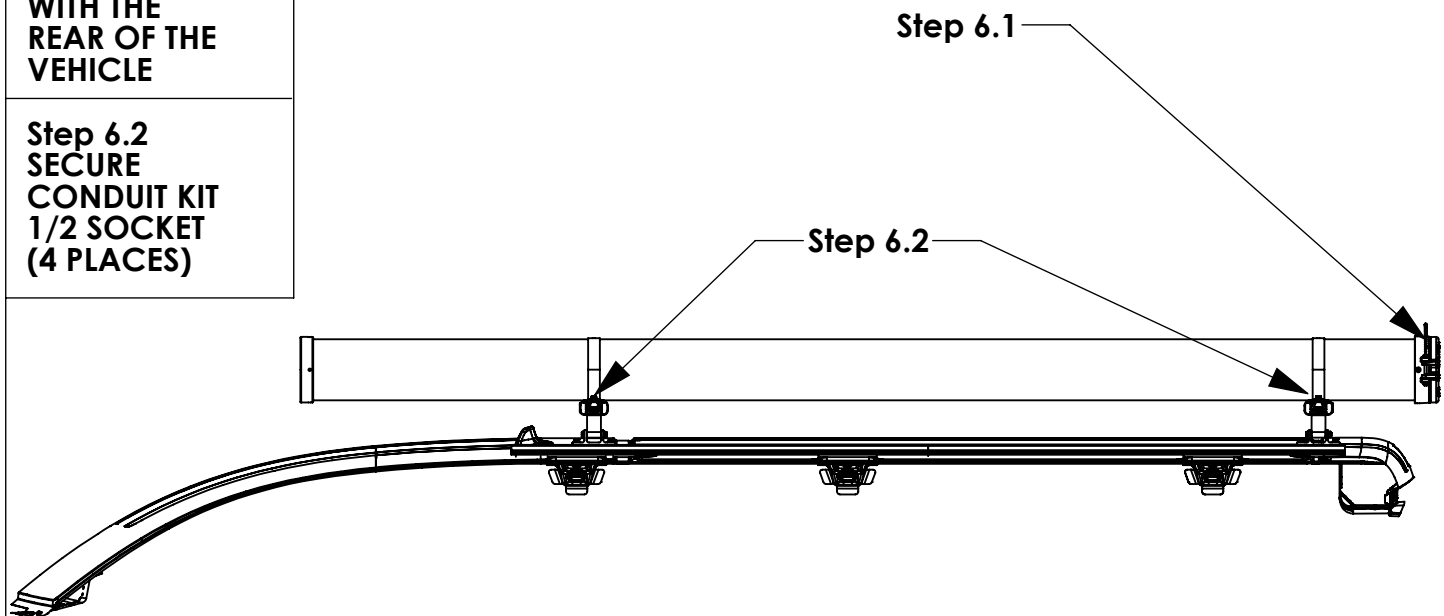

STEP 7 - SECURE CONDUIT KIT

**Step 7.1
ADD THE
SECOND,
CUT WEAR STRIP
TO EACH
CROSSBOW.**

**Step 7.2
FAS0473
(2 PLACES PER
CROSSBOW)
5/16 SOCKET**

