

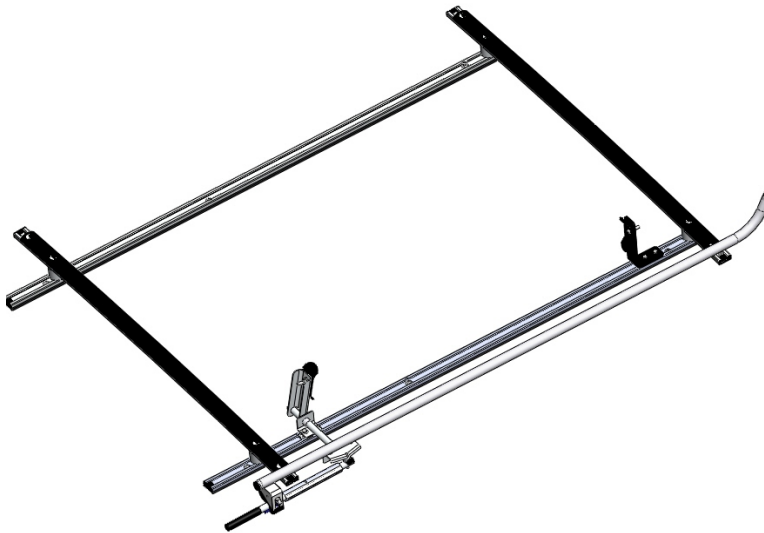

ADRIAN STEEL

Cargo Management Solutions for Commercial Vehicles

61-PMC Single Grip-Lock Ldr Rack



PRODUCT WEIGHT

40 Lbs

WIDTH x DEPTH x HEIGHT

62" x 85" x 8"

CAPACITY

**24' Extension Ladders
Or 125 Lbs
See Below**

COLOR

Aluminum & Black

CATALOG NUMBER

61-PMC

PRODUCT FEATURES

LIGHTWEIGHT, SINGLE GRIP-LOCK LADDER RACK FOR THE DODGE PROMASTER CITY VAN. CAN CARRY UP TO 12' STEP LADDERS AND 24' EXTENSION LADDERS. CAPACITY OF 1 LADDER. ALUMINUM CONSTRUCTION WITH COMPOSITE SURFACES TO PREVENT DAMAGE TO LADDERS AND STAINLESS STEEL FASTENERS. NO DRILL INSTALLATION! ATTACHES TO FACTORY INSTALLED MOUNTING FASTENERS.

SEE PAGE 2 FOR APPLICATION NOTES AND ACCESSORIES, OTHER PRODUCTS THAT WORK WITH THIS UNIT.

PAGE 1 of 2

The information contained in this document is the sole property of ADRIAN STEEL COMPANY. ADRIAN STEEL COMPANY retains the right to modify and/or change the product of its design at any time without prior notification.



CATALOG NUMBER 61-PMC

PRODUCT APPLICATION

THIS PRODUCT IS DESIGNED SPECIFICALLY FOR THE DODGE PROMASTER CITY VAN.

ACCESSORIES THAT WILL WORK WITH THIS PRODUCT

<i>CATALOG NUMBER</i>	<i>DESCRIPTION</i>
1BPMCGL	CENTER BOW ADD-ON KIT FOR CARRYING SHORT LADDERS
61TCSSUR	STREET SIDE UTILITY ADD-ON KIT TO CONVERT STREET SIDE TO A UTILITY RACK.
61PMCSSGL	STREET SIDE G/L CONVERSION KIT TO DBL

SPECIAL APPLICATION NOTES

Additional accessories may be compatible with this product. Please consult with ADRIAN STEEL ENGINEERING to review specific applications not listed here.



Introduction / Comments:

THIS LADDER RACK IS DESIGNED TO MOUNT TO THE FACTORY ATTACHMENT POINTS. REMOVE PLASTIC PLUGS TO INSTALL NEW RACK.

THIS RACK IS DESIGNED FOR AND RATED TO CARRY UP TO 24' EXTENSION LADDERS OR 115 LBS EVENLY DISTRIBUTED ON THE RACK. BE SURE ANY LOAD OR LADDER IS PROPERLY SECURED TO THE RACK PRIOR TO MOVING VEHICLE.

INSTALLATION OF THIS RACK DOES **NOT** ACCOMMODATE USE OF SUNROOF!!!

NOTE : THIS RACK UTILIZES SPECIFIC STREET AND CURB SIDE ROOF RAILS!!!

Note:

It is advised that all fasteners used in this assembly and installation of this Rack should be checked for tightness at the following intervals: @ 2-weeks and again @ 6-weeks of operation. This preventive maintenance step must be completed to ensure your package gives you long service life.

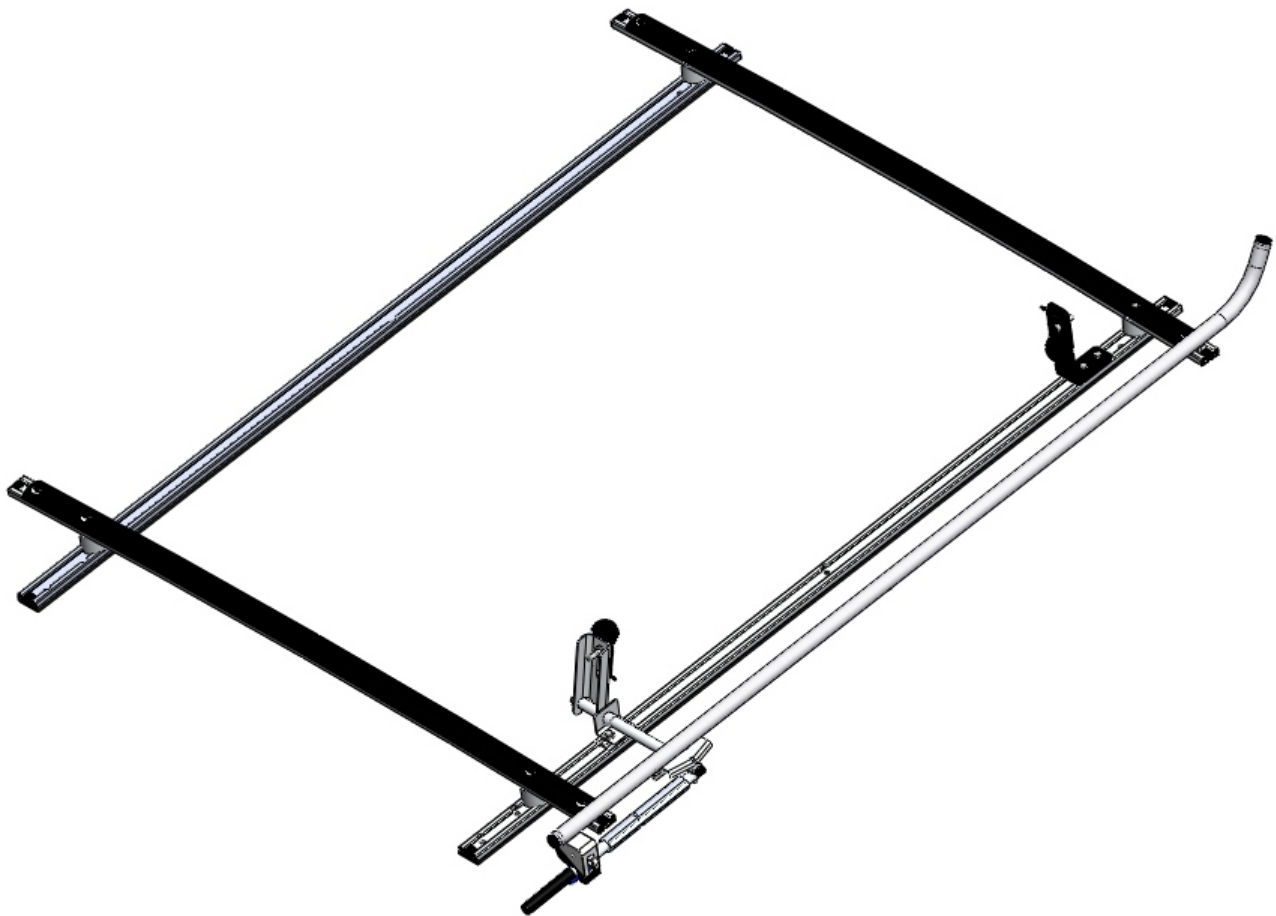

61-PMC SINGLE GRIP-LOCK LADDER RACK ASM FOR PROMASTER CITY CARGO VAN



- PRECAUTIONS -



CAUTION
THE USE OF AIR IMPACT TOOLS CAN
OVER-TORQUE FASTENERS AND
CAUSE FASTENER FAILURE!



CAUTION
ALL INSTALLATION HOLES SHOULD BE SEALED
WITH SILICON OR BUTYL SEALANT TO PREVENT
EXHAUST FUMES FROM ENTERING THE VEHICLE!



DANGER
INSPECT FOR FUEL TANK, FUEL LINES, BRAKE LINES, HIGH
VOLTAGE BATTERIES AND ELECTRICAL LINES PRIOR TO
DRILLING TO AVOID DAMAGING CRITICAL VEHICLE SYSTEMS
OR INJURY TO INSTALLER DURING INSTALLATION PROCESS!



CAUTION
TO AVOID DAMAGING THE VEHICLE ALWAYS
USE DRILL STOPS WHEN DRILLING ANY IN-
STALLATION HOLES!



- IMPORTANT WARRANTY REQUIREMENTS -

1. SUBSTITUTING ADRIAN STEEL SPECIFIED FASTENERS FOR ASSEMBLY AND/OR INSTALLATION WILL VOID YOUR PRODUCT WARRANTY.
2. ALL HOLES DRILLED INTO VEHICLE SHOULD HAVE THE RAW METAL EDGES SEALED WITH A SELF-ETCHING PRIMER TO RESIST CORROSION AND POTENTIAL FASTENER POINT FAILURE.
3. ALL FASTENERS USED IN THE INSTALLATION OF THIS PRODUCT SHOULD BE TIGHTENED TO THE TORQUE(S) SPECIFIED IN THESE INSTRUCTIONS.
4. THESE INSTRUCTIONS SHOULD BE KEPT WITH THE VEHICLE.

THE BASIC TOOLS NEEDED FOR MOST INSTALLATIONS



DRILL



DRILL BIT WITH
STOP



RATCHET, SOCKETS
AND/OR WRENCHES



SCREWDRIVERS



MEASURING TAPE

ADDITIONAL TOOLS MAY BE NEEDED FOR THIS INSTALLATION AND THEY WILL BE IDENTIFIED IN THE STEPS THAT FOLLOW.



**BAG61PMC
FASTENER BAG FOR 61-PMC LADDER RACK**

ITEM NO.	PART NUMBER	DESCRIPTION	QTY.
1	35335-0	SLIDE	8
2	36496-0	END CAP	8
3	FAS0698	PIN, SPRING .312X1.50 SS	1
4	FAS0577	Screw, Button Hd Hex Soc, 3/8-16x1.50 NI-ZN	2
5	FAS0830	Screw, Hex Hd, 5/16-18 X 1.25 SS	3
6	FAS 0720	Washer, Flat 3/8 SS	2
7	FAS0110	Nut, Hex Nylk 3/8-16 SS W	2
8	FAS0717	Screw, Hex Hd, 5/16-18x.625 SST	4
9	FAS0740	Shoulder Bolt,	1
10	FAS0234	Washer, Flat, 1/4, SST	11
11	FAS0125	Nut, Nylon Insert Lock, 1/4-20 SST	1
12	FAS0588	Washer, Lock, Split, 5/16, SS	13
13	BAG0709-A	7" x 9" 3MIL AUTOBAG	1
14	FAS0242	Screw, Hex Hd, 5/16-18x1.50 Stainless Steel	2
15	FAS0552	Washer, Flat, 5/16, SST	13
16	FAS0243	Screw, Hex Hd, 5/16-18x2.50 Stainless Steel	4
17	FAS0315	Screw, Button Hd Hex Soc, M6-1 X 30 mm lg, SST	10
18	FAS0672	Washer, Lock, Split, 1/4", SST	10

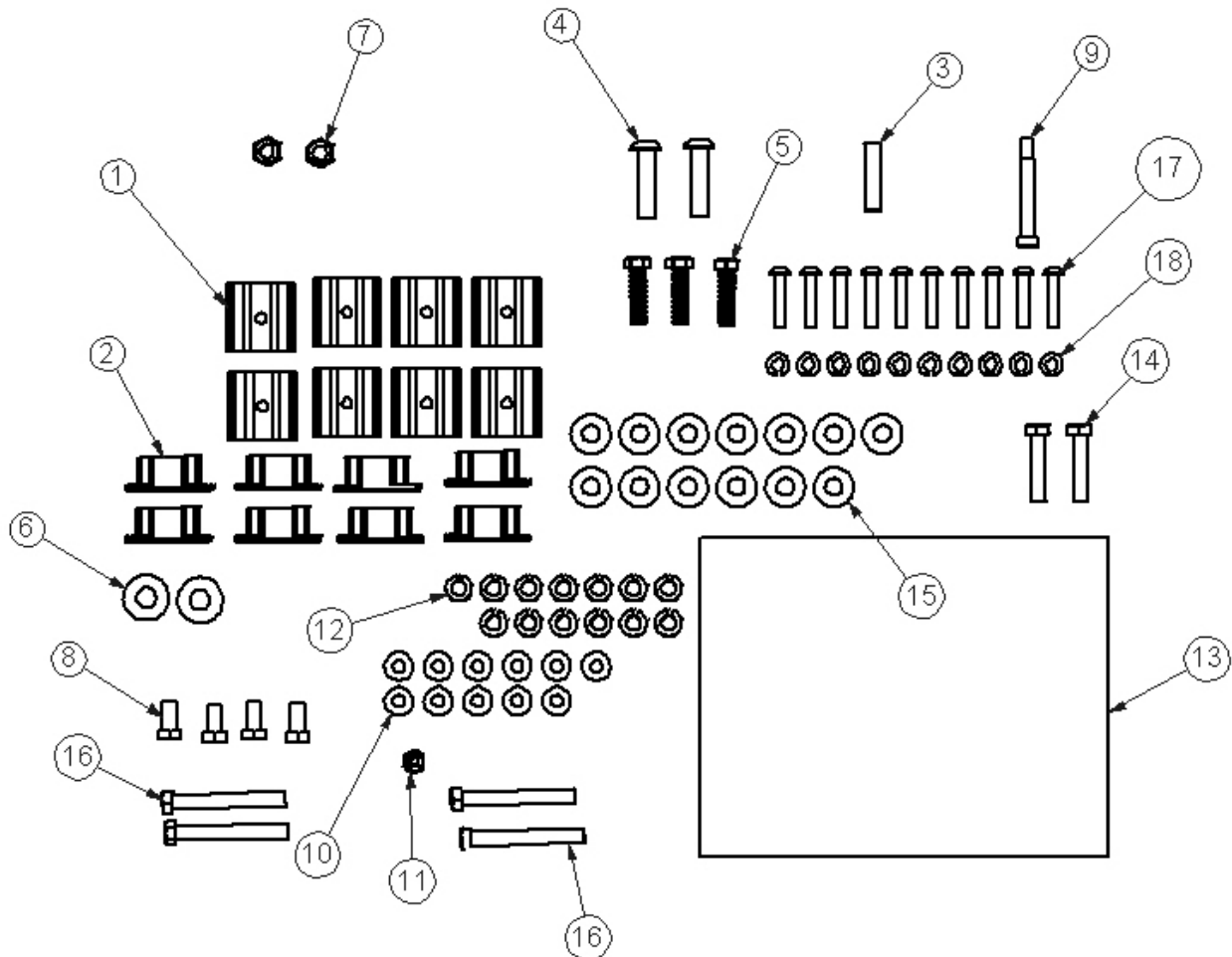



BAG45261 ACCESSORY BAG FOR 61-PMC

ITEM NO.	PART NUMBER	DESCRIPTION	BAG45261/QTY.
1	38846-B	BUSHING, G/L, TC	2
2	37517-0	End Cap, Black	2
3	51363	CAP PLUG, RND, BLK, 1 DIA	2
4	BAG0507-A	5" x 7" 3MIL AUTOBAG	1
5	28818-0	Silicone Sealant	1
6	05588-0	Butyl Tape, T224 -1/2"X 1' Roll	2

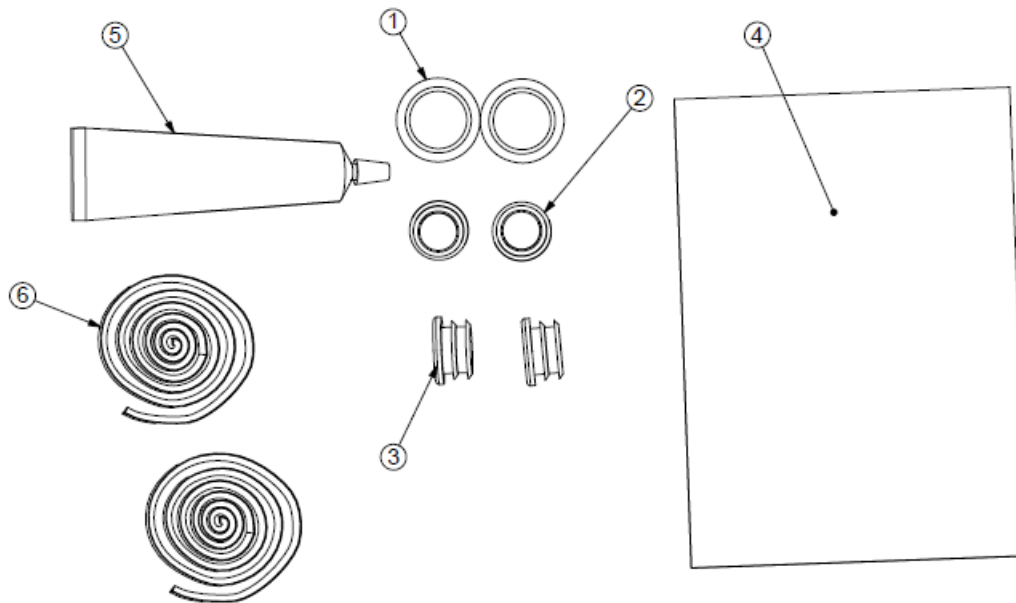



STEP #01: ASSEMBLE ROOF RAILS. NOTE DIFFERENCES BETWEEN STREET AND CURB SIDE ROOF RAILS!!

INSERT (6) 35335-0 SLIDES INTO CURB SIDE ROOF RAIL, 2 SLIDES INTO STREET SIDE ROOF RAIL, AND (1) 36496-0 END CAP INTO EACH END (4 TOTAL). PEEL AND STICK FOAM STRIP TO BOTTOM OF EACH RAIL.

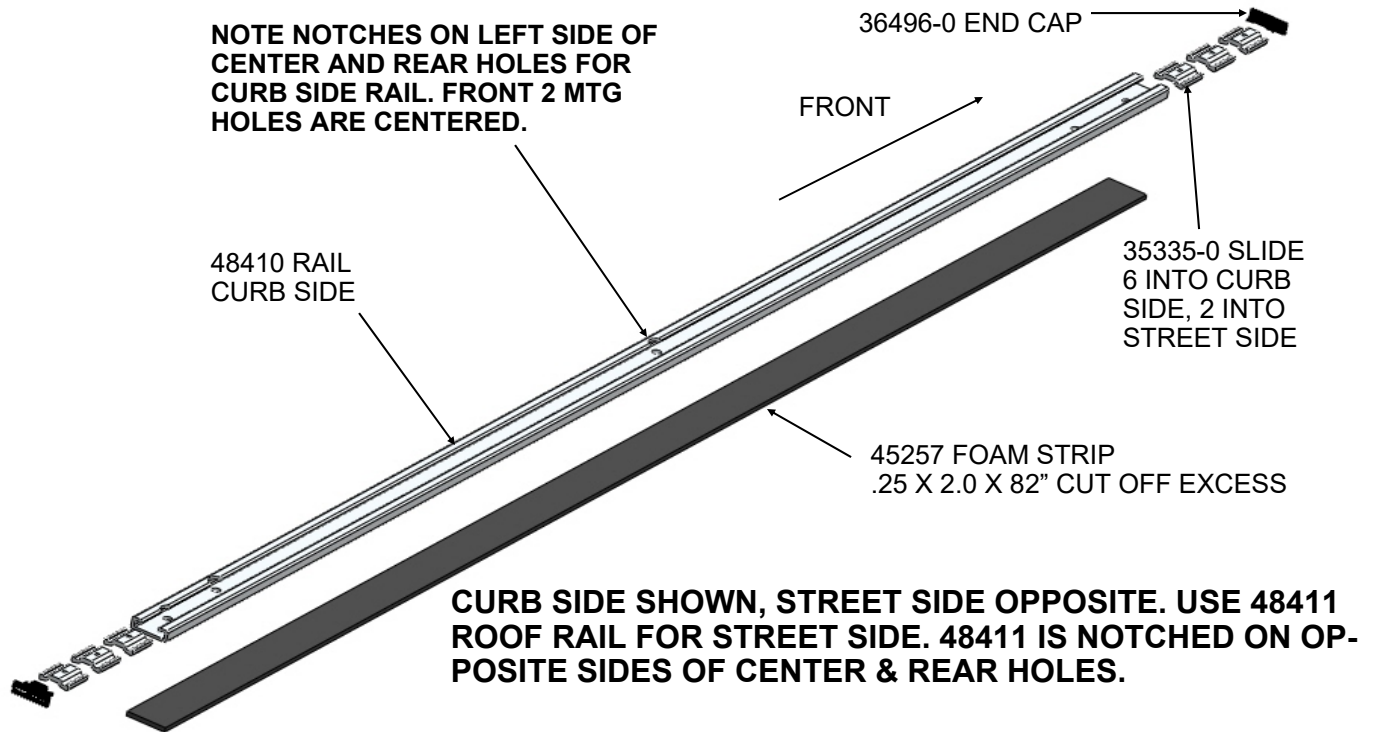

STEP #02 : ASSEMBLE 2 CROSS BOW ASMs.

SLIDE WEAR INSERT INTO CROSS BOW UNTIL INNER HOLES LINE UP ON EACH END. INSERT (1) 36496-0 END CAP INTO EACH END OF EACH BOW ASM. TIP : BEND WEAR INSERT TO MATCH CURVATURE OF BOW WHILE INSERTING. SOME MATERIAL WILL SHAVE OFF AS THIS IS AN INTERFERENCE FIT!

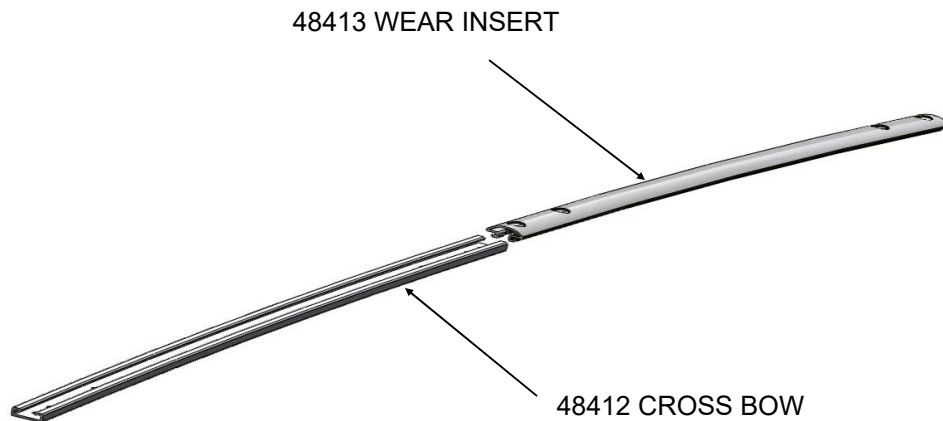



STEP #03 : ASSEMBLE LADDER STOP TO ROOF RAIL, CURB SIDE ONLY

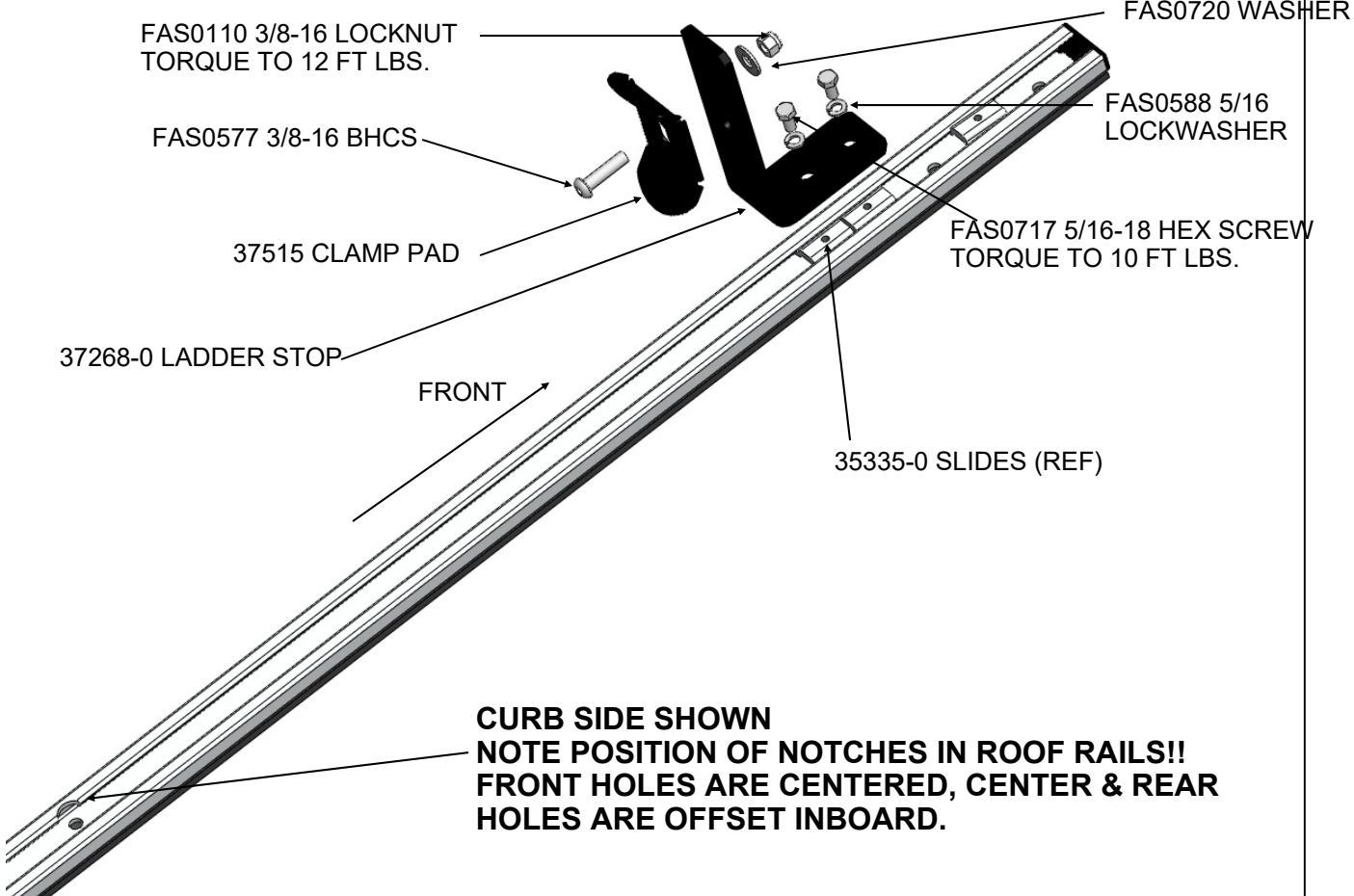

STEP #04 : ASSEMBLE BOW ASMS TO ROOF RAILS

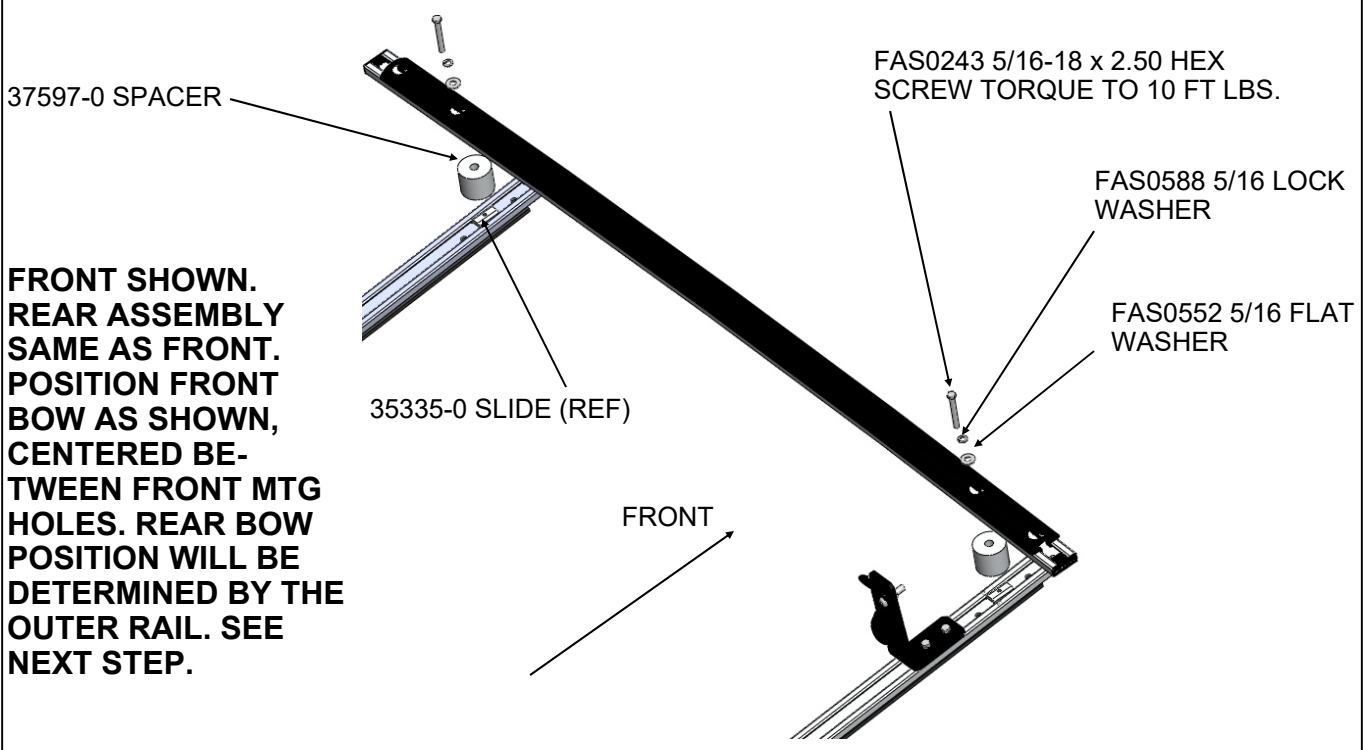



STEP #05 ASSEMBLE OUTER RAILS TO RACK

INSTALL (2) 51363 END CAPS INTO TUBE ENDS, INSTALL LATCH ASM AS SHOWN AND INSTALL ASM ON RACK.

NOTE : OUTER RAIL HAS 5/16 RIVMUTS IN BOTTOM SIDE FOR ATTACHMENT.

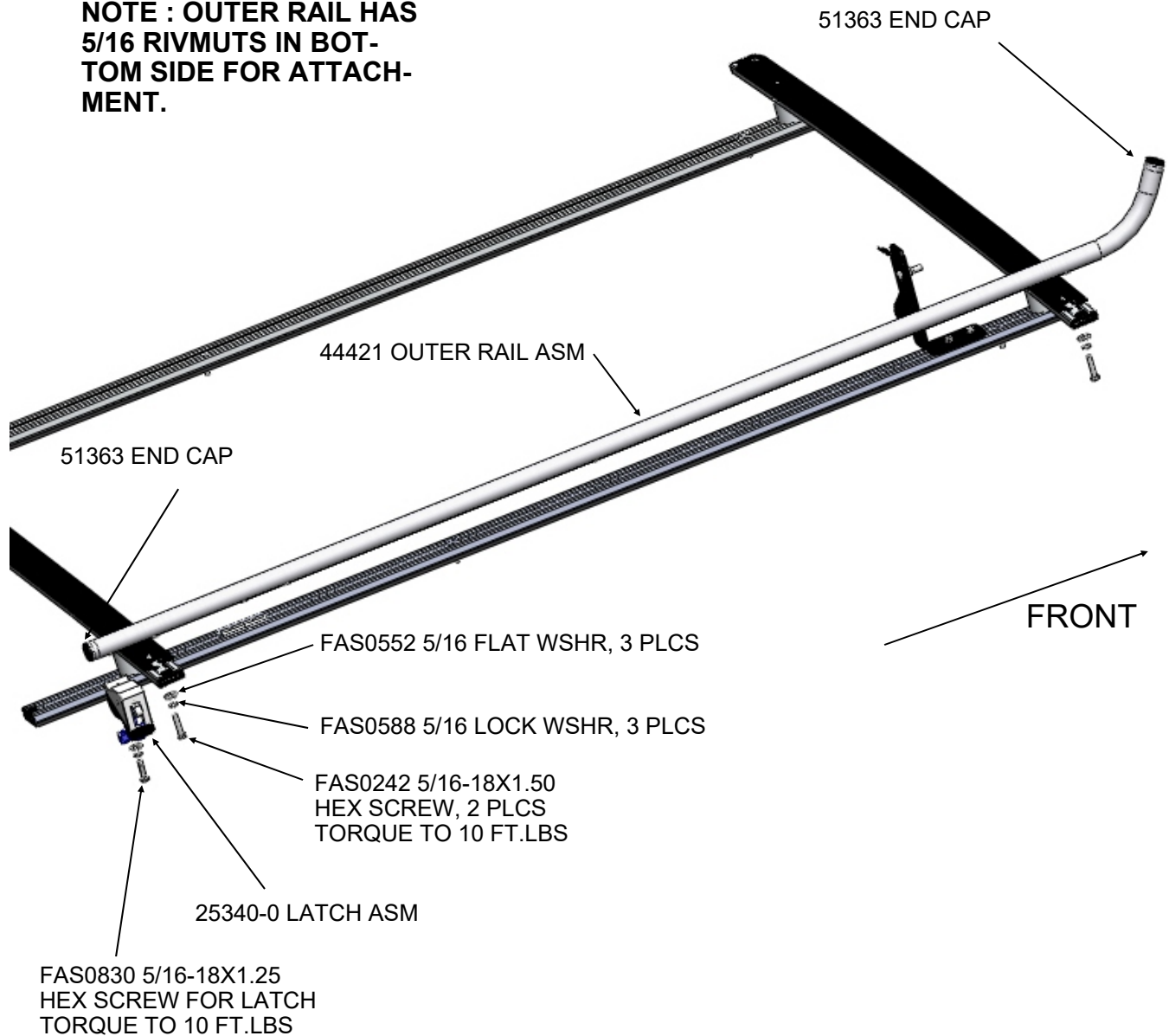



STEP #06 ASSEMBLE GRIP-LOCK MECHANISM AND INSTALL ON RACK

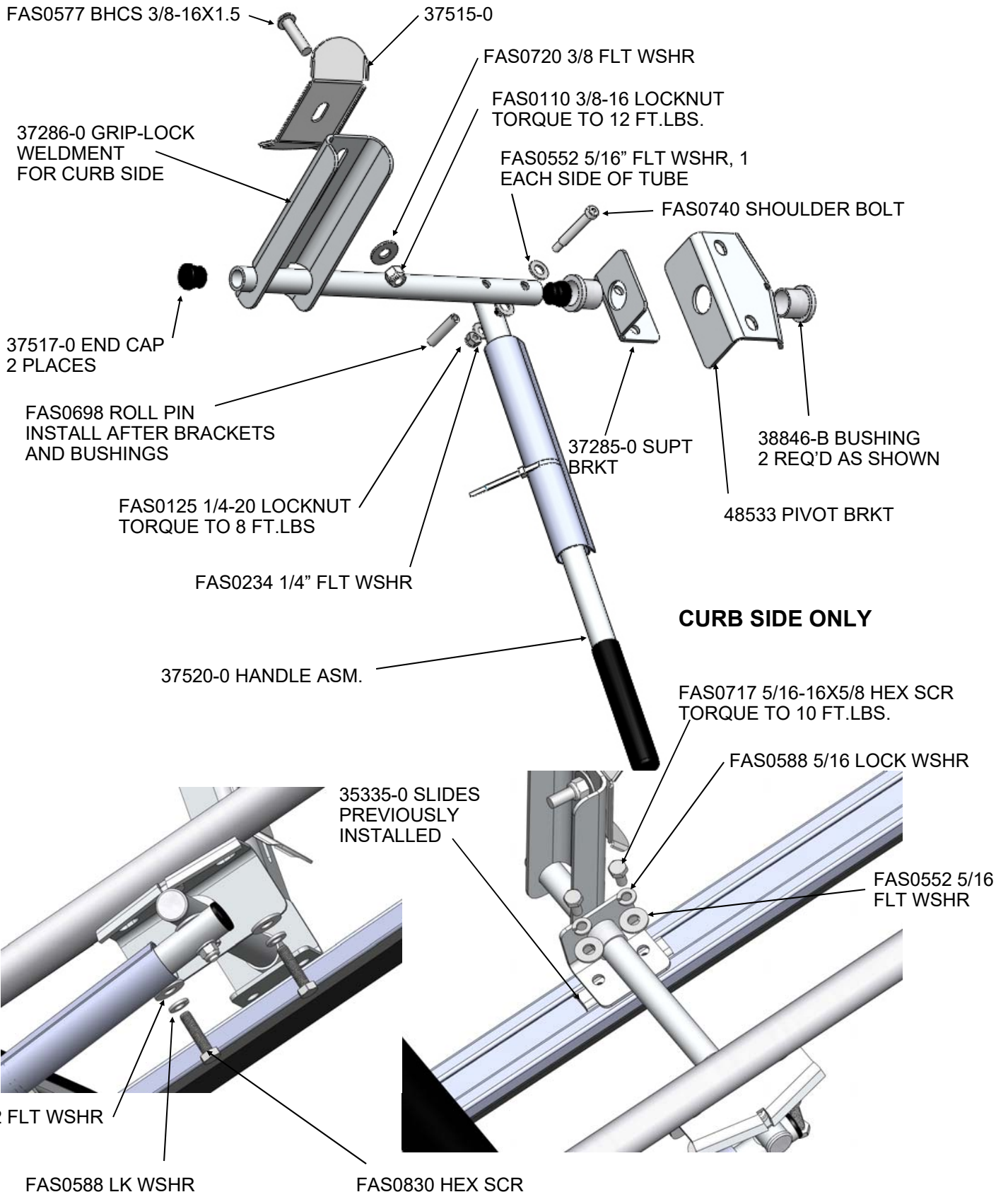



STEP #07 ASSEMBLE GRIP-LOCK RACK TO VEHICLE

REMOVE OEM PLASTIC PLUGS (10) FROM ROOF. THESE ARE THE ATTACHMENT POINTS FOR THE RACK. POSITION THE RACK ON ROOF, ADD THE SPACERS AND SCREW THE FAS0315 SCREWS INTO THE OEM

FASTENERS IN ROOF AFTER APPLYING SOME BUTYL TAPE UNDER WASHERS (SEE VIEW BELOW). TORQUE AS SHOWN. FASTENERS SHOWN BELOW ARE TYPICAL AT ALL ATTACHMENT POINTS.

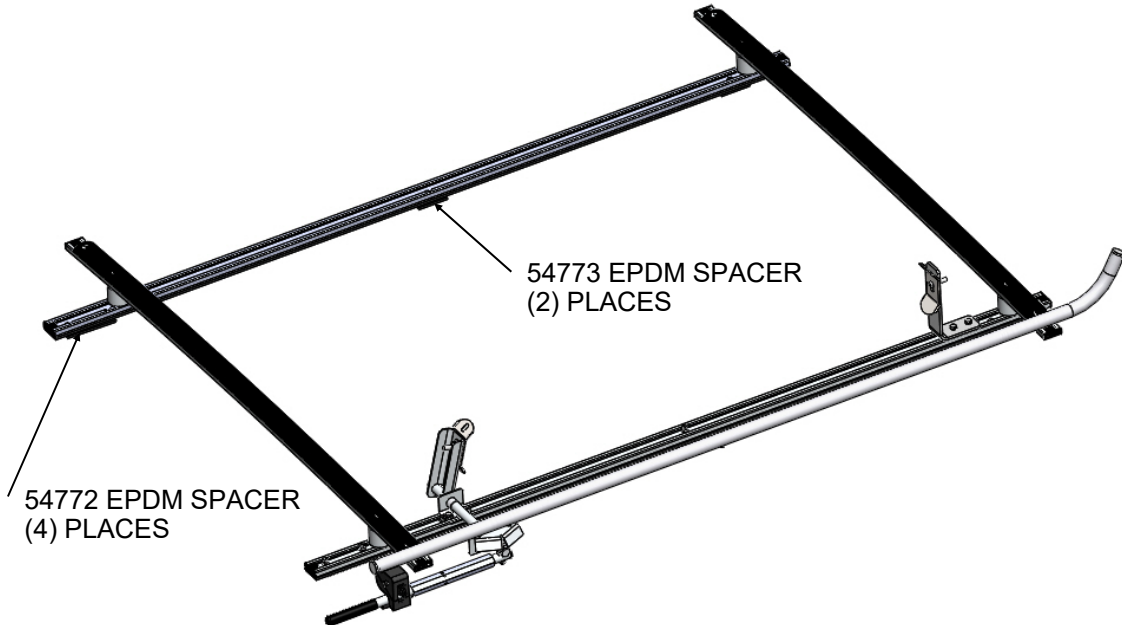

FAS0315 M6-1.0 X 30 BUTTON HEAD
FAS0672—LW
FAS0234—FW
PUSH THRU FOAM. SCREW INTO
OEM FASTENER. TORQUE TO
8-10 FT LBS

GENERIC PICTURE
SCREW HEAD
MAY VARY

BUTYL TAPE

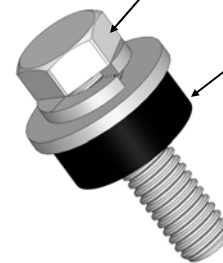

FASTENER WITH BUTYL TAPE APPLIED BE-
LOW WASHERS. USE ENOUGH TO FILL HOLE
IN ROOF RAIL WHEN INSTALLED.



**DOUBLE-CHECK ALL FASTENER LOCATIONS TO
BE SURE THAT ALL FASTENERS ARE TIGHTENED
TO SPECIFICATIONS!**

