

PRODUCT WEIGHT
1.5 lbs

WIDTH x DEPTH x HEIGHT
3 X 4 X 9.5

CAPACITY
12 FOOT A-FRAME

COLOR

Black

CATALOG NUMBER

57107

PRODUCT FEATURES

This DDLR wide step ladder kit is designed to Retrofit any DDLR series ladder rack. It is released as an add on kit as we do not get many requests for the wide step ladder. This is for the 12 foot wide A-Frame step ladder.

SEE PAGE 2 FOR APPLICATION NOTES AND ACCESSORIES, OTHER PRODUCTS THAT WORK WITH THIS UNIT.



CATALOG NUMBER 57107

PRODUCT APPLICATION

This DDLR wide step ladder kit is designed to Retrofit any DDLR series ladder rack. It is released as an add on kit as we do not get many requests for the wide step ladder. This is for the 12 foot wide A-Frame step ladder.

ACCESSORIES THAT WILL WORK WITH THIS PRODUCT

<i>CATALOG NUMBER</i>	<i>DESCRIPTION</i>
------------------------------	---------------------------

SPECIAL APPLICATION NOTES

Introduction / Comments:

THIS DDLR WIDE STEP LADDER KIT IS DESIGNED TO ALLOW A WIDER STEP LADDER TO WORK PROPERLY ON THE DDLR SERIES LADDER RACKS.

ALL LADDERS MUST BE REMOVED PRIOR TO INSTALLATION !

Note:

It is advised that all fasteners used in this assembly and installation of this Rack should be checked for tightness at the following intervals: @ 2-weeks and again @ 6-weeks of operation. This preventive maintenance step must be completed to ensure your package gives you long service life.

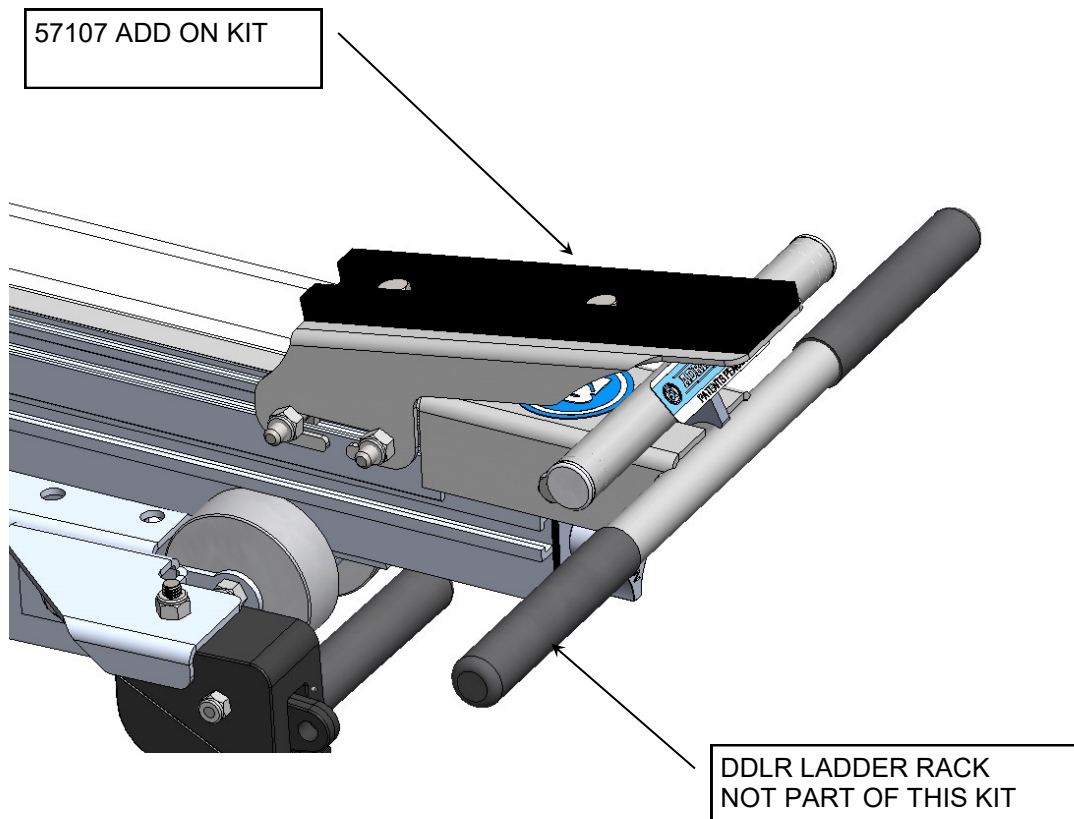

57107—DDLR WIDE STEP LADDER KIT

- PRECAUTIONS -



CAUTION
THE USE OF AIR IMPACT TOOLS CAN
OVER-TORQUE FASTENERS AND
CAUSE FASTENER FAILURE!



CAUTION
ALL INSTALLATION HOLES SHOULD BE SEALED
WITH SILICON OR BUTYL SEALANT TO PREVENT
EXHAUST FUMES FROM ENTERING THE VEHICLE!



DANGER
INSPECT FOR FUEL TANK, FUEL LINES, BRAKE LINES, HIGH
VOLTAGE BATTERIES AND ELECTRICAL LINES PRIOR TO
DRILLING TO AVOID DAMAGING CRITICAL VEHICLE SYSTEMS
OR INJURY TO INSTALLER DURING INSTALLATION PROCESS!

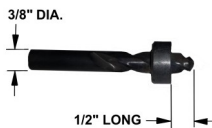

CAUTION
TO AVOID DAMAGING THE VEHICLE ALWAYS USE DRILL
STOPS WHEN DRILLING ANY INSTALLATION HOLES!
ADRIAN AVAILABLE PART #'S 31119-0 (3/8" X 1/2"
DEEP), 31121-0 (1/2" x 1/2" DEEP)



- IMPORTANT WARRANTY REQUIREMENTS -

1. SUBSTITUTING ADRIAN STEEL SPECIFIED FASTENERS FOR ASSEMBLY AND/OR INSTALLATION WILL VOID YOUR PRODUCT WARRANTY.
2. ALL HOLES DRILLED INTO VEHICLE SHOULD HAVE THE RAW METAL EDGES SEALED WITH A SELF-ETCHING PRIMER TO RESIST CORROSION AND POTENTIAL FASTENER POINT FAILURE.
3. ALL FASTENERS USED IN THE INSTALLATION OF THIS PRODUCT SHOULD BE TIGHTENED TO THE TORQUE(S) SPECIFIED IN THESE INSTRUCTIONS.
4. THESE INSTRUCTIONS SHOULD BE KEPT WITH THE VEHICLE.

THE BASIC TOOLS NEEDED FOR MOST INSTALLATIONS



DRILL



DRILL BIT WITH
STOP

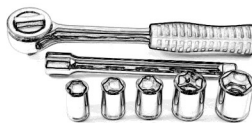

RATCHET, SOCKETS
AND/OR WRENCHES



SCREWDRIVERS



MEASURING TAPE

ADDITIONAL TOOLS MAY BE NEEDED FOR THIS INSTALLATION AND THEY WILL BE IDENTIFIED IN THE STEPS THAT FOLLOW.

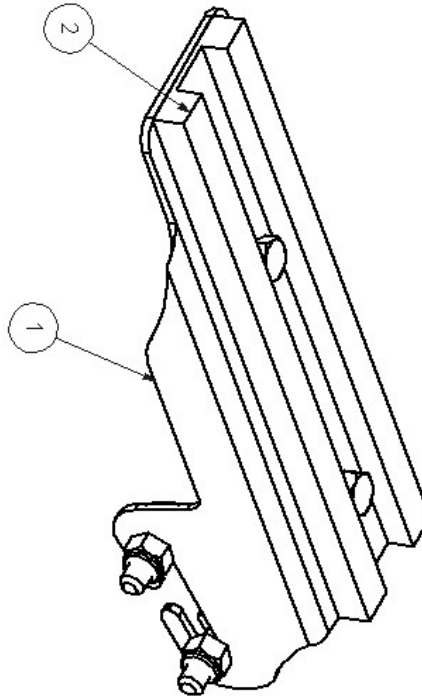
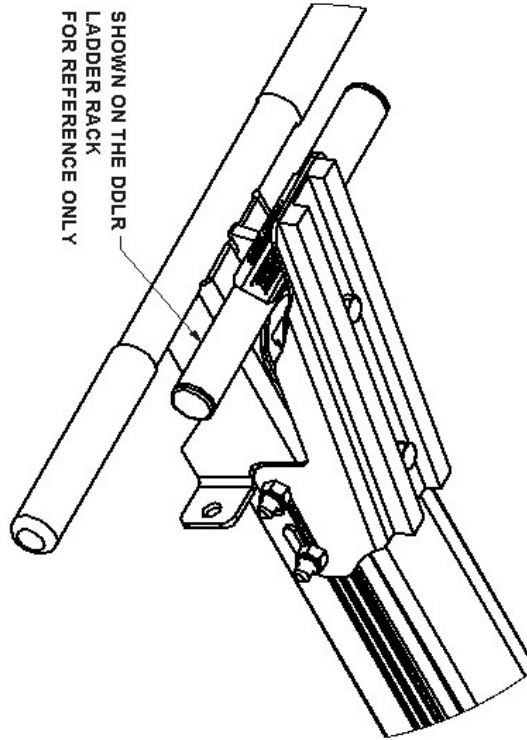

ITEM NO.	PART NUMBER	DESCRIPTION	57107/QTTY
1	57108-B	DDLR GUARD BRKT	1
2	40327	PAD, FRONT	1
3	BAG57109	FASTENER BAG, WIDE STEP LADDER KIT	1

BAG57109—FASTENER BAG, WIDE STEP LADDER KIT

ITEM NO.	PART NUMBER	DESCRIPTION	QTY.
1	BAG0505-A	BAG0507-A	1
2	FAS0035	BOLT,SQ HD,5/16-18X1.0 SS	4
3	FAS0248	Nut, Nylon Insert Lock, 5/16-18 SST	6
4	FAS0799	Screw, Hex Hd, 5/16-18x0.75 SS	2

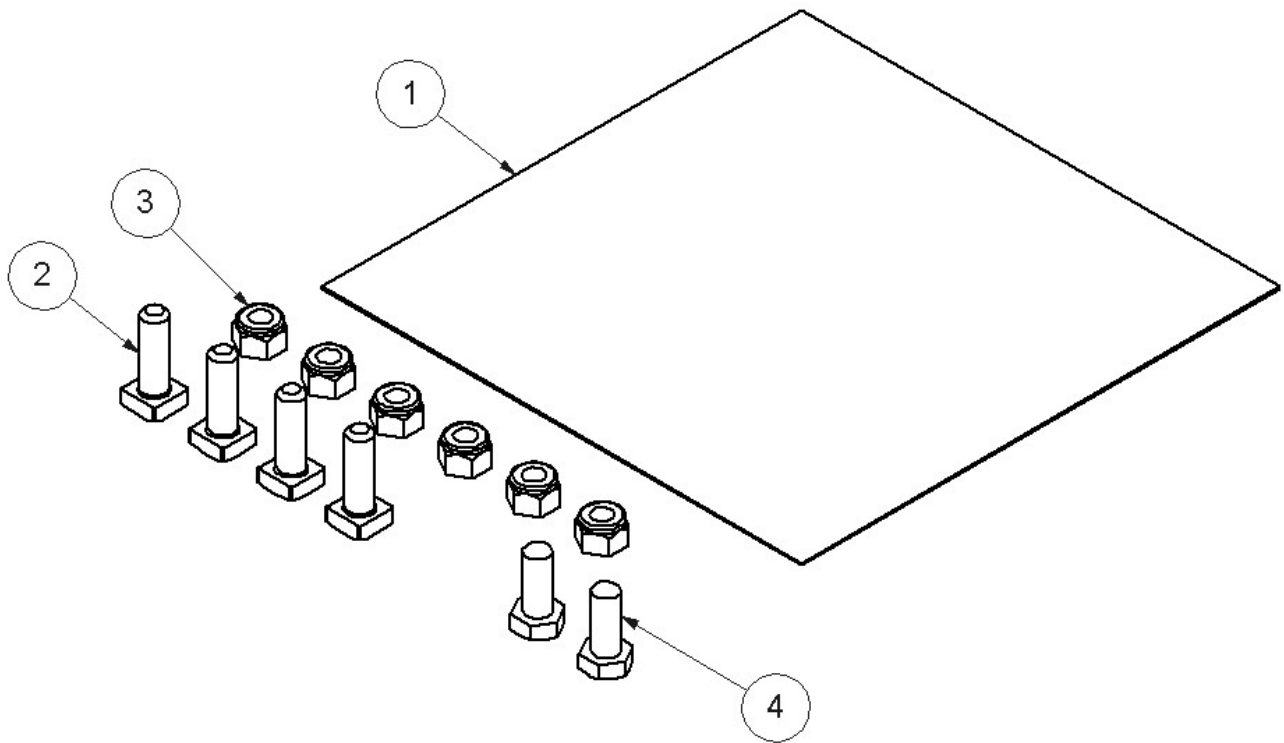

STEP #1 : SUB-ASSEMBLE YOUR ADD-ON KIT

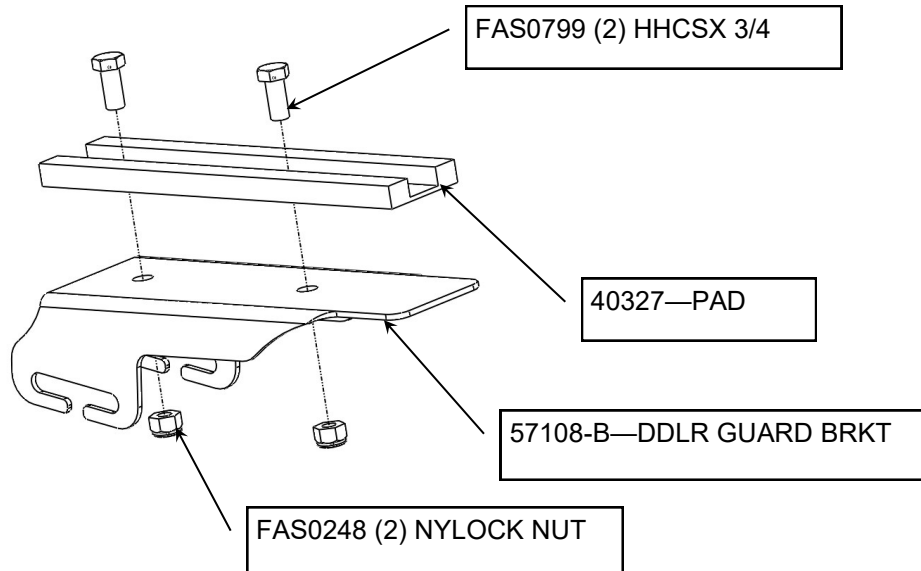

STEP #2A : REMOVE TOP GLIDE ASSEMBLY

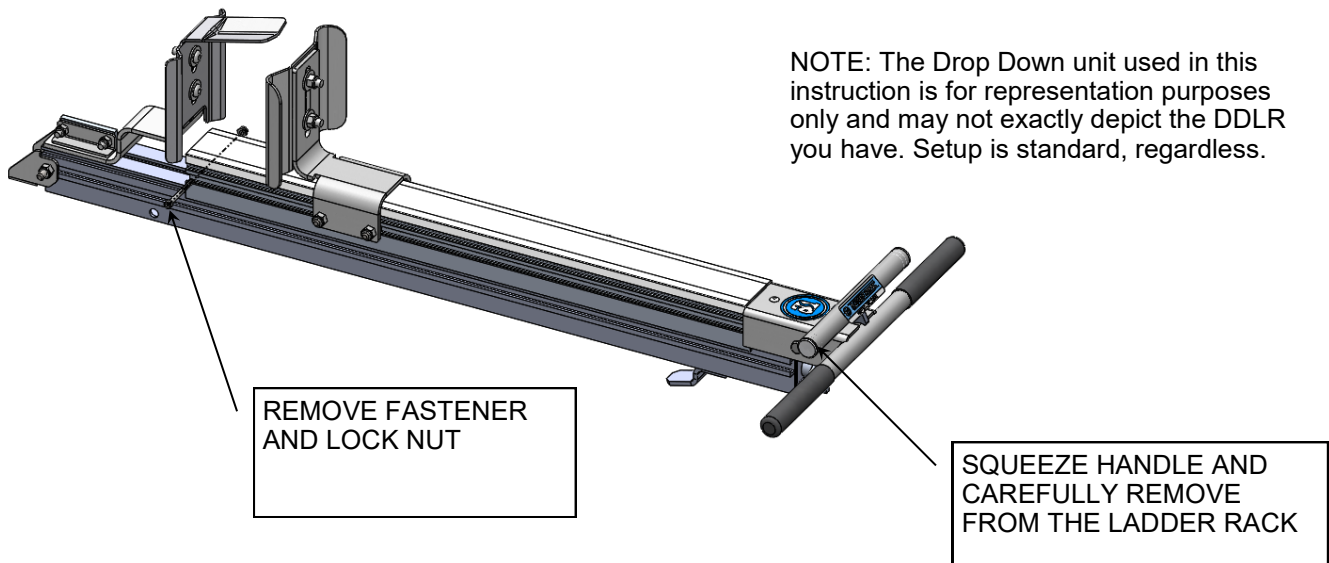

STEP #2B : REMOVE CLAMP PAD ASSEMBLY

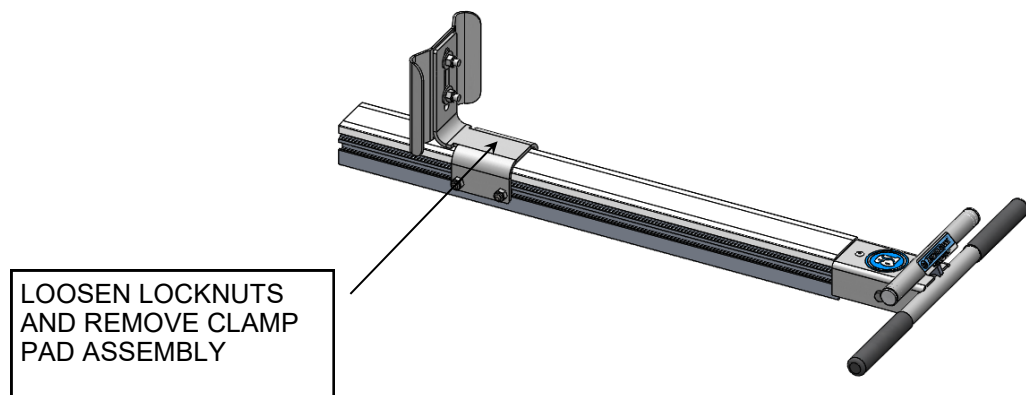

STEP #3 : ADD THE PRE-ASSEMBLED WIDE SLK ADD ON KIT

FROM THIS END
ADD SQ HD FASTENER
IN T-SLOT (2) PER SIDE.
FAS0035 (4) SQ HD

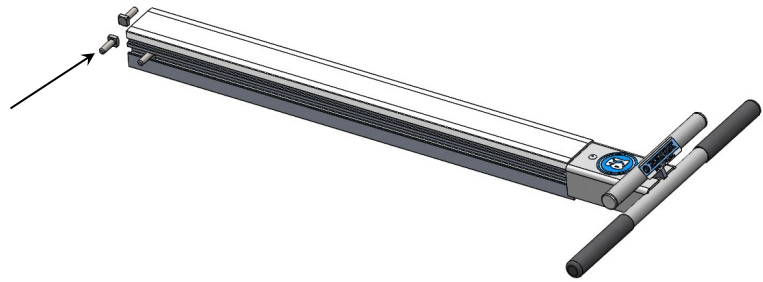

FROM STEP 1
PRE-ASSEMBLED
ADD ON KIT

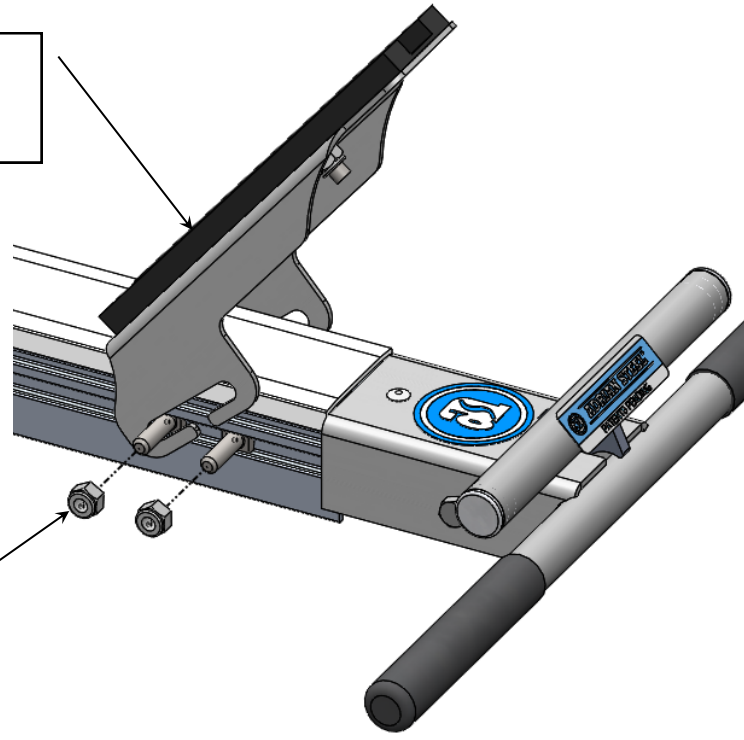

FAS0248 (4) NYLOCK

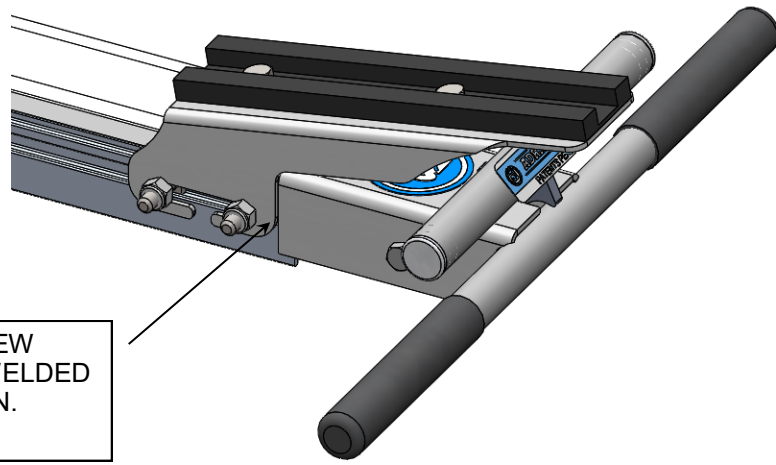

FINAL INSTALLED VIEW
AS CLOSE TO THE WELDED
HANDLE AS YOU CAN.

STEP #4 : RE-ASSEMBLE CLAMP PAD PREVIOUSLY REMOVED.

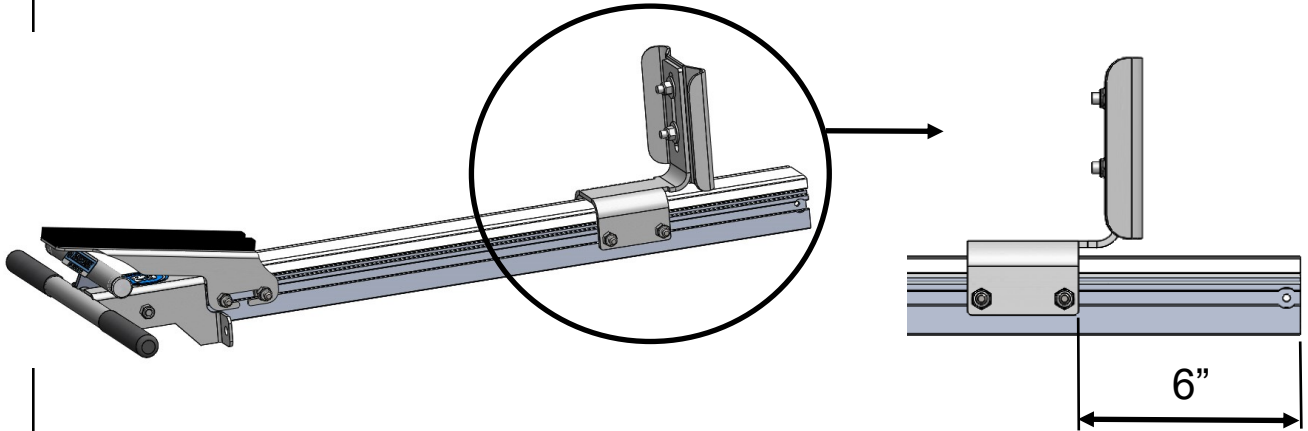

STEP #5 : RE-ASSEMBLE TOP GLIDE ASSM PREVIOUSLY REMOVED, SLIDE AND LOCK INTO PLACE- ADD FASTENERS

PAST POSITIVE STOP

SLIDE ASSEMBLY ONTO EXTRUSION PUSH AND LOCK INTO PLACE.

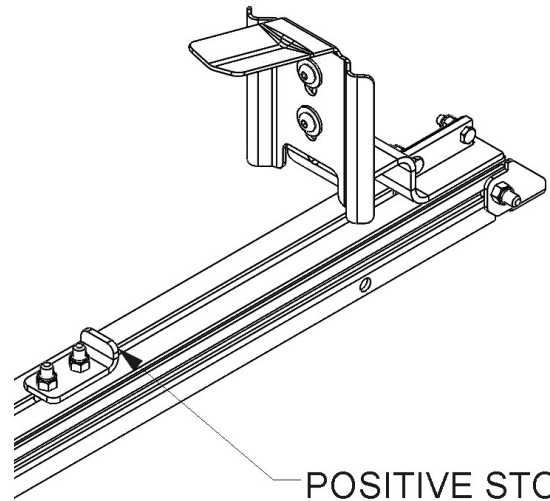
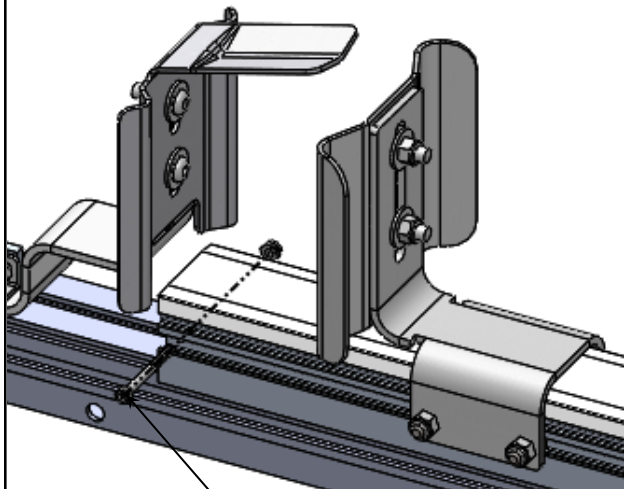
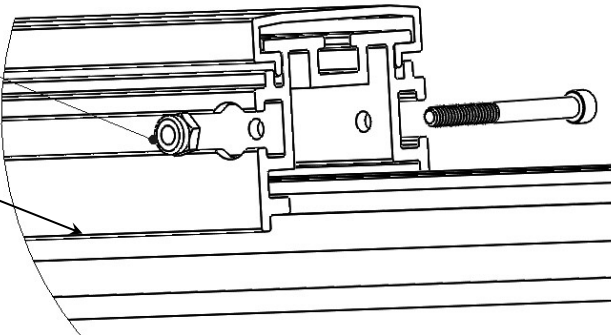

ADD FASTENERS AND LOCK NUT. LIGHTLY TIGHTEN UNTIL NYLOCK NUT TOUCHES THE ALUMINUM EXTRUSION. CYCLE TEST TO CONFIRM FASTENER IS NOT TO TIGHT.

STEP #6 : CYCLE TEST MODIFIED LADDER RACK TO CONFIRM THE POSITIVE STOP ENGAGES AND WORKS PROPERLY BEFORE USING WITH A LADDER

NOTE: The Drop Down unit used in this instruction is for representation purposes only and may not exactly depict the DDLR you have. Setup is standard, regardless.

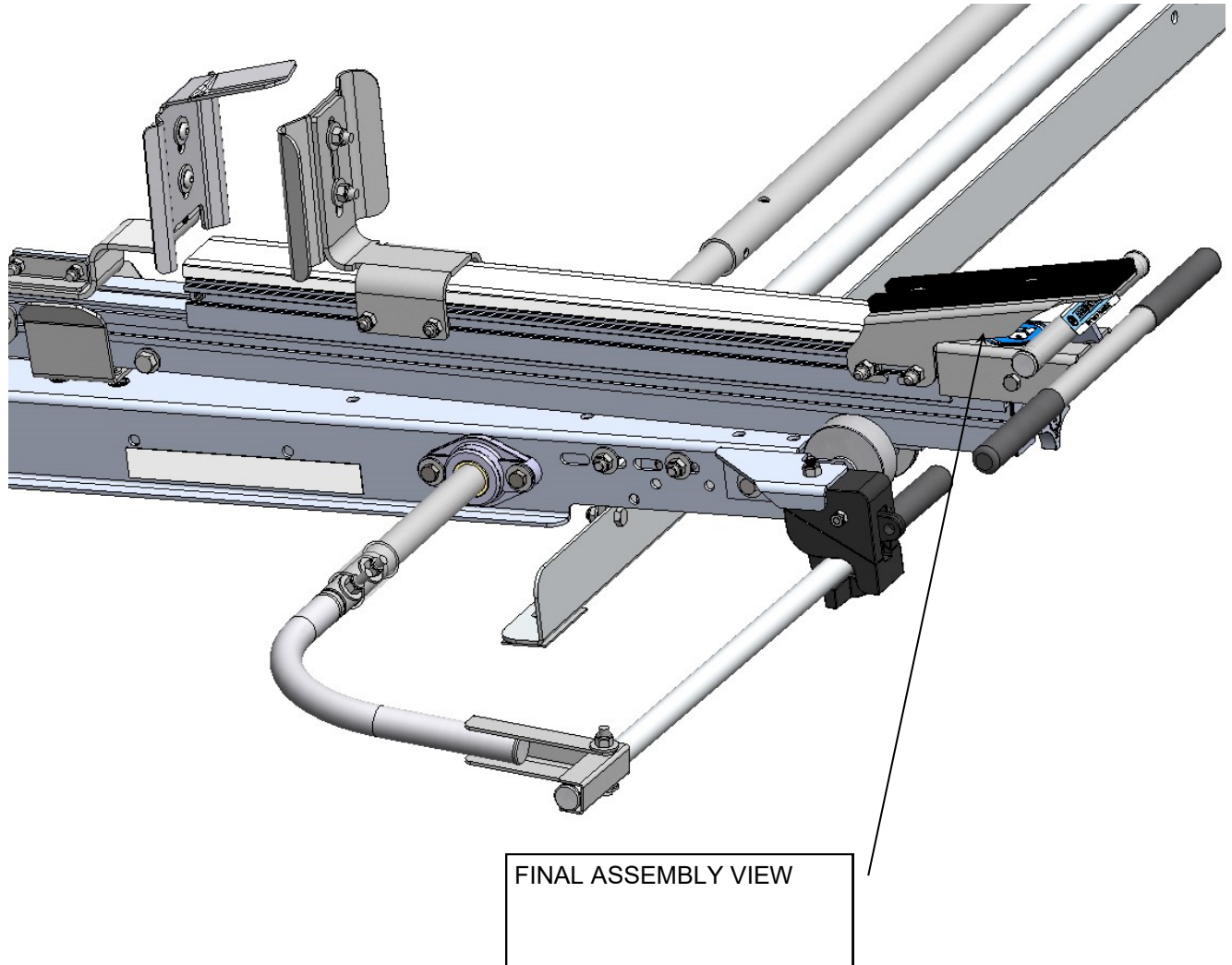

**DOUBLE CHECK ALL FASTENERS LOCATIONS TO BE SURE THAT ALL FASTENERS ARE TIGHTENED TO SPECIFICATIONS.
YOUR INSTALLATION IS NOW COMPLETE!
STOW THIS COPY IN THE VEHICLE FOR FUTURE REFERENCES!**