

Introduction / Comments:

Mounting bracket kit to support 4" & 6" PVC conduit. Attached to RRK series ladder rack cross supports.

Note:

It is advised that all fasteners used in this assembly and installation should be checked for tightness at the following intervals: @ 2-weeks and again @ 6-weeks of operation. This preventive maintenance step must be completed to ensure your Product gives you long service life.



**4" & 6" PVC Conduit Carrier Mounting
Bracket Installation**

- PRECAUTIONS -



CAUTION



THE USE OF AIR IMPACT TOOLS CAN OVER-TORQUE FASTENERS AND CAUSE FASTENER FAILURE!



CAUTION



ALL INSTALLATION HOLES SHOULD BE SEALED WITH SILICON OR BUTYL SEALANT TO PREVENT EXHAUST FUMES FROM ENTERING THE VEHICLE!



DANGER



INSPECT FOR FUEL TANK, FUEL LINES, BRAKE LINES, HIGH VOLTAGE BATTERIES AND ELECTRICAL LINES PRIOR TO DRILLING TO AVOID DAMAGING CRITICAL VEHICLE SYSTEMS OR INJURY TO INSTALLER DURING INSTALLATION PROCESS!



CAUTION



TO AVOID DAMAGING THE VEHICLE ALWAYS USE DRILL STOPS WHEN DRILLING ANY INSTALLATION HOLES! ADRIAN AVAILABLE PART #'S 31121-0 (3/8" X 1/2" DEEP), 31121-0 (1/2" x 1/2" DEEP)



- IMPORTANT WARRANTY REQUIREMENTS -

1. SUBSTITUTING ADRIAN STEEL SPECIFIED FASTENERS FOR ASSEMBLY AND/OR INSTALLATION WILL VOID YOUR PRODUCT WARRANTY.
2. ALL HOLES DRILLED INTO VEHICLE SHOULD HAVE THE RAW METAL EDGES SEALED WITH A SELF-ETCHING PRIMER TO RESIST CORROSION AND POTENTIAL FASTENER POINT FAILURE.
3. ALL FASTENERS USED IN THE INSTALLATION OF THIS PRODUCT SHOULD BE TIGHTENED TO THE TORQUE(S) SPECIFIED IN THESE INSTRUCTIONS.
4. THESE INSTRUCTIONS SHOULD BE KEPT WITH THE VEHICLE.

THE BASIC TOOLS NEEDED FOR MOST INSTALLATIONS



DRILL



DRILL BIT WITH STOP



RATCHET, SOCKETS AND/OR WRENCHES



SCREWDRIVERS



MEASURING TAPE

ADDITIONAL TOOLS MAY BE NEEDED FOR THIS INSTALLATION AND THEY WILL BE IDENTIFIED IN THE STEPS THAT FOLLOW.

If your vehicle contains carpet or a rubber floor mat you will need to prepare the mounting location. Position the product to be installed into the vehicle and once you are satisfied with the mounting locations, mark the mounting locations. Using a 1-3/16" diameter carpet cutter (P/N: 31183-0). Select the appropriate floor spacers as shown in the illustration. Set those aside for use later into the installation process.

Using the correct drill bit size for the selected plusnut, drill the mounting holes in the vehicle sheet metal to prepare for installing the plusnuts.

If you are thru-bolting at any of the locations simply drill a hole that is 1/16" larger than the bolt size(s) for those locations.

Once you have drilled the holes into the vehicle, the raw metal edges should be sealed using a self-etching primer to resist corrosion and potential fastener point failure.

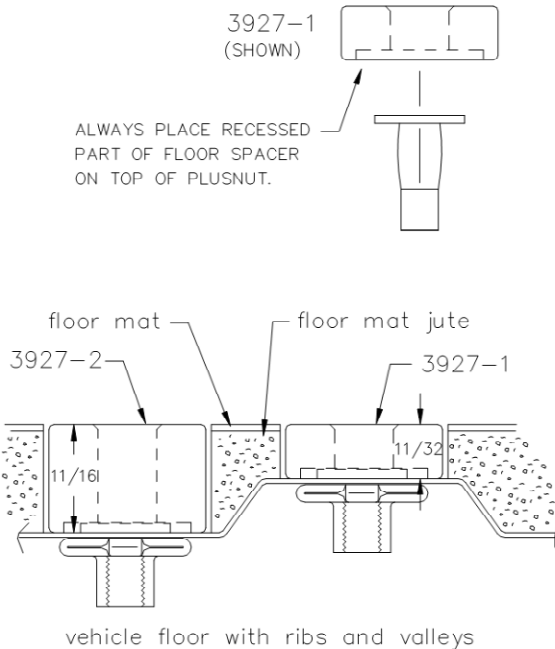

A PLUSNUT (RIVNUT) SETTING TOOL IS REQUIRED FOR PLUSNUT (RIVNUT) INSTALLATION . PLUS NUT SETTING TOOL CAN BE ORDERED THROUGH ADRIAN STEEL, OR USE AN AIR POWERED PLUSNUT SETTING GUN.

1/4-20UNC Plusnut (FAS0052) Use 3/8" dia. drill w/stop
 FAS0080 SCREW, HXHD, 1/4-20UNCx2.00", G8
 FAS0067 WASHER, FLAT, 1/4"ID
 22200-0 PLUSNUT TOOL

5/16-18UNC Plusnut (FAS0091) Use 1/2" dia. drill w/stop
 FAS0095 SCREW, HXHD, 5/16-18UNCx2.00", G8
 FAS0086 WASHER, FLAT, 5/16"ID
 22200-0 PLUSNUT TOOL

PLACE BARREL OF PLUSNUT BODY IN SHEET METAL THRU HOLE UNTIL FLANGE IS FLUSH WITH SHEET METAL.
 USING A 9/16" COMBINATION WRENCH OF PLUSNUT TOOL BODY AND A SECOND HAND WRENCH, RATCHET OR AIR TOOL. ROTATE THE HEX BOLT HEAD CW TO DRAW PLUS NUT FLANGES UP (SET THE PLUSNUT).

Installation and/or Assembly Fasteners
(BAG51693)

ITEM NO.	PART NUMBER	DESCRIPTION	QTY.
1	BAG51693	BAG, FAS, ASM, 51693	1
2	FAS0248	Nut, Nylon Insert Lock, 5/16-18 SST	4
3	FAS0813	Screw, BHCS, 5/16-18X1.00, SS	4
4	FAS0552	Washer, Flat, 5/16, SST	8

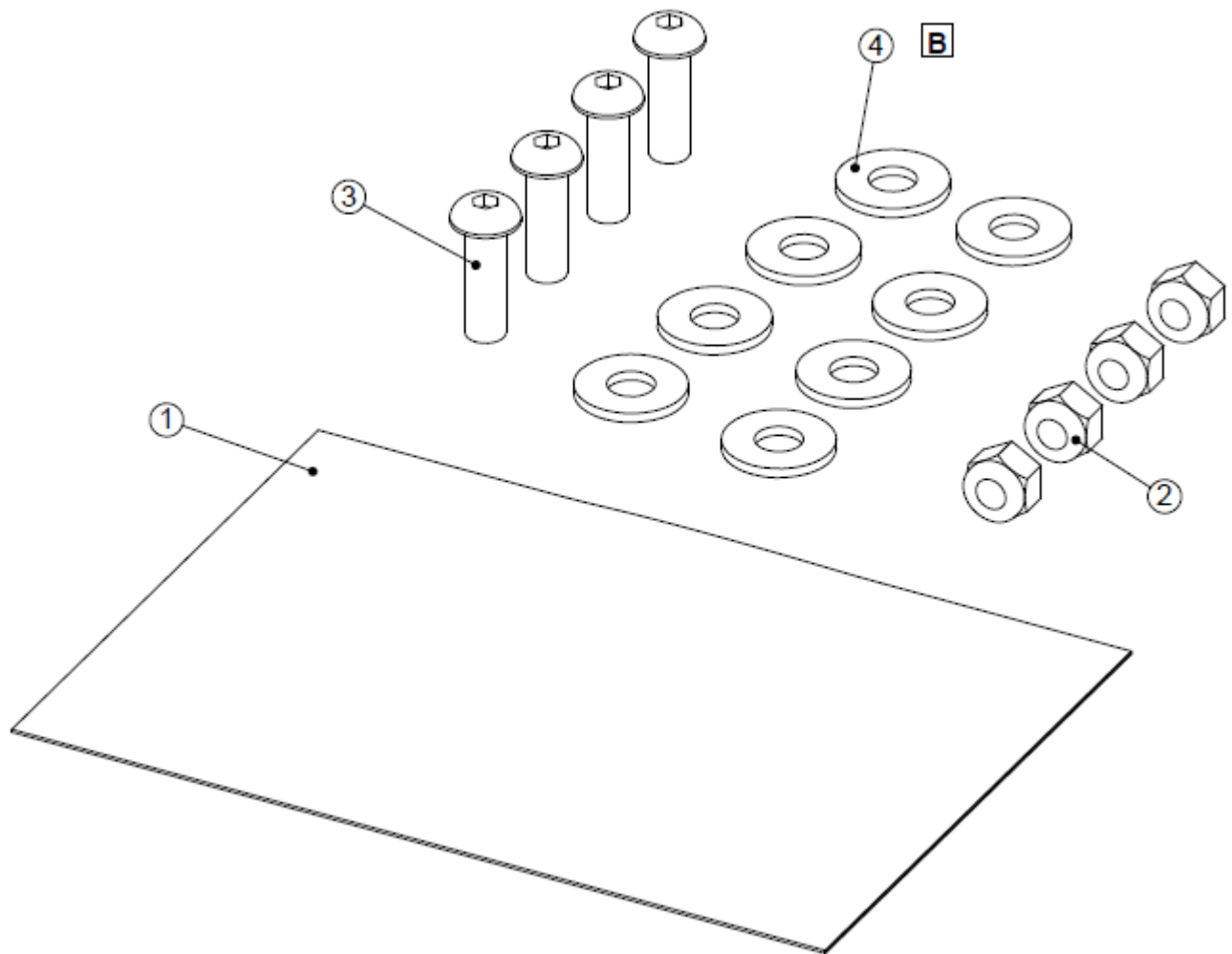

Attach brackets to RRK series cross support (front and rear). The flange must be facing outward on both the front and rear cross supports. Insert button head screws (FAS0813) with flat washer (FAS0552) into bracket and cross supports. Fasten flat washers (FAS0552) and hex nuts (FAS0248) on the inside of cross support channels. Torque to 14 in/lbs.

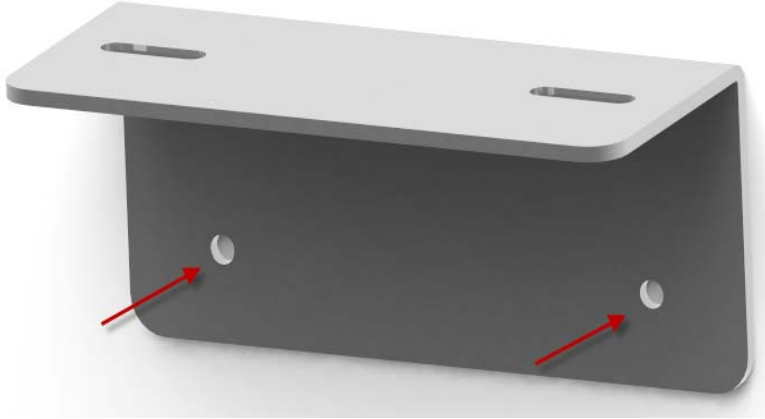

(Screw orientation)

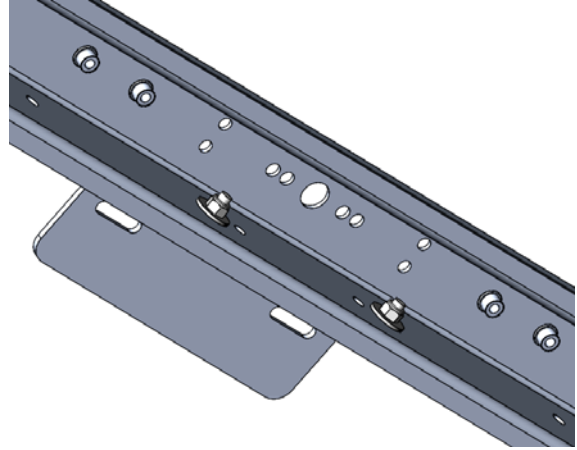

(Inside view of cross supports installed)

SHIP THRU ONLY!!!

After brackets are installed on cross supports, box and stow remaining conduit kit product in vehicle for ship thru.

(Bracket orientation)

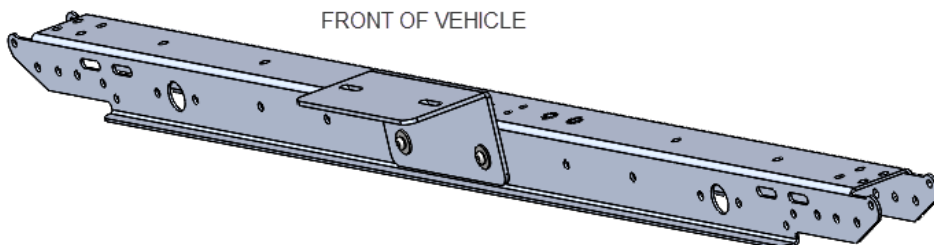
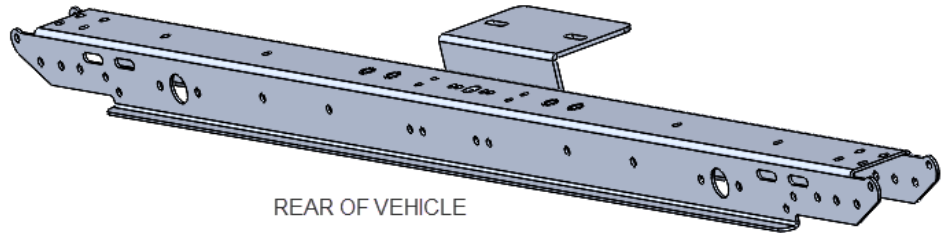

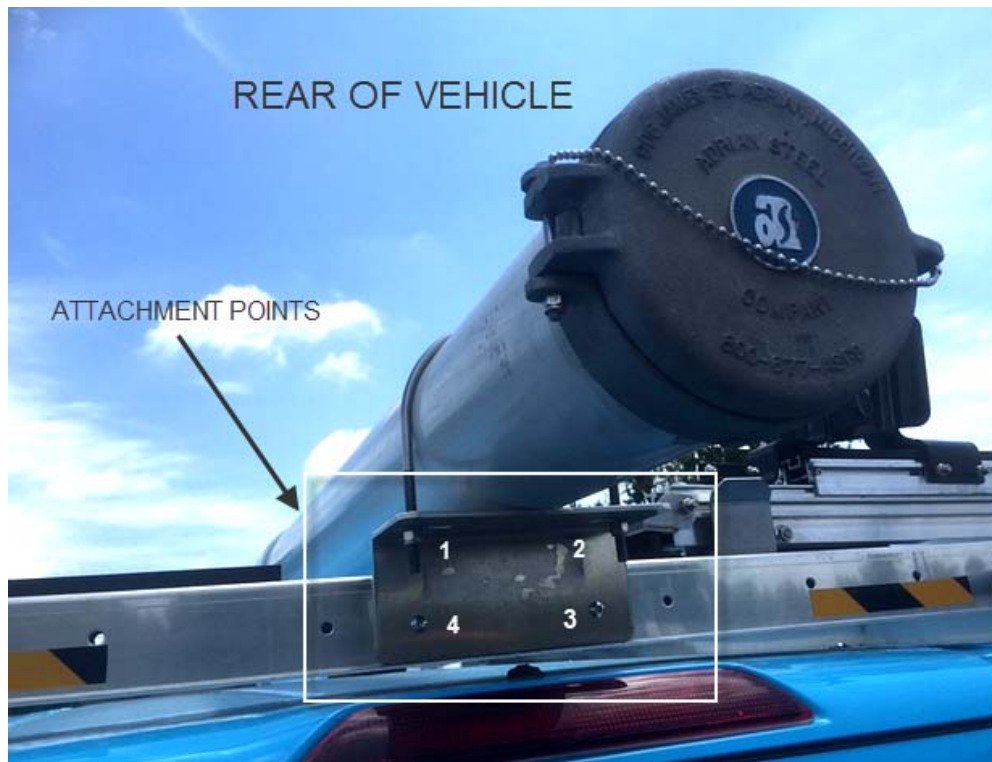

DOUBLE CHECK ALL FASTENERS LOCATIONS TO BE SURE THAT ALL FASTENERS ARE TIGHTENED TO SPECIFICATIONS.

**YOUR INSTALLATION IS NOW COMPLETE!
STOW THIS COPY IN THE VEHICLE FOR FUTURE REFERENCES!**



ASSEMBLY & INSTALL INSTRUCTIONS

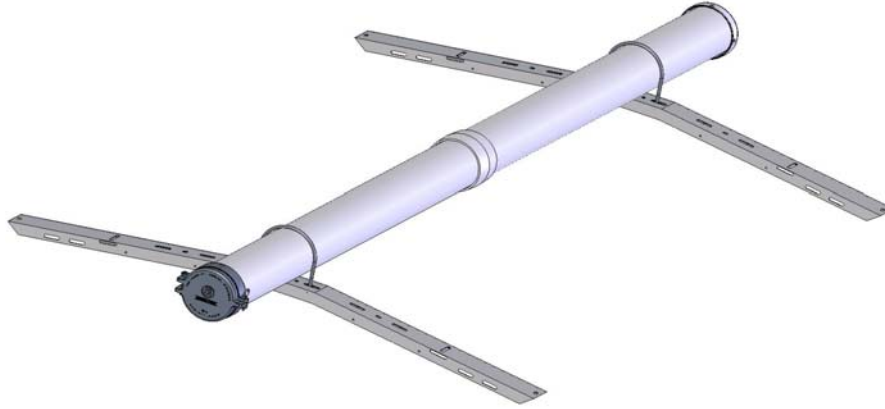

34064-0

ADRIAN STEEL PVC CONDUIT KIT 4" X 10'

34065-0

ADRIAN STEEL PVC CONDUIT KIT 6" X 10'

51693

CON. CARRIER 6" FLEET

51890

CON. CARRIER 4" FLEET

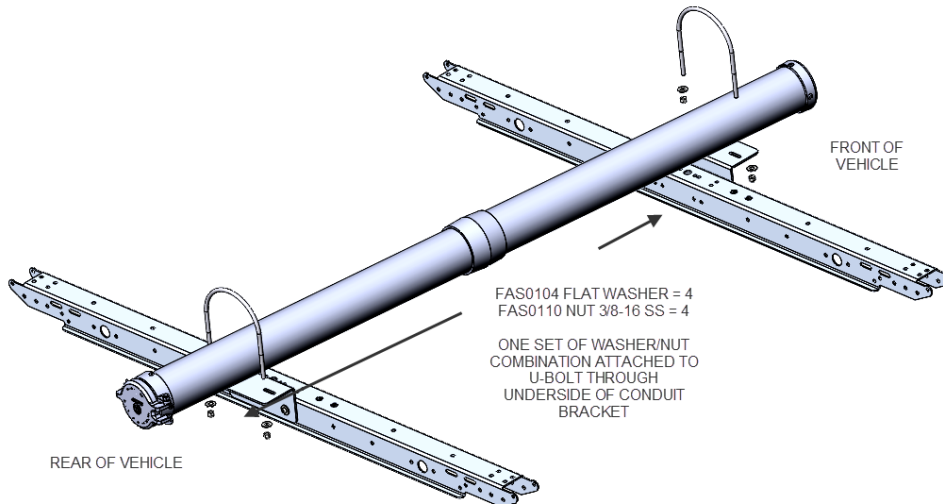

ECN-18831 DATE: 08/11/16 DWG. BY: KG REV. BY: KG CHK. BY: KG ISSUE: B P.N.: 34070-0



BEFORE YOU START!

IMPORTANT INSTALLATION STEPS ARE DENOTED USING A STOP SIGN. THESE STEPS MUST BE PERFORMED AS SPECIFIED IN ORDER TO ENSURE A PROPER INSTALLATION AND MUST BE FOLLOWED IN ORDER TO MAINTAIN YOUR PRODUCT WARRANTY!



CRITICAL INFORMATION PERTAINING TO USER AND/OR VEHICLE SAFETY IS DENOTED USING A CAUTION SIGN. SAFETY ITEMS MUST BE STRICTLY ADHERED TO IN ORDER TO ENSURE A SAFE WORKING ENVIROMENT!



YOU WILL NEED THE FOLLOWING TOOLS IN ORDER TO COMPLETE THIS JOB.

9/16" OPEN END WRENCH &/or Ratchet w/ 9/16" Deep Well Socket, DRILL MOTOR, 1/4" DRILL BIT, SAFETY GLASSES, HAMMER, TAPE MEASURE, HANDSAW (for cutting PVC tube to length),

ALL FASTENERS USED IN THE ASSEMBLY AND INSTALLATION OF THIS PRODUCT SHOULD BE TIGHTENED TO THE SPECIFIED TORQUE AS LISTED WITH EACH FASTENER CALLOUT BOX.



THE USE OF AIR OR ELECTRIC IMPACT TOOLS FOR THE ASSEMBLY OF FASTENERS IS NOT RECOMMENDED AND COULD CAUSE FASTENER FAILURE!



WARNING



THE USE OF DRILLS WITH INTEGRAL DRILL STOPS ALONG WITH PROPER INSPECTION FOR GAS TANK, GAS LINES, BRAKE LINES AND ELECTRICAL LINES PRIOR TO DRILLING ANY MOUNTING HOLES IS STRONGLY RECOMMENDED TO ENSURE THAT VEHICLE DAMAGE IS AVOIDED!



THE USE OF NON-STANDARD FASTENERS AND/OR DEVIATING FROM THE FASTENERS SPECIFIED IN THE INSTRUCTION (S) MAY VOID YOUR PRODUCT WARRANTY!

ALL DRILLED HOLES IN THE VEHICLE SHOULD HAVE THE RAW METAL EDGES SEALED WITH A SELF-ETCHING PRIMER TO RESIST CORROSION AND POTENTIAL FASTENER POINT FAILURE!







STEP- 01

JOINING THE PVC CONDUIT KIT SECTIONS

Please note that CONDUIT KITS (34064-0, 34065-0) require adhesive bonding of the PVC tube sections with a PVC coupler prior to mounting the HOLDER KITS onto the vehicle ladder rack.

IMPORTANT: ALWAYS FOLLOW ADHESIVE & PRIMER/SOLVENT MANUFACTURES DIRECTIONS ON CONTAINER FOR PROPER SAFETY AND USE OF PRODUCT.

Remove excess PVC Adhesive material with a paper towel on the outside surface of the PVC tube.

 <p>34015-0 PVC PRIMER/SOLVENT 4 oz CAN</p>	 <p>34016-0 PVC CEMENT 4 oz CAN</p>	 <p>32068-0 4" OR 34069-0 6" A.S. PVC REAR ASSEMBLY</p>	 <p>32066-0 4" or 34067-0 6" A.S. PVC FRONT ASSEMBLY</p>
---	---	--	--

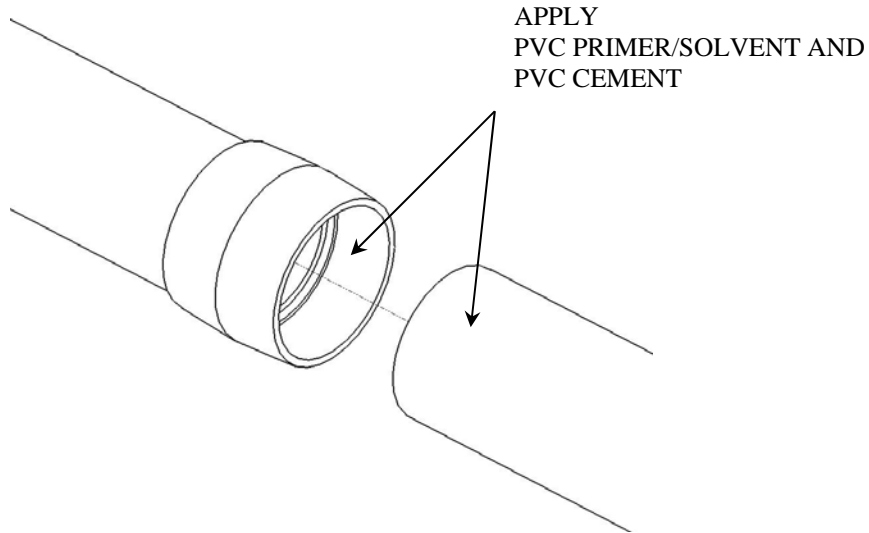

**IMPORTANT:
ALWAYS FOLLOW ADHESIVE & PRIMER/SOLVENT
MANUFACTURERS DIRECTIONS ON CONTAINER FOR PROPER
SAFETY AND USE OF PRODUCT.**



STEP- 02

MOUNTING THE PVC CONDUIT KIT ON VEHICLE LADDER RACK

			
14986-0 U-BOLT, 6" (2) REQ'D	14987-0 U-BOLT, 4" (2) REQ'D	FAS0104 WASHER, FLAT, 3/8"ID (4) REQ'D	FAS0110 NUT, NYLON LOCK, 3/8-16UNC (4) REQ'D 20 FT-LBS TORQUE

The PVC tube HOLDER KITS are mounted to a service vehicle ladder rack. When the kit is mounted the canister lid is positioned to swing to the LH (street) side when opened. Position the PVC tube on the ladder rack at the desire location. Install the "U-Bolts" astride the tube with the threaded ends through the holes/slots in the front and rear cross supports of the vehicle ladder rack. Secure in place with the fasteners shown above, tighten to 20 FT-LBS torque.

When this kit is installed on other than an ADRIAN STEEL ladder rack some drilling may be required.

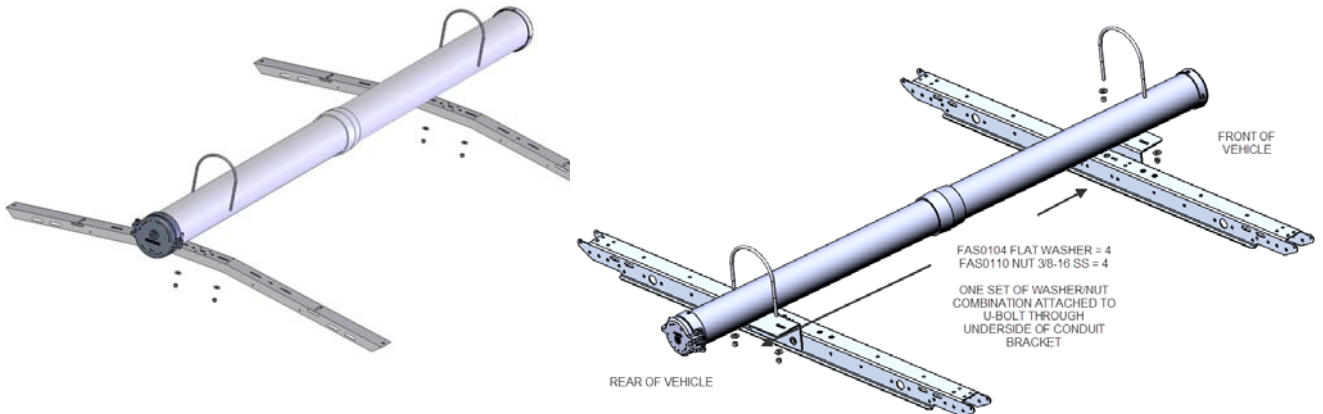

DOUBLE-CHECK ALL FASTENER LOCATIONS TO BE SURE THAT ALL FASTENERS ARE TIGHTENED TO SPECIFICATIONS!



YOUR INSTALLATION IS NOW COMPLETE! STOW THIS COPY IN THE VEHICLE FOR FUTURE REFERENCE!